

PART NUMBER	REV	FIRST USED	TERMINATOR	FEED TYPE	DESCRIPTION
1339783-1	A		BENCH & LEADMAKER	MECH POST FEED	HD-I APPLICATOR
7-1339783-1	A		BENCH & LEADMAKER	MECH POST FEED	-1 AND SPARE PARTS
7-1339783-7	A		-	-	SPARE PARTS KIT

CRIMP DATA JST TERMINAL AMP CRIMP SPECS			
TERMINAL NAME: 250 TAB-IN TAB TYPE			
CRIMP	SIZE	TYPE	RANGE
WIRE	2.54 [ .100 IN ]	F	0.50-2.00mm <sup>2</sup> or 20-14 AWG
INSUL	4.32 [ .170 IN ]	F	2.60-3.80 [ .102-.150 IN ]
WIRE STRIP LENGTH		APPL INSTRUCTION	
4.40-5.20 [ .173-.205 IN ]		408-8323	
TERMINAL APPL SPEC	-	FEED	26.50 [ 1.043 IN ]

TERMINALS APPLIED				
AMP PN	MFR PN	-	-	-
1572819-1	SIM-S1T-250N	-	-	-
1572819-2	SIM-S1-250NK	-	-	-
1572819-3	SIM-S1-250N	-	-	-
-	-	-	-	-
-	-	-	-	-
-	-	-	-	-
-	-	-	-	-
-	-	-	-	-

WIRE SIZE mm <sup>2</sup> AWG	CRIMP HEIGHT	PIN PN AND LENGTH [IN]
2.00mm <sup>2</sup>	1.93 ±0.05 [ .076 ±.002 IN ]	7-354778-3 [ 1.2860 ]
1.50mm <sup>2</sup>	1.75 ±0.05 [ .069 ±.002 IN ]	8-354778-7 [ 1.2930 ]
1.00mm <sup>2</sup>	1.60 ±0.05 [ .063 ±.002 IN ]	9-354778-9 [ 1.2990 ]
0.75mm <sup>2</sup>	1.52 ±0.05 [ .060 ±.002 IN ]	354778-8 [ 1.3030 ]
0.50mm <sup>2</sup>	1.42 ±0.05 [ .056 ±.002 IN ]	1-354779-6 [ 1.3070 ]
-	-	-
-	-	-
-	-	-
-	-	-
-	-	-
-	-	-
-	-	-
-	-	-
-	-	-
-	-	-
-	-	-

- RECOMMENDED SPARE PARTS.
- 2. GREASE RAM, CAM, CAM FOLLOWER AND FEED ROD LIGHTLY.
- 3. LUBRICATE DAILY PER THE APPLICATOR INSTRUCTION SHEET SUPPLIED WITH THE APPLICATOR.
- 4. CERTAIN TERMINALS REQUIRE LUBRICATION. REFER TO THE APPLICATOR INSTRUCTION SHEET FOR MORE INFORMATION.
- 5. ALL CRIMP DATA CALCULATED BY TYCO ELECTRONICS UK LTD. CUT TO LENGTH AT ASSY.
- 7. RANGE QUOTED IS THAT OF THE TERMINAL, NOT THE APPLICATOR.
- 8. 2.00mm<sup>2</sup> WILL NOT ACHIEVE CAPABILITY STUDY FOR CRIMP TENSILE.

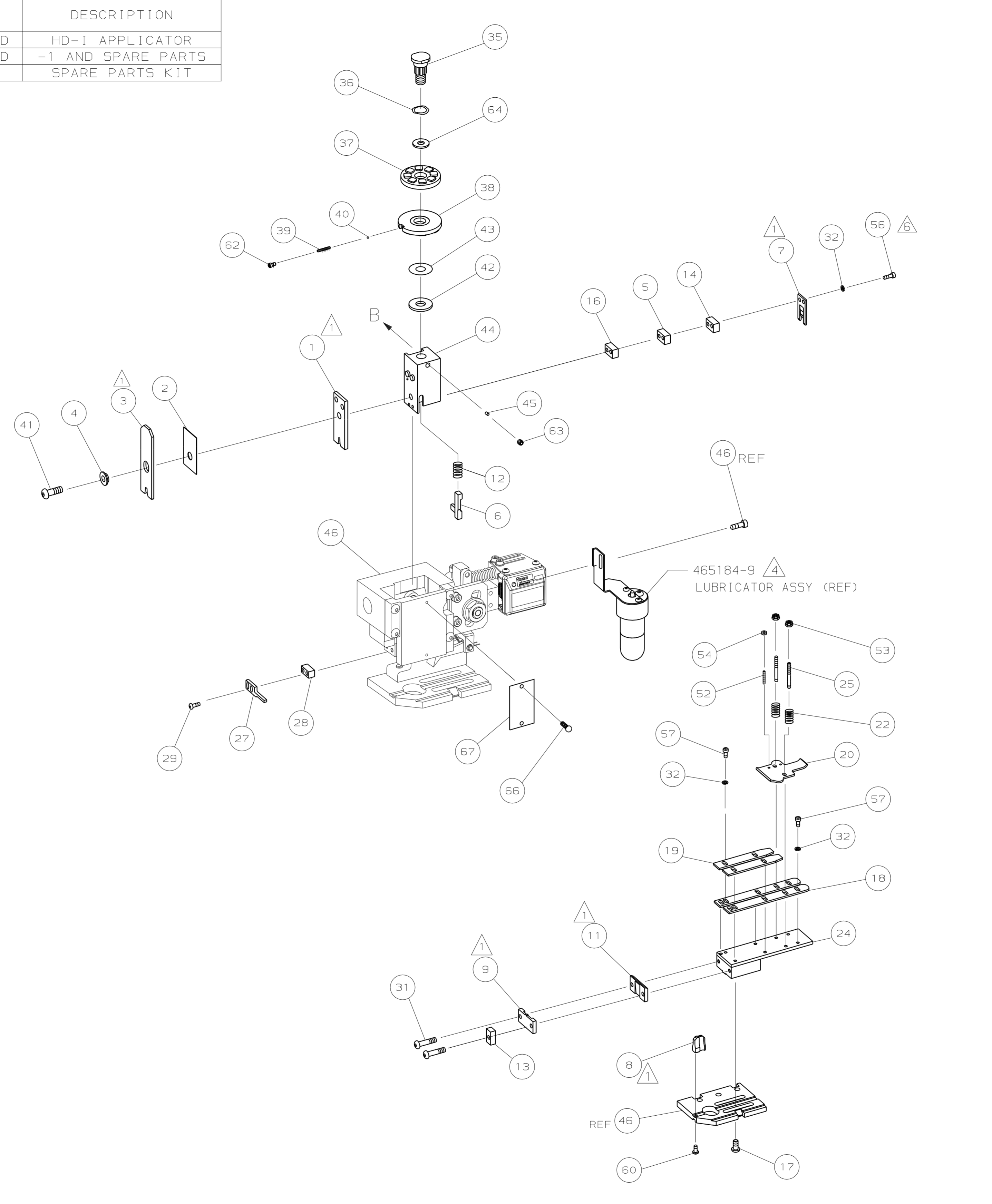
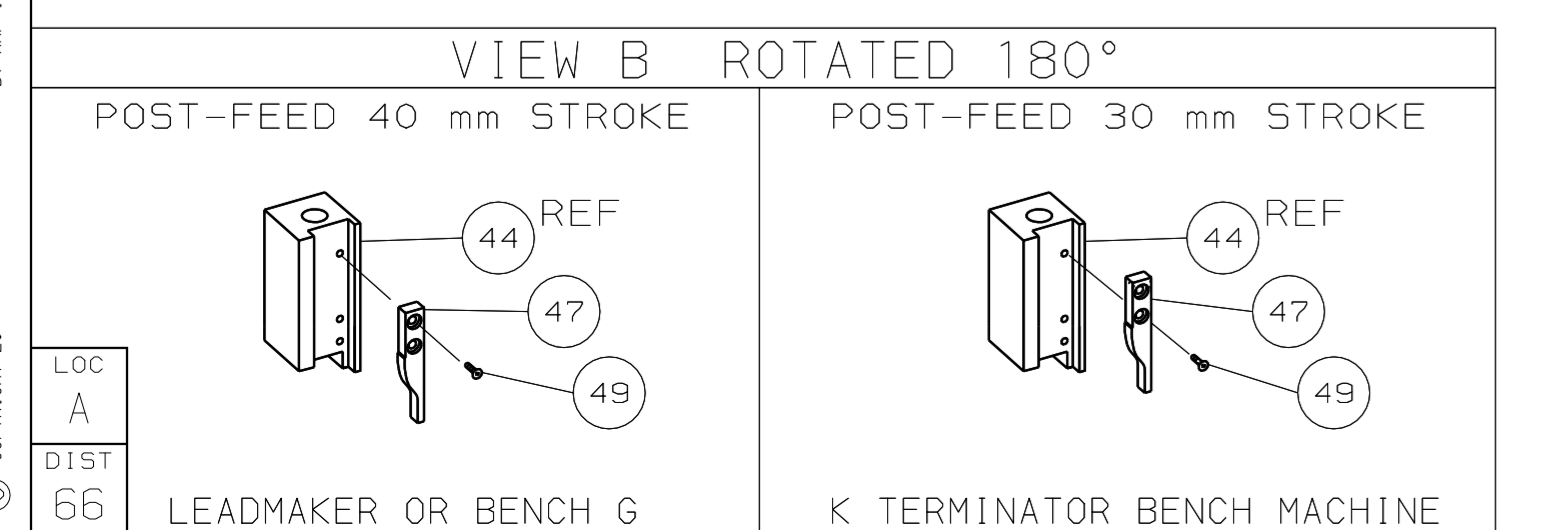

-	1	1	1339783	PRINT, APPLICATOR LOG SHEET	73	
-	1	1	1338705-2	DOCUMENTATION PACKAGE	72	
-					70	
-					68	
-	1	1	461264-1	PLATE, IDENTIFICATION	67	
-	2	2	21017-2	SCR,DRIVE (#2X.19) ID PLATE	66	
-					65	
-	1	1	986950-1	WASHER, FLAT PRECISION	64	
-	1	1	3-18031-0	SCR,SKT SET (M6X6) RAM	63	
-	1	1	18023-9	SCR,SKT CAP (M4X6) CP DSC	62	
-					61	
-	1	1	18024-7	SCR,BHC (M4X10) ANVIL	60	
-					59	
-					58	
-	6	6	18023-9	SCR,SHC (M4X6) STRIP GUIDE	57	
-	2	2	1-18023-4	SCR,SHC (M4X20) SLUG BLADE	56	
-					55	
-	2	2	18029-1	NUT, HEX (M3) DRAG	54	
-	2	2	986965-1	NUT, HEX SL (M4) DRAG STUD	53	
-	2	2	2-18032-2	SCR,SKT SET (M3X10) DRAG	52	
-					51	
-					50	
-	1	1	18024-3	SCR,BHC (M3X10) CAM	49	
-					48	
-	1	1	1338676-1	CAM, POST-FEED 30 & 40 mm ST	47	
-	1	1	1338662-1	APPLICATOR, BASIC (SUBASSY)	46	
-	1	1	690191-1	PLUG, NYLON	45	
-	1	1	1320998-1	RAM	44	
-	1	1	690125-1	WASHER, LAMINATED	43	
-	1	1	690124-1	WASHER, RAM	42	
-	1	1	2-18024-6	SCREW,BHC (M8X25) CRIMPER	41	
-	1	1	23241-1	BALL, STEEL	40	
-	1	1	2-22278-7	SPRING, COMPRESSION	39	
-	1	1	1320922-1	DISC, INSULATION	38	
-	1	1	354777-1	WIRE DISC, PLASTIC	37	
-	1	1	22480-5	WASHER, SPRING	36	
-	1	1	690212-1	POST, RAM	35	
-					34	
-					33	
-	8	8	18025-2	WASHER, LOCK (M4) SHEAR BL	32	
-	2	2	4-18024-7	SCR,BHC (M4X25) SHEAR PL	31	
-					30	
-	2	2	18024-8	SCR,BHC (M4X12) STRIPPER	29	
-	1	1	3-690451-2	SPACER, STRIPPER	28	
-	1	1	240639-1	STRIPPER	27	
-					26	
-	2	2	1320906-1	DRAG, STUD	25	
-	1	1	1320995-1	PLATE, STRIP GUIDE	24	
-					23	
-	2	2	4-22281-1	SPRING, DRAG	22	
-					21	
-	1	1	1338665-1	DRAG, STOCK	20	
-	2	2	1338664-1	GUIDE, UPPER STRIP	19	
-	2	2	1338663-2	GUIDE, LOWER STRIP	18	
-	4	4	1-18024-8	SCR,BHC (M6X12) STRIP GD PL	17	
-	1	1	1338708-1	SPACER, SLUG BLADE	16	
-					15	
-	1	1	1-240641-2	SPACER, SLUG BLADE	14	
-	1	1	1-690481-0	SPACER, HOLD DOWN	13	
-	1	1	23846-1	SPRING, HOLD DOWN	12	
-	1	1	240644-1	PLATE, REAR SHEAR	11	
-					10	
-	1	1	690482-4	PLATE, FRONT SHEAR	9	
-	1	2	1	2-1333218-2	ANVIL	8
-	1	1	690474-4	BLADE, SLUG	7	
-	1	1	6-455892-3	HOLD DOWN, TERMINAL	6	
-	1	1	2-240641-9	SPACER, SLUG BLADE	5	
-	1	1	238009-2	SPACER, BLOCK CRIMPER	4	
-	1	2	1	2-1424909-6	CRIMPER, INSULATION	3
-	1	1	455888-5	SPACER, CRIMPER	2	
-	1	2	1	2-456407-6	CRIMPER, WIRE	1
-	-77	-71	-1	PART NO	DESCRIPTION	ITEM NO

DIMENSIONS: mm [INCHES] MATL		HT TR		FIN	
DO NOT SCALE PRINT.					
TOLERANCES UNLESS OTHERWISE SPECIFIED:					
1 PLC DEC ±		2 PLC DEC ±		3 PLC DEC ±	
ANGLES ± -					
SURF TEXTURE: <input checked="" type="checkbox"/> REMOVE BURRS, BREAK SHARP EDGES RO.38 MAX					
CAGE CODE 00779			CUSTOMER AND ASSEMBLY DRAWING		

THIS DRAWING IS A CONTROLLED DOCUMENT.

LAYOUT L1339783  
SET UP GAGE 458638-3

RELEASED FOR PUBLICATION  
BY AMP INCORPORATED. ALL RIGHTS RESERVED.

301339783-1

D

C

B

A