

LOC	DIST	REVISIONS					
		P	LTN	DESCRIPTION	DATE	DWN	APVD
CE	16	F		REV: ECO-13-008210	20MAY2013	GG	TE
		G		REV: ECO-13-008637	22MAY2013	GG	TE
		J		ECR-19-019013	11MAR2020	JL	RS

- NOTES:
1. MOUNTS IN 1.75mm BULKHEAD.
 2. (OPTIONAL) USE #2 SCREWS AND NUTS (NOT PROVIDED).
 3. MEETS THE ADAPTER INTERFACE DIMENSIONS AS SPECIFIED IN IEC 61754-7.
 4. COLOR: BLACK
- △ BULK PACK 50 PCS.

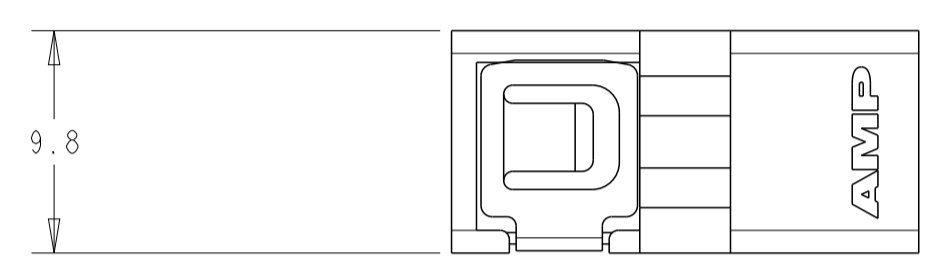

RECOMMENDED PANEL CUT-OUT

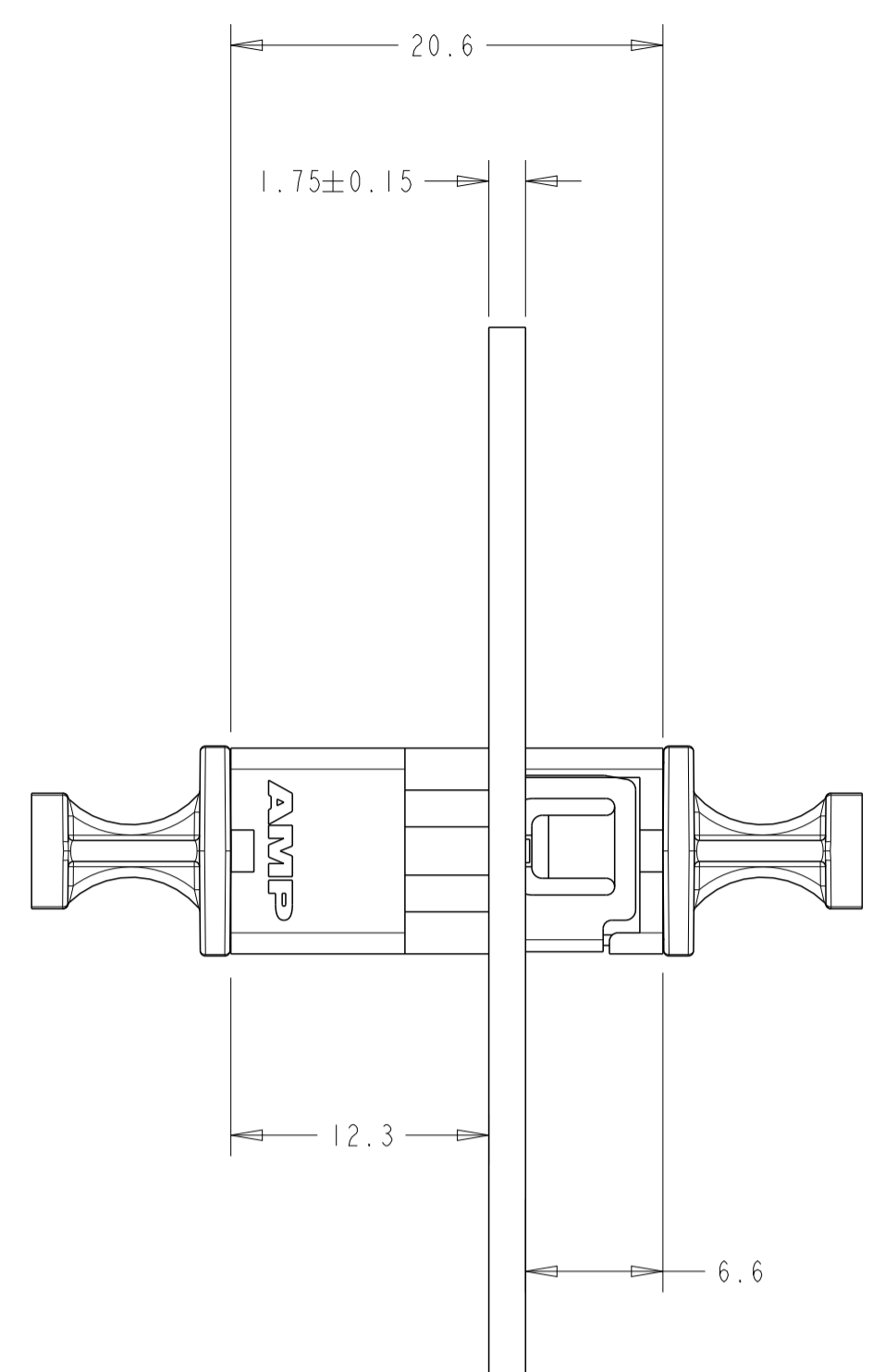
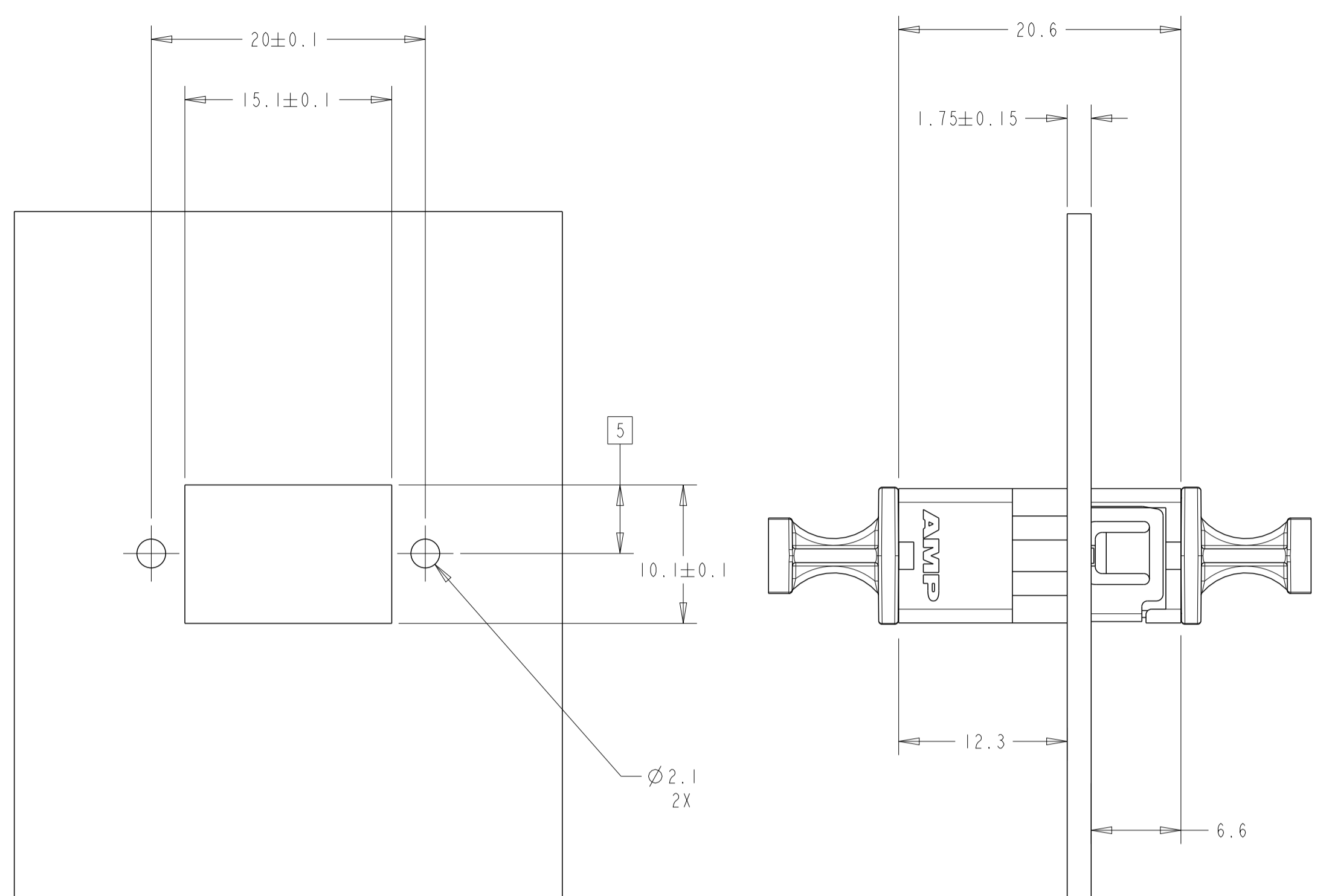
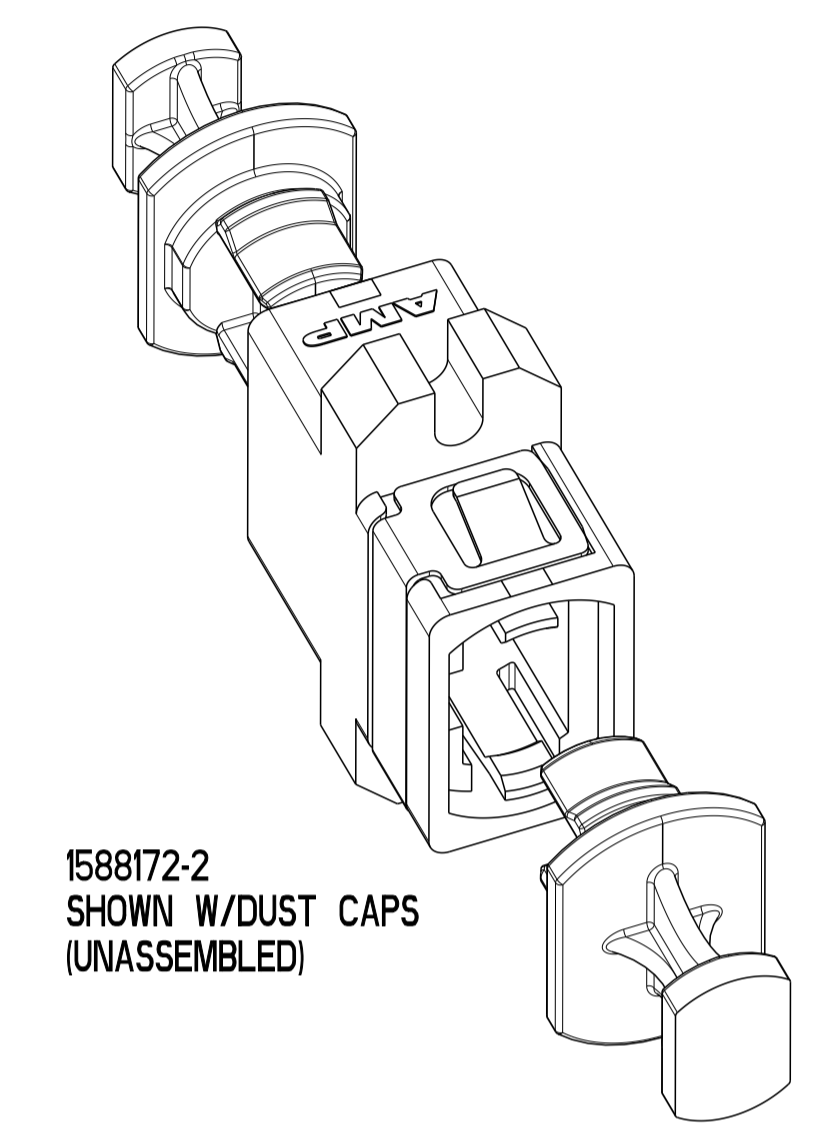
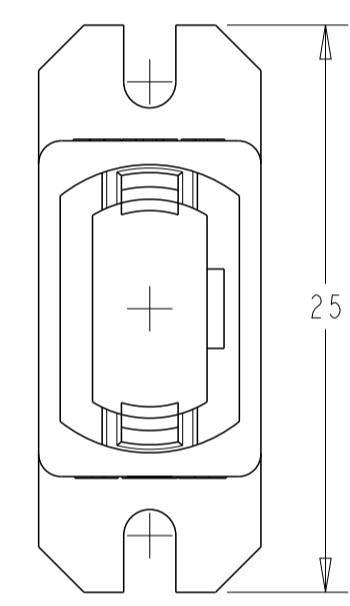
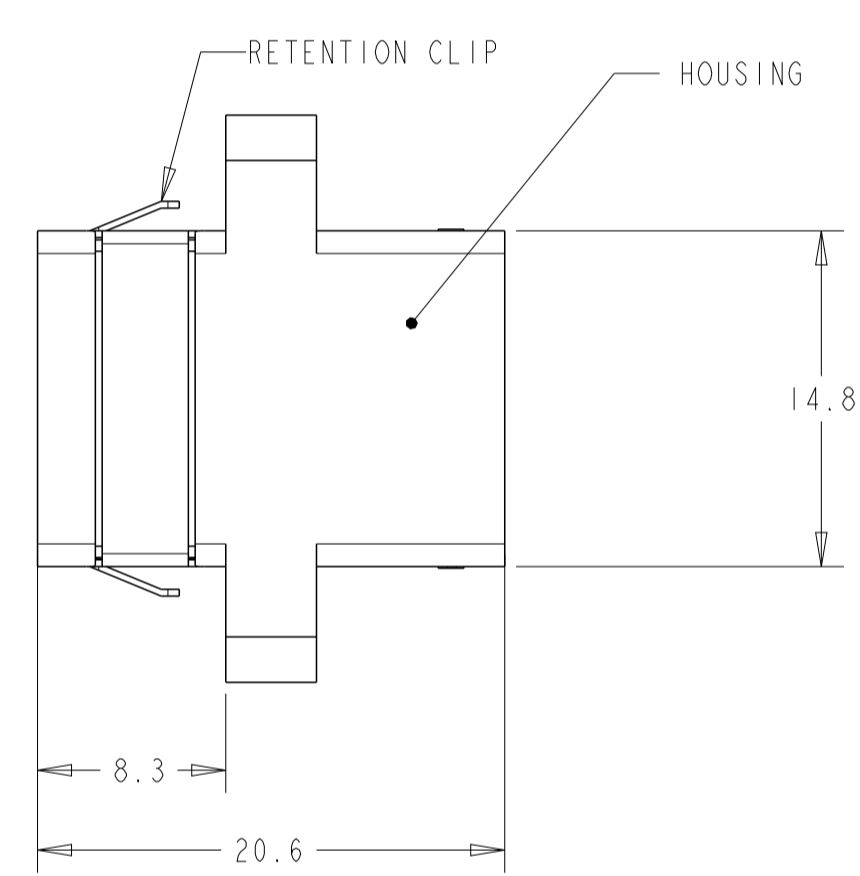
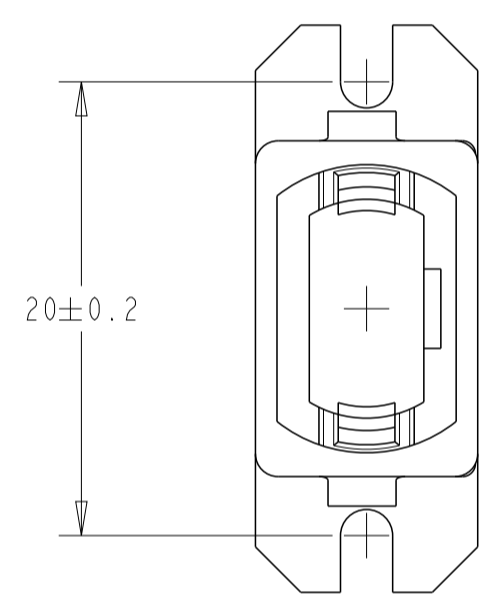

1588172-2
SHOWN W/DUST CAPS
(UNASSEMBLED)

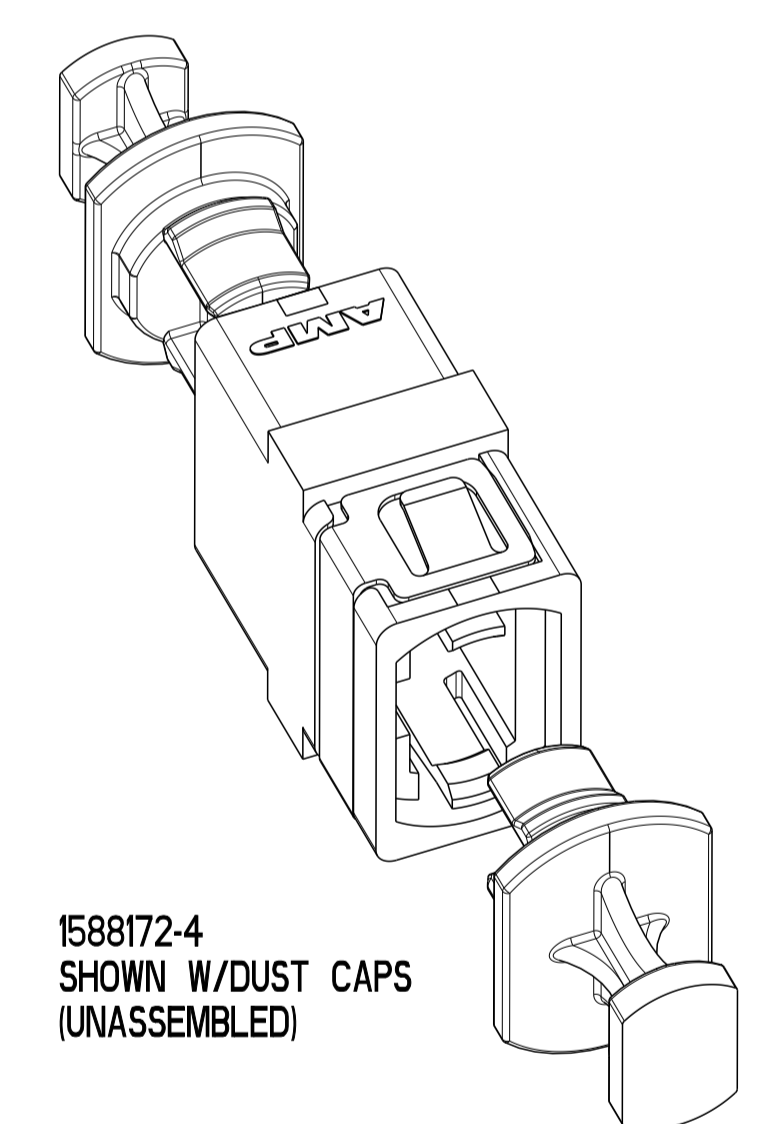

1588172-4
SHOWN W/DUST CAPS
(UNASSEMBLED)

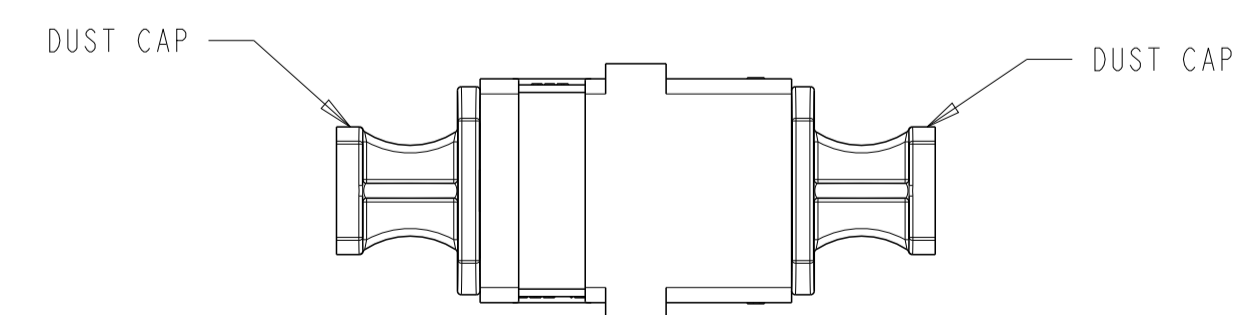

1588172-3
(WITHOUT FLANGE)
SHOWN W/DUST CAPS
ASSEMBLED

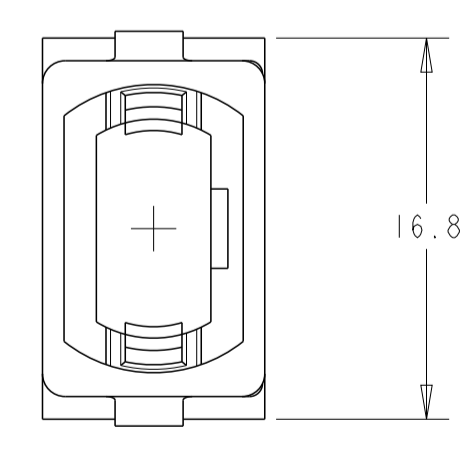

1588172-3
(WITHOUT FLANGE)
1588172-4
(WITHOUT FLANGE)
(WITH CLIP)

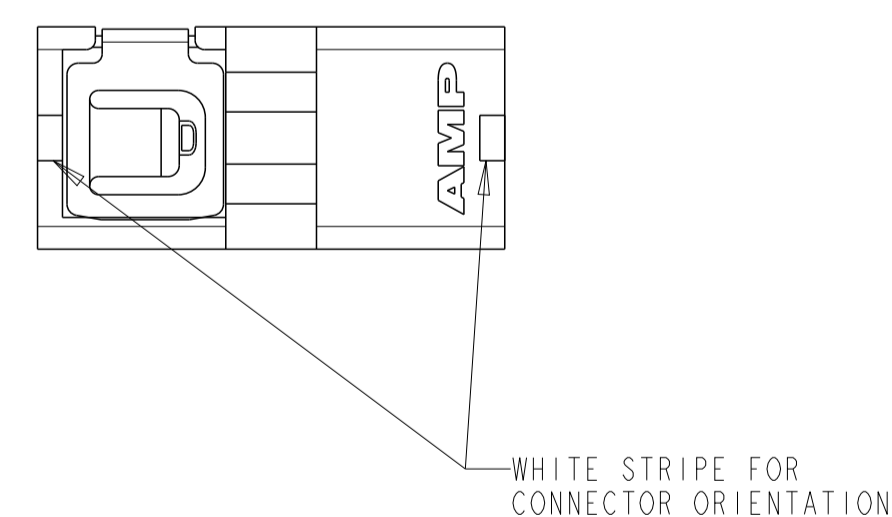

△ 5	MPO ADAPTER W/O FLANGE	1-1588172-1
	MPO ADAPTER W/FLANGE	1-1588172-0
	MPO ADAPTER W/FLANGE, AND CLIP	1588172-9
△ 5	MPO ADAPTER W/O FLANGE W/ CLIP	1588172-8
△ 5	MPO ADAPTER W/O FLANGE	1588172-7
△ 5	MPO ADAPTER W/ FLANGE AND CLIP	1588172-6
△ 5	MPO ADAPTER W/ FLANGE	1588172-5
	MPO ADAPTER W/O FLANGE AND W/CLIP	1588172-4
	MPO ADAPTER W/ FLANGE	1588172-3
	MPO ADAPTER W/FLANGE, AND CLIP	1588172-2
	MPO ADAPTER W/FLANGE	1588172-1

DIMENSIONS:		TOLERANCES UNLESS OTHERWISE SPECIFIED:		MATERIAL:		FINISH:		WEIGHT:		CUSTOMER DRAWING:	
mm	0 PLC	±									
	1 PLC	±	0.1								
	2 PLC	±	0.05								
	3 PLC	±									
	4 PLC	±									
	ANGLES										

THIS DRAWING IS A CONTROLLED DOCUMENT.	DWN LG_EBY 06DEC2001	NAME	
CHK D.ROHDE 06DEC2001	APVD F.ABENDSCHEIN 06DEC2001	MPO ADAPTER ASSY, RETENTION CLIP AND PANEL ASSY.	
SIZE		CAGE CODE	DRAWING NO
A1		00779	1588172
SCALE		NTS	SHEET 1 OF 1
REV		J	