

2x Ø1.96 x 9.0 DP  
FOR ANSI SIZE #2 SCREWS  
TORQUE: 2.1-3.1 IN-LB [0.24-0.35 NM]

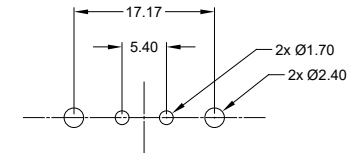

RECOMMENDED PCB LAYOUT

NOTES: UNLESS OTHERWISE SPECIFIED

1. MATERIAL:  
HOUSING: THERMOPLASTIC; COLOR: BLACK  
CONTACT: COPPER ALLOY  
PLATING: NICKEL UNDERPLATE  
SEE CHART FOR OVERALL FINISH
2. MODIFICATIONS: RIGHT ANGLE PCB MOUNT, SCREW BOSS
3. SPECIFICATIONS:  
3.1 CURRENT RATING: 13 AMPS  
3.2 OPERATING TEMPERATURE: -55°C TO +125°C  
3.3 DIELECTRIC WITHSTANDING VOLTAGE: LESS THAN 2 MILLIAMPS CURRENT LEAKAGE @ 1500 VOLTS AC.  
3.4 INSULATION RESISTANCE: 1000 MEGOHMS MIN @ 25°C.  
3.5 MOISTURE RESISTANCE: IP67 ( MATED CONDITION )  
3.6 MATING CYCLE DURABILITY: 100 CYCLES  
3.7 RoHS COMPLIANT
4. MATING PART: AT06-2S\* PLUG  
(\* = MODIFICATIONS AND COLORS )
5. ALL DIMENSIONS ARE FOR REFERENCE USE ONLY.

| ATF13-2P-BM1X VARIANTS |               |
|------------------------|---------------|
| CONTACT PLATING        | PART NUMBER   |
| GOLD                   | ATF13-2P-BM11 |
| TIN                    | ATF13-2P-BM13 |

| REVISIONS |     |                      |           |       |       |
|-----------|-----|----------------------|-----------|-------|-------|
| REV       | ECO | DESCRIPTION          | DATE      | BY    | APPR  |
| A1        | -   | RELEASE              | 02JUL2018 | JAH   |       |
| A2        | -   | UPDATE DRAWING       | 25/MAR/19 | BROOK | TOMMY |
| A3        | -   | MODIFIED DESCRIPTION | 12JUL19   | BROOK | TOMMY |

|  |                |   |                               |
|--|----------------|---|-------------------------------|
| SEE PART NUMBER CHART  |                | REF: DTF13-2P   |                               |
| PART NUMBER  |                | DESCRIPTION   |                               |
| QUANTITY   | MATERIALS LIST |   |                               |
| UNLESS OTHERWISE SPECIFIED:<br>1) All dimensions are in metric (mm).<br>2) Tolerances are as follows:<br>1 PL DEC ±0.30<br>2 PL DEC ±0.15<br>3 PL DEC ±0.08<br>Fractions ±1/64<br>Angles ±1°   |                | SIGNATURES  | DATE                          |
| 3) Note reference =  |                | DRAWN: BROOKING   | 12/JUL/19                     |
| MATERIAL SPECIFICATIONS:   |                | CHECKED: ORION LI   | 12/JUL/19                     |
| PROCESS SPECIFICATIONS:  |                | ENGINEER:   | APPROVAL: TOMMY XIE 12/JUL/19 |
| NEXT ASSY:   |                | CUSTOMER:   |                               |
| THIS DRAWING IS SUPPLIED FOR INFORMATION ONLY. DESIGN FEATURES, SPECIFICATIONS AND PERFORMANCE DATA SHOWN HEREON ARE THE PROPERTY OF THE AMPHENOL CORPORATION. NO RIGHTS OF REPRODUCTION ARE IMPLIED. ALL DIMENSIONS ARE SUBJECT TO NORMAL MANUFACTURING VARIATIONS. |                | <p style="text-align: center;"><b>Amphenol</b></p> <p style="text-align: center;">Sine Systems - www.amphenol-sine.com<br/>44724 Morley Drive<br/>Clinton Township, MI 48036</p> <p style="text-align: center;">RIGHT ANGLE RECEPTACLE, AT 2 PIN,<br/>SCREW BOSS, BOARDLOCK</p> |                               |
| SIZE: <b>B</b>   | TYPE: <b>C</b> | DWG NO: ATF13-2P-BM1X   | REVISION: <b>A3</b>           |
| SCALE: NONE  | SHEET 1 OF 1   |   |                               |

TITLE: RIGHT ANGLE RECEPT, AT 2 PIN, SCREW BOSS BOARDLOCK  
DWG NO: ATF13-2P-BM1X  
REV: A3  
SH: 1  
OF: 1