

- 1
- 2
- 3
- 4
- 5
- 6
- 7
- 8
- 9
- 10
- 11
- 12
- 13
- 14
- 15
- 16
- 17
- 18

MATERIAL

Round cross section aluminium bar, epoxy resin coating, glossy finish.

COLOUR

RAL 9002 white.

STANDARD EXECUTION

Threaded blind holes.

FEATURES AND APPLICATIONS

This handle, of white colour, has been conceived for applications on medical and hospital equipment and on food processing machines whose parts, for hygienic reasons, must be frequently cleaned. Its solid shape without cavities prevents unhealthy residues from depositing. Its glossy surface allows a perfect cleaning.

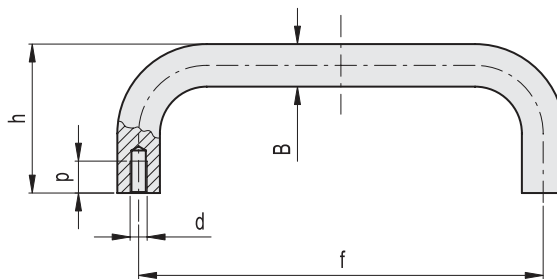

Conversion Table
1 mm = 0.039 inch

mm	inch
200	7.84
250	9.84
300	11.81
350	13.78
400	15.75

METRIC

Code	f	d	p	B	h	△
RHM1-20.R200.9002	200	M8	15	20	70	249
RHM1-20.R250.9002	250	M8	15	20	70	275
RHM1-20.R300.9002	300	M8	15	20	70	335
RHM1-20.R350.9002	350	M8	15	20	70	381
RHM1-20.R400.9002	400	M8	15	20	70	416
RHM1-25.R300.9002	300	M8	15	25	85	534
RHM1-25.R400.9002	400	M8	15	25	85	666
RHM1-30.R300.9002	300	M10	15	30	100	802
RHM1-30.R400.9002	400	M10	15	30	100	974

Lift & Pull handles