

This document is the property of Amphenol Corporation and is delivered on the express condition that it is not to be disclosed, reproduced or used, in whole or in part, for manufacture or sale by anyone other than Amphenol Corporation without its prior consent, & that no right is granted to disclose or to use any information in this document.

CUSTOMER DRAWING

REVISIONS				
SYM	ECN	DESCRIPTION	DATE	APPROVED
3	CD2541	UPDATE THE STANDOFF	Mar.25,2021	YH
4	CD2569	ADD THE SOFT TRAY PACKING	Apr.12,2021	YH
5	CD2815	UP DATE THE HARD TRAY	Aug.19,2021	YH

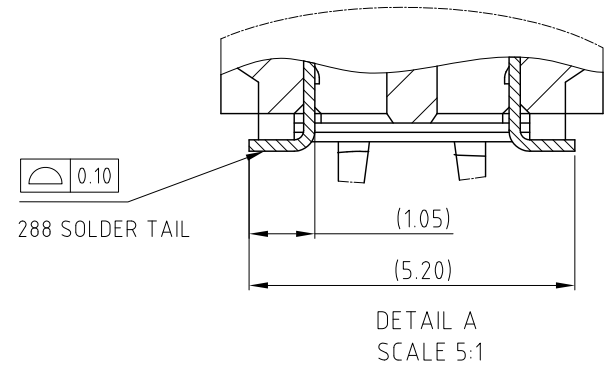
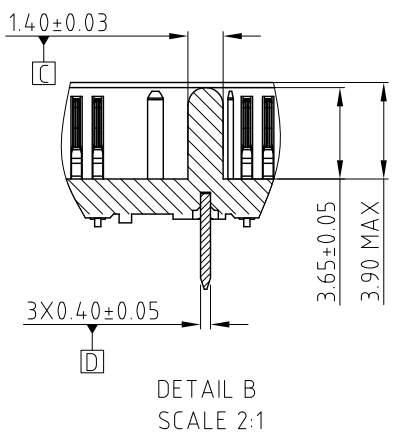
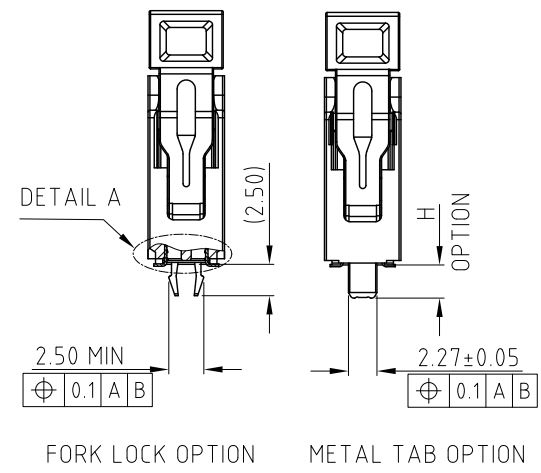
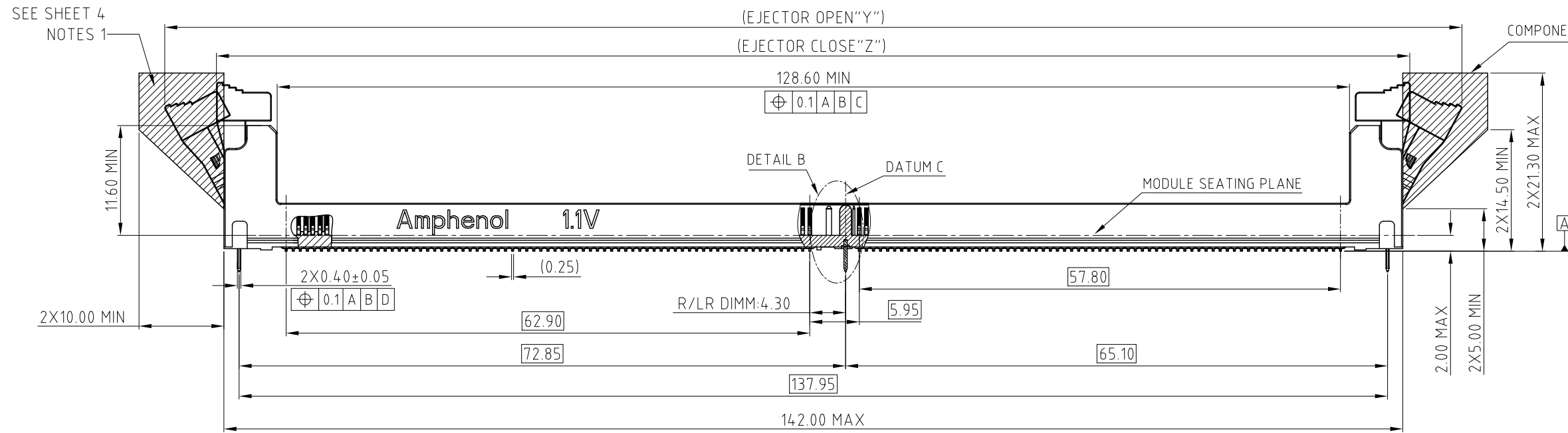
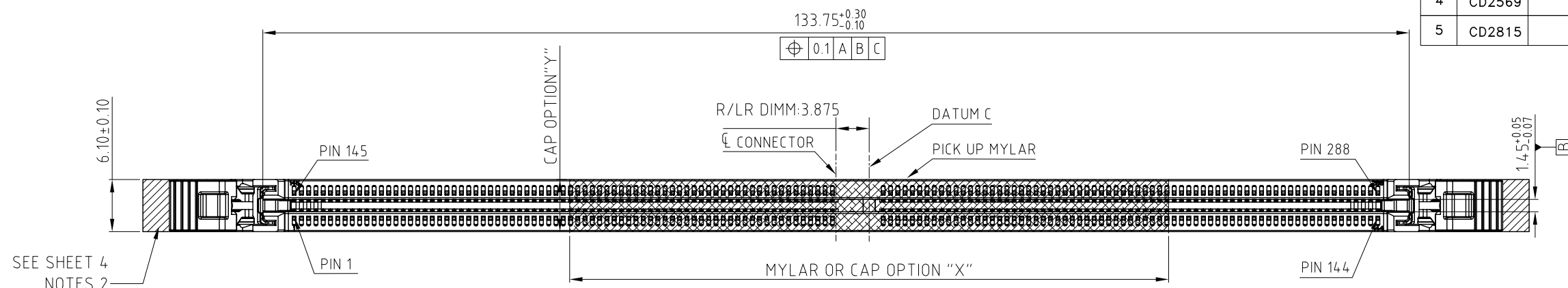

ITEM	EJECTOR OPEN DIMENSION "Y"	EJECTOR CLOSE DIMENSION "Z"	EJECTOR FIGURE
STANDARD LATCH	156.00	144.00	

UNLESS OTHERWISE SPECIFIED TOLERANCES		APPROVAL	DATE	Amphenol
.X	+/- 0.35	DRAWN	Kellan.Yang Aug.19,2021	
.XX	+/- 0.25	CHECKED		TITLE DDR5 288P R/LR DIMM CONNECTOR
.XXX	+/- 0.15	CHECKED		
FRACTIONS +/- 3'		DRAWING FILE : DRAWING\DDR\DDR504XXXXXXH		SIZE
FOR MATERIALS AND FINISHES SEE NOTES		REMOVE SHARP EDGES		DRAWING NO.
DIMENSIONS		ANGLE OF PROJECTION		REV.
U.S.	INCHES			A3 C
(METRIC)	(MM)			SCALE

This document is the property of Amphenol Corporation and is delivered on the express condition that it is not to be disclosed, reproduced or used, in whole or in part, for manufacture or sale by anyone other than Amphenol Corporation without its prior consent, & that no right is granted to disclose or to use any information in this document.

CUSTOMER DRAWING

REVISIONS				
SYM	ECN	DESCRIPTION	DATE	APPROVED
		SEE SHEET 1		

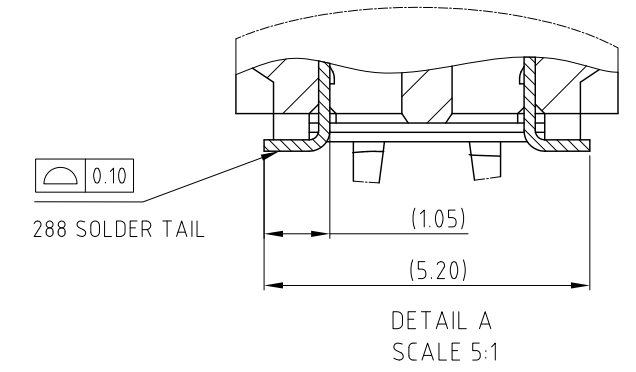
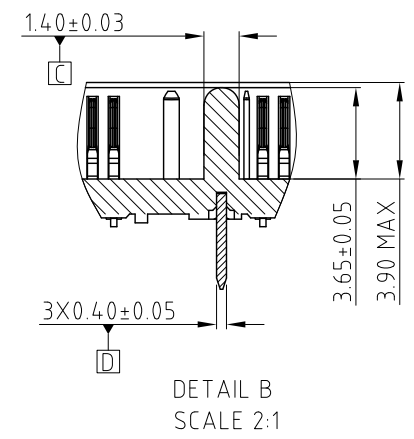
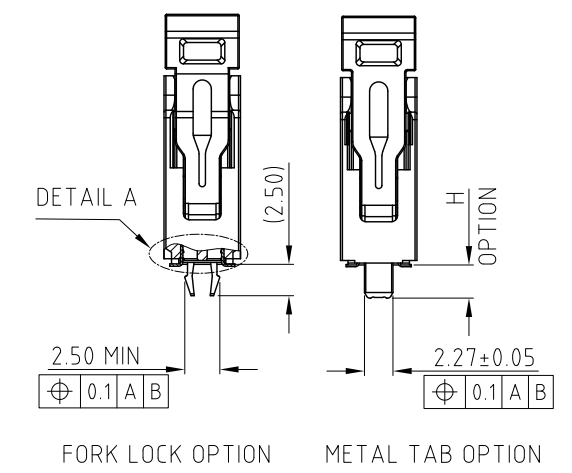
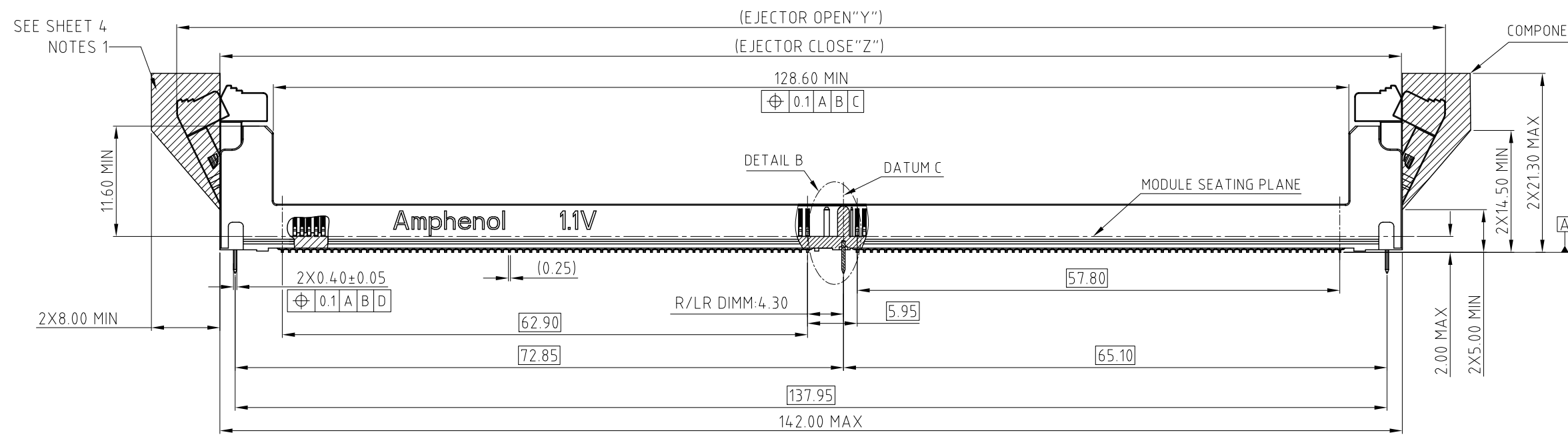
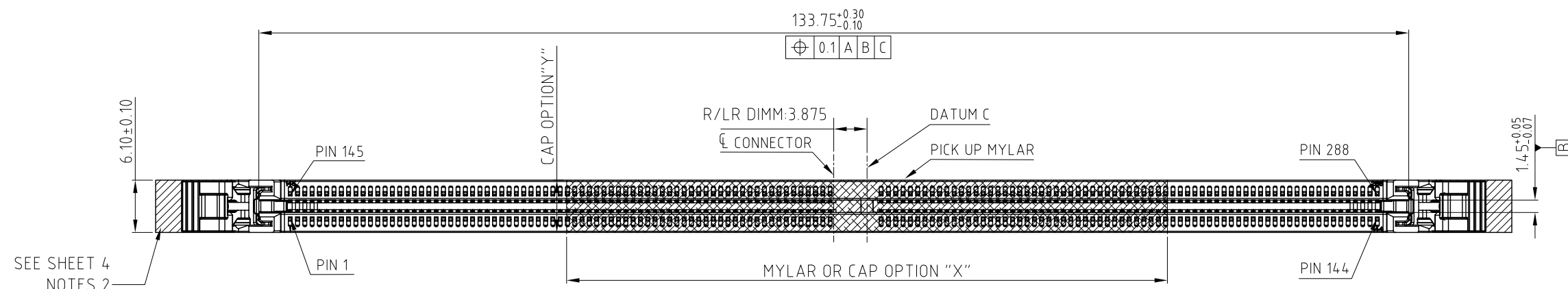

ITEM	EJECTOR OPEN DIMENSION "Y"	EJECTOR CLOSE DIMENSION "Z"	EJECTOR FIGURE
SHORT LATCH	152.00	142.00	

UNLESS OTHERWISE SPECIFIED TOLERANCES		APPROVAL	DATE	Amphenol
.X	+/-	0.35		
.XX	+/-	0.25		
.XXX	+/-	0.15		
FRACTIONS +/-				
ANGLES +/-		3°		
FOR MATERIALS AND FINISHES SEE NOTES		DRAWING FILE : DRAWING\DDR\DDR504XXXXXXH		TITLE
REMOVE SHARP EDGES				DDR5 288P R/LR DIMM CONNECTOR
DIMENSIONS		ANGLE OF PROJECTION		SIZE
U.S.	INCHES			DRAWING NO.
(METRIC)	(MM)			A3 C DDR5-04-X-X-X-XXX-X-H
				SCALE
				NONE
				SHEET 2 OF 7
				REV.
				5

This document is the property of Amphenol Corporation and is delivered on the express condition that it is not to be disclosed, reproduced or used, in whole or in part, for manufacture or sale by anyone other than Amphenol Corporation without its prior consent, & that no right is granted to disclose or to use any information in this document.

CUSTOMER DRAWING



REVISIONS				
SYM	ECN	DESCRIPTION	DATE	APPROVED
		SEE SHEET 1		

DDR5 MODULE  
MORE INFORMATION REFER TO JEDEC MO-329

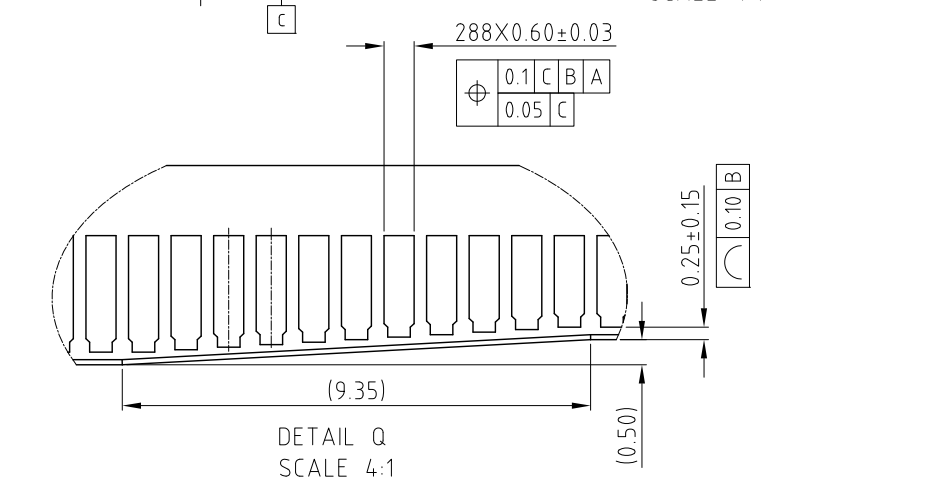
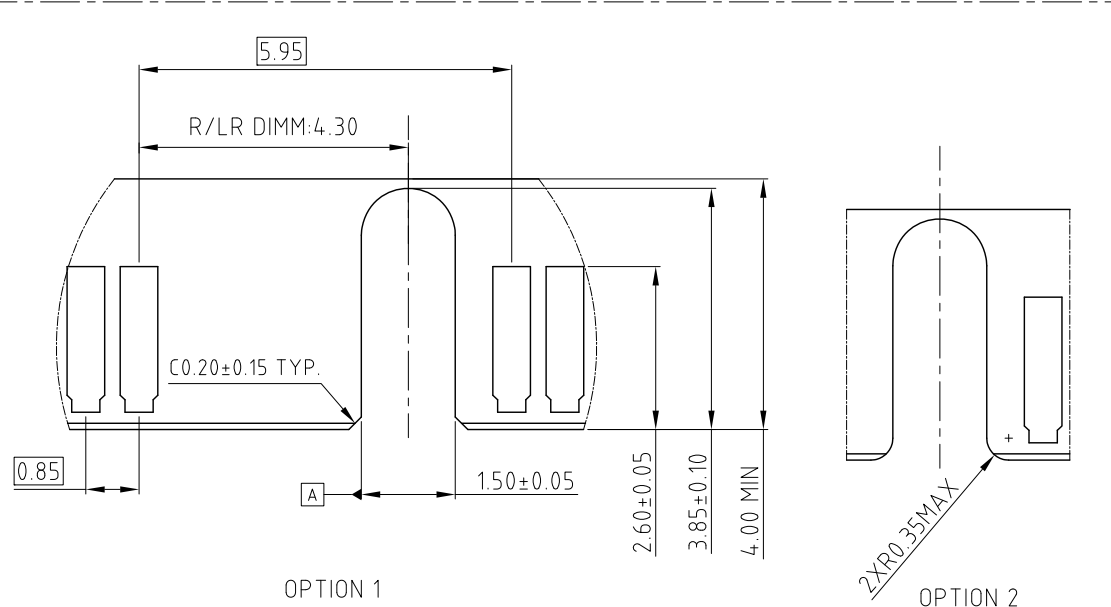
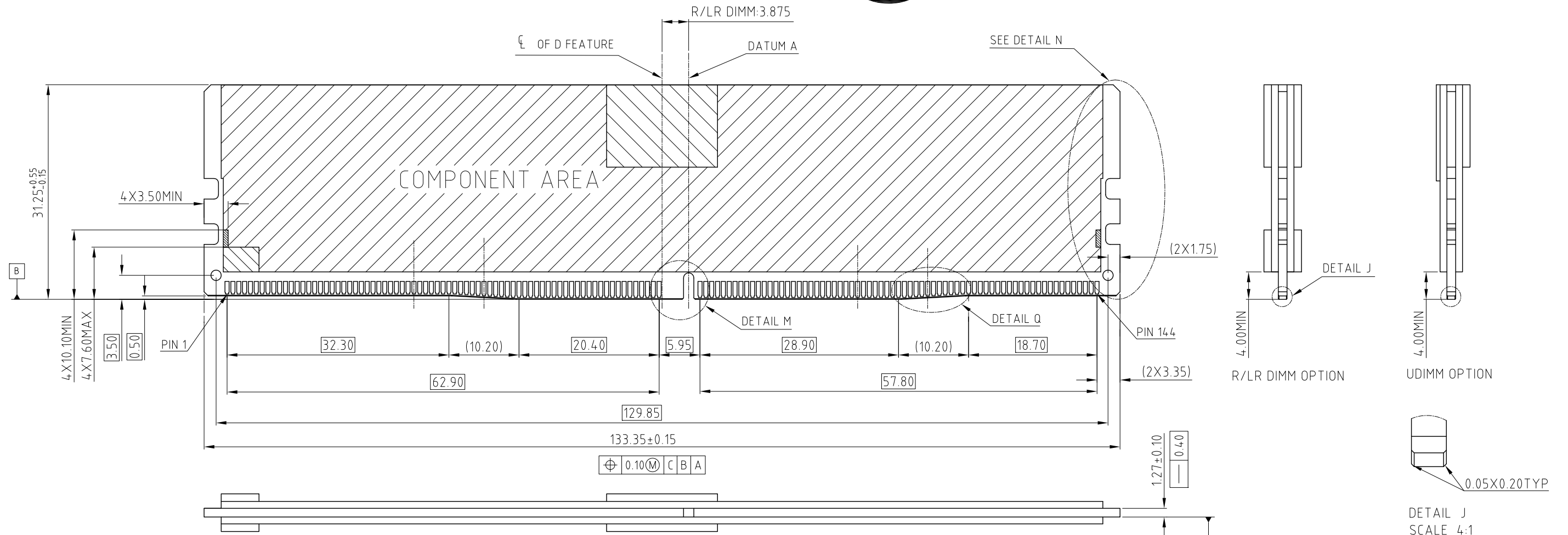

UNLESS OTHERWISE SPECIFIED TOLERANCES		APPROVAL	DATE	Amphenol
U.S.	METRIC	DRAWN	Aug. 19, 2021	
.X +/-	0.35	Kellen.Yang		TITLE DDR5 288P R/LR DIMM CONNECTOR
.XX +/-	0.25	CHECKED		
.XXX +/-	0.15	CHECKED		DRAWING FILE : DRAWING\DDR\DDR504XXXXXXH
FRACTIONS +/-	3°			
ANGLES +/-				ANGLE OF PROJECTION 
FOR MATERIALS AND FINISHES SEE NOTES				
REMOVE SHARP EDGES				DRAWING NO. DDR5-04-X-X-X-XXX-X-H
DIMENSIONS				
U.S.	INCHES			SCALE NONE
(METRIC)	(MM)			

This document is the property of Amphenol Corporation and is delivered on the express condition that it is not to be disclosed, reproduced or used, in whole or in part, for manufacture or sale by anyone other than Amphenol Corporation without its prior consent, & that no right is granted to disclose or to use any information in this document.



CUSTOMER DRAWING

REVISIONS				
SYM	ECN	DESCRIPTION	DATE	APPROVED
		SEE SHEET 1		

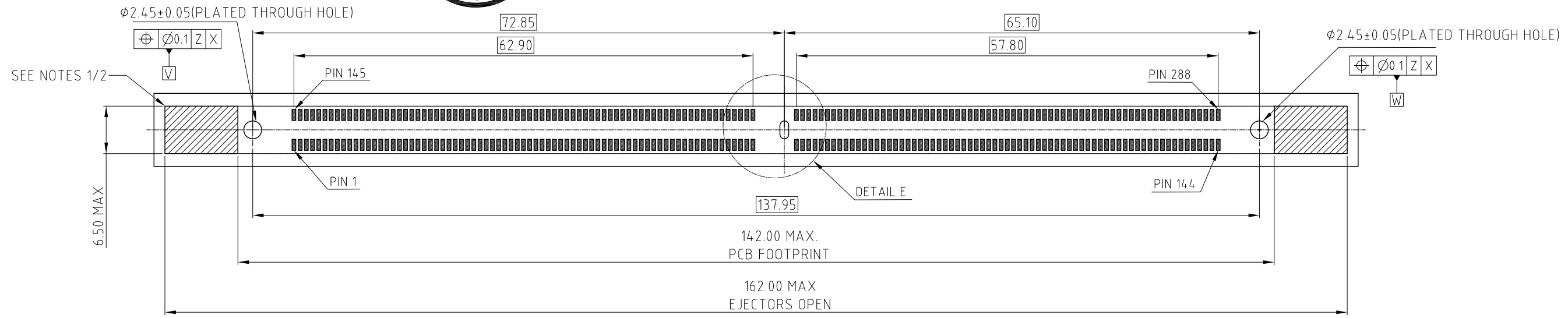

RECOMMENDED PCB FOOTPRINT (OPTION 1)

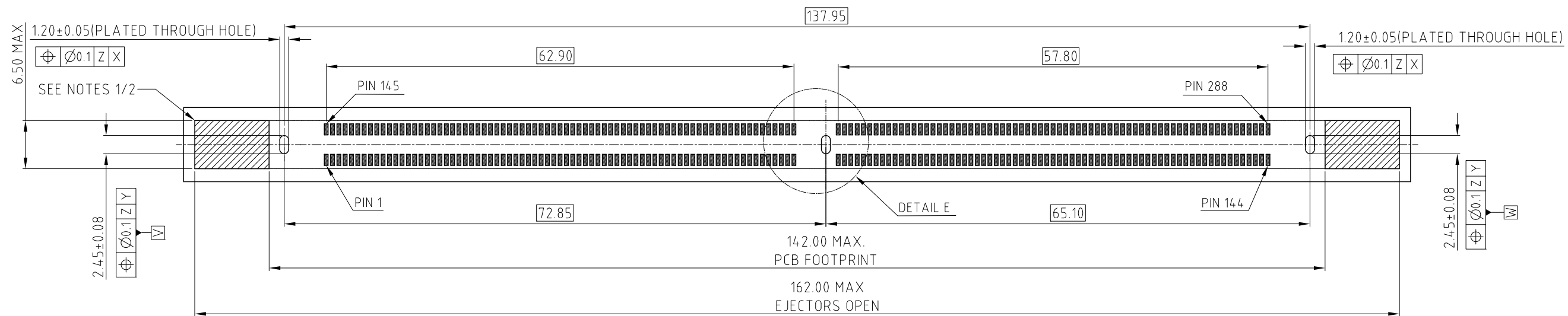

RECOMMENDED PCB FOOTPRINT (OPTION 2)

ADDITIONAL NOTES:

- KEEP OUT CROSS HATCH IS RESERVED FOR SOCKET EJECTORS AT BOTH ENDS.
- KEEP OUT ZONE IS HEIGHT LIMITED PER NOTE 1.
- RECOMMENDED STENCIL THICKNESS:

REFLOW CONDITION	THICKNESS OF STENCIL
AIR	0.18MM MIN
NITROGEN	0.18MM MIN
REWORK	0.20MM MIN

RECOMMENDED PCB LAYOUT  
MORE INFORMATION REFER TO JEDEC SO-023

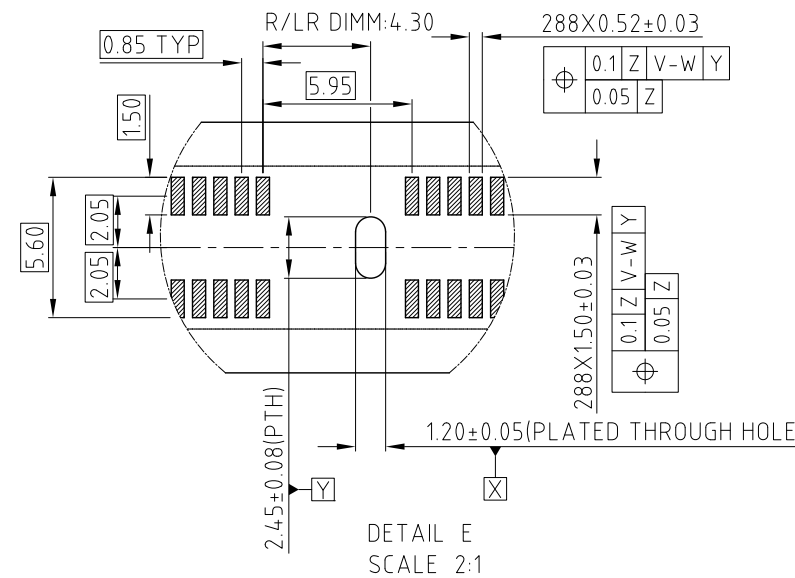

DETAIL E  
SCALE 2:1

UNLESS OTHERWISE SPECIFIED TOLERANCES		APPROVAL	DATE	Amphenol
U.S.	METRIC	DRAWN	Kellen.Yang	
.X	+/-			
.XX	+/-			
.XXX	+/-			
FRACTIONS	+/-			
ANGLES	+/-			3°
FOR MATERIALS AND FINISHES SEE NOTES		DRAWING FILE : DRAWING\DDR\DDR504XXXXXXH		TITLE DDR5 288P R/LR DIMM CONNECTOR
REMOVE SHARP EDGES		ANGLE OF PROJECTION		SIZE A3 C
DIMENSIONS				DRAWING NO. DDR5-04-X-X-X-XXX-X-H
U.S.	INCHES			REV. 5
(METRIC)	(MM)			SCALE NONE
				SHEET 4 OF 7

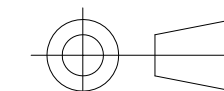

1.60-3.2  
PCB THICKNESS

This document is the property of Amphenol Corporation and is delivered on the express condition that it is not to be disclosed, reproduced or used, in whole or in part, for manufacture or sale by anyone other than Amphenol Corporation without its prior consent, & that no right is granted to disclose or to use any information in this document.

CUSTOMER DRAWING



REVISIONS				
SYM	ECN	DESCRIPTION	DATE	APPROVED
		SEE SHEET1		

PACKING HARD TRAY DRAWING

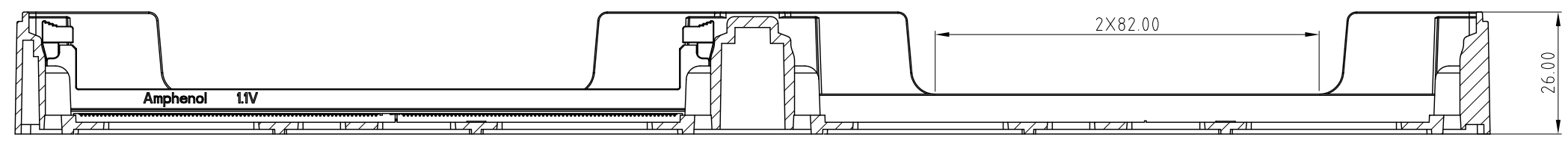
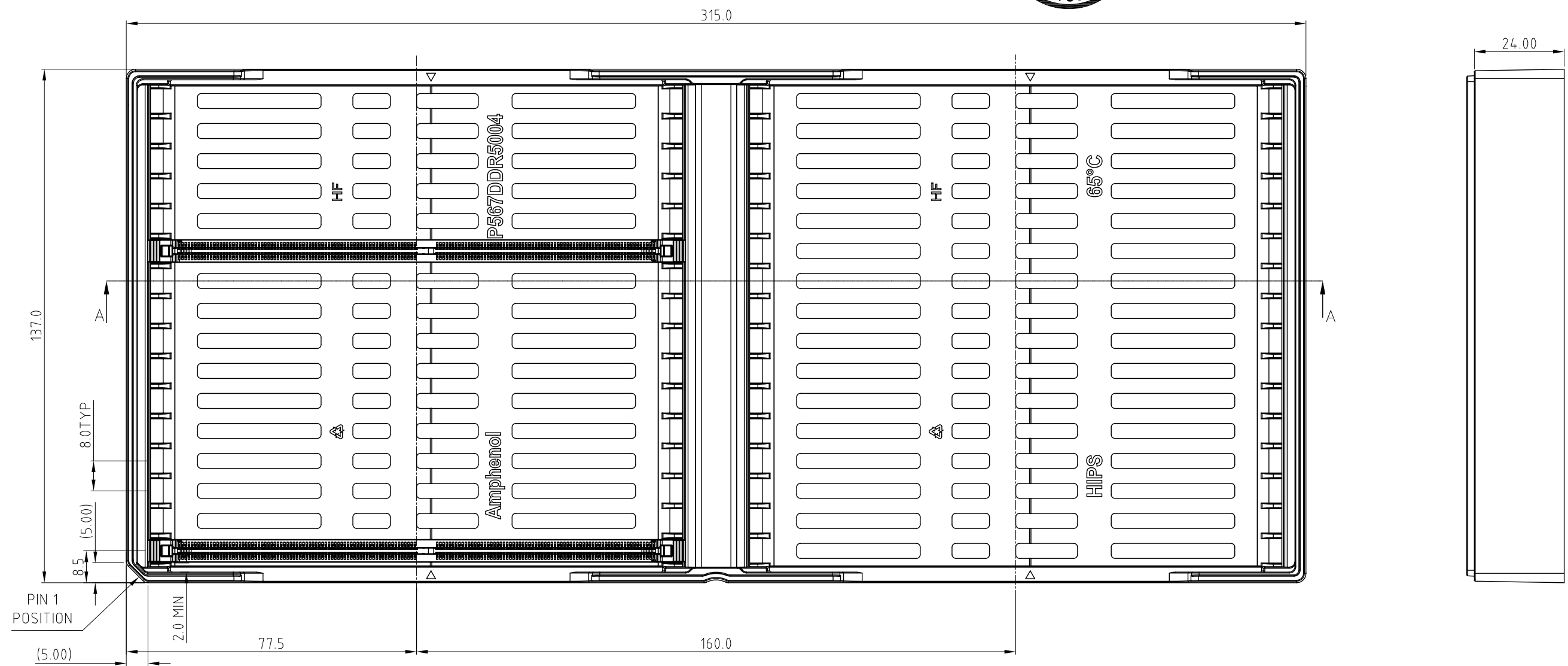

SECTION A-A

- NOTES:  
 1. MATERIAL: HIPS, BLACK  
 2. QUANTITY: 32PCS/TRAY

UNLESS OTHERWISE SPECIFIED TOLERANCES

	U.S.	METRIC
.X +/-		0.35
.XX +/-		0.25
.XXX +/-		0.15
FRACTIONS +/-		
ANGLES +/-		3°

FOR MATERIALS AND FINISHES SEE NOTES

REMOVE SHARP EDGES

DIMENSIONS

U.S.	INCHES
(METRIC)	(MM)

APPROVAL		DATE
DRAWN	Kellen.Yang	Aug.19,2021
CHECKED		
CHECKED		

DRAWING FILE :  
DRAWING\DDR\DDR504XXXXXXH

ANGLE OF PROJECTION

Amphenol		
TITLE DDR5 288P R/LR DIMM CONNECTOR		
SIZE	DRAWING NO.	REV.
A3	C DDR5-04-X-X-X-XXX-X-H	5
SCALE	NONE	SHEET 5 OF 7

This document is the property of Amphenol Corporation and is delivered on the express condition that it is not to be disclosed, reproduced or used, in whole or in part, for manufacture or sale by anyone other than Amphenol Corporation without its prior consent, & that no right is granted to disclose or to use any information in this document.

CUSTOMER DRAWING



REVISIONS				
SYM	ECN	DESCRIPTION	DATE	APPROVED
		SEE SHEET1		

PACKING SOFT TRAY DRAWING

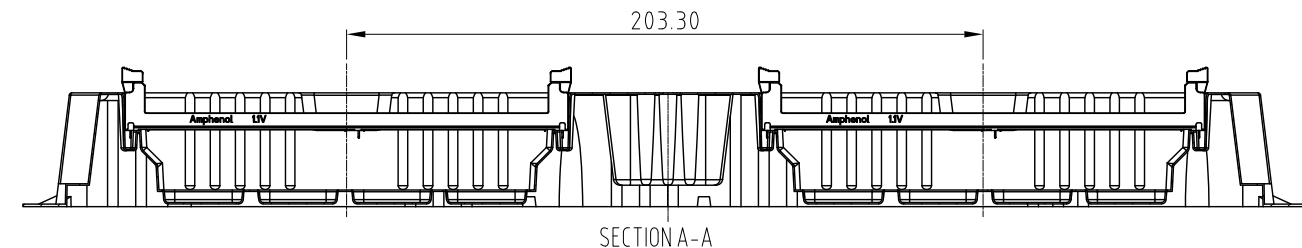
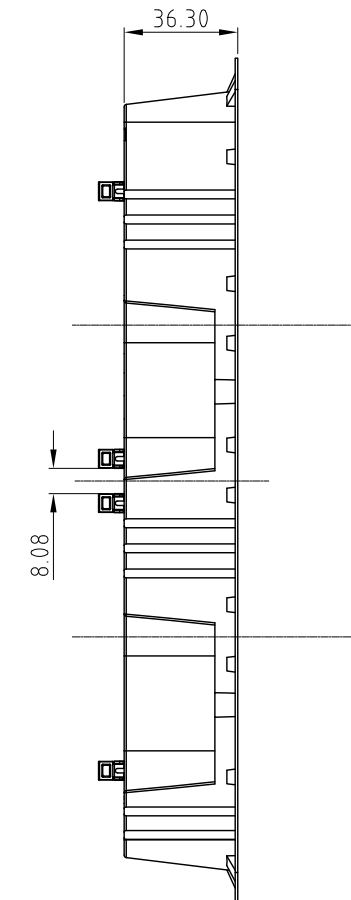
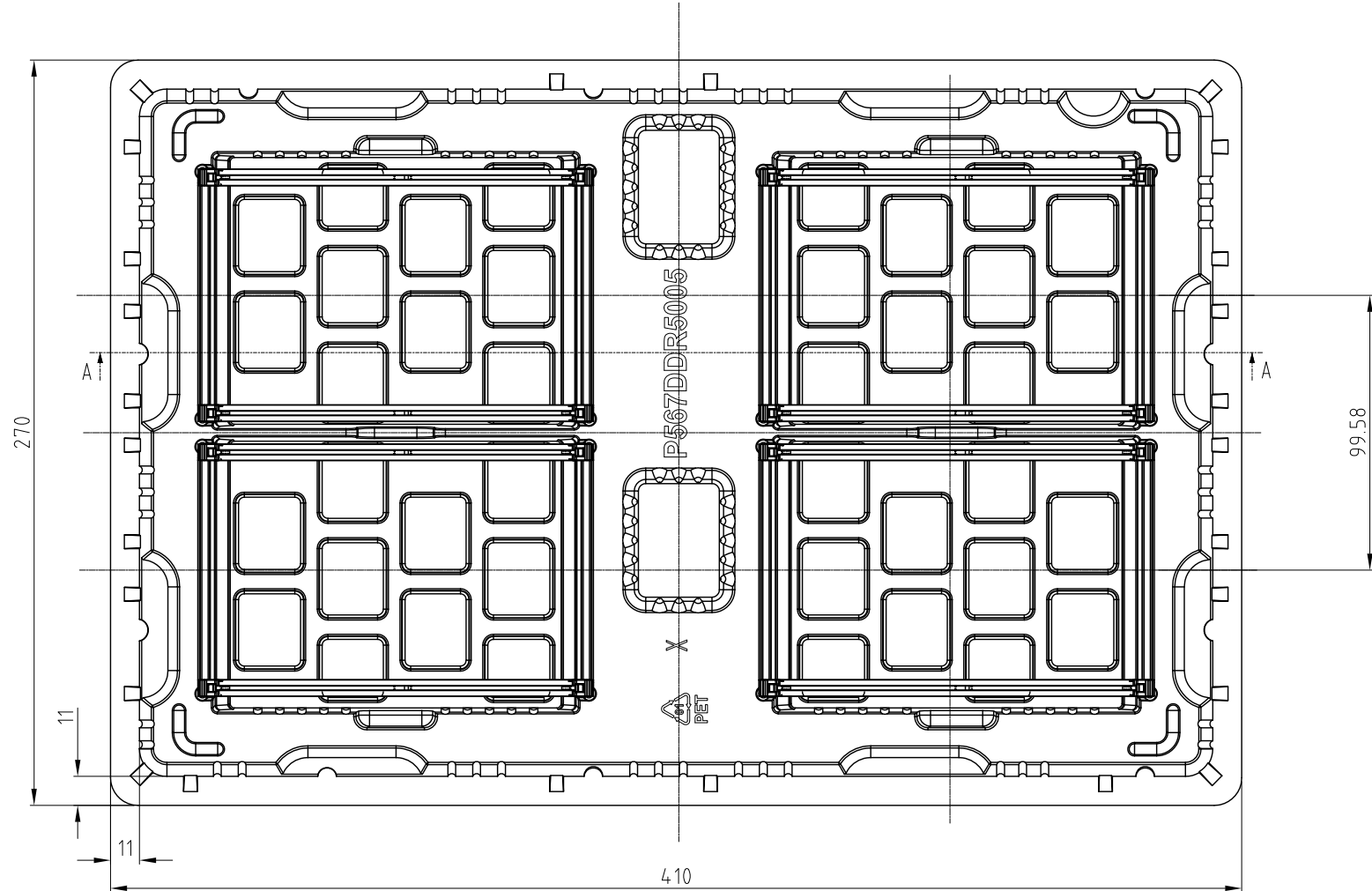

- NOTES:  
 1. MATERIAL: PET TRANSPARENT  
 2. QUANTITY: 60PCS/TRAY

UNLESS OTHERWISE SPECIFIED TOLERANCES		APPROVAL	DATE	Amphenol			
.X	+/- 0.35	DRAWN	Kellen.Yang			Aug.19,2021	
.XX	+/- 0.25	CHECKED			TITLE DDR5 288P R/LR DIMM CONNECTOR		
.XXX	+/- 0.15	CHECKED					
FRACTIONS +/-		DRAWING FILE : DRAWING\DDR\DDR504XXXXXXH			SIZE	DRAWING NO.	REV.
ANGLES +/- 3°		FOR MATERIALS AND FINISHES SEE NOTES			A3	C DDR5-04-X-X-X-XXX-X-H	5
REMOVE SHARP EDGES		ANGLE OF PROJECTION			SCALE	NONE	SHEET 6 OF 7
DIMENSIONS							
U.S.	INCHES						
(METRIC)	(MM)						

This document is the property of Amphenol Corporation and is delivered on the express condition that it is not to be disclosed, reproduced or used, in whole or in part, for manufacture or sale by anyone other than Amphenol Corporation without its prior consent, & that no right is granted to disclose or to use any information in this document.

CUSTOMER DRAWING

REVISIONS				
SYM	ECN	DESCRIPTION	DATE	APPROVED
		SEE SHEET1		

NOTES:

1. MATERIAL:
  - 1.1 HOUSING: HIGH TEMPERATURE THERMAL PLASTIC, UL94V-0, COLOR:OPTION.
  - 1.2 LATCH: HIGH TEMPERATURE THERMAL PLASTIC, UL94V-0. COLOR: OPTION.
  - 1.3 TERMINAL: COPPER ALLOY.
  - 1.4 BOARDLOCK: COPPER ALLOY.
  - 1.5 METAL CLIP: SUS.
2. FINISH:
  - 2.1 TERMINAL:
    - 2.1.1 CONTACT AREA: SELECTED GOLD PLATING;
    - 2.1.2 SOLDERING AREA: MATTE TIN PLATING 100u" THICKNESS MIN; UNDER PLATING: NICKEL PLATING 50u" THICKNESS MIN. UNLESS OTHERWISE SPECIFIED
  - 2.2 BOARDLOCK:
    - 2.2.1 100u" MIN LEAD FREE MATTE TIN OVER 50u" MIN NICKEL UNDERPLATED OVERALL.
3. ELECTRICAL CHARACTERISTICS:
  - 3.1 CONTACT CURRENT RATING:1.0A MAX
  - 3.2 INSULATION RESISTANCE:1MΩ MIN. 500ADC.
  - 3.3 DIELECTRIC WITHSTANDING VOLTAGE:500 VAC AT SEA LEVEL.
  - 3.4 LOW LEVEL CONTACT RESISTANCE:
    - INITIAL:40mΩ MAX.
    - FINAL:THE CHANGE IN LLCR BETWEEN THE READING AFTER STRESS AND THE INITIAL READING SHALL NOT EXCEED 20 mΩ MAX.
4. MECHANICAL CHARACTERISTICS:
  - 4.1 CONTACT RETENTION FORCE:300gF MIN/PER PIN.
  - 4.2 DURABILITY:25 CYCLES.
  - 4.3 INSERTION FORCE (MODULE TO CONNECTOR) :106.8N MAX. UNMATING FORCE :19.77N MIN.
5. RELIABILITY AND OTHER CHARACTERISTICS:
  - 5.1 SOLDERABILITY -LEAD FREE: JESD22-B102; CONDITION C, 8 HOURS ±15 MINUTES STEAM PRECONDITION.
  - 5.2 VIBRATION: EIA-364-28, RANDOM PROFILE:
    - 5 HZ @ 0.01 g<sup>2</sup>/HZ TO 20HZ @ 0.02g<sup>2</sup>/HZ (SLOPE UP), 20 HZ TO 500HZ @ 0.02g<sup>2</sup>/HZ (FLAT), INPUT ACCELERATION IS 3.13g RMS.
  - 5.3 CYCLIC TEMPERATURE AND HUMIDITY: PER EIA-364-31, METHOD III WITHOUT CONDITIONING, INITIAL MEASUREMENTS, COLD SHOCK AND VIBRATION.
  - 5.4 THERMAL SHOCK: PASSED PER EIA-364-32, METHOD A, TABLE 2, TEST CONDITION 1, -55°C TO 85°C. PERFORM 5 CYCLES IN MATED CONDITION.
  - 5.5 MECHANICAL SHOCK: EIA-364-27, TEST CONDITION E,
  - 5.6 OPERATING TEMPERATURE: -55°C TO 85°C.
6. HALOGEN-FREE COMPLIANT PRODUCT. MEET AMPHENOL SPEC # S-SN-004.
7. ORDER PN SYSTEM:



DDR5 XX X X X XXX X X	
DOUBLE DATA RATE 5 SERIES	
XX: APPLICATION TYPE	X: CUSTOMER CODE OPTION:
04: SMT,288P, R/LR DIMM CONNECTOR	H: FOR H3C
.....	
X: HOUSING COLOR	X: PACKING AND MYLAR OPTIONS
1: BLACK	T: SOFT TRAY
2: NATURAL (IVORY)	H: HARD TRAY PACKAGE, WITH MYLAR "X"=40MM
3: YELLOW	J: HARD TRAY PACKAGE, WITH MYLAR "X"=70MM
4: BLUE	K: HARD TRAY PACKAGE, WITHOUT MYLAR
.....	M: HARD TRAY PACKAGE, WITH MYLAR "X"=90MM
X: LATCH COLOR	C: HARD TRAY PACKAGE, WITH CAP "X"=70MM;"Y"=6MM
1: BLACK	.....
2: NATURAL (IVORY)	
3: YELLOW	
4: BLUE	
.....	
X: CONTACT PLATED	SEE SEQUENCE NUMBER TABLE
0: GOLD FLASH	
1: 15u" Au ON CONTACT AREA	
2: 30u" Au ON CONTACT AREA	
3: 15u" MIN GXT	
4: 30u" MIN GXT	
5: 15u" Au ON CONTACT AREA AND 90u" Ni MIN ON UNDERPLATING:	
6: 30u" Au ON CONTACT AREA AND 90u" Ni MIN ON UNDERPLATING:	
8: 18u" AU ON CONTACT AREA	
.....	

SEQUENCE NUMBER		
CODE	OPTION DESCRIPTION	FIGURE DIM "H"
001	1. STANDARD HOUSING 2. STANDARD LATCH 3. FORK LOCK	(2.50)
002	1. STANDARD HOUSING 2. STANDARD LATCH 3. METAL TAB	(2.65)
005	1. STANDARD HOUSING 2. SHORT LATCH 3. FORK LOCK	(2.50)
006	1. STANDARD HOUSING 2. SHORT LATCH 3. METAL TAB	(2.65)
007	1. STANDARD HOUSING 2. STANDARD LATCH 3. METAL TAB	(1.85)
008	1. STANDARD HOUSING 2. SHORT LATCH 3. METAL TAB	(1.85)
.....		

UNLESS OTHERWISE SPECIFIED TOLERANCES U.S. METRIC .X +/- 0.35 .XX +/- 0.25 .XXX +/- 0.15 FRACTIONS +/- ANGLES +/- 3°	APPROVAL	DATE	Amphenol
	DRAWN Kellan.Yang	Aug.19,2021	
FOR MATERIALS AND FINISHES SEE NOTES	CHECKED		TITLE
REMOVE SHARP EDGES	CHECKED		DDR5 288P R/LR DIMM CONNECTOR
DIMENSIONS	DRAWING FILE : DRAWING\DDR\DDR504XXXXXXH		SIZE
U.S. INCHES	ANGLE OF PROJECTION		DRAWING NO.
(METRIC) (MM)			A3 C
			SCALE
			NONE
			SHEET 7 OF 7
			REV. 5