

**Technical specification :**

Rated voltage: 230 V AC / DC

Current rating: 4 A at 40°C  
IEC 60512-5-2 5b

Pollution degree: 3  
IEC 60664-1

Degree of protection: IP 67, in mated condition  
IEC 60529

Temperature range: -25°C ... +80°C  
IEC 60664-1

Mating cycles: >50

**Materials:**

Contact: CuZn

Contact plating: Nickel, stannous plated

Contact carrier: PA GF, UL 94

Moulding body: TPU, UL 94, black

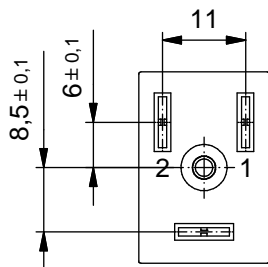
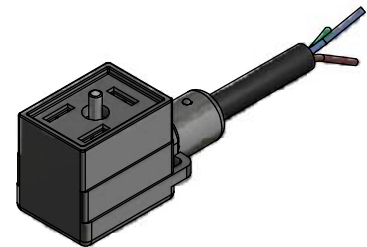

**Contact assignment:**

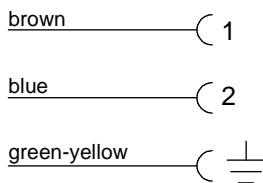

Part no:	Description:	Length L:	Cable:
55-00154	SAL - BI - V2PE - 0 - 0220 - 2 / H2	2m	PUR/PVC, black, 3x0,5mm <sup>2</sup> Cable: 781-H25300
55-00008	SAL - BI - V2PE - 0 - 0220 - 3 / H2	3m	
55-00009	SAL - BI - V2PE - 0 - 0220 - 5 / H2	5m	
55-00155	SAL - BI - V2PE - 0 - 0220 - 10 / H2	10m	
55-00156	SAL - BI - V2PE - 0 - 0220 - 2 / A2	2m	PVC, black, 3x0,5mm <sup>2</sup> Cable: -
55-00157	SAL - BI - V2PE - 0 - 0220 - 3 / A2	3m	
55-00158	SAL - BI - V2PE - 0 - 0220 - 5 / A2	5m	
55-00159	SAL - BI - V2PE - 0 - 0220 - 10 / A2	10m	TPU, UL 20549, black, 3x0,75mm <sup>2</sup> Cable: 781-K17300
55-00165	SAL - BI - V2PE - 0 - 0220 - 2 / K1 / 075	2m	
55-00166	SAL - BI - V2PE - 0 - 0220 - 3 / K1 / 075	3m	
55-00167	SAL - BI - V2PE - 0 - 0220 - 5 / K1 / 075	5m	
55-00168	SAL - BI - V2PE - 0 - 0220 - 10 / K1 / 075	10m	PVC, UL 2464, grey, 3x0,75mm <sup>2</sup> Cable: 781-A37300
55-00169	SAL - BI - V2PE - 0 - 0220 - 2 / A3 / 075	2m	
55-00170	SAL - BI - V2PE - 0 - 0220 - 3 / A3 / 075	3m	
55-00171	SAL - BI - V2PE - 0 - 0220 - 5 / A3 / 075	5m	
55-00172	SAL - BI - V2PE - 0 - 0220 - 10 / A3 / 075	10m	

D see data sheet cable

DO NOT ALTER CAD DRAWING BY HAND	Directive 2002/95/EC RoHS compliant	Index: a 02.02.11 VF Ä3731 contact assignment modified, dimension cable diameter removed, part no. cable in table added	dim. in mm	title: <b>Valve plug type B industrial, without protective circuit</b>			
					date	name	
			drawn		16.06.08	Franz	dwg no:
			appd.		16.06.08	Schmidt	part no: <b>55K1A005</b> see table
THIS DRAWING MAY NOT BE COPIED OR REPRODUCED IN ANY WAY, AND MAY NOT BE PASSED ON TO A THIRD PARTY WITHOUT WRITTEN PERMISSION. OWNERSHIP AND COPYRIGHT OF CONEC GmbH							