

PM162-K

Flat Actuator+Pin Terminal+Ring illumination(Dual color and tri-color available)



Switch Function■:

Blank indicates momentary
Z Latching

LED options★:

Blank indicates single color
31 Dual color(common cathode)
32 Dual color(common anode)
41 Tri-color(common cathode)
42 Tri-color(common anode)

LED Color△:

Single color R G Y O B W
Tri-color R G B
Dual color R G

LED Voltage▲ :

AC/DC 6V
AC/DC 12V
AC/DC 24V
AC/DC 110V
AC/DC 220V

Body◎ :

C Chrome plated brass
S Stainless steel
A Black plated brass

Specifications

- Panel Cutout: Φ 16mm
- Rating: 0.5A/220VAC
- Contact Configuration: 1NO1NC
- Protection Class: IP65,IK08
- Pin Terminal(2.8 × 0.5mm)
- Switching: C(Single-break slow-motion contact)
- Panel Thickness: 1 ~ 8mm
- Torque: About 0.6Nm
- Mechanical Life: 500,000 cycles
- Electrical Life: 50,000 cycles
- Actuator: Stainless steel/Chrome plated brass/Black plated brass
- Body: Stainless steel/Chrome plated brass/Black plated brass
- Base: PA
- Actuation Force: About 1.7N
- Actuation Travel: About 3mm

RoHS Compliant

Dimension

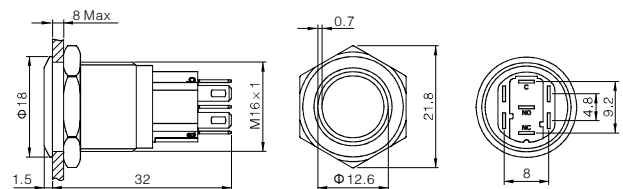

Terminal Arrangement

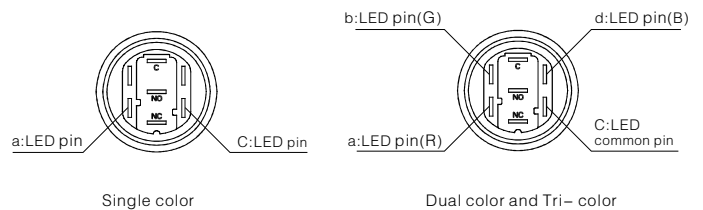

Single Color Lamp Specification

| | |
|-----------------------------|---|
| Lamp Type | Two-way LED lamp(AC/DC) |
| LED Color | R G Y O B W |
| Life | 40000hours(Reference) |
| Rated Voltage | AC/DC6V, AC/DC12V, AC/DC24V, AC/DC110V,AC/DC220V |
| Rated Current | 1~15mA |
| Dropping Way | Inner resistor |
| Lamp Circuit Diagram | Using AC/DCLed lamp, the terminals have no difference of anode and cathode. |
| Note: | DC LED and other voltage can be made to order. |

Tri-color Lamp Specification

| | |
|-----------------------------|--|
| Lamp Type | Unidirection Tri-color LED |
| LED Color | R G B |
| Life | 40000hours(Reference) |
| Rated Voltage | Without Resistor: R 1.8V, G 2.8V, B 2.8V With internal resistor: DC6V, DC12V, DC24V |
| Rated Current | 3~15mA |
| Lamp Circuit Diagram | <p>Common Cathode Common Anode</p> |
| | Using unidirection LED lamp, need distinguish anode and cathode, Using inner resistor, do not need connect outer resistor. |