

THIS DRAWING IS A CONTROLLED DOCUMENT FOR AMP INCORPORATED. IT IS SUBJECT TO CHANGE WITHOUT NOTICE. THE LATEST REVISION SHOULD BE CONTACTED FOR THE LATEST REVISION.

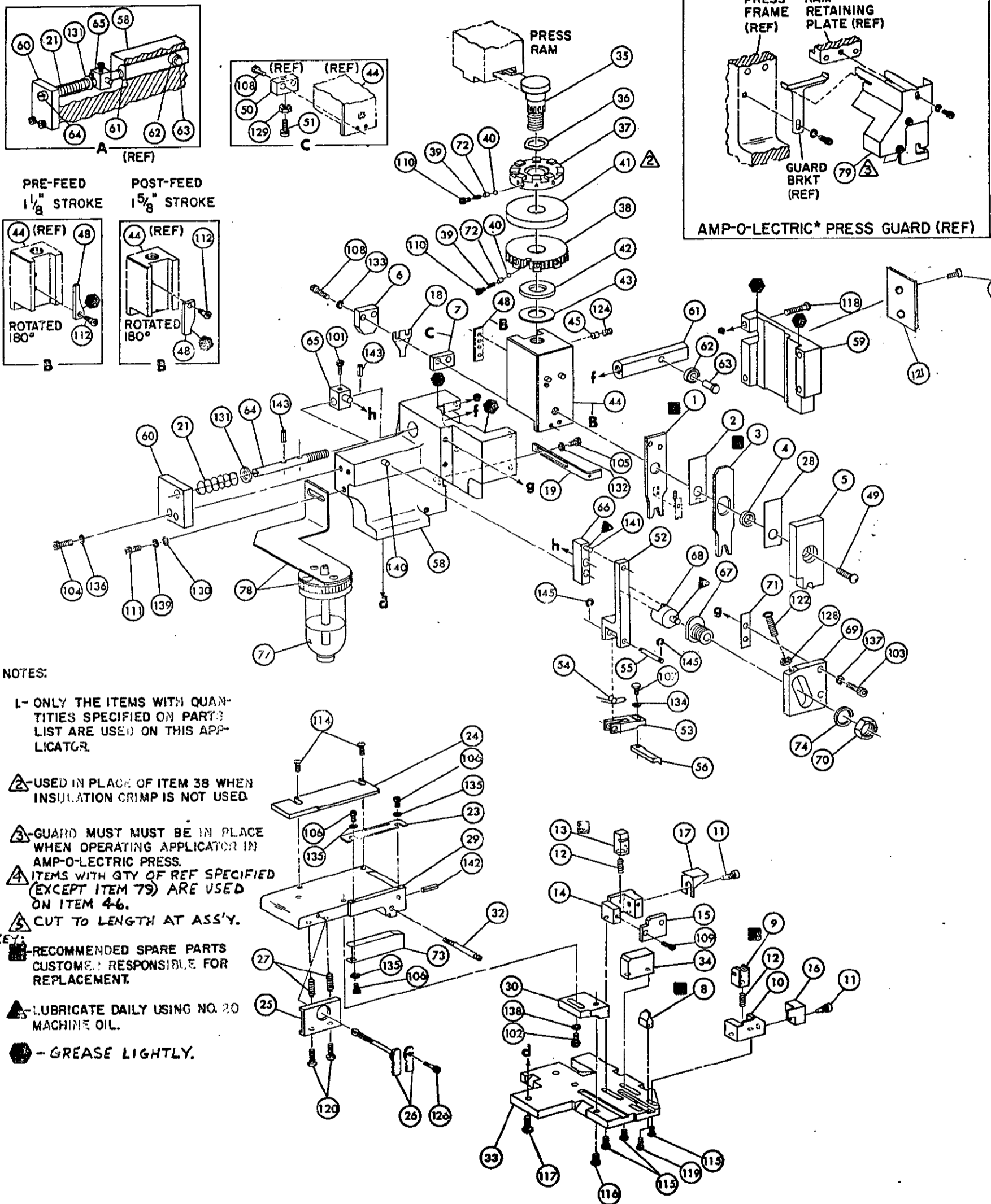

**NOTES:**

- 1- ONLY THE ITEMS WITH QUANTITIES SPECIFIED ON PARTS LIST ARE USED ON THIS APPLICATOR.
- △ USED IN PLACE OF ITEM 38 WHEN INSULATION CRIMP IS NOT USED.
- △ GUARD MUST BE IN PLACE WHEN OPERATING APPLICATOR IN AMP-O-LECTRIC PRESS.
- △ ITEMS WITH QTY OF REF SPECIFIED (EXCEPT ITEM 79) ARE USED ON ITEM 46.
- △ CUT TO LENGTH AT ASS'Y.
- KEY: - RECOMMENDED SPARE PARTS CUSTOMER RESPONSIBLE FOR REPLACEMENT.
- ▲ LUBRICATE DAILY USING NO. 20 MACHINE OIL.
- - GREASE LIGHTLY.

REF	QTY	PART NO	DESCRIPTION	ITEM	REF	QTY	PART NO	DESCRIPTION	ITEM
REF		21045-3	RING, RETAINING 'C' (.187 DIA) FEED FINGER PIN	145	REF	454220-1	CAP, HOUSING	59	
REF		5-21028-1	PIN, SLOT SPR (.125 DIA X .50) ADJ ROD	144	REF	454489-1	HOUSING	57	
REF	1	4-21028-0	PIN, SLOT SPR (.093 DIA X .75) STR G PLATE	143		690542-2	PAWL, FEED	56	
REF	1	1-21030-1	PIN, DOWEL (.187 DIA X .50) LEVER	142	1	240824-1	PIN, FEED FINGER	55	
REF	1	1-21030-6	PIN, DOWEL (.187 DIA X 1.25) HOUSING	141	REF	691499-1	SPRING, FEED FINGER	54	
		21024-5	WASHER, LOCK (NO 10) LUB ASSY	139	REF	690541-1	FINGER, FEED	53	
		21024-5	WASHER, LOCK (NO 10) STRIP GUIDE ADJ BLOCK	138	REF	455679-1	LEVER, TERMINAL FEED ARM	52	
REF	1	21024-5	WASHER, LOCK (NO 10) ADJ PLATE	137	1	811242-2	BUMPER, HOLDDOWN	51	
REF	1	21024-5	WASHER, LOCK (NO 10) FEED GUIDE ROD	136	1	690753-1	SPACER, TONKER	50	
3		21057-2	WASHER, LOCK (NO 4) FRONT STRIP GUIDE	135	1	7-21002-9	BOLT, CRIMPER	49	
1		21024-4	WASHER, LOCK (NO 8) FEED FINGER	134	1	690501-4	CAM POST-FEED	1 1/2 STROKE	
		21024-4	WASHER, LOCK (NO 8) DEPRESSOR	133				47	
1		21024-4	WASHER, LOCK (NO 8) STRIPPER	132	1	459456-1	APPLICATOR, BASIC (SUB ASSY)	46	
REF	1	21899-4	WASHER, FLAT (5/16 DIA) SCREW ADJ	131	1	690191-1	PLUG, NYLON	45	
		21899-2	WASHER, FLAT (NO 10) LUB ASSY	130	1	455673-1	RAM	44	
1		21068-5	NUT, HEX MACH (6-32) HOLDDOWN	129	1	690125-1	WASHER, LAMINATED	43	
REF	1	21068-5	NUT, HEX MACH (6-32) FEED ADJ	128	1	690124-1	WASHER, RAM	42	
		22353-8	SCR, SHLD. (.187 DIA X .250 LG) DRAG LEVER	127	1	690223-1	DISC, SPACER	41	
		21009-2	SCR, SKT SET (1/4-20 X .25) (LOC-WEL) RAM	124		23241-6	BALL, STEEL	40	
2		21017-2	SCR, DRIVE # 2 X .19	123	1	690170-1	SPRING, COMPRESSION	39	
REF	1	3-21064-2	SCR, RD HD MACH (6-32 X 1.50) FEED ADJ	122	1	690692-7	DISC, INSULATION	38	
1		461264-1	PLATE, IDENTIFICATION	121	1	22480-5	WASHER, SPRING	37	
2		2-21002-0	SCR, BUT HD SKT CAP (10-32 X .88) DRAG	120	1	690212-1	POST, RAM	35	
1		22733-8	SCR, BUT HD SKT CAP (8-32 X .38) (LOC-WEL) ANVIL	119	REF	692776-1	SUPPORT, TERMINAL	34	
REF	1	2-21002-9	SCR, BUT HD SKT CAP (10-32 X .75) CAP	118	1	455675-1	PLATE, BASE	33	
REF	2	2-22733-9	SCR, BUT HD SKT CAP (1/4-20 X .75) HOUSING	117	1	690432-3	SCREW, ADJUSTMENT	32	
REF	4	2-21002-2	SCR, BUT HD SKT CAP (10-32 X .50) SG ADJ BLOCK	116	REF	455689-1	BLOCK, STRIP GUIDE ADJ	30	
2		2-21002-2	SCR, BUT HD SKT CAP (8-32 X .50) SHEAR	115	1	1-455671-6	PLATE, STRIP GUIDE	29	
		2-21002-2	SCR, BUT HD SKT CAP (8-32 X .50) R STRIP GUIDE	114	1	1-455889-0	SPACER, FRONT SHEAR DEPRESSOR	28	
1		1-21002-7	SCR, BUT HD SKT CAP (6-32 X .38) CAM	112	1	1-22284-0	SPRING, DRAG	27	
		3-21000-4	SCR, SKT HD CAP (10-32 X .38) LUBRICATOR ASSY	111	1	690546-1	LEVER, DRAG RELEASE	26	
2		2-2030-1	SCR, SKT HD CAP (6-32 X .25) (LOC-WEL) CP DISC	110	1	240792-1	DRAG, STOCK	25	
		2-21000-7	SCR, SKT HD CAP (8-32 X .50) REAR SHEAR PLATE	109	1	690504-6	GUIDE STRIP (REAR)	24	
1		2-22503-0	SCR, HEX HD MACH (8-32 X .31) FEED FINGER	108	1	690438-1	GUIDE, STRIP (FRONT)	23	
3		1-21000-3	SCR, SKT HD CAP (4-40 X .25) F STRIP GUIDE	107	REF	4-22284-9	SPRING, FEED RETURN	21	
1		2-21000-7	SCR, SKT HD CAP (8-32 X .50) STRIPPER	106				20	
REF	3-21000-7	SCR, SKT HD CAP (10-32 X .75) FEED ROD GUIDE	105	1	690472-2	STRIPPER	19		
REF	3-21000-6	SCR, SKT HD CAP (10-32 X .62) FEED ADJ BLOCK	104				18		
1		3-21000-4	SCR, SKT HD CAP (10-32 X .38) SG ADJ BLOCK	103			17		
REF	1	3-21000-4	SCR, SKT HD CAP (10-32 X .38) SG ADJ BLOCK	102	1	691667-1	GUARD, CHIP (FRONT)	16	
REF	1	455749-1	GUARD, WINDOW	101			15		
		1-485184-0	LUBRICATOR ASSY	79			14		
			OIL, LUBRICATING	78			13		
				77	1	5-22280-0	SPRING, SHEAR	12	
				76	1	690461-1	STOP, SHEAR	11	
REF	1	458109-1	WASHER, SPECIAL	75	1	690459-1	HOLDER, SHEAR (FRONT)	10	
REF	1	454877-3	PLATE, STRIP GUIDE COVER	74	1	454276-1	SHEAR, FLOAT (FRONT)	9	
		690603-1	SPRING, ASSIST	73	1	9-690512-1	ANVIL	8	
REF	1	690517-1	SPACER	72			7		
		22594-8	NUT, HEX	71			6		
		240628-1	PLATE, ADJUSTMENT	70	1	1-455889-4	DEPRESSOR, SHEAR (FRONT)	5	
		240626-1	SHAFT, PIVOT	69			4		
		240633-1	BUSHING	68			3		
		455680-1	LEVER, INTERMEDIATE	67			2		
		240629-1	BLOCK, PIVOT	66	1	454406-2	CRIMPER, INSULATION	1	
		240632-2	SCREW, ADJUSTMENT FEED ROD	64					
		240659-3	PIN, CAM ROLLER	63					
		240658-1	ROLLER, CAM	62					
		454398-2	ROD, FEED	61					
REF		454178-1	GUIDE, FEED ROD	60					

CRIMPING DATA				APPLICATOR WILL APPLY
PAD LTR	CRIMP HEIGHT	WIRE SIZE	STRIP LENGTH	
A	.053	18		62505
B	NOT USED			
C	.049	20		
D	.047	22		

REMARKS	NO	REV
APPL USED ON MACHINE PART NO	MACH SERIAL NO	DISTRIBUTION
CUSTOMER NAME	APPL SERIAL NO	ORIGINAL
ADDRESS	PURCHASE ORDER	CUSTOMER COPY
CITY	ENG APP	FIELD ENG COPY

AMPOMATOR POST-FEED

T.D. PLATE (REF): 461264-1

AMP INCORPORATED

AMPOMATOR QUICK CHANGE APPLICATOR SIDE FEED (.130 DIA. PIN)