

- NOTES:
- MATERIALS:  
HOUSING: LCP, GLASS FILLED, UL 94V-0, COLOR: BLACK  
TERMINAL: COPPER ALLOY
  - FINISHES:  
CONTACT: 0.76µm MIN, SELECTIVE GOLD OVER 1.27µm MIN NICKEL UNDERPLATE  
SOLDERTAIL: 2.54µm MIN TIN OVER 1.27µm MIN NICKEL UNDERPLATE.
  - PRODUCT SPECIFICATION: PS-78720-001
  - PACKAGING SPECIFICATION: 787209900
  - MOLEX LOGO AND DATE CODE TO BE LOCATED APPROXIMATELY AS SHOWN.
  - MATES WITH SFF8482 PLUG, SATA PLUG
  - THIS PRODUCT COMPLIANT TO RoHS DIRECTIVE WITH THE FOLLOWING BANNED SUBSTANCES - LEAD, MERCURY, CADMIUM, HEXAVALENT CHROMIUM, POLYBROMINATED BIPHENYLS AND POLYBROMINATED DIPHENYLS ETHERS.
  - CORING AT NON FUNCTIONAL AREA ARE SUBJECTED TO CHANGES WITHOUT NOTICES.

molex YYDDD

THIS DRAWING CONTAINS INFORMATION THAT IS PROPRIETARY TO MOLEX ELECTRONIC TECHNOLOGIES, LLC AND SHOULD NOT BE USED WITHOUT WRITTEN PERMISSION

UPDATE NOTE 4 2017/07/18 EC NO: 119394 DRWN: SKANG CHK'D: APPR: SHONG	GENERAL TOLERANCES (UNLESS SPECIFIED)		DIMENSION UNITS	SCALE		
	ANGULAR TOL ± 3.0 °		MM	NTS		
	4 PLACES ±	DRWN BY		DATE		
	3 PLACES ±	CGOH	2012/08/29			
2 PLACES ± 0.2	CHK'D BY		DATE	SAS RECEPTACLE PRESS-FIT STANDARD HEIGHT		
1 PLACE ±	SCHEONG	2012/10/17				
0 PLACES ±	APPR BY		DATE	PRODUCT CUSTOMER DRAWING		
DRAFT WHERE APPLICABLE MUST REMAIN WITHIN DIMENSIONS	BOKOK	2012/10/29				
	DRAWING SIZE	THIRD ANGLE PROJECTION		SERIES	MATERIAL NUMBER	CUSTOMER
	A3			78720	78720-0001	GENERAL MARKET
		DOCUMENT NUMBER	DOC TYPE	DOC PART	SHEET NUMBER	
		SD-78720-001	PSD	000	1 OF 3	

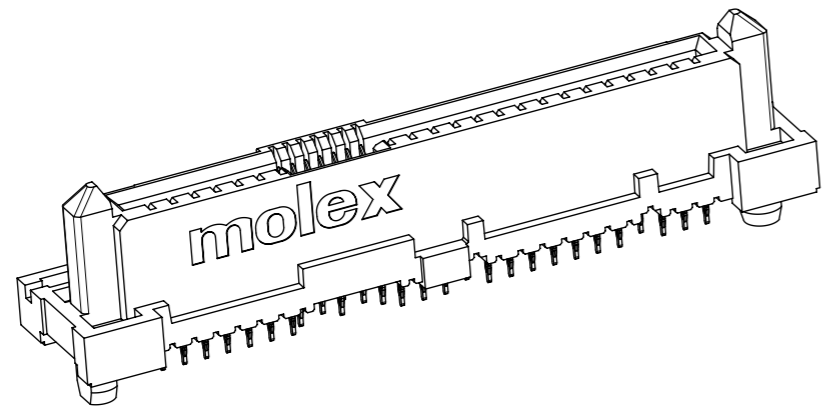
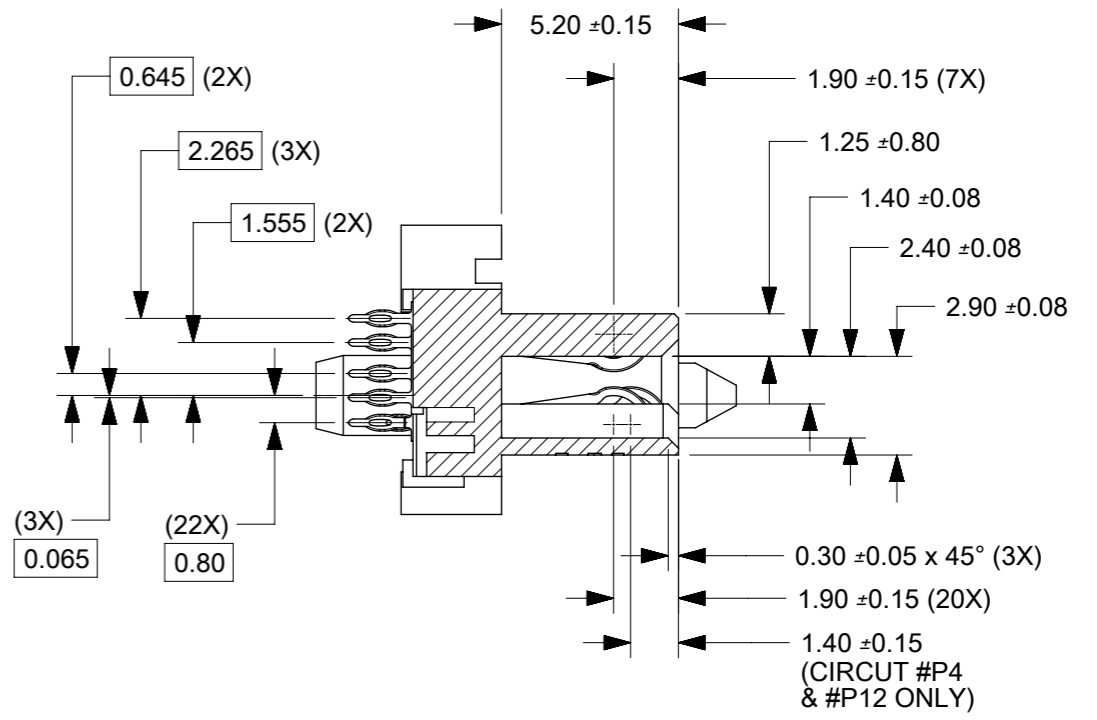
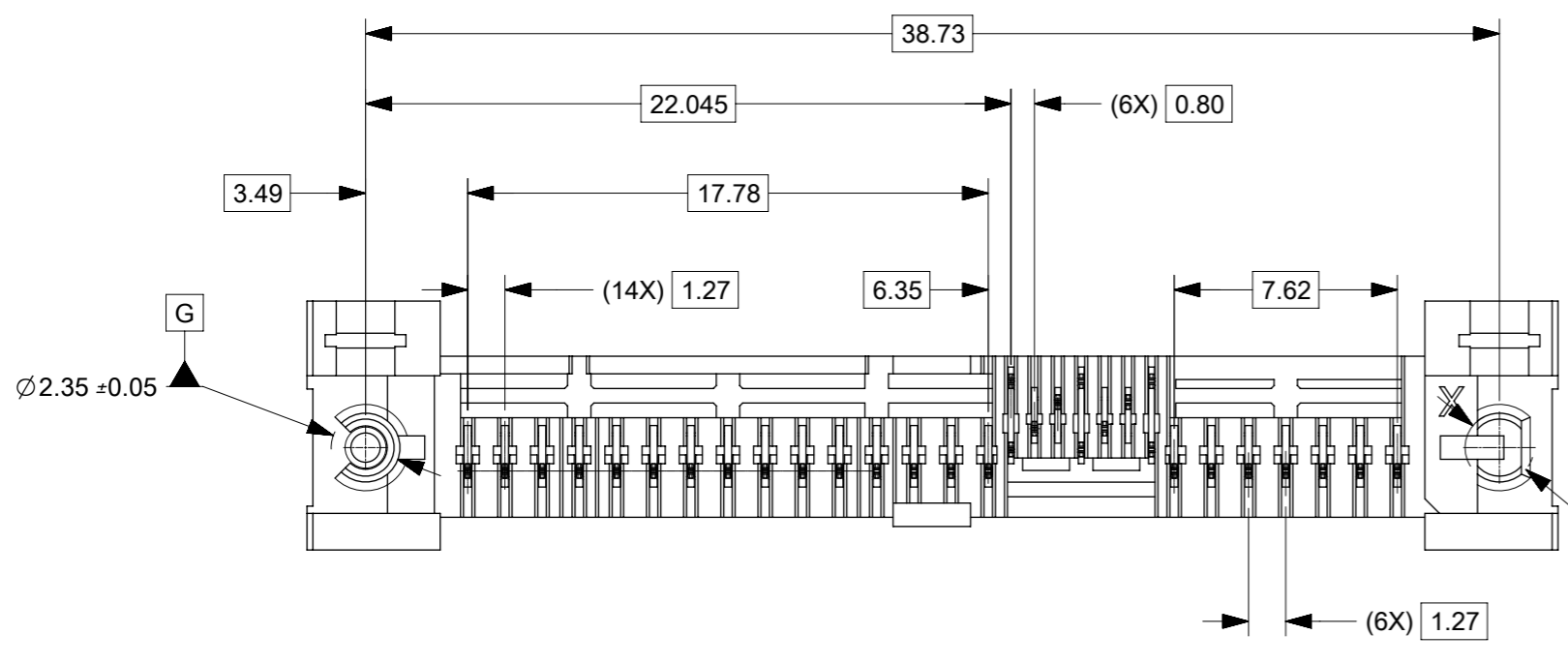
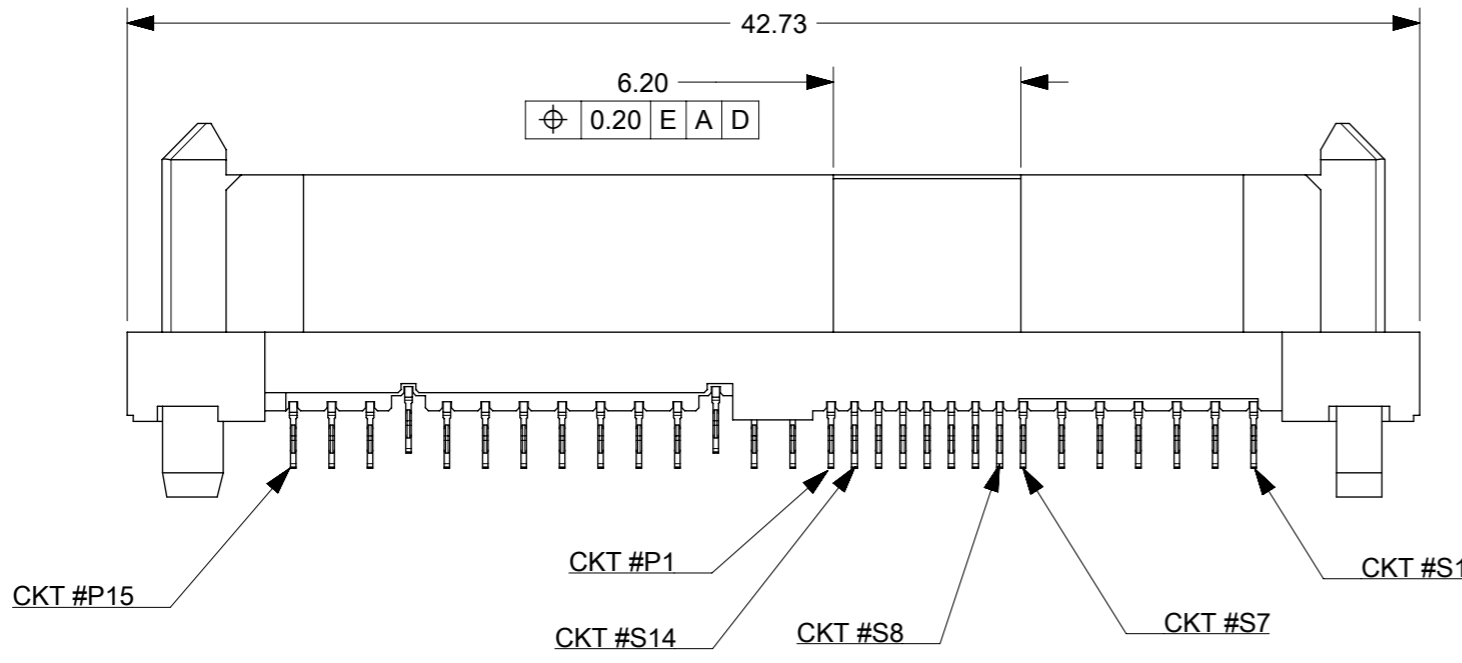

THIS DRAWING CONTAINS INFORMATION THAT IS PROPRIETARY TO MOLEX ELECTRONIC TECHNOLOGIES, LLC AND SHOULD NOT BE USED WITHOUT WRITTEN PERMISSION

UPDATE NOTE 4 2017/07/18 EC NO: 119394 DRWN: SKANG CHK'D: REV APPR: SHONG	GENERAL TOLERANCES (UNLESS SPECIFIED)		DIMENSION UNITS	SCALE	
	ANGULAR TOL $\pm 3.0^\circ$		MM	NTS	
	4 PLACES $\pm$		DRWN BY	DATE	
	3 PLACES $\pm$		CGOH	2012/08/29	
2 PLACES $\pm 0.2$		CHK'D BY	DATE	SAS RECEPTACLE PRESS-FIT STANDARD HEIGHT  PRODUCT CUSTOMER DRAWING	
1 PLACE $\pm$		SCHEONG	2012/10/17		
0 PLACES $\pm$		APPR BY	DATE		
		BOKOK	2012/10/29		
DRAFT WHERE APPLICABLE MUST REMAIN WITHIN DIMENSIONS		DRAWING SIZE	THIRD ANGLE PROJECTION		SERIES: 78720 MATERIAL NUMBER: 78720-0001 CUSTOMER: GENERAL MARKET
A1		A3			DOCUMENT NUMBER: SD-78720-001 DOC TYPE: PSD DOC PART: 000 SHEET NUMBER: 2 OF 3

# RECOMMENDED PCB LAYOUT

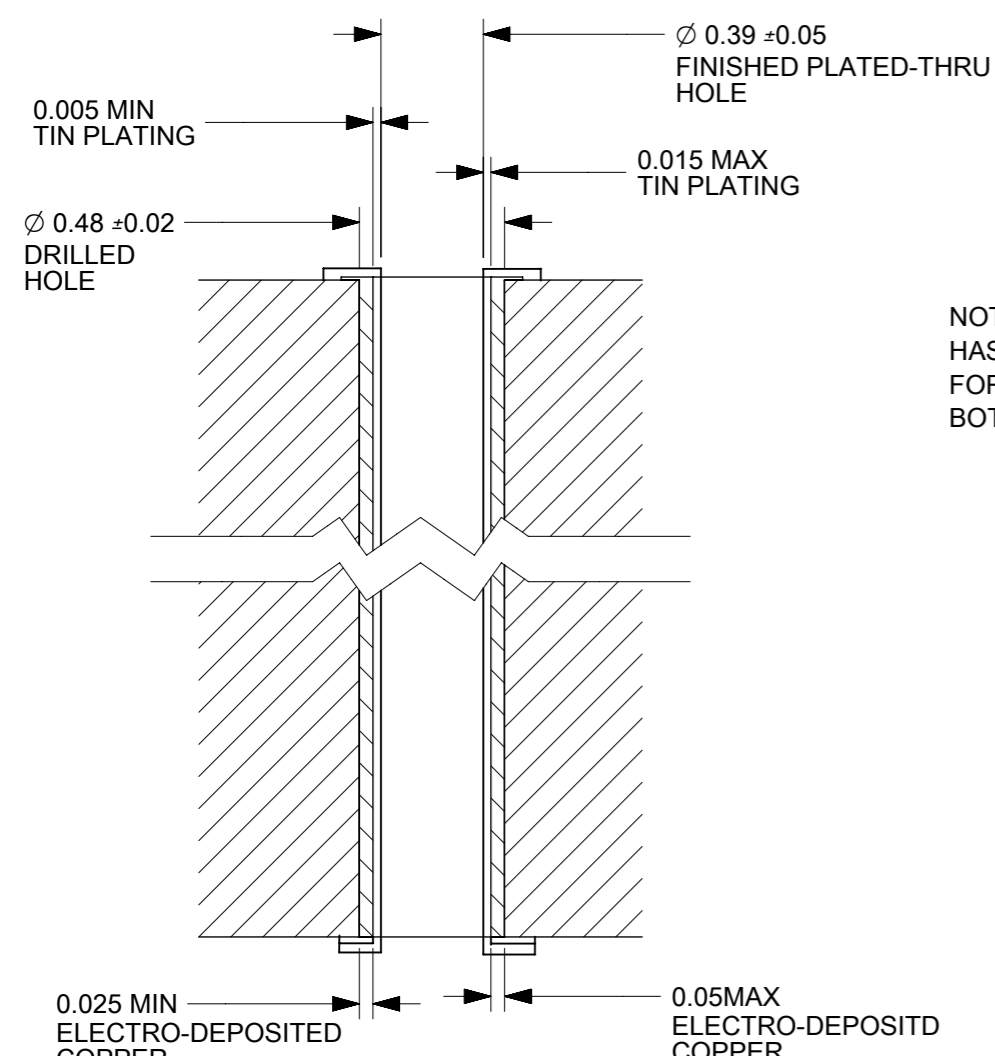
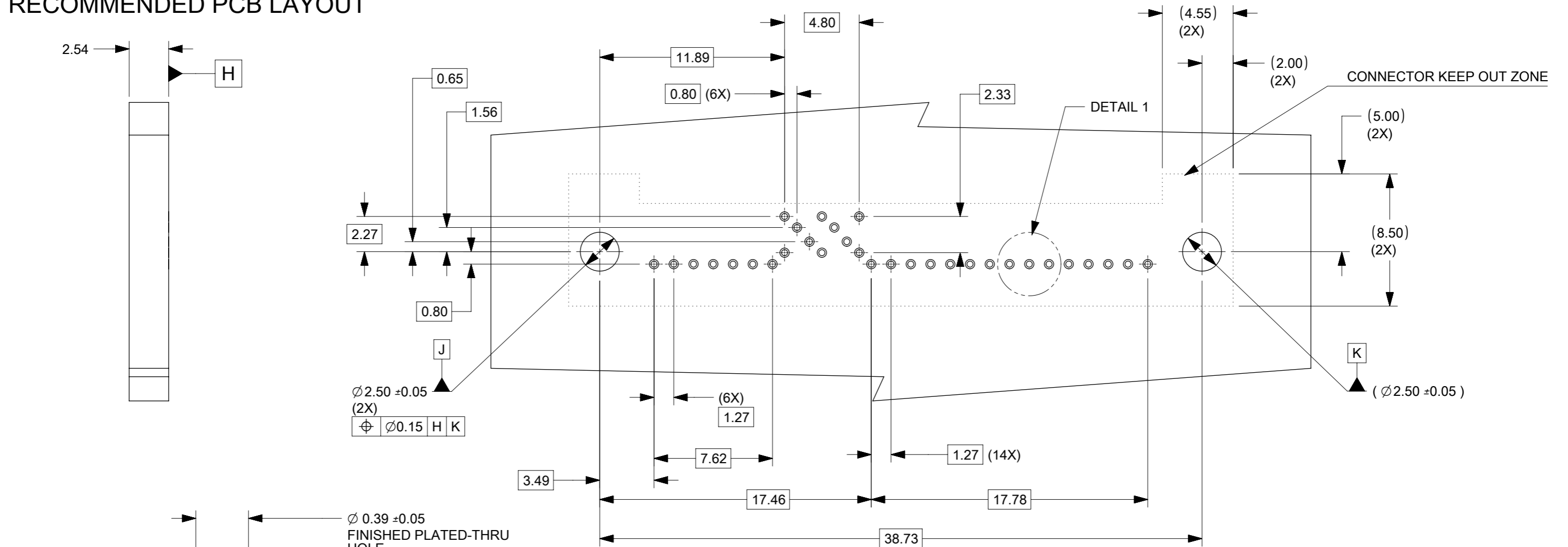

NOTE:  
HASL PLATING PROCESS FOR THE PLATED THRU HOLE IS NOT RECOMMENDED.  
FOR OPTIMAL HIGH SPEED ELECTRICAL PERFORMANCE,  
BOTTOM ROUTING, THINNER PCBs AND/ OR BACK DRILLING IS RECOMMENDED.

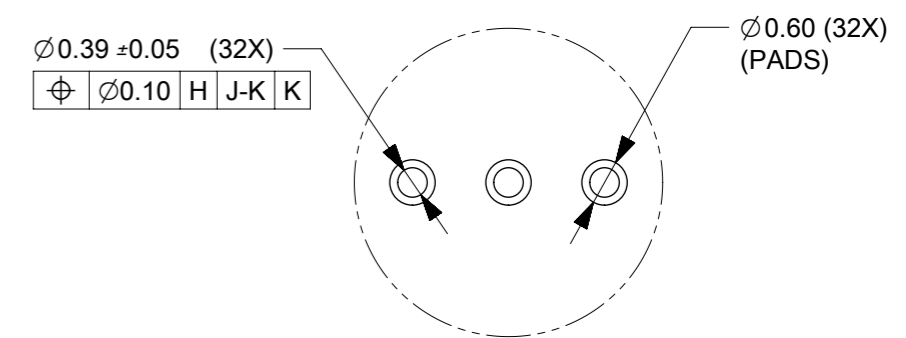

DETAIL 1

THIS DRAWING CONTAINS INFORMATION THAT IS PROPRIETARY TO MOLEX ELECTRONIC TECHNOLOGIES, LLC AND SHOULD NOT BE USED WITHOUT WRITTEN PERMISSION																	
UPDATE NOTE 4 2017/07/18 EC NO: 119394 DRWN: SKANG CHK'D: APPR: SHONG	GENERAL TOLERANCES (UNLESS SPECIFIED)		DIMENSION UNITS	SCALE													
	ANGULAR TOL ± 3.0 °		MM	NTS													
	4 PLACES ±	DRWN BY		DATE	CGOH 2012/08/29												
	3 PLACES ±	CHK'D BY		DATE	SCHEONG 2012/10/17												
2 PLACES ± 0.2	APPR BY		DATE	BOKOK 2012/10/29													
1 PLACE ±	DRAWING SIZE		THIRD ANGLE PROJECTION	PRODUCT CUSTOMER DRAWING													
0 PLACES ±	DRAFT WHERE APPLICABLE MUST REMAIN WITHIN DIMENSIONS		A3	78720		78720-0001		GENERAL MARKET									
RELEASE STATUS		P1	RELEASE DATE		13.10.2017		06:13:51		DOCUMENT NUMBER		SD-78720-001	DOC TYPE	PSD	DOC PART	000	SHEET NUMBER	3 OF 3