

NOTES:

1. FOR WAVESOLDERING (SOLDER BATH TEMPERATURE 260 °C FOR 5 SEC. AND SOLDER PREHEAT 100 °C FOR 30 SEC.)
2. METALSHELLS: STEEL; min. 315µm TIN over 40-80µm NICKEL
3. INSULATOR: HIGH TEMPERATURE PLASTIC UL 94 V-0; BLACK
4. CONTACTS: COPPER ALLOY; PLATING (SEE PART NO.):
 - PLEASE ADD A for GOLD FLASH over NICKEL (PREFERRED TYPE)
 - PLEASE ADD B for 20µm HARD GOLD over min. 50µm NICKEL
 - PLEASE ADD C for 30µm HARD GOLD over min. 50µm NICKEL
5. THREADED SPACER CLIPS: COPPER ALLOY; min. 200µm TIN over 80µm NICKEL
PCB-HOLE: $\varnothing 3,1 \pm 0,1$; PCB THICKNESS 1,6mm
6. COLLARS: COPPER ALLOY; min. 200µm TIN over 80µm NICKEL
7. CAPACITANCE: 2 x 180pF $\pm 20\%$
8. DIELECTRIC WITHSTANDING VOLTAGE: 300 VDC
9. P.C.B. HOLE DRILLINGS ON SHEET 2
10. MAXIMUM TORQUE VALUE FOR THREAD: 6 in.LB
11. CONNECTOR IS PART MARKED: **242□26280X CONEC ABC** (see note 4)

RoHS compliant

THIS DRAWING MAY NOT BE COPIED OR REPRODUCED IN ANY WAY, AND MAY NOT BE PASSED ON TO A THIRD PARTY WITHOUT WRITTEN PERMISSION. OWNERSHIP AND COPYRIGHT OF CONEC GmbH DO NOT ALTER CAD DRAWING BY HAND				tolerance		scale: 2:1 (5:1)
					dim. in mm	material: SEE NOTES
				date	name	title:
				drawn 14.09.15	Henneboel	D-SUB PI FILTER FEMALE
			appd. 14.09.15	Lehmenkühler	25pos. SOLDER PIN STRAIGHT	
			norm		with threaded spacer clip	
			d-old	24K1A239	dwg no:	
4 x b	Ä5811	14.09.2015	K.H.		24K1A1626 (b)	DIN-A3
a	Original					sh: 1/2
rev.	description	date	name	part no: (b) 242□26280X (see note 4)		

P.C.B. HOLE DRILLINGS

(P.C.B. TOP SIDE)

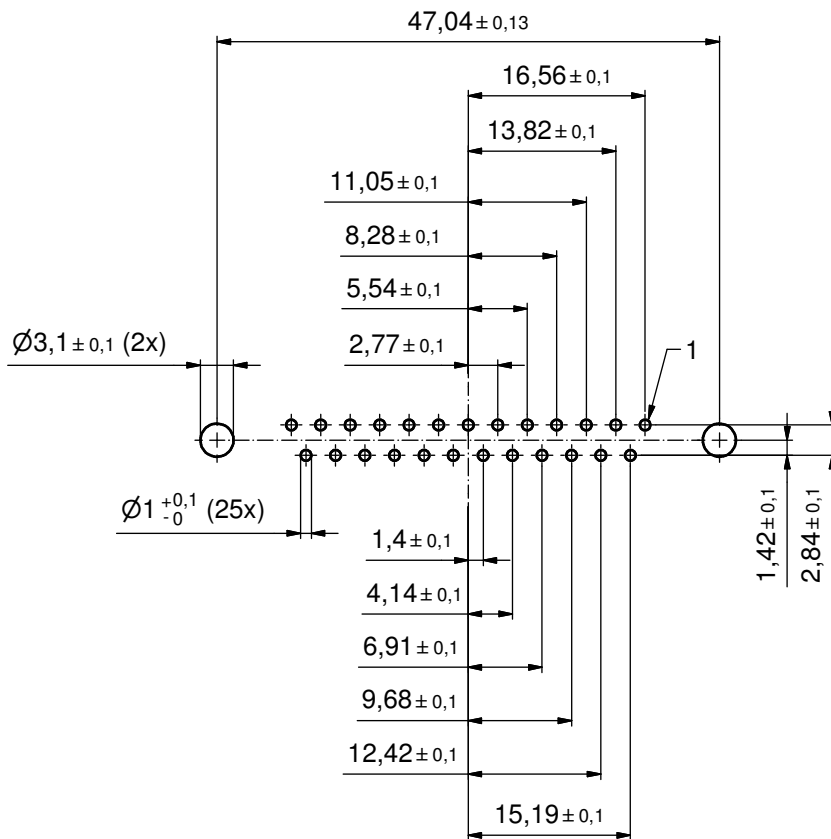

THIS DRAWING MAY NOT BE COPIED OR REPRODUCED IN ANY WAY, AND MAY NOT BE PASSED ON TO A THIRD PARTY WITHOUT WRITTEN PERMISSION. OWNERSHIP AND COPYRIGHT OF CONEC GmbH DO NOT ALTER CAD DRAWING BY HAND				tolerance		scale: 2:1
					dim. in mm	material: SEE SHEET 1
				date	name	title:
				drawn 14.09.15	Henneboel	P.C.B. HOLE DRILLINGS
				appd. 14.09.15	Lehmenkühler	D-SUB PI FILTER FEMALE 25pos. SOLDER PIN with threaded spacer clip
				norm		
				d-old		dwg no:
	a	Original		CONEC [®]		24K1A1626
rev.	description	date	name			part no: SEE SHEET 1