

Tyco / Electronics
Raychem Circuit Protection
 308 Constitution Drive
 Menlo Park, CA 94025-1164
 Phone: 800-227-4856
 Fax: 800-227-4866

PolySwitch®
PTC Devices
 Overcurrent Protection Device

PRODUCT: LTP260

DOCUMENT: SCD 23012
 PCN: 054466
 REV LETTER: F
 REV DATE: MAY 25, 2005
 PAGE NO.: 1 OF 1

Specification Status: Released

Electrical Rating

Voltage: 24V MAX
Current: 100A MAX

Leads:
 Nickel: 0.125 mm nom

Tape:
 Polyester

Marking:
 _____ Manufacturer's Mark
 XX L26 _____ Part Identification
 □□□□ _____ Lot Identification

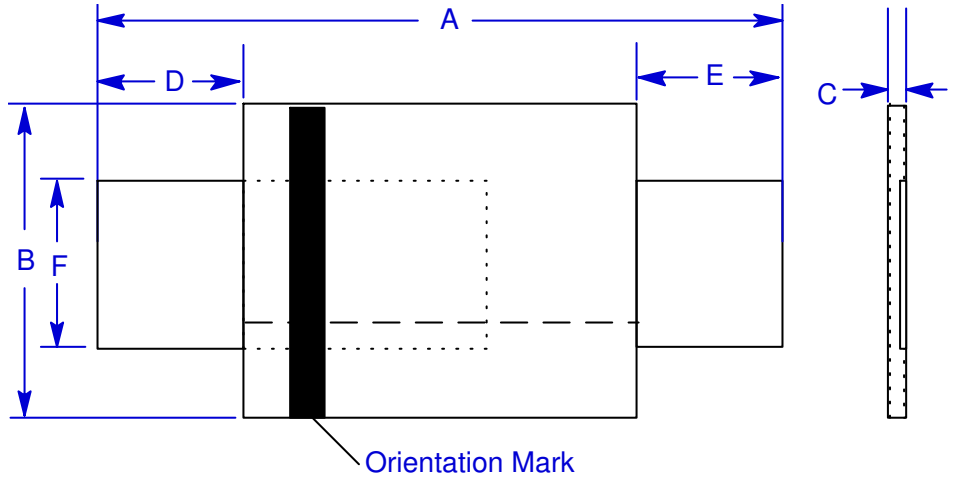

TABLE I. DIMENSIONS:

mm:	A		B		C		D		E		F		G	
	MIN	MAX	MIN	MAX	MIN	MAX	MIN	MAX	MIN	MAX	MIN	MAX	MIN	MAX
	24.0	26.0	10.8	11.9	0.6	1.0	5.0	7.0	5.0	7.0	5.9	6.1	--	--
in*:	(0.94)	(1.02)	(0.43)	(0.47)	(0.02)	(0.04)	(0.20)	(0.28)	(0.20)	(0.28)	(0.23)	(0.24)	--	--

*Rounded off approximation

TABLE II. PERFORMANCE RATINGS:

I HOLD	CURRENT TRIP LIMITS								TIME TO TRIP		REFERENCE RESISTANCE		ONE-HOUR POST-TRIP RESISTANCE		TRIPPED-STATE POWER DISSIPATION
	AMPS AT 0°C		AMPS AT 20°C		AMPS AT 60°C		AMPS AT 80°C		SECONDS AT 20°C, 13 A		OHMS AT 20°C		OHMS AT 20°C		
HOLD	HOLD	TRIP	HOLD	TRIP	HOLD	TRIP	HOLD	TRIP	TYP	MAX	MIN	MAX	TYP	MAX	WATTS AT 20°C, 24V MAX
2.6	3.1	6.2	2.6	5.2	1.4	2.8	0.8	1.6	2	5	0.025	0.042	0.055	0.076	2.3

Reference Documents: PS300
 Precedence: This specification takes precedence over documents referenced herein.
 Effectivity: Reference documents shall be the issue in effect on the date of invitation for bid.
 CAUTION: Operation beyond the rated voltage or current may result in rupture, electrical arcing or flame.