

LOC	DIST	REV	DESCRIPTION	DATE	DMN	AP'D
DW	-	P	LTR			
		A	REVISED (ECR-09-010844), OBSOLETE -1	15MAY09	SC	WK

NOTES:

1. MATERIAL:
 HOUSING: THERMOPLASTIC(PBT), UL94V-0, COLOR BLUE (661C)
 CONTACT: BRASS
 SHELL: STEEL
 BOARDLOCK: BRASS
 RIVET AND SCREW: BRASS
2. FINISH:
 CONTACT: GOLD FLASH PLATED ON CONTACT AREA
 2.54um[100u"] MIN. MATTE TIN PLATED ON SOLDERTAILS
 1.27um[50u"] MIN. NICKEL UNDERPLATED OVERALL
 SHELL: 2.03um[80u"] MIN. NICKEL PLATED
 BOARDLOCK: 2.54um[100u"] MIN. MATTE TIN PLATED ON SOLDERTAILS
 1.27um[50u"] MIN. NICKEL UNDERPLATED OVERALL
 RIVET AND SCREW: 2.03um[80u"] MIN. NICKEL PLATED
 WAVE SOLDER CAPABLE TO 265°C
 PER TE SPEC. 109-202, CONDITION B.
4. RECOMMENDED P.B.C. THICKNESS: 1.0~1.8mm

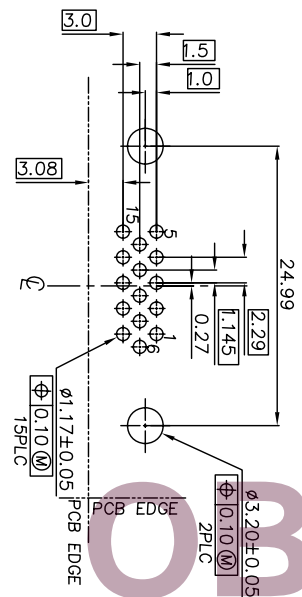
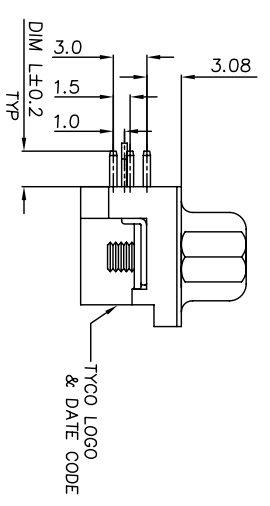
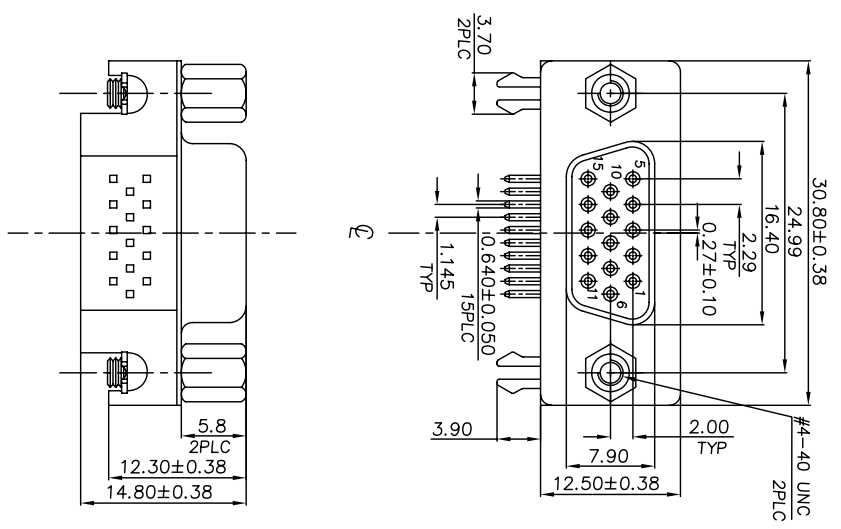

RECOMMENDED P.C.B. LAYOUT
 PCB TOLERANCE : ±0.05

2.54	1734323-2
3.18	1734323-1
DIM L	PART NUMBER

THIS DRAWING IS A CONTROLLED DOCUMENT.

DMN	15MAY2009	S. CHIEN	15MAY2009	15MAY2009	15MAY2009	15MAY2009	15MAY2009	15MAY2009	15MAY2009
CHK	15MAY2009	S. CHIEN	15MAY2009	15MAY2009	15MAY2009	15MAY2009	15MAY2009	15MAY2009	15MAY2009
AP'D	15MAY2009	W. KODAMA	15MAY2009	15MAY2009	15MAY2009	15MAY2009	15MAY2009	15MAY2009	15MAY2009

DIMENSIONS:	MM	TOLERANCES UNLESS OTHERWISE SPECIFIED:	± .1	0 PLC	± .03	1 PLC	± .02	2 PLC	± .01	3 PLC	± .01	4 PLC	± .3°
-------------	----	--	------	-------	-------	-------	-------	-------	-------	-------	-------	-------	-------

MATERIAL	SEE NOTE	FINISH	SEE NOTE	WEIGHT	501-57622	SIZE	A3	DATE CODE	00779	DRAWING NO	1734323	RESTRICTED TO	
----------	----------	--------	----------	--------	-----------	------	----	-----------	-------	------------	---------	---------------	--

CUSTOMER DRAWING	SCALE	SHEET	1 of 2	REV	A
------------------	-------	-------	--------	-----	---

OBsolete NOT the LATEST REVISION

Loc	DW	DIST	
P	LTR	DESCRIPTION	DATE
		SEE SHEET 1.	DWN
			AP'D

4

3

2

1

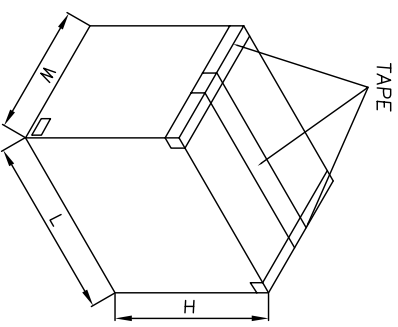
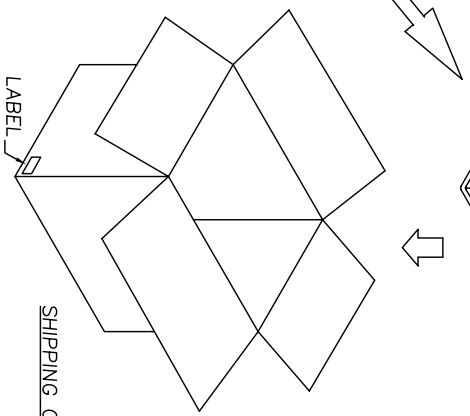
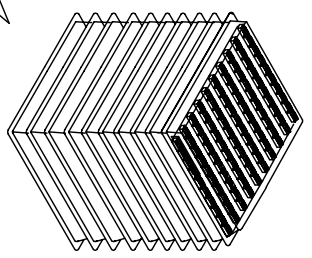
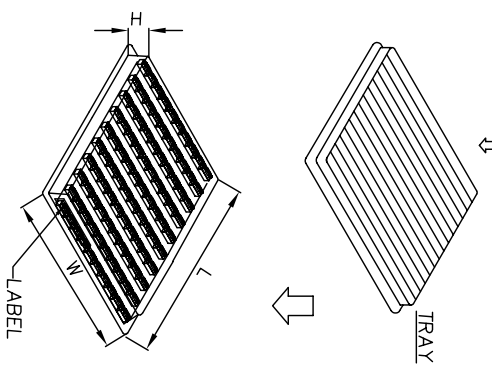
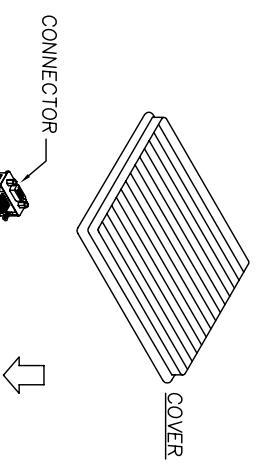

- NOTES:
1. MATERIAL:
 TRAY: PVC
 SHIPPING CARTON: CORRUGATED FIBER
 2. DIMENSION:
 TRAY: 358mm(L)x241mm(W)x24.6mm(H)
 SHIPPING CARTON: 360mm(L)x242mm(W)x250mm(H)
 3. QUANTITY:
 100 PCS/TRAY
 10 TRAYS/SHIPPING CARTON
 4. WEIGHT:
 GROSS WT.: 10.6KGS/SHIPPING CARTON

THIS DRAWING IS A CONTROLLED DOCUMENT.

DIMENSIONS: MM		TOLERANCES UNLESS OTHERWISE SPECIFIED:		DWN		Tyco Electronics Corporation Taipei, Taiwan
		0 P.L.C	±	CHK		
MATERIAL		1 P.L.C	±	AP'D	D-SUB 15 POSITION RIGHT ANGLE, DIP TYPE	
		2 P.L.C	±	PRODUCT SPEC		
		3 P.L.C	±	APPLICATION SPEC		
		4 P.L.C	±	WEIGHT		
FINISH		ANGLES	±	CUSTOMER DRAWING	SIZE: A3 PAGE CODE: 300779 DRAWING NO: C=1734323	RESTRICTED X0
				SCALE: 1:1	SHEET: 2 of 2	REV: A