

Recommended P.C. Board Layout
SCALE 6:1

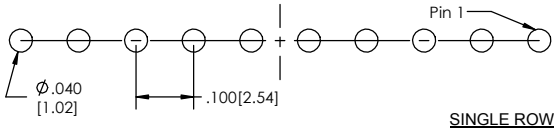

SINGLE ROW

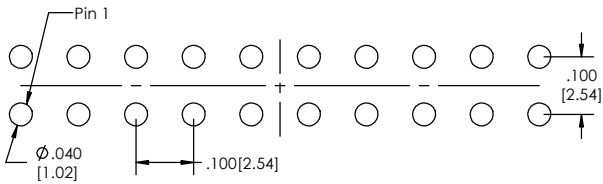

DOUBLE ROW

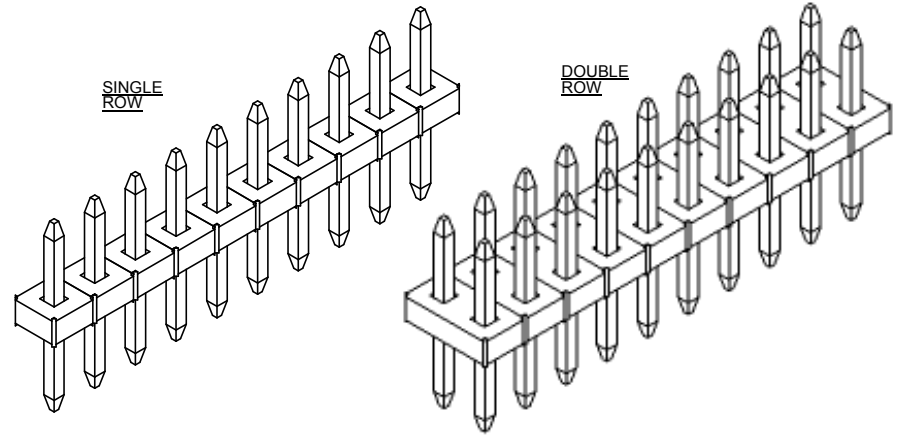

ULTSHC-1 **(A)** **(B)** **(C)** **(D)** **(E)** **(F)** **(G)** **(H)** **(I)** **(J)** **(L)**

- A. Pins Per Row - 1 through 40
- B. Row Specification
 - S= Single
 - D= Double
- C. Desired Tail Length
 - If Tail is not specified then:
Tail(T) = Overall Length(L) - Post(P) - .060[1.50]
- D. Pin Options
 - See Pin Options below
- E. Desired Post Height
 - Please specify
 - e.g. 230[5.84]= 230
- F. Plating Options
 - See Plating Options below
- G. Lock Tight "LT" (Optional)
 - Leave blank if not needed
 - LT= With
- H. Polarized Position
 - Leave blank if not needed
 - If required, specify empty pin position
 - e.g. 012 for Pin 12
- I. Every Other Pin Filled (.200 Centers)
 - Leave blank if not needed
 - E= Filled
- J. Lead Free

Mates with:

- BCSS
- BSSH
- BSSHC
- BSSQ
- BSSQC
- BSSQM
- LBCSS
- LSMBC
- LSWSC
- SMBC
- SSHQ
- SSHR
- SSHR
- SSHS
- SSHSM

APPLICATION

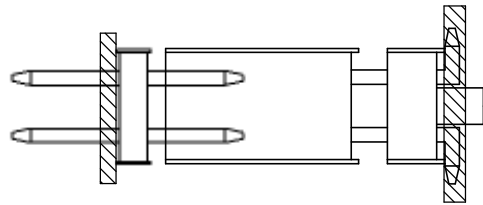

SINGLE ROW

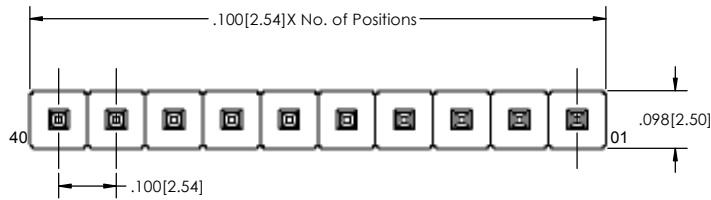
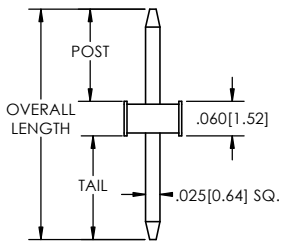

DOUBLE ROW

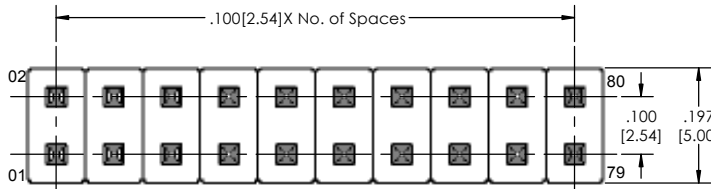
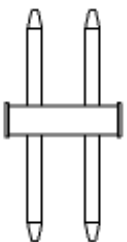

Plating options	
G	-10µ Gold on Contact Area/ Flash on Tail
T	-Matte Tin all Over
GT	-10µ Gold on Contact Area/ Matte Tin on Tail
H	-30µ Gold on Contact Area/ Matte Tin on Tail
F	-Gold Flash over Entire Pin
FT	-Gold Flash on Contact Area/ Matte Tin on Tail

Specifications:
 Current Rating: 3.0 Ampere
 Insulation Resistance: 1000M Ohms Min.
 Dielectric Withstanding: 600V AC
 Contact Resistance: 20M Ohms Max.
 Operation Temperature: -40°C to +105°C
 Max. Process Temperature
 Peak: 260°C up to 20 secs.
 Process: 230°C up to 60 secs.
 Wave: 260°C up to 6 secs.
 Manual Solder: 350°C up to 5 secs.

Materials:
 Contact Material: Phosphor Bronze
 Insulator Material: Nylon 6T
 Plating: Au or Sn over 50µ" (1.27) Ni

Tails may be clipped to achieve specific dimensions.
 Products cut to specific sizes are uncancellable/ nonreturnable.
 Parts are subject to change without notice.

Pin Options		
Overall Pin Length	Max. Post Length	
.300[7.62mm]	.150[3.81mm]	02
.335[8.51mm]	.185[4.70mm]	03
.430[10.92mm]	.280[7.11mm]	06
.445[11.30mm]	.295[7.49mm]	08
.456[11.58mm]	.306[7.77mm]	10
.480[12.19mm]	.330[8.38mm]	11
.530[13.46mm]	.380[9.65mm]	14
.630[16.00mm]	.480[12.19mm]	16
.730[18.54mm]	.580[14.73mm]	20
.830[21.08mm]	.680[17.27mm]	22
.930[23.62mm]	.780[19.81mm]	24
1.030[26.16mm]	.880[22.35mm]	26
1.130[28.70mm]	.980[24.89mm]	28
1.230[31.24mm]	1.080[27.43mm]	30
1.330[33.78mm]	1.180[29.97mm]	32
1.430[36.32mm]	1.280[32.51mm]	34
1.530[38.86mm]	1.380[35.05mm]	36

Post + Tail + .060[1.50] must not exceed Overall Length



PROPRIETARY AND CONFIDENTIAL
 THE INFORMATION CONTAINED IN THIS DRAWING IS THE SOLE PROPERTY OF Major League Electronics. ANY REPRODUCTION IN PART OR AS A WHOLE WITHOUT THE WRITTEN PERMISSION OF Major League Electronics IS PROHIBITED.

UNLESS OTHERWISE SPECIFIED:		NAME	DATE		
DIMENSIONS ARE IN INCHES		DRAWN	EOW		01/13/14
TOLERANCES:		CHECKED	GWE		01/13/14
ONE DECIMAL ±.100		ENG APPR.			
TWO DECIMAL ±.010		MFG APPR.			
THREE DECIMAL ±.005		ADDRESS:		2533 Centennial Blvd.	
FOUR DECIMAL ±.002		MATERIAL:		Jeffersonville, In 47130	
NEXT ASSY USED ON		FINISH:		Phone: 812-670-4174	
APPLICATION		DO NOT SCALE DRAWING		Fax: 812-670-4175	
		E-Mail: mle@mlelectronics.com		TITLE: ULTSHC-1 SERIES SIZE DWG. NO. C SCALE 6:1 SHEET 1 OF 1	