

OPTIONAL PICK AND PLACE CAP

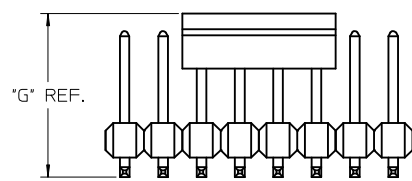

PICK AND PLACE CAP AVAILABLE SEE NOTES 4 & 9

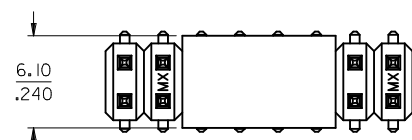
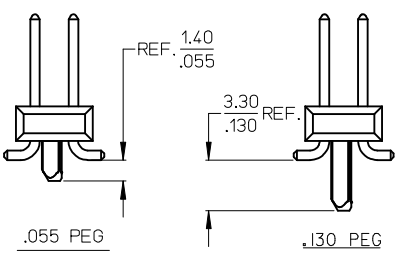

PEG OPTIONS

NOTES:

- MATERIALS: INSULATOR: GLASS FILLED LIQUID CRYSTAL POLYMER (LCP), UL94 V-0, COLOR: BLACK
TERMINAL: COPPER ALLOY
- FINISH:
TIN - 0.00381/.000150 MINIMUM TIN OVER NICKEL OVER ALL
15 GOLD - 0.00038/.000015 MINIMUM GOLD IN SELECT AREA OVER 0.00191/.000075 MINIMUM TIN IN SELECT AREA OVER NICKEL OVERALL
30 GOLD - 0.00076/.000030 MINIMUM GOLD IN SELECT AREA OVER 0.00191/.000075 MINIMUM TIN IN SELECT AREA OVER NICKEL OVERALL.
50 GOLD - 0.00127/.000050 MINIMUM GOLD IN SELECT AREA OVER 0.00254/.000100 MINIMUM TIN IN SELECT AREA OVER NICKEL OVERALL.
- PART TO CONFORM TO PS-71308
- PACKAGING (SEE CHARTS):
BULK: PER PK-70873-0353.
TUBES: PER PK-70873-0041.
TUBES W/ VAC CAPS: PER PK-70873-0691.
TAPE AND REEL W/ VAC CAPS: PER PK-70873-0805.
SEE SHEET 3 FOR TAPE & REEL PRODUCT WITH SHALLOW POCKET REQUIREMENTS.
- TYP. DIMENSIONS FOR LANDS SURROUNDING HOLES FOR RETENTION PEGS.
- PIN SOLDERABILITY PER MOLEX SPEC. ES-152.
- SEE SHEETS 2-5 FOR CHARTED DIMS., PART/EDP NO'S, AND VOIDED CIRCUITS.
- PIN PUSHOUT FORCE: 3 POUNDS MINIMUM.
- PICK-N-PLACE CAPS WILL BE PLACED SO THAT VACUUM PICK UP AREA WILL BE IN CENTER OF PART.
- THIS PART CONFORMS TO CLASS B REQUIREMENTS OF COSMETIC SPECIFICATION PS-45499-002.
- MEASURE POINT FOR PLATING THICKNESS.

DIM "M"	DIM "G"
6.10 .240	10.67 .420
8.13 .320	12.70 .500

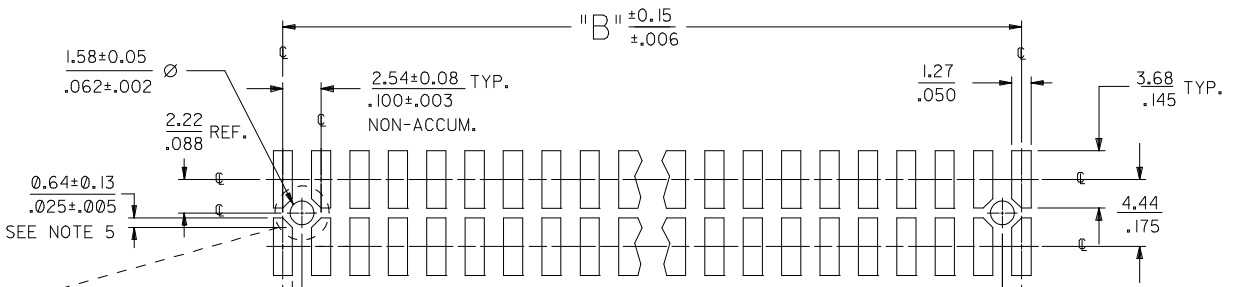

RECOMMENDED P.C. BOARD PAD LAYOUT



P.C. BOARD PAD LAYOUT AT ENDS FOR NO PEG VERSION.

FOR PARTS WITH PEGS
FOR PARTS WITHOUT PEGS

ROW "A"
ROW "B"

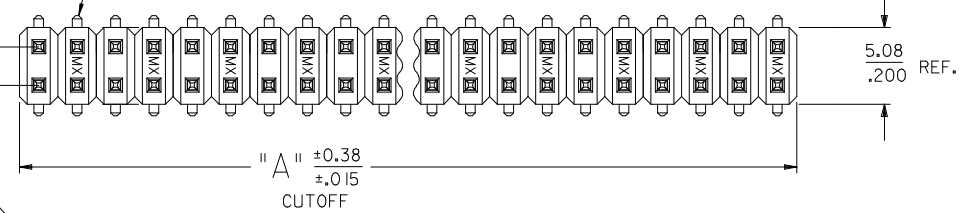

USED TO LOCATE VOIDED CIRCUITS

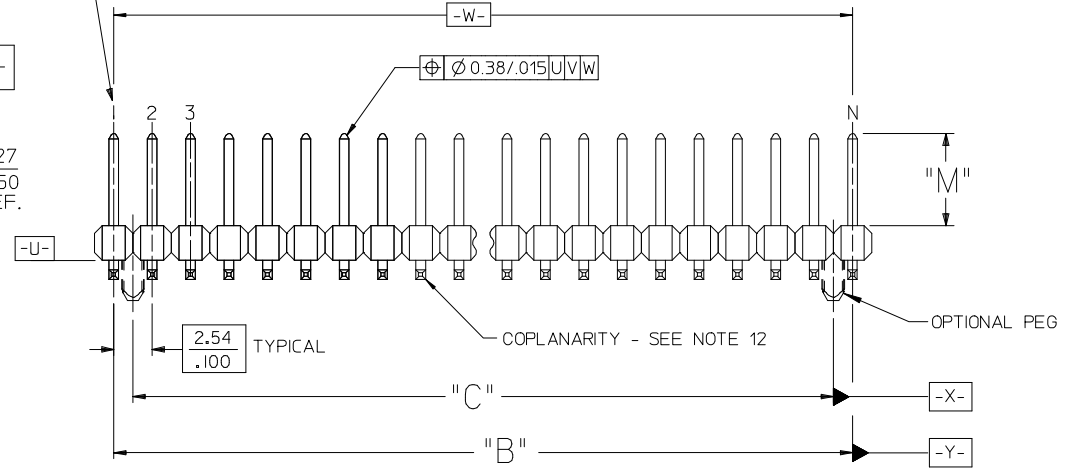
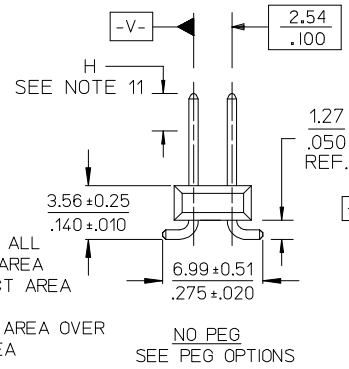

12. COPLANARITY FOR CIRCUIT SIZES UP TO 40 IS 0.15 MM/.006 INCH.
FOR CIRCUIT SIZES 42 AND LARGER, CONTACT MOLEX SALES DEPARTMENT.

CORRECT DIM. H	REV	DESCRIPTION	QUALITY SYMBOLS	GENERAL TOLERANCES (UNLESS SPECIFIED)		DIMENSION STYLE		SCALE	DESIGN UNITS	THIRD ANGLE PROJECTION	
				mm	INCH	MM/IN	MM/IN				
G5			=0 =0 =0	4 PLACES	± ---	± ---	DRAWN BY RKA DATE 04/07/19	TITLE SALES ASSY INSULATOR DUAL ROW SMT W/BREAK-OFF .025SQ PIN GULLWING .100	DOCUMENT NO. SD-71308-002	SHEET NO. 1 OF 5	
				3 PLACES	± ---	± .005					CHECKED BY DATE
				2 PLACES	± 0.13	± .010					BBARKER 04/07/19
				1 PLACE	± 0.25	± ---					APPROVED BY DATE
				0 PLACE	± ---	± ---					FSMITH 2013/09/03
				ANGULAR ±1/2°		MATERIAL NO.					
				DRAFT WHERE APPLICABLE MUST REMAIN WITHIN DIMENSIONS		SEE CHARTS					
				SIZE C		THIS DRAWING CONTAINS INFORMATION THAT IS PROPRIETARY TO MOLEX INCORPORATED AND SHOULD NOT BE USED WITHOUT WRITTEN PERMISSION					

	13		12		11		10		9		8		7		6		5		4		3		2		1			
J	PACKAGING SEE NOTE 4 SHT 1				4-6 CKT		BULK		TAPE-N-REEL W/ VAC CAPS		N/A		BULK		TAPE-N-REEL W/ VAC CAPS		N/A		BULK		TAPE-N-REEL W/ VAC CAPS		N/A		BULK		BULK	
					8-100 CKT		TUBES		TAPE-N-REEL W/ VAC CAPS		TUBES W/ VAC CAPS		TUBES		TAPE-N-REEL W/ VAC CAPS		TUBES W/ VAC CAPS		TUBES		TAPE-N-REEL W/ VAC CAPS		TUBES W/ VAC CAPS		TUBES		TUBES	
	DIM. M±0.25 MM				6.10 (.240)				6.10 (.240)				6.10 (.240)				8.13 (.320)				8.13 (.320)							
	PLATING				TIN				15 GOLD				30 GOLD				15 GOLD				30 GOLD							
	DIM. H				2.54 (.100)				2.54 (.100)				2.54 (.100)				4.57 (.180)				4.57 (.180)							
I	CKTS	DIM. A		DIM. B		EDP NUMBER	EDP NUMBER	EDP NUMBER	EDP NUMBER	EDP NUMBER	EDP NUMBER	EDP NUMBER	EDP NUMBER	EDP NUMBER	EDP NUMBER	EDP NUMBER	EDP NUMBER	EDP NUMBER	EDP NUMBER	EDP NUMBER	EDP NUMBER	EDP NUMBER	EDP NUMBER	EDP NUMBER	EDP NUMBER	EDP NUMBER	EDP NUMBER	CKTS
		MM	IN	MM	IN																							
04	5.08	.200	2.54	.100																							04	
06	7.62	.300	5.08	.200	71308-9060									71308-9061													06	
08	10.16	.400	7.62	.300	71308-9080																						08	
10	12.70	.500	10.16	.400	71308-3210									71308-3110													10	
12	15.24	.600	12.70	.500																							12	
14	17.78	.700	15.24	.600	71308-3214				71308-9140					71308-9147													14	
16	20.32	.800	17.78	.700																							16	
18	22.86	.900	20.32	.800																							18	
20	25.40	1.000	22.86	.900					71308-9200																		20	
22	27.94	1.100	25.40	1.000																							22	
24	30.48	1.200	27.94	1.100		71308-2240																					24	
26	33.02	1.300	30.48	1.200																							26	
28	35.56	1.400	33.02	1.300																							28	
30	38.10	1.500	35.56	1.400																							30	
32	40.64	1.600	38.10	1.500																							32	
34	43.18	1.700	40.64	1.600																							34	
36	45.72	1.800	43.18	1.700																							36	
38	48.26	1.900	45.72	1.800																							38	
40	50.80	2.000	48.26	1.900																							40	
42	53.34	2.100	50.80	2.000																							42	
44	55.88	2.200	53.34	2.100																							44	
46	58.42	2.300	55.88	2.200																							46	
48	60.96	2.400	58.42	2.300																							48	
50	63.50	2.500	60.96	2.400																							50	
52	66.04	2.600	63.50	2.500																							52	
54	68.58	2.700	66.04	2.600																							54	
56	71.12	2.800	68.58	2.700																							56	
58	73.66	2.900	71.12	2.800																							58	
60	76.20	3.000	73.66	2.900																							60	
62	78.74	3.100	76.20	3.000																							62	
64	81.28	3.200	78.74	3.100																							64	
66	83.82	3.300	81.28	3.200																							66	
68	86.36	3.400	83.82	3.300																							68	
70	88.90	3.500	86.36	3.400																							70	
72	91.44	3.600	88.90	3.500																							72	
74	93.98	3.700	91.44	3.600																							74	
76	96.52	3.800	93.98	3.700																							76	
78	99.06	3.900	96.52	3.800																							78	
80	101.60	4.000	99.06	3.900																							80	
82	104.14	4.100	101.60	4.000																							82	
84	106.68	4.200	104.14	4.100																							84	
86	109.22	4.300	106.68	4.200																							86	
88	111.76	4.400	109.22	4.300																							88	
90	114.30	4.500	111.76	4.400																							90	
92	116.84	4.600	114.30	4.500																							92	
94	119.38	4.700	116.84	4.600																							94	
96	121.92	4.800	119.38	4.700																							96	
98	124.46	4.900	121.92	4.800																							98	
100	127.00	5.000	124.46	4.900																							100	

NO PEG VERSION
(SEE ALSO SHEET 3)

SEE SHEET 1 EC NO: UCP2014-0809 DRAWN: KIPPER 2013/08/23 CHKD: BELM 2013/08/23 APPR: FSMITH 2013/09/03	QUALITY SYMBOLS ▽=0 ▽=0 ▽=0	GENERAL TOLERANCES (UNLESS SPECIFIED)	DIMENSION STYLE		SCALE	DESIGN UNITS	THIRD ANGLE PROJECTION
			MM/IN		---	INCH	
			mm	INCH	DRAWN BY	DATE	
			4 PLACES ± ---	± ---	RKA	04/07/19	
			3 PLACES ± ---	± .005	CHECKED BY	DATE	
2 PLACES ± 0.13	± .010	BBARKER	04/07/19				
1 PLACE ± 0.25	± ---	APPROVED BY	DATE				
0 PLACE ± ---	± ---	FSMITH	2013/09/03				
ANGULAR ±1/2°		MATERIAL NO.		DOCUMENT NO.		SHEET NO.	
DRAFT WHERE APPLICABLE MUST REMAIN WITHIN DIMENSIONS		SEE CHARTS		SD-71308-002		2 OF 5	
THIS DRAWING CONTAINS INFORMATION THAT IS PROPRIETARY TO MOLEX INCORPORATED AND SHOULD NOT BE USED WITHOUT WRITTEN PERMISSION							

		13	12	11	10	9	8	7	6	5	4	3	2	1
		IN TAPE AND REEL WITH SHALLOW POCKET TAPE										BULK / IN TUBES		
J	PACKAGING SEE NOTE 4 SHT 1		4-8 CKT 10-100 CKT		TAPE-N-REEL W/ VAC CAPS	TAPE-N-REEL W/ VAC CAPS				TAPE-N-REEL W/ VAC CAPS		BULK		
	DIM. M±0.25 MM				6.10 (.240)	6.10 (.240)				8.13 (.320)		8.13 (.320)		
	PLATING				30 GOLD	15 GOLD				TIN		TIN		
	DIM. H				2.54 (.100)	2.54 (.100)				4.57 (.180)		4.57 (.180)		
I	CKTS	DIM. A		DIM. B		EDP NUMBER	EDP NUMBER			EDP NUMBER		EDP NUMBER		CKTS
		MM	IN	MM	IN									
04	5.08	.200	2.54	.100								713088004		04
06	7.62	.300	5.08	.200								713088006		06
08	10.16	.400	7.62	.300								713088008		08
10	12.70	.500	10.16	.400								713088010		10
12	15.24	.600	12.70	.500								713088012		12
14	17.78	.700	15.24	.600								713088014		14
16	20.32	.800	17.78	.700								713088016		16
18	22.86	.900	20.32	.800								713088018		18
20	25.40	1.000	22.86	.900								713088020		20
22	27.94	1.100	25.40	1.000								713088022		22
24	30.48	1.200	27.94	1.100						713088124		713088024		24
26	33.02	1.300	30.48	1.200								713088026		26
28	35.56	1.400	33.02	1.300								713088028		28
30	38.10	1.500	35.56	1.400								713088030		30
32	40.64	1.600	38.10	1.500								713088032		32
34	43.18	1.700	40.64	1.600								713088034		34
36	45.72	1.800	43.18	1.700								713088036		36
38	48.26	1.900	45.72	1.800								713088038		38
40	50.80	2.000	48.26	1.900								713088040		40
42	53.34	2.100	50.80	2.000								713088042		42
44	55.88	2.200	53.34	2.100								713088044		44
46	58.42	2.300	55.88	2.200								713088046		46
48	60.96	2.400	58.42	2.300								713088048		48
50	63.50	2.500	60.96	2.400								713088050		50
52	66.04	2.600	63.50	2.500								713088052		52
54	68.58	2.700	66.04	2.600								713088054		54
56	71.12	2.800	68.58	2.700								713088056		56
58	73.66	2.900	71.12	2.800								713088058		58
60	76.20	3.000	73.66	2.900								713088060		60
62	78.74	3.100	76.20	3.000								713088062		62
64	81.28	3.200	78.74	3.100								713088064		64
66	83.82	3.300	81.28	3.200								713088066		66
68	86.36	3.400	83.82	3.300								713088068		68
70	88.90	3.500	86.36	3.400								713088070		70
72	91.44	3.600	88.90	3.500								713088072		72
74	93.98	3.700	91.44	3.600								713088074		74
76	96.52	3.800	93.98	3.700								713088076		76
78	99.06	3.900	96.52	3.800								713088078		78
80	101.60	4.000	99.06	3.900								713088080		80
82	104.14	4.100	101.60	4.000										82
84	106.68	4.200	104.14	4.100										84
86	109.22	4.300	106.68	4.200										86
88	111.76	4.400	109.22	4.300										88
90	114.30	4.500	111.76	4.400										90
92	116.84	4.600	114.30	4.500										92
94	119.38	4.700	116.84	4.600										94
96	121.92	4.800	119.38	4.700										96
98	124.46	4.900	121.92	4.800										98
100	127.00	5.000	124.46	4.900										100

NO PEG VERSION
(ALSO SEE SHEET 2)

SEE SHEET 1 EC NO: UCP2014-0809 DRAWN: KIPPER 2013/08/23 CHKD: J.BELL 2013/08/23 APPR: F.SMITH 2013/09/03	QUALITY SYMBOLS	GENERAL TOLERANCES (UNLESS SPECIFIED)	DIMENSION STYLE	SCALE	DESIGN UNITS	THIRD ANGLE PROJECTION
	▽=0	mm INCH	MM/IN	---	INCH	
	▽=0	4 PLACES ± --- ± ---	DRAWN BY DATE			TITLE
	▽=0	3 PLACES ± --- ± .005	RKA 04/07/19			SALES ASSY INSULATOR
		2 PLACES ± 0.13 ± .010	CHECKED BY DATE			DUAL ROW SMT W/BREAK-OFF
	1 PLACE ± 0.25 ± ---	BBARKER 04/07/19			.025SQ PIN GULLWING .100	
	0 PLACE ± --- ± ---	APPROVED BY DATE				
		F.SMITH 2013/09/03				
	ANGULAR ±1/2°	MATERIAL NO.			DOCUMENT NO.	
	DRAFT WHERE APPLICABLE MUST REMAIN WITHIN DIMENSIONS	SEE CHARTS			SD-71308-002	SHEET NO. 3 OF 5
		SIZE C			THIS DRAWING CONTAINS INFORMATION THAT IS PROPRIETARY TO MOLEX INCORPORATED AND SHOULD NOT BE USED WITHOUT WRITTEN PERMISSION	

13	12	11	10	9	8	7	6	5	4	3	2	1	
PACKAGING SEE NOTE 4 SHT 1		4-8 CKT	BULK	TAPE-N-REEL W/ VAC CAPS	BULK	TAPE-N-REEL W/ VAC CAPS	BULK	TAPE-N-REEL W/ VAC CAPS	BULK	BULK	BULK		
		8-100 CKT	TUBES	TAPE-N-REEL W/ VAC CAPS	TUBES	TAPE-N-REEL W/ VAC CAPS	TUBES	TAPE-N-REEL W/ VAC CAPS	TUBES	TUBES	TUBES		
DIM. M ±0.25 MM			6.10 (.240)			6.10 (.240)			6.10 (.240)		8.13 (.320)	8.13 (.320)	8.13 (.320)
PLATING			TIN			15 GOLD			30 GOLD		TIN	15 GOLD	30 GOLD
DIM. H			2.54 (.100)			2.54 (.100)			2.54 (.100)		4.57 (.180)	4.57 (.180)	4.57 (.180)

CKTS	DIM. A		DIM. B		DIM. C		EDP NUMBER	EDP NUMBER	EDP NUMBER	EDP NUMBER	EDP NUMBER	EDP NUMBER	EDP NUMBER	EDP NUMBER	EDP NUMBER	EDP NUMBER	CKTS
	MM	IN	MM	IN	MM	IN											
04	5.08	.200	2.54	.100	----	----											04
06	7.62	.300	5.08	.200	2.54	.100											06
08	10.16	.400	7.62	.300	5.08	.200											08
10	12.70	.500	10.16	.400	7.62	.300			71308-1102								10
12	15.24	.600	12.70	.500	10.16	.400											12
14	17.78	.700	15.24	.600	12.70	.500											14
16	20.32	.800	17.78	.700	15.24	.600	71308-9160										16
18	22.86	.900	20.32	.800	17.78	.700											18
20	25.40	1.000	22.86	.900	20.32	.800											20
22	27.94	1.100	25.40	1.000	22.86	.900											22
24	30.48	1.200	27.94	1.100	25.40	1.000											24
26	33.02	1.300	30.48	1.200	27.94	1.100											26
28	35.56	1.400	33.02	1.300	30.48	1.200											28
30	38.10	1.500	35.56	1.400	33.02	1.300											30
32	40.64	1.600	38.10	1.500	35.56	1.400											32
34	43.18	1.700	40.64	1.600	38.10	1.500											34
36	45.72	1.800	43.18	1.700	40.64	1.600											36
38	48.26	1.900	45.72	1.800	43.18	1.700											38
40	50.80	2.000	48.26	1.900	45.72	1.800											40
42	53.34	2.100	50.80	2.000	48.26	1.900											42
44	55.88	2.200	53.34	2.100	50.80	2.000											44
46	58.42	2.300	55.88	2.200	53.34	2.100											46
48	60.96	2.400	58.42	2.300	55.88	2.200											48
50	63.50	2.500	60.96	2.400	58.42	2.300											50
52	66.04	2.600	63.50	2.500	60.96	2.400											52
54	68.58	2.700	66.04	2.600	63.50	2.500											54
56	71.12	2.800	68.58	2.700	66.04	2.600											56
58	73.66	2.900	71.12	2.800	68.58	2.700											58
60	76.20	3.000	73.66	2.900	71.12	2.800											60
62	78.74	3.100	76.20	3.000	73.66	2.900											62
64	81.28	3.200	78.74	3.100	76.20	3.000											64
66	83.82	3.300	81.28	3.200	78.74	3.100											66
68	86.36	3.400	83.82	3.300	81.28	3.200											68
70	88.90	3.500	86.36	3.400	83.82	3.300											70
72	91.44	3.600	88.90	3.500	86.36	3.400											72
74	93.98	3.700	91.44	3.600	88.90	3.500											74
76	96.52	3.800	93.98	3.700	91.44	3.600											76
78	99.06	3.900	96.52	3.800	93.98	3.700											78
80	101.60	4.000	99.06	3.900	96.52	3.800											80
82	104.14	4.100	101.60	4.000	99.06	3.900											82
84	106.68	4.200	104.14	4.100	101.60	4.000											84
86	109.22	4.300	106.68	4.200	104.14	4.100											86
88	111.76	4.400	109.22	4.300	106.68	4.200											88
90	114.30	4.500	111.76	4.400	109.22	4.300											90
92	116.84	4.600	114.30	4.500	111.76	4.400											92
94	119.38	4.700	116.84	4.600	114.30	4.500											94
96	121.92	4.800	119.38	4.700	116.84	4.600											96
98	124.46	4.900	121.92	4.800	119.38	4.700											98
100	127.00	5.000	124.46	4.900	121.92	4.800											100

LONG PEG VERSION (.130")

SEE SHEET 1 EC NO: UCP2014-0809 DRAWN: KIPPER 2013/08/23 CHKD: BELL 2013/08/23 APPR: FSMITH 2013/09/03	QUALITY SYMBOLS 	GENERAL TOLERANCES (UNLESS SPECIFIED)		DIMENSION STYLE MM/IN		SCALE ---	DESIGN UNITS INCH	THIRD ANGLE PROJECTION		
						DRAWN BY RKA		DATE 04/07/19		SALES ASSY INSULATOR DUAL ROW SMT W/BREAK-OFF .025SQ PIN GULLWING .100 molex
						CHECKED BY BBARKER		DATE 04/07/19		
						APPROVED BY FSMITH		DATE 2013/09/03		
				ANGULAR ±1/2°		MATERIAL NO.		DOCUMENT NO.		
		DRAFT WHERE APPLICABLE MUST REMAIN WITHIN DIMENSIONS		SEE CHARTS		SD-71308-002				
				SIZE C		THIS DRAWING CONTAINS INFORMATION THAT IS PROPRIETARY TO MOLEX INCORPORATED AND SHOULD NOT BE USED WITHOUT WRITTEN PERMISSION		SHEET NO. 4 OF 5		

13	12	11	10	9	8	7	6	5	4	3	2	1
		PACKAGING SEE NOTE 4 SHT 1		4-8 CKT	BULK	TAPE-N-REEL W/ VAC CAPS						
				10-100 CKT	TUBES	TAPE-N-REEL W/ VAC CAPS						
		DIM. M+0.25 MM		6.10 (.240)								
		PLATING		30 GOLD								
		DIM. H		2.54 (.100)								

CKTS	DIM. A		DIM. B		DIM. C		EDP NUMBER	EDP NUMBER	EDP NUMBER	EDP NUMBER	EDP NUMBER	EDP NUMBER	EDP NUMBER	EDP NUMBER	EDP NUMBER	CKTS
	MM	IN	MM	IN	MM	IN										
04	5.08	.200	2.54	.100	----	----										04
06	7.62	.300	5.08	.200	2.54	.100										06
08	10.16	.400	7.62	.300	5.08	.200										08
10	12.70	.500	10.16	.400	7.62	.300										10
12	15.24	.600	12.70	.500	10.16	.400										12
14	17.78	.700	15.24	.600	12.70	.500										14
16	20.32	.800	17.78	.700	15.24	.600										16
18	22.86	.900	20.32	.800	17.78	.700										18
20	25.40	1.000	22.86	.900	20.32	.800										20
22	27.94	1.100	25.40	1.000	22.86	.900										22
24	30.48	1.200	27.94	1.100	25.40	1.000										24
26	33.02	1.300	30.48	1.200	27.94	1.100										26
28	35.56	1.400	33.02	1.300	30.48	1.200										28
30	38.10	1.500	35.56	1.400	33.02	1.300										30
32	40.64	1.600	38.10	1.500	35.56	1.400										32
34	43.18	1.700	40.64	1.600	38.10	1.500										34
36	45.72	1.800	43.18	1.700	40.64	1.600										36
38	48.26	1.900	45.72	1.800	43.18	1.700										38
40	50.80	2.000	48.26	1.900	45.72	1.800										40
42	53.34	2.100	50.80	2.000	48.26	1.900										42
44	55.88	2.200	53.34	2.100	50.80	2.000										44
46	58.42	2.300	55.88	2.200	53.34	2.100										46
48	60.96	2.400	58.42	2.300	55.88	2.200										48
50	63.50	2.500	60.96	2.400	58.42	2.300										50
52	66.04	2.600	63.50	2.500	60.96	2.400										52
54	68.58	2.700	66.04	2.600	63.50	2.500										54
56	71.12	2.800	68.58	2.700	66.04	2.600										56
58	73.66	2.900	71.12	2.800	68.58	2.700										58
60	76.20	3.000	73.66	2.900	71.12	2.800										60
62	78.74	3.100	76.20	3.000	73.66	2.900										62
64	81.28	3.200	78.74	3.100	76.20	3.000										64
66	83.82	3.300	81.28	3.200	78.74	3.100										66
68	86.36	3.400	83.82	3.300	81.28	3.200										68
70	88.90	3.500	86.36	3.400	83.82	3.300										70
72	91.44	3.600	88.90	3.500	86.36	3.400										72
74	93.98	3.700	91.44	3.600	88.90	3.500										74
76	96.52	3.800	93.98	3.700	91.44	3.600										76
78	99.06	3.900	96.52	3.800	93.98	3.700										78
80	101.60	4.000	99.06	3.900	96.52	3.800										80
82	104.14	4.100	101.60	4.000	99.06	3.900										82
84	106.68	4.200	104.14	4.100	101.60	4.000										84
86	109.22	4.300	106.68	4.200	104.14	4.100										86
88	111.76	4.400	109.22	4.300	106.68	4.200										88
90	114.30	4.500	111.76	4.400	109.22	4.300										90
92	116.84	4.600	114.30	4.500	111.76	4.400										92
94	119.38	4.700	116.84	4.600	114.30	4.500										94
96	121.92	4.800	119.38	4.700	116.84	4.600										96
98	124.46	4.900	121.92	4.800	119.38	4.700										98
100	127.00	5.000	124.46	4.900	121.92	4.800										100

SHORT PEG VERSION (.055")

SEE SHEET 1 EC NO: UCP2014-0809 DRAWN: KIPPER 2013/08/23 CHKD: J.BELL 2013/08/23 APPR: FSMITH 2013/09/03	QUALITY SYMBOLS ▽=0 ▽=0 ▽=0	GENERAL TOLERANCES (UNLESS SPECIFIED)		DIMENSION STYLE	SCALE	DESIGN UNITS	THIRD ANGLE PROJECTION	
				MM/IN	---	INCH	DRAWN BY: RKA DATE: 04/07/19 CHECKED BY: BBARKER DATE: 04/07/19 APPROVED BY: FSMITH DATE: 2013/09/03	TITLE: SALES ASSY INSULATOR DUAL ROW SMT W/BREAK-OFF .025SQ PIN GULLWING .100 molex
				mm	---	---		
				ANGULAR ±1/2°		SEE CHARTS		SHEET NO. 5 OF 5

DRAFT WHERE APPLICABLE MUST REMAIN WITHIN DIMENSIONS

THIS DRAWING CONTAINS INFORMATION THAT IS PROPRIETARY TO MOLEX INCORPORATED AND SHOULD NOT BE USED WITHOUT WRITTEN PERMISSION