

Material and Finish

Shell: Steel, Nickel Plated
 Insulator: High Temperature with glass-fiber reinforcement, UL94V-0 rated
 Color: Black
 Contact Material:
 Socket - Phosphor Bronze
 Contact Plating Options:
 Standard: gold flash on mating end, tin on termination end, nickel underplate on entire contact
 15 Option: 15u" gold on mating end, tin on termination end, nickel underplate on entire contact
 30 Option: 30u" gold on mating end, tin on termination end, nickel underplate on entire contact

Electrical Specifications

Rated Current: 1.5A
 Rated Voltage: 29V RMS
 Insulation Resistance: more than 1000 megohms at 500V DC
 Contact Resistance: 13 milliohms max.
 Dielectric Withstanding Voltage: 1000V for 1 minute
 Operating Temperature: -55°C to +105°C

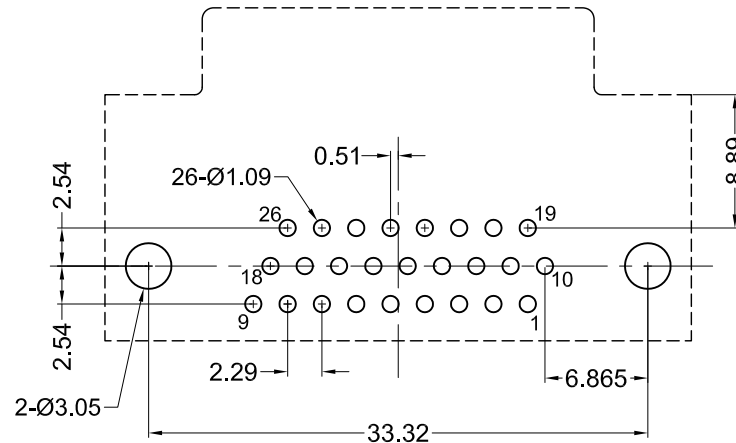
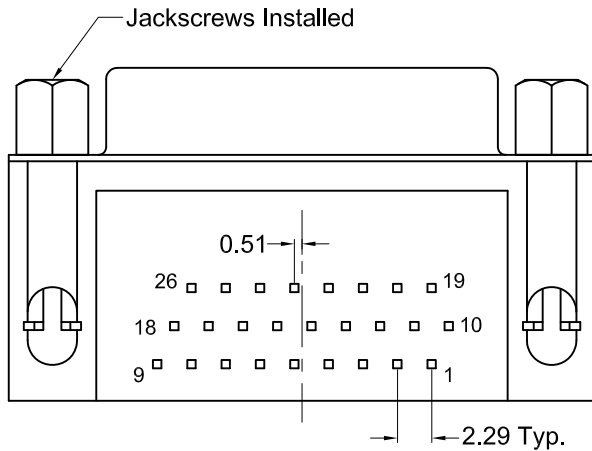

Recommended PCB Layout
(Bottom View)

Part Number	Contact Area Plating Finish
K66XHT-A26S-NJ	Gold Flash (standard)
K66XHT-A26S-NJ15	15u" Gold (15 option)
K66XHT-A26S-NJ30	30u" Gold (30 option)



Tolerances
X.X ± 0.25
X.XX ± 0.15
Unless Stated Otherwise

REV.	DATE	DESCRIPTION	REV. BY	CHK. BY	DRAWN BY	DATE
A1	11/07/06	New Drawing	R. Aguirre	H. MA	R. Aguirre	11/06/06
A2	03/10/08	ECO # 07-049	S. Vien	H. Ma		
A3	12/09/08	ECO # 08-084	S. Vien	H. MA		
A4	08/05/09	ECO # 09-057	S. Vien	H. MA		
A5	01/25/16	ECO #15-019	H. MA	W. Cook		

K66XHT-A26S-NJ

HD, D-Sub, High Temp., RoHS Compliant

JS, 26 Pos., Female, BoardLocks

