

4

3

2

1

|                              |                          |                      |
|------------------------------|--------------------------|----------------------|
| THIS DRAWING IS UNPUBLISHED. | RELEASED FOR PUBLICATION | 20                   |
| © COPYRIGHT 20               | BY -                     | ALL RIGHTS RESERVED. |

| REVISIONS |     |                        |           |        |
|-----------|-----|------------------------|-----------|--------|
| P         | LTR | DESCRIPTION            | DATE      | APVD   |
|           | A   | RELEASED ECO-14-002997 | 24MAR2014 | LAW SB |
|           |     |                        |           |        |
|           |     |                        |           |        |

2149701-1  
SCALE 5:1

1 MATERIALS:  
HOUSING - ZINC ALLOY  
RECEPTACLE HOUSING - LCP, BLACK, UL 94V-0 RATED  
CHICKLET - LCP, BLACK, UL 94V-0 RATED  
CONTACT - PHOSPHOR BRONZE  
EMI SPRING - COPPER ALLOY

2 FINISH:  
CONTACT - CONFORMS TO THE REQUIREMENTS OF TE PRODUCT SPECIFICATION 108-2426, BASED ON EIA/ECA-364-1000.01A, (CONTROLLED ENVIRONMENT APPLICATIONS) ON MATING INTERFACE,  
MATTE TIN PLATE OVER NICKEL UNDER PLATE ON COMPLIANT PIN  
HOUSING - NICKEL PLATED

3 NOTE DELETED

4 MOUNTING HARDWARE REQUIRED:  
M2X0.4 (4): MOUNTING SCREW LENGTH = BOARD THICKNESS + 8mm MAX

5 THE ENTIRE AREA OF THE CONNECTOR FOOTPRINT, INDICATED BY CROSSHATCHING, TO BE CONSIDERED THE KEEPOUT AREA FOR COMPONENTS AND SIGNAL TRACES, TOP SIDE ONLY, TOP SIDE TRACES ALLOWED WITHIN CONNECTOR HOLE PATTERN, CROSSHATCHING TO BE CONDUCTIVE

6 PCB THICKNESS = 1.44 MIN

1 FOR HOLE SIZE AND FINISHES SEE APPLICATION SPECIFICATION 114-13283

|          |        |                                 |             |
|----------|--------|---------------------------------|-------------|
| OBSOLETE | 3      | 84 POSITION RECEPTACLE ASSEMBLY | 2149701-2   |
|          | 2      | 84 POSITION RECEPTACLE ASSEMBLY | 2149701-1   |
|          | FINISH | DESCRIPTION                     | PART NUMBER |

|  |  |                                     |  |                         |
|--|--|-------------------------------------|--|-------------------------|
| THIS DRAWING IS A CONTROLLED DOCUMENT. DIMENSIONING AND TOLERANCING PER ASME Y14.5M-2009 |  | DWN<br>M. E. COWHER<br>27SEP2010    | <b>STE</b> TE Connectivity   |                         |
| DIMENSIONS:<br>mm  |  | CHK<br>M. D. MORRISON<br>28SEP2010  |  |                         |
| TOLERANCES UNLESS OTHERWISE SPECIFIED:   |  | APVD<br>M. D. MORRISON<br>28SEP2010 | NAME<br>RECEPTACLE ASSEMBLY, BELLY-BELLY, STANDARD, 84 POSITION, CXP |                         |
| 0 PLC ±0.15<br>1 PLC ±0.15<br>2 PLC ±0.15<br>3 PLC ±<br>4 PLC ±                          |  | PRODUCT SPEC<br>108-2426            | SIZE<br>-  |                         |
| ANGLES ±1°   |  | APPLICATION SPEC<br>114-13283       | CAGE CODE<br>A200779   | DRAWING NO<br>C-2149701 |
| MATERIAL<br>1  |  | WEIGHT<br>-                         | RESTRICTED TO<br>-   |                         |
| FINISH<br>2  |  | Customer Drawing                    |  |                         |
|  |  | SCALE<br>1:1                        | SHEET<br>1 OF 4  | REV<br>A                |

1471-9 (3/13)

THIS DRAWING IS UNPUBLISHED. RELEASED FOR PUBLICATION 20  
 © COPYRIGHT 20 BY - ALL RIGHTS RESERVED.

| REVISIONS |     |             |      |      |
|-----------|-----|-------------|------|------|
| P         | LTR | DESCRIPTION | DATE | APVD |
| -         | -   | SEE SHEET 1 | -    | -    |
|           |     |             |      |      |
|           |     |             |      |      |

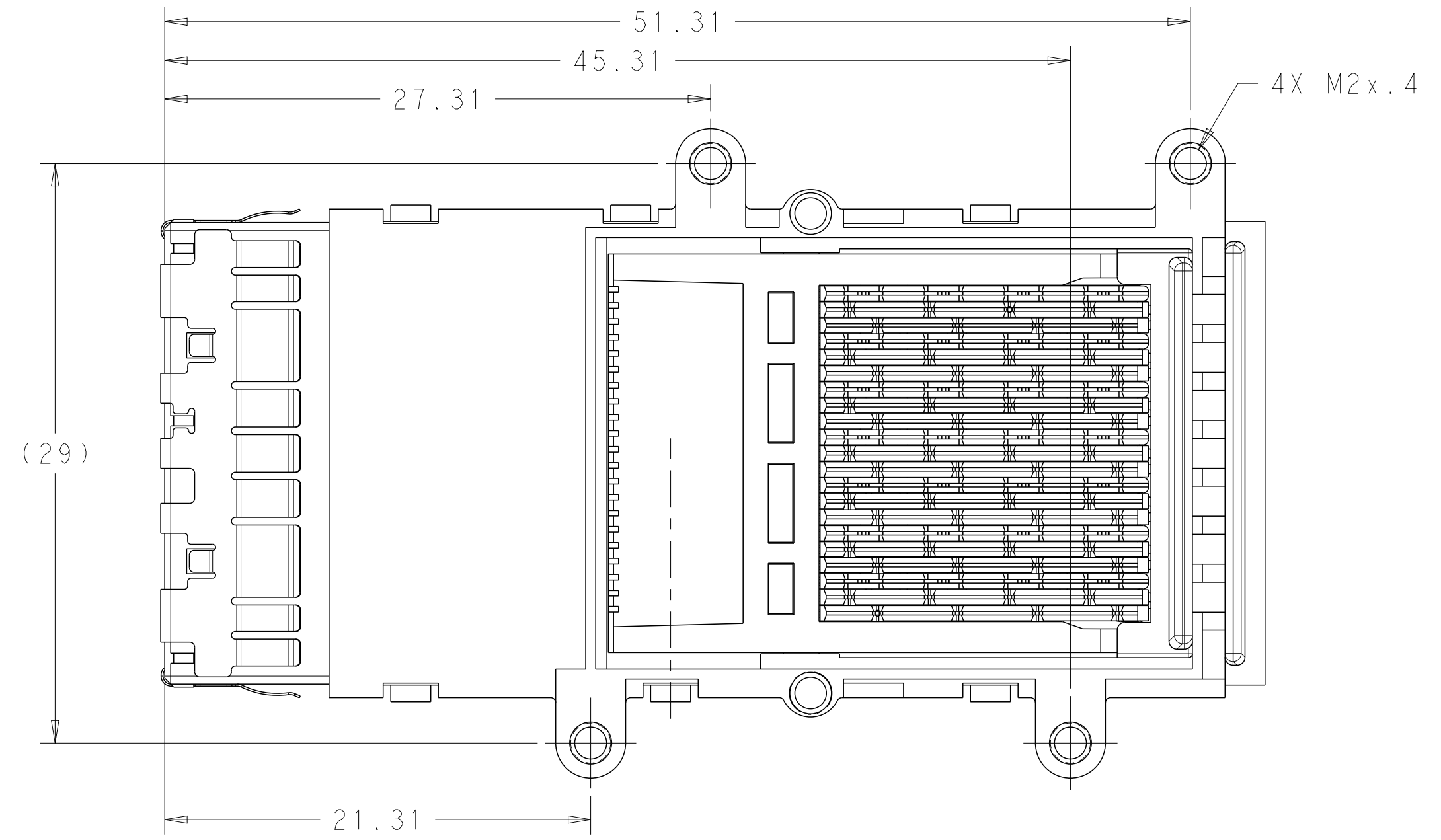
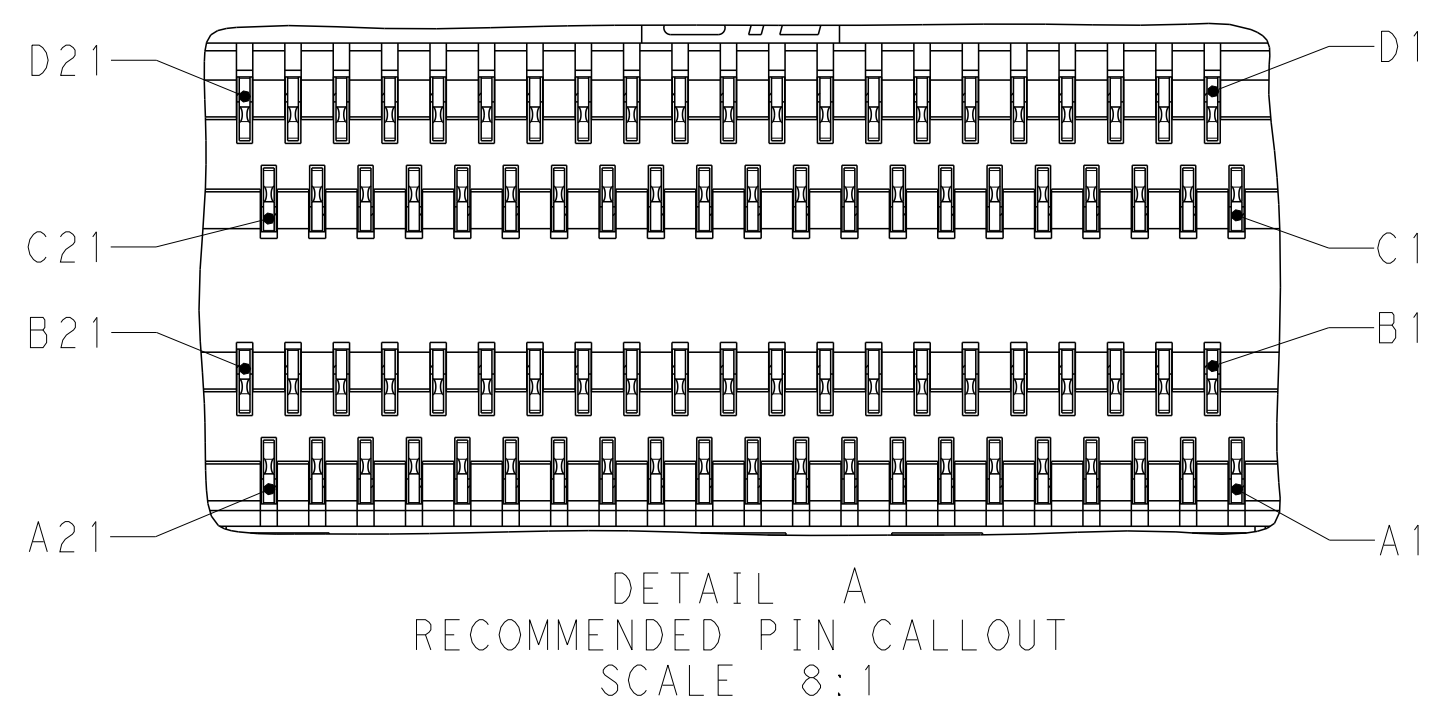
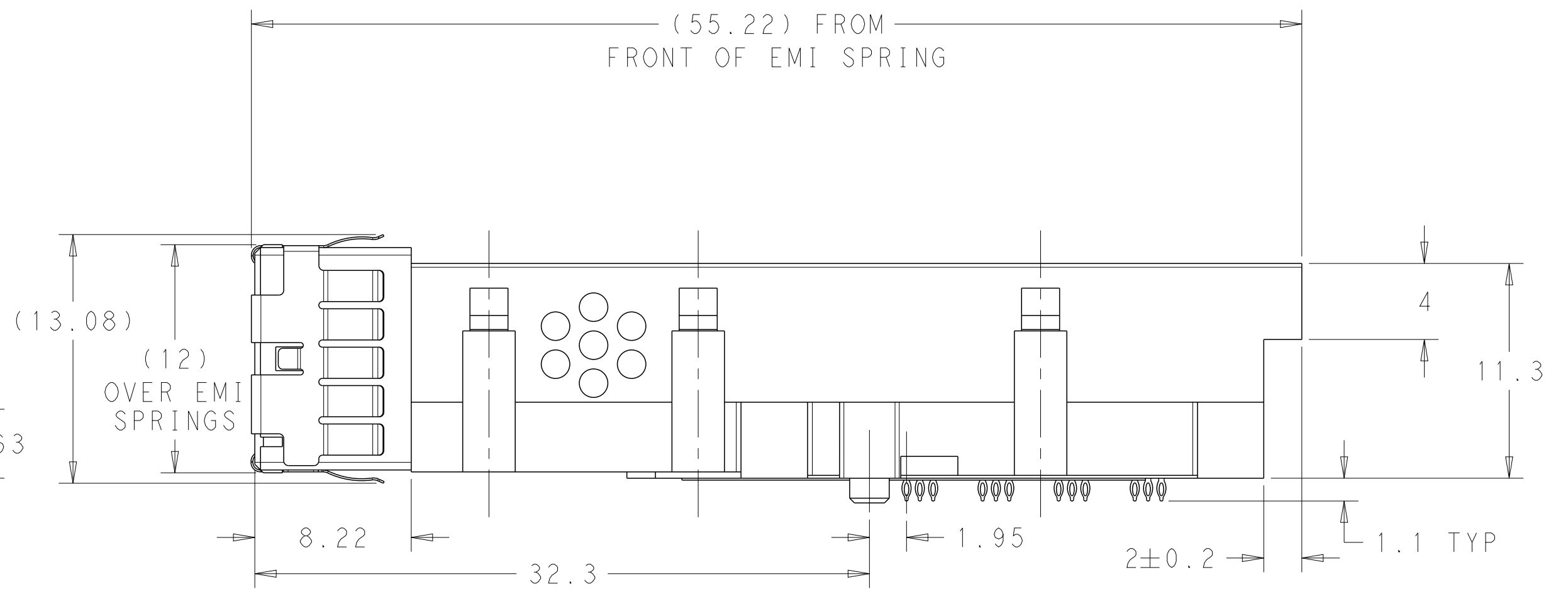
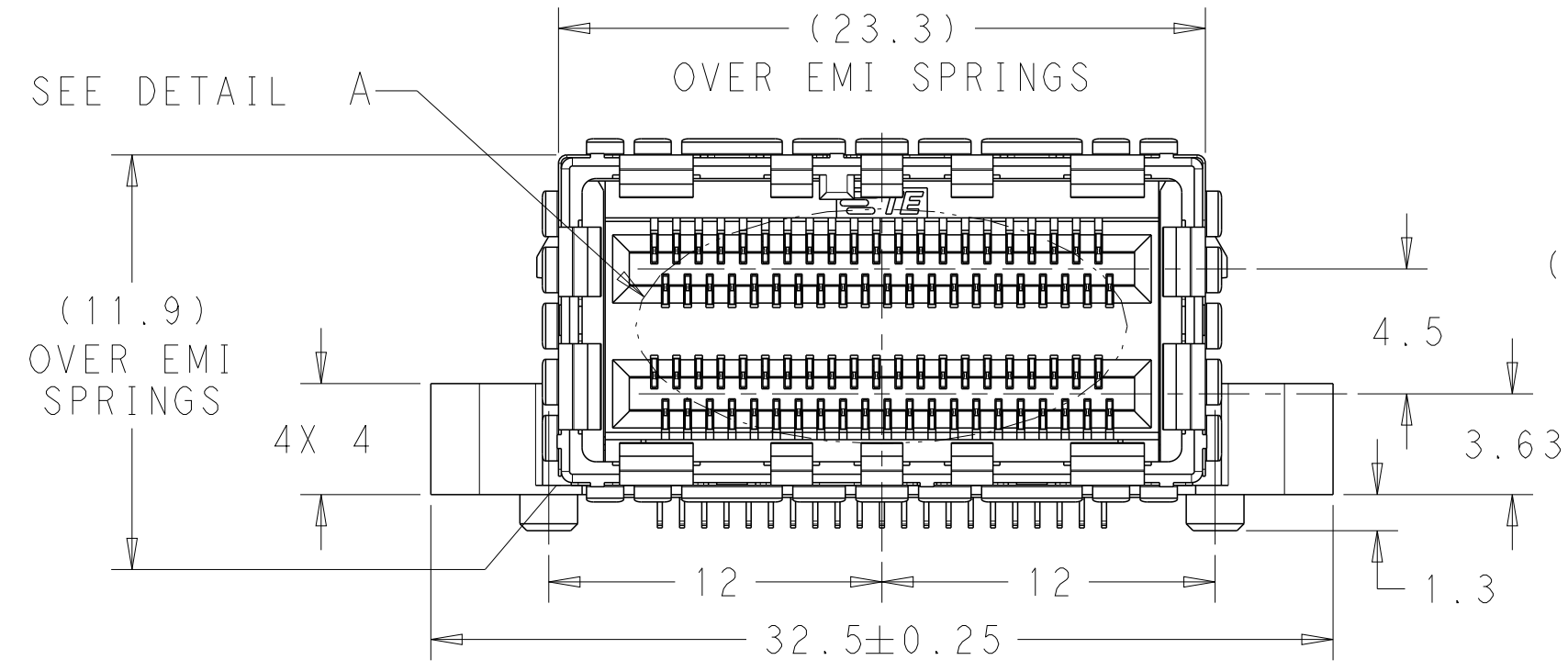

2149701-1  
SCALE 4:1

|   |  |                                     |                               |  |                      |
|---|--|-------------------------------------|-------------------------------|--|----------------------|
| THIS DRAWING IS A CONTROLLED DOCUMENT. DIMENSIONING AND TOLERANCING PER ASME Y14.5M-2009  |  | DWN<br>M. E. COWHER<br>27SEP2010    | TE Connectivity               | NAME<br>RECEPTACLE ASSEMBLY, BELLY-BELLY, STANDARD, 84 POSITION, CXP |                      |
| DIMENSIONS: mm  |  | CHK<br>M. D. MORRISON<br>28SEP2010  |                               | SIZE<br>108-2426   | CAGE CODE<br>A200779 |
| TOLERANCES UNLESS OTHERWISE SPECIFIED:  |  | APVD<br>M. D. MORRISON<br>28SEP2010 | APPLICATION SPEC<br>114-13283 | RESTRICTED TO  |                      |
| 0 PLC ±0.15<br>1 PLC ±0.15<br>2 PLC ±0.15<br>3 PLC ±<br>4 PLC ±<br>ANGLES ±1°<br>FINISH - |  | PRODUCT SPEC<br>108-2426            | WEIGHT<br>-                   | SCALE 1:1  | SHEET 2 OF 4         |
| MATERIAL  |  | Customer Drawing                    |                               | REV A  |                      |

THIS DRAWING IS UNPUBLISHED. RELEASED FOR PUBLICATION 20  
 © COPYRIGHT 20 BY - ALL RIGHTS RESERVED.

| REVISIONS |     |             |      |      |
|-----------|-----|-------------|------|------|
| P         | LTR | DESCRIPTION | DATE | APVD |
| -         | -   | SEE SHEET 1 | -    | -    |
|           |     |             |      |      |
|           |     |             |      |      |

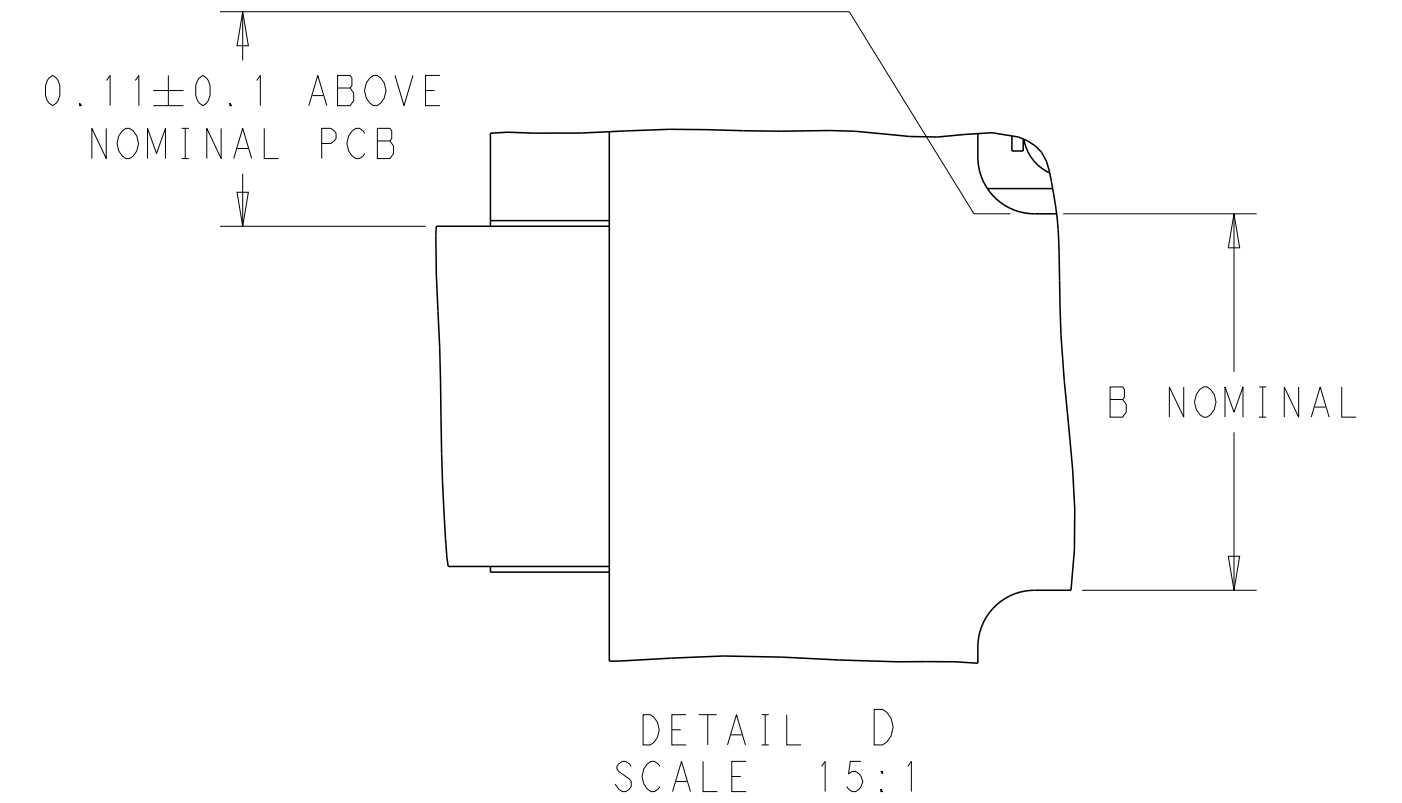
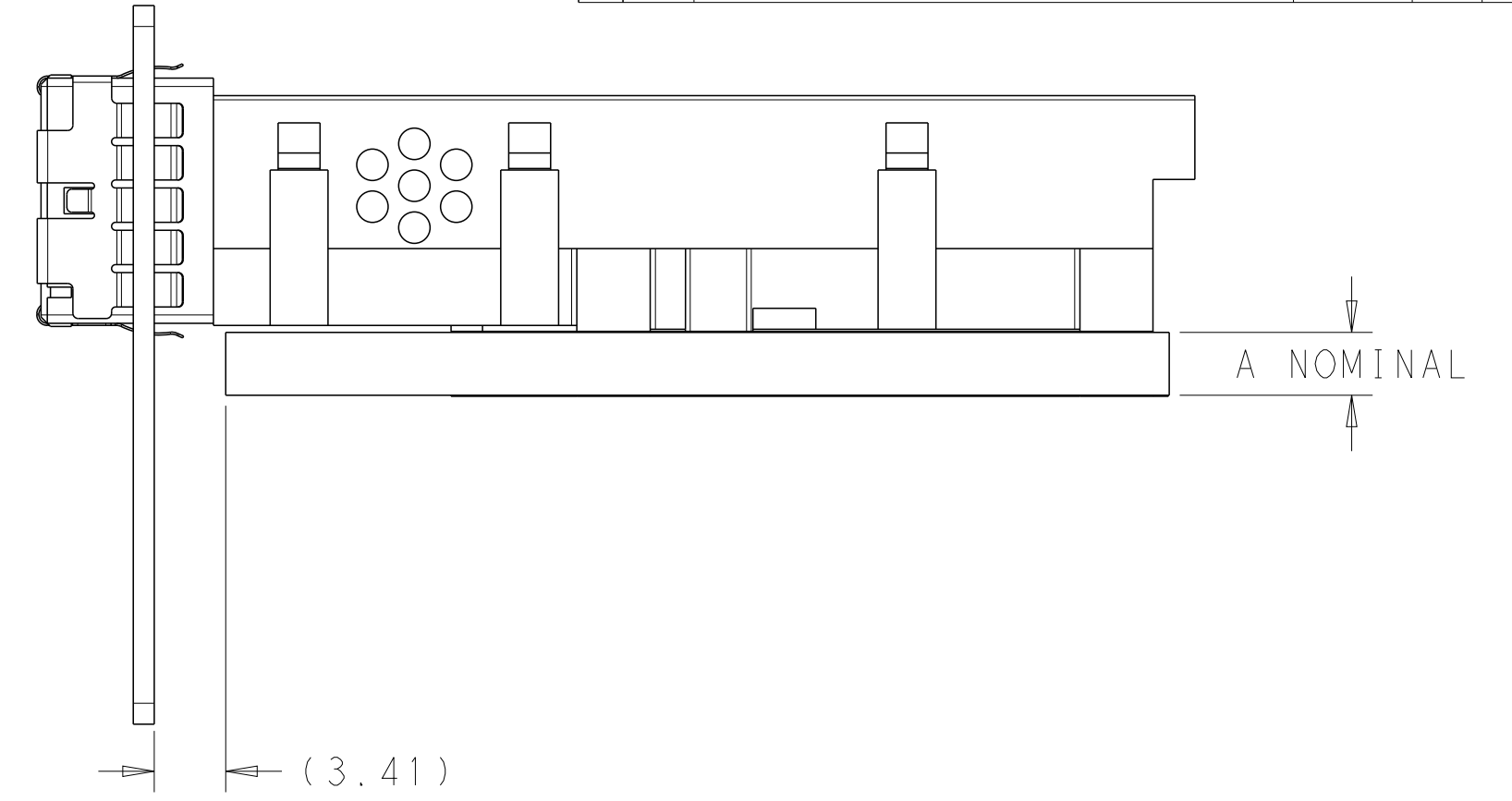
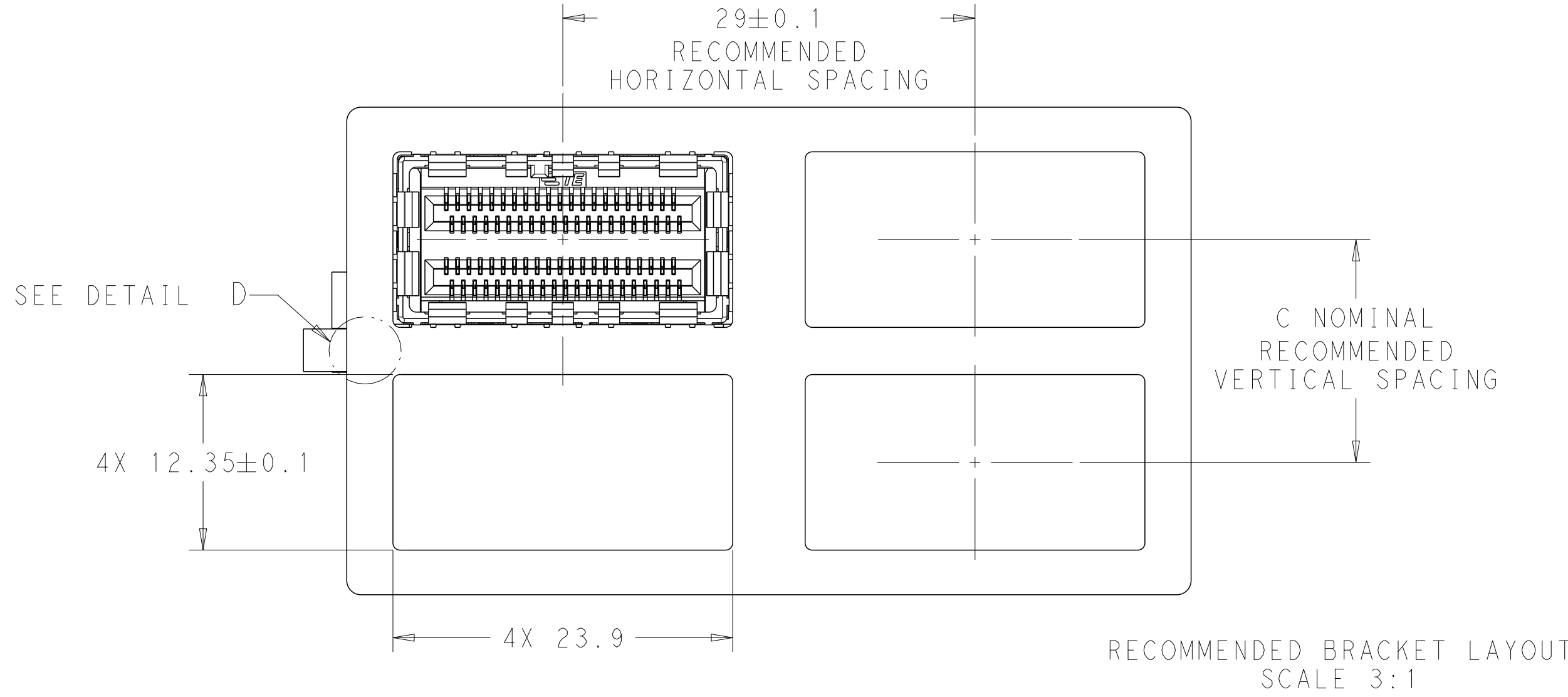

|         |        |               |
|---------|--------|---------------|
| 12.57+A | 0.22+A | PCB THICKNESS |
| C       | B      | A             |

|  |             |                                     |  |                        |
|--|-------------|-------------------------------------|--|------------------------|
| THIS DRAWING IS A CONTROLLED DOCUMENT. DIMENSIONING AND TOLERANCING PER ASME Y14.5M-2009 |             | DWN<br>M. E. COWHER<br>27SEP2010    | TE Connectivity  |                        |
| DIMENSIONS: mm   |             | CHK<br>M. D. MORRISON<br>28SEP2010  |  |                        |
| TOLERANCES UNLESS OTHERWISE SPECIFIED:   |             | APVD<br>M. D. MORRISON<br>28SEP2010 | NAME<br>RECEPTACLE ASSEMBLY, BELLY-BELLY, STANDARD, 84 POSITION, CXP |                        |
| 0 PLC ±0.15  | 1 PLC ±0.15 | PRODUCT SPEC<br>108-2426            | SIZE<br>A200779  | CAGE CODE<br>C-2149701 |
| 2 PLC ±0.15  | 3 PLC ±     | APPLICATION SPEC<br>114-13283       | DRAWING NO   |                        |
| 4 PLC ±  | ANGLES ±1°  | WEIGHT                              | RESTRICTED TO  |                        |
| FINISH   |             | Customer Drawing                    | SCALE 1:1  | SHEET 3 OF 4           |
|  |             |                                     |  | REV A                  |

THIS DRAWING IS UNPUBLISHED. RELEASED FOR PUBLICATION 20  
 © COPYRIGHT 20 BY - ALL RIGHTS RESERVED.

| REVISIONS |     |             |      |      |
|-----------|-----|-------------|------|------|
| P         | LTR | DESCRIPTION | DATE | APVD |
| -         | -   | SEE SHEET 1 | -    | -    |
|           |     |             |      |      |
|           |     |             |      |      |

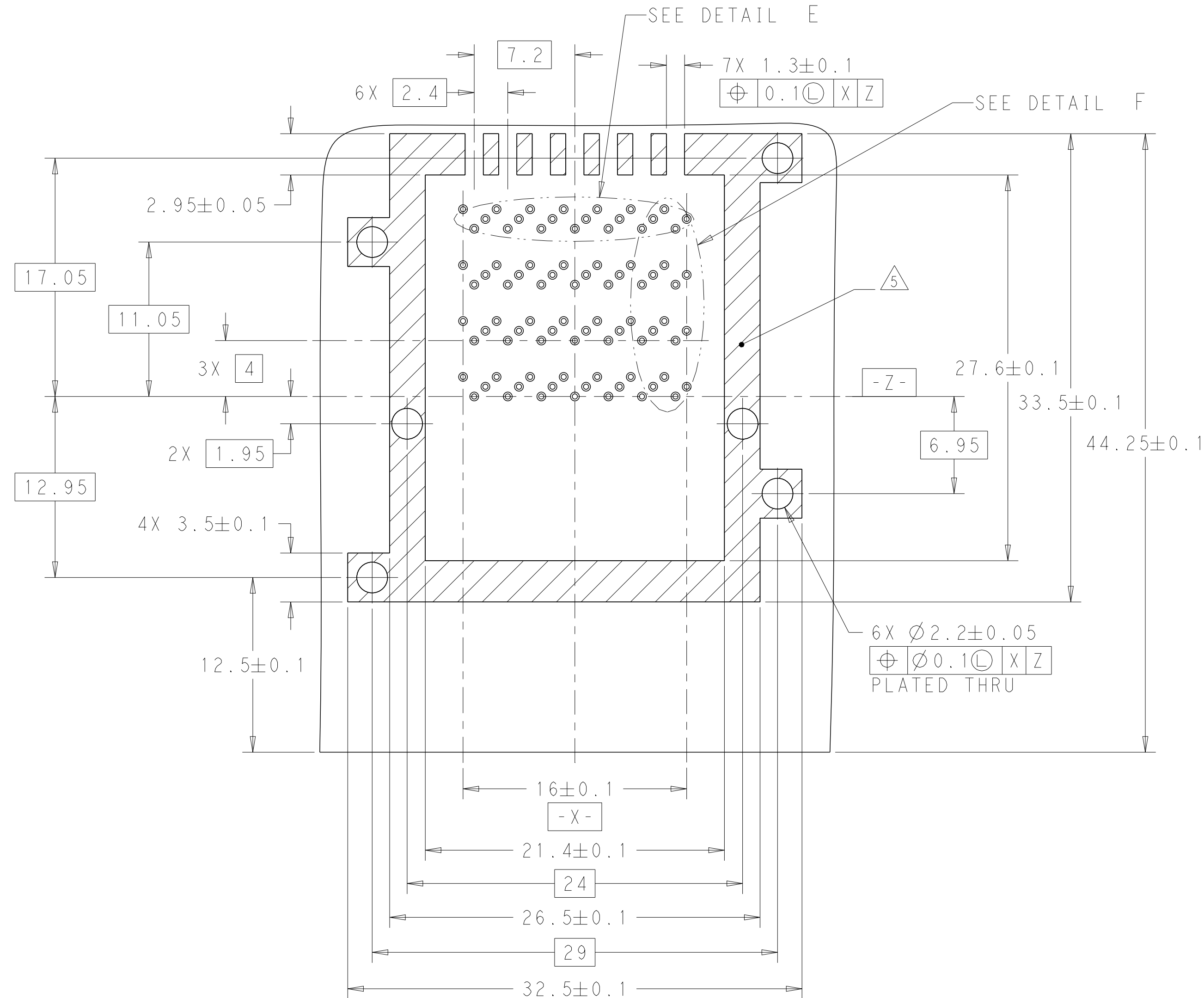

RECOMMENDED PCB LAYOUT  
 COMPONENT SIDE SHOWN  
 SCALE 4:1

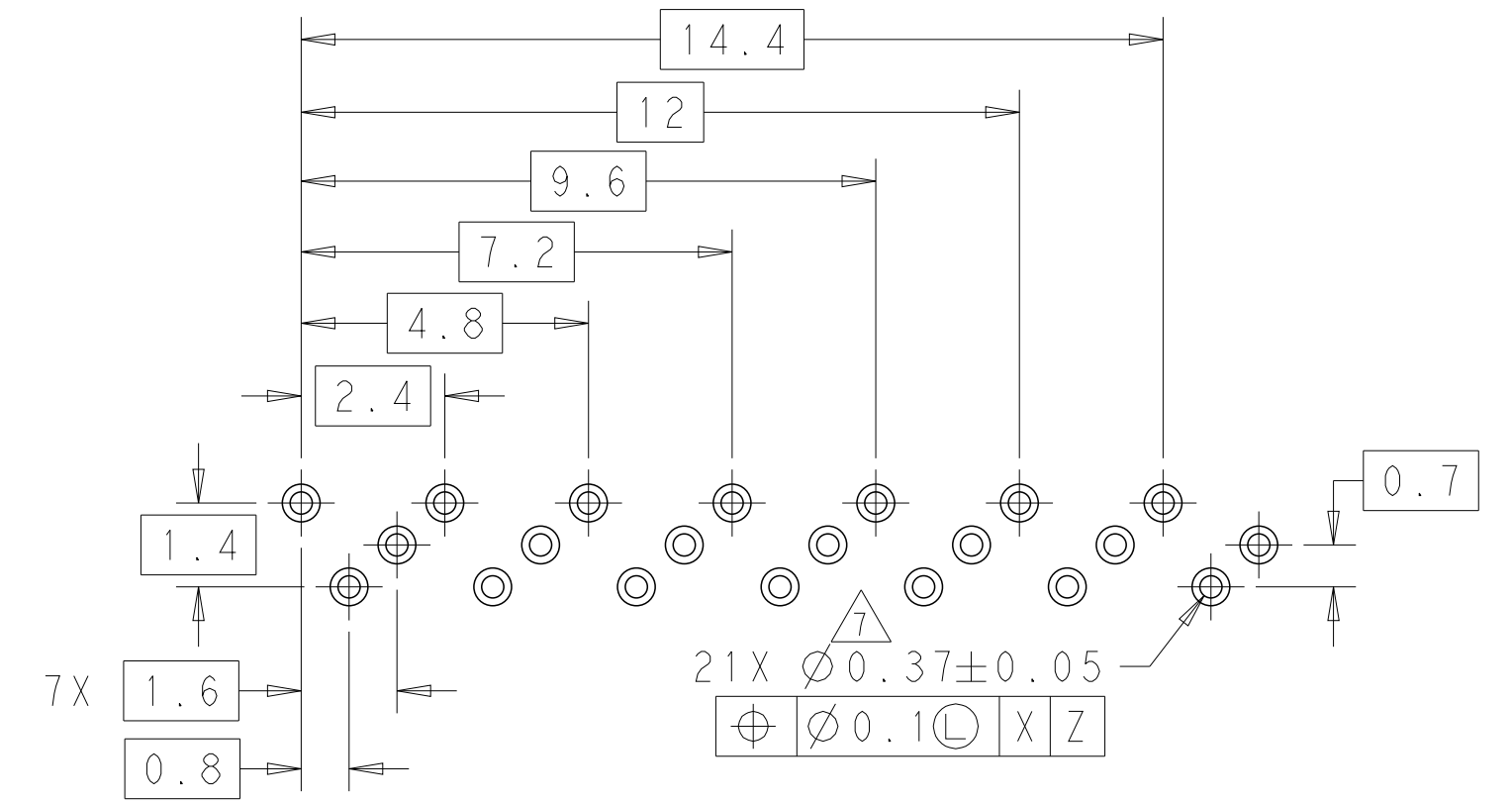

DETAIL E  
 4X INDIVIDUALLY  
 SCALE 8:1

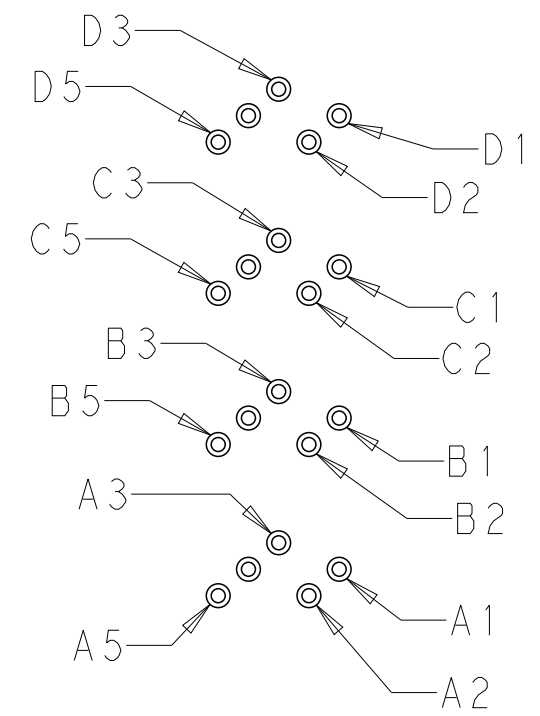

DETAIL F  
 PIN CALLOUT (TYPICAL)  
 SCALE 5:1

|   |  |                              |                     |   |                 |                       |
|---|--|------------------------------|---------------------|---|-----------------|-----------------------|
| THIS DRAWING IS A CONTROLLED DOCUMENT. DIMENSIONING AND TOLERANCING PER ASME Y14.5M-2009  |  | DWN M.E. COWHER 27SEP2010    | <br>TE Connectivity | NAME RECEPTACLE ASSEMBLY, BELLY-BELLY, STANDARD, 84 POSITION, CXP |                 |                       |
| DIMENSIONS: mm  |  | CHK M.D. MORRISON 28SEP2010  |                     | SIZE A2   | CAGE CODE 00779 | DRAWING NO. C-2149701 |
| TOLERANCES UNLESS OTHERWISE SPECIFIED:  |  | APVD M.D. MORRISON 28SEP2010 |                     | RESTRICTED TO   | -               |                       |
| 0 PLC ±0.15<br>1 PLC ±0.15<br>2 PLC ±0.15<br>3 PLC ±<br>4 PLC ±<br>ANGLES ±1°<br>FINISH - |  | PRODUCT SPEC 108-2426        |                     | SCALE 1:1   | SHEET 4 OF 4    | REV A                 |
| MATERIAL -  |  | APPLICATION SPEC 114-13283   | Customer Drawing    |   |                 |                       |