

# 90146-AS

## LONG TAIL SPRING LOADED CONTACT

Visit us at [WWW.PRECI-DIP.COM](http://WWW.PRECI-DIP.COM)



preci-dip

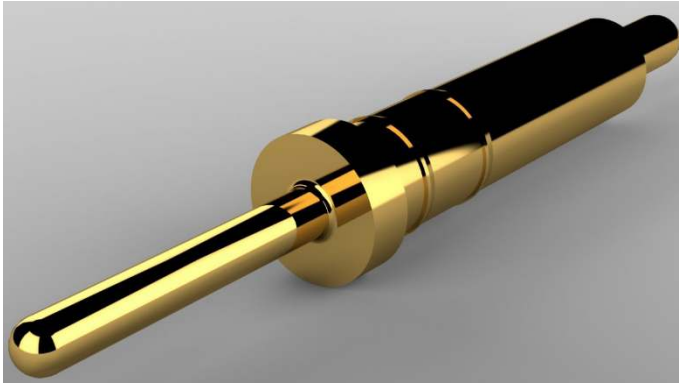

### *Engineered for Success*

Assembly: Long Tail  
Overall Length:  
21mm (.827")  
Above Board Height:  
14mm (.551")  
Stroke: 2.2mm (.087")

**ORDER AS:**

**90146-AS**

#### APPLICATION NOTES:

#### PRODUCT DESCRIPTION:

Preci-Dip Spring Loaded contact with long tail termination for pass-through extension between circuit boards and pluggable tail applications..  
Every Preci-Dip spring contact is Swiss precision machined and assembled for highest quality, performance and long product life.

#### PRODUCT PACKAGING:

This product is sold in bulk. It can also be provided assembled in an insulator. Let us help you with your custom packaging request.

#### HOW TO USE THIS PRODUCT:

This product is ideal for extended PCB connection applications. With solid one-piece body construction, These spring loaded contacts are typically used in docking stations, recharging stations, module stacking and pluggable SLC requirements.

#### CAN I CUSTOMIZE THIS PRODUCT?

Preci-Dip welcomes custom design requests. Please provide us your spring force and packaging requirements. Call today to discuss your application.

Temperature rise [°C]

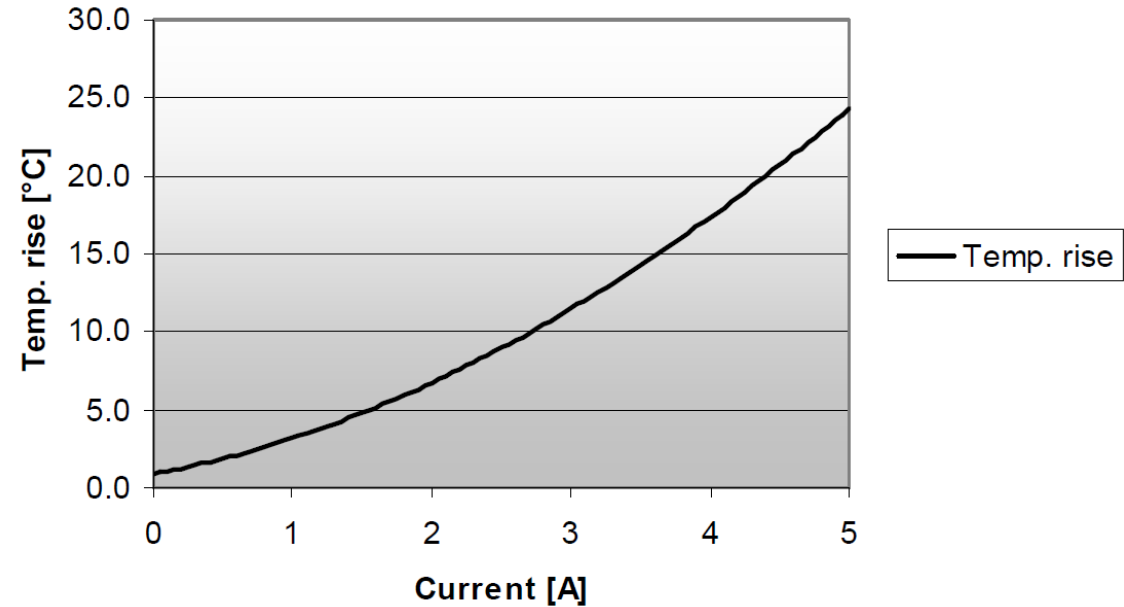

Current: 3A continuous @ 10 ° C rise

Long Tail

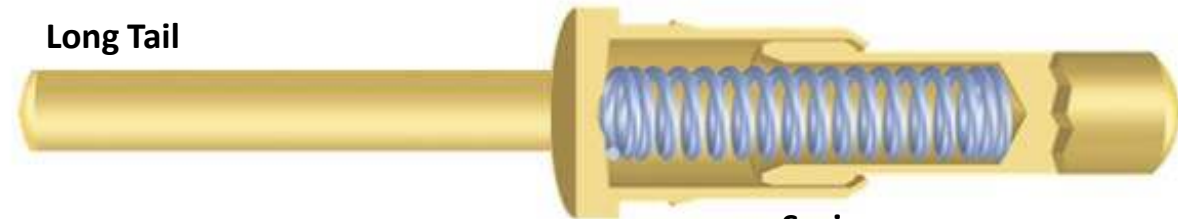

Piston

Spring

#### HOW IT WORKS:

Strong, secure and featuring one piece solid body construction, there are no capped components at the bottom of this spring contact. No seams for solder to wick inside the shell.



