

Tous droits strictement reserves. Reproduction ou communication a des tiers interdite sous quelque forme que ce soit sans autorisation écrite du propriétaire. Propriete de c FCI. Droits de reproduction FCI.

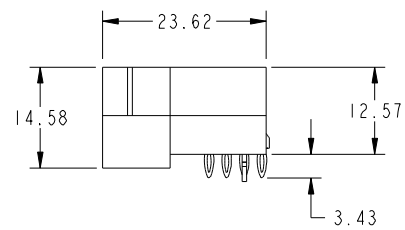

All rights strictly reserved. Reproduction or issue to third parties in any form whatever is not permitted without written authority from the proprietor. Property of FCI. Copyright FCI.

PRODUCT NO.	POWER			
	E1	P1	P2	E2
51939-475... NOTE 3		PX	PX	

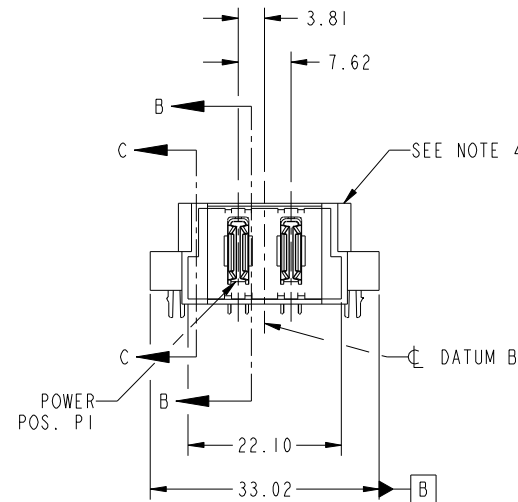
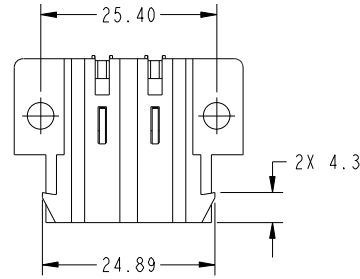

CODE	DIM "M" MATING LENGTH	CONTACT TYPE
PX	[N/A]	POWER
HA	[N/A]	HOLD-DOWN

mat'l code				SEE NOTE		tolerances unless otherwise specified		CUSTOMER		FCI	
ltr	ecn no.	dr	date	linear	0.X ± 0.5	projection		COPY		www.fciconnect.com	
A	DG09-0337	WL	10/29/09	angles	0.XX ± 0.25	MIM		title		2ACP RIGHT ANGLE PRESS FIT HEADER	
				dr	0.XXX ± 0.1	scale		product family		PwrBlade code	
				enr	0° ± 2°	1:1		size		213	
				chr	WL ZHANG 10/29/09			dwg no		51939-475 sheet	
				appd	JEROME CHEN 10/28/09			A		1 of 4	
					PM ZHENG 10/29/09						
					JOSEPH HSIA 10/29/09						
sheet index	revision sheet	A 1	A 2	A 3	A 4						

cage code 22526

Pro/E

Tous droits strictement reserves. Reproduction ou communication a des tiers interdite sous quelque forme que ce soit sans autorisation écrite du propriétaire. Propriete de c FCI. Droits de reproduction FCI.



All rights strictly reserved. Reproduction or issue to third parties in any form whatever is not permitted without written authority from the proprietor. Property of FCI. Copyright FCI.

PRODUCT NUMBER
51939-475--
NOTE: 3

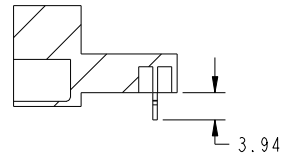

SECTION C-C

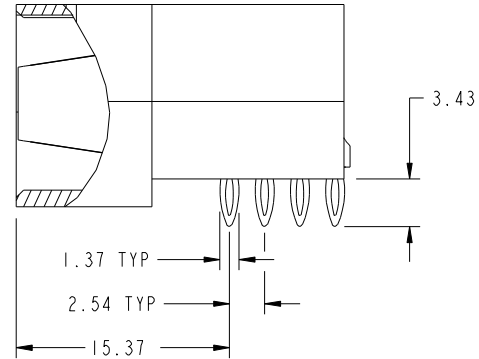

BROKEN-OUT SECTION B-B
SCALE 2:1

mat'l code				SEE NOTE	tolerances unless otherwise specified		CUSTOMER		FCI		www.fciconnect.com		
ltr	ecr no.	dr	date	linear	0.X ±0.5		COPY		projection	title			
A					0.XX ±0.25		MIM			2ACP			
					0.XXX ±0.1		←			RIGHT ANGLE PRESS FIT HEADER			
				angles	0° ±2°		scale		product family		code		
				dr	WL ZHANG	10/29/09	1:1		PwrBlade		213		
				enr	JEROME CHEN	10/28/09			size		sheet		
				chr	PM ZHENG	10/29/09			A		51939-475		
				appd	JOSEPH HSIA	10/29/09					2 of 4		
sheet index		revision sheet											

cage code 22526

Pro/E

Tous droits strictement reserves. Reproduction ou communication a des tiers interdite sous quelque forme que ce soit sans autorisation écrite du propriétaire. Propriete de c FCI. Droits de reproduction FCI.



All rights strictly reserved. Reproduction or issue to third parties in any form whatever is not permitted without written authority from the proprietor. Property of FCI. Copyright FCI.

PRODUCT NUMBER
51939-475--
NOTE: 3

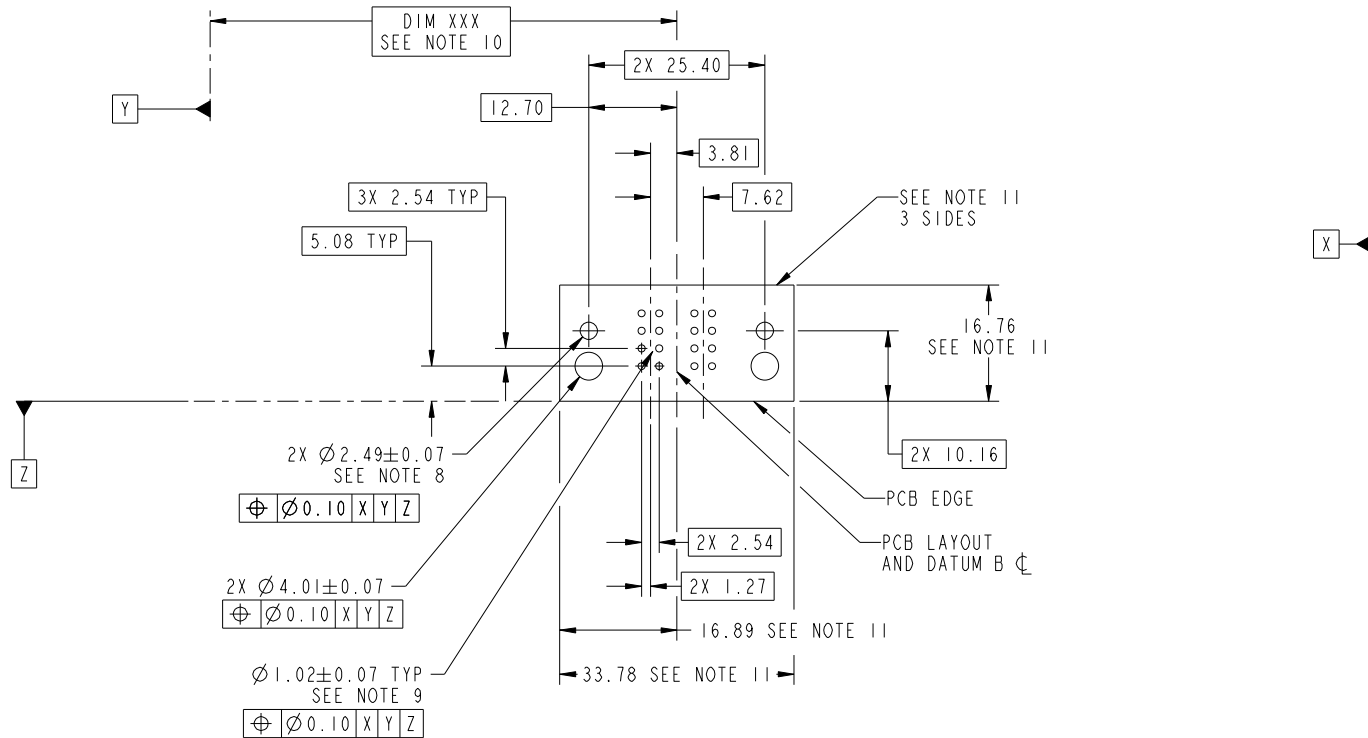

mat'l code		SEE NOTE		tolerances unless otherwise specified		CUSTOMER		FCI	
ltr	ecn no.	dr	date	linear	0.X ± 0.5	COPY		www.fciconnect.com	
A					0.XX ± 0.25	projection		title	
				angles	0.XXX ± 0.1			2ACP RIGHT ANGLE PRESS FIT HEADER	
				dr	0° ± 2°			product family	
				enr	WL ZHANG 10/29/09	scale		PwrBlade	
				chr	JEROME CHEN 10/28/09	1:1		code	
				appd	PM ZHENG 10/29/09	A		213	
					JOSEPH HSIA 10/29/09	size		3 of 4	
sheet index	revision sheet					dwg no		51939-475	
						3 of 4			

RECOMMENDED PCB LAYOUT

Pro/E

cage code 22526

Tous droits strictement reserves. Reproduction ou communication a des tiers interdite sous quelque forme que ce soit sans autorisation écrite du propriétaire. Propriete de c FCI. Droits de reproduction FCI.



All rights strictly reserved. Reproduction or issue to third parties in any form whatever is not permitted without written authority from the proprietor. Property of FCI. Copyright FCI.

PRODUCT NUMBER
51939-475--
NOTE: 3

NOTES:

1. DIMENSIONS AND TOLERANCES ARE IN ACCORDANCE WITH ASME Y14.5M, 1994 UNLESS OTHERWISE SPECIFIED.

CONNECTOR NOTES:

- 2. HOUSING MATERIAL: UL 94 V-0 GLASS FILLED
HIGH-TEMP THERMOPLASTIC
POWER CONTACT MATERIAL: COPPER ALLOY
SIGNAL PIN MATERIAL: COPPER ALLOY
- 3. PLATING SPEC.
SEE ITEM 3 & 4 IN PRINT 10064183 FOR PLATING SPEC OF 51939-475; 51939-475LF PRESPECTIVELY
- 4. MANUFACTURER'S NAME, DATE CODE AND OPTIONAL P/N TO APPEAR ON THIS SURFACE.
THE P/N CAN BE OMITTED IF THERE IS NOT ENOUGH SPACE ON THIS SURFACE.
- 5. PRODUCT SPECIFICATION GS-12-149.
APPLICATION SPECIFICATION BUS-20-067.
- 6. PACKAGED IN TRAYS.

PCB NOTES:

- 7. ALL HOLE DIAMETERS ARE FINISHED HOLE SIZE.
- 8. MOUNTING HOLES, WHERE APPLICABLE, ARE UNPLATED.
- 9. $\varnothing 1.151 \pm 0.025$ DRILLED HOLES PLATED WITH
0.008 MIN SnPb OR Sn OVER 0.03
TO 0.08 Cu PLATING TO ACHIEVE
 $\varnothing 1.02 \pm .07$ HOLE.
- 10. "DIM XXX" TO BE DETERMINED BY THE CUSTOMER.
- 11. CONNECTOR KEEP-OUT ZONE.

mat'l code		SEE NOTE		tolerances unless otherwise specified		CUSTOMER		FCI	
ltr	ecn no.	dr	date	linear	0.X ± 0.5	COPY		www.fciconnect.com	
A				linear	0.XX ± 0.25	projection		title	
				angles	0.XXX ± 0.1			2ACP RIGHT ANGLE PRESS FIT HEADER	
				dr	0° ± 2°	MIM		product family PwrBlade code	
				enr	WL ZHANG 10/29/09			size	
				chr	JEROME CHEN 10/28/09	scale		dwg no	
				appd	PM ZHENG 10/29/09	1:1		A 51939-475	
					JOSEPH HSIA 10/29/09			sheet	
sheet index	revision sheet							4 of 4	

cage code 22526

Pro/E