

ASSEMBLY P/N	HEIGHT	COATING	TOOLING
1802890000	40	BLACK ANODIZED	TOOLED
1802890001	40	NO FINISH	NOT TOOLED/ CONTACT FACTORY
1802890002	60	BLACK ANODIZED	NOT TOOLED/ CONTACT FACTORY
1802890003	60	NO FINISH	NOT TOOLED/ CONTACT FACTORY
1802890004	80	BLACK ANODIZED	NOT TOOLED/ CONTACT FACTORY
1802890005	80	NO FINISH	NOT TOOLED/ CONTACT FACTORY

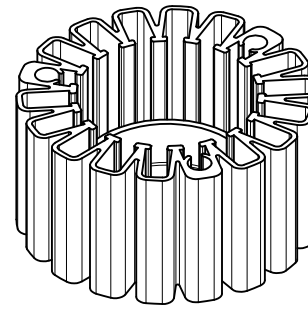

BOTTOM

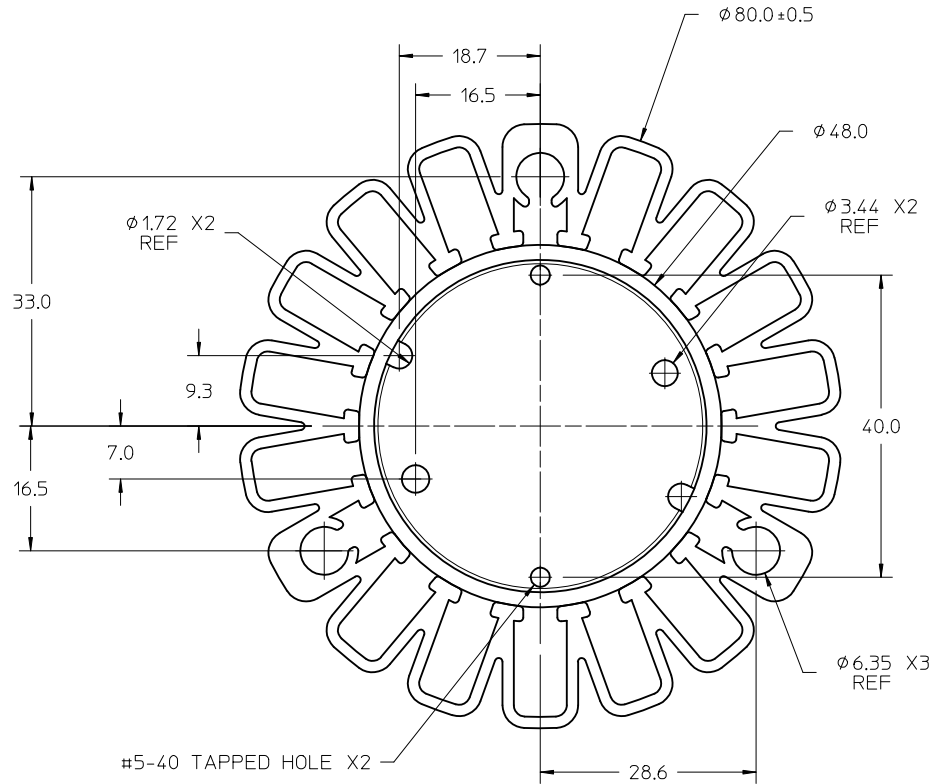
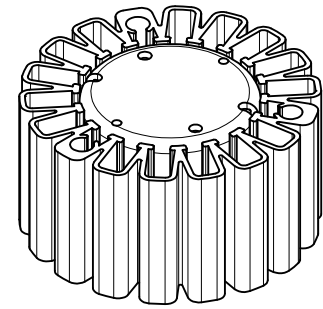

TOP

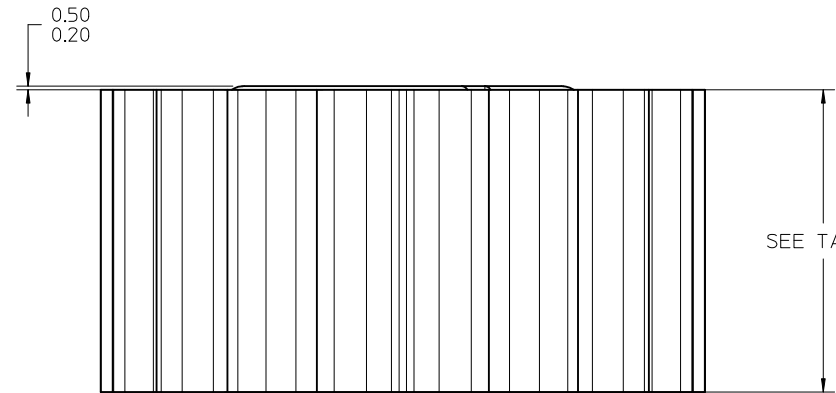

SEE TABLE

ACCOMMODATES MOLEX LED ARRAY HOLDERS FOR : BRIDGELUX ES  
CREE CXA 20  
CREE MPL  
CITIZEN C340

NOTES:

- 1) MATERIAL: ALUMINUM
- 2) HEIGHT CAN BE CHANGED BASED ON THERMAL REQUIREMENTS
- 3) USE OF STANDOFFS SUGGESTED FOR BETTER AIRFLOW

EC NO: SSL2011-0093 DRW:MSRWACKI 2011/03/11 CHKD: APPR:DMCGOWAN 2011/07/19 REV: A	QUALITY SYMBOLS ∇=0 ∇=0 ∇=0	GENERAL TOLERANCES (UNLESS SPECIFIED)		DIMENSION STYLE <b>MM ONLY</b>		SCALE <b>1:1</b>	DESIGN UNITS <b>METRIC</b>	THIRD ANGLE PROJECTION		
		4 PLACES ± ---	± ---	mm	INCH	DRAWN BY MSRWACKI	DATE 2011/03/11	TITLE <b>80 MM HEATSINK ASSEMBLY</b>		
		3 PLACES ± ---	± ---			CHECKED BY	DATE			
		2 PLACES ± 0.13	± ---			APPROVED BY DMCGOWAN	DATE 2011/07/12			
		1 PLACE ± 0.25	± ---	ANGULAR ± 1/2°		MATERIAL NO. <b>EM-180289-0000</b>		DOCUMENT NO. <b>SD-180289-000</b>		
DRAFT WHERE APPLICABLE MUST REMAIN WITHIN DIMENSIONS				SIZE C		THIS DRAWING CONTAINS INFORMATION THAT IS PROPRIETARY TO MOLEX INCORPORATED AND SHOULD NOT BE USED WITHOUT WRITTEN PERMISSION				
						MOLEX MOLEX INCORPORATED		SHEET NO. 1 OF 1		