

PC board drilling dimensions(after plating)

(thickness ≤ 3.20±0.30mm)

Pitch 2.76(shell 25-37)

pitch 2.74(shell 09-15)

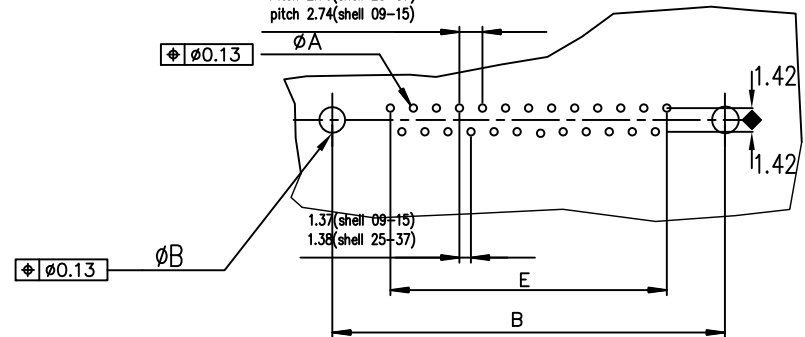

ROHS PART NUMBER

| SHELL | A±0.38 | B±0.12 | C±0.10 | D±0.25 | E±0.07 | PART NUMBER |
|-------|--------|--------|--------|--------|--------|----------------|
| 09 | 30.81 | 24.99 | 16.96 | 16.79 | 10.96 | D09P91C*GL00LF |
| 15 | 39.14 | 33.32 | 25.18 | 25.12 | 19.18 | D15P91C*GL00LF |
| 25 | 53.03 | 47.04 | 39.12 | 38.84 | 33.12 | D25P91C*GL00LF |
| 37 | 69.32 | 63.50 | 55.68 | 55.30 | 49.68 | D37P91C*GL00LF |

Plating: 4 --> 200 Mating
 Plating: 6 --> 500 Mating
 Plating: 8 --> 1.25µ Equivalent PdNi/Au

GENERAL CHARACTERISTICS AND ROHS INFORMATIONS:
 SEE DRAWING C01-8646-0001

| | | | | | | | | | |
|-------------|-------------|---------------------|-------------|---------------------------------------|--------|----------------------------|--|------------------------------------|--|
| mat'l. code | | surface ISO 1302 | | tolerance ISO 406 ISO 1101 | | projection | | product family D-SUB | |
| ltr | ecn no | dr | date | tolerances unless otherwise specified | | mm | | title | |
| L | ELX-I-21654 | AB | 2015-10-26 | angles | linear | .0±0.1 .00±0.1 0'±2' | | MALE DELTA-D STRAIGHT PRESS-FIT | |
| M | ELX-I-24020 | AAB | 2016-06-06 | | | scale 2:1 | | dwg no sheet 1 of 1 size | |
| | | dr | JARRY | 1994-09-21 | | Amphenol FCI | | C01-8646-0311 A3 | |
| | | engr | MITHUN PAUL | 2016-06-06 | | | | type Product Customer Drawing | |
| | | chr | ATHUL A.B | 2016-06-06 | | | | | |
| | | appd | BIJU K PAUL | 2016-06-06 | | | | | |
| sheet index | revision | M | | | | | | | |
| | sheet | 1 | | | | | | | |