

THIS DRAWING IS UNPUBLISHED. RELEASED FOR PUBLICATION  
 BY AMP INCORPORATED. ALL RIGHTS RESERVED.

Loc		Dist		REVISIONS			
P	LTR	DESCRIPTION	DATE	DWN	APVD		
DF	AO						
0		RELEASED PER 0600-7709-98	8-98	CT	RG		

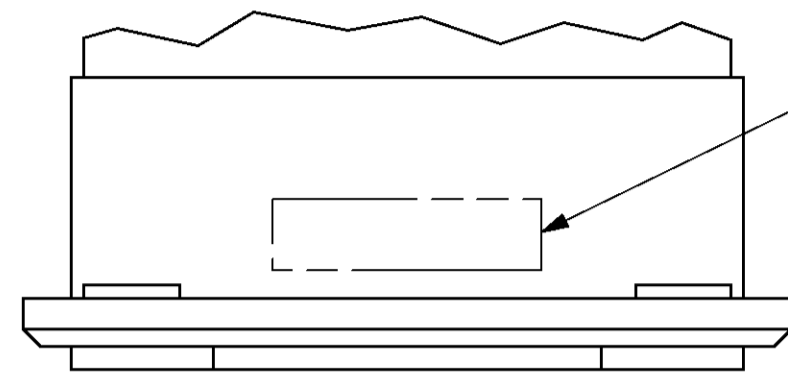

AMP PART NUMBER  
MARKED IN THIS AREA

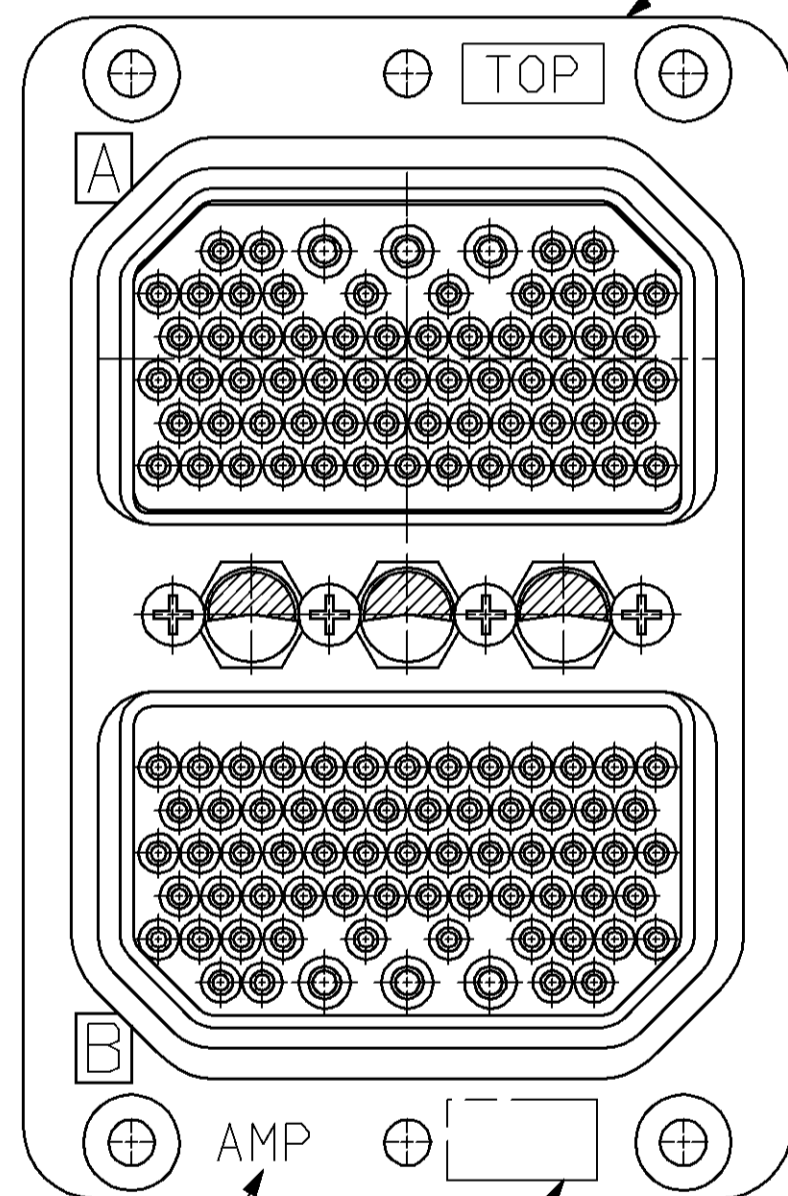

RECEPTACLE SHELL  
 MATERIAL: ALUMINUM PER QQ-A-591  
 FINISH: CADMIUM PLATED PER QQ-P-416  
 COLOR: YELLOW CHROMATE

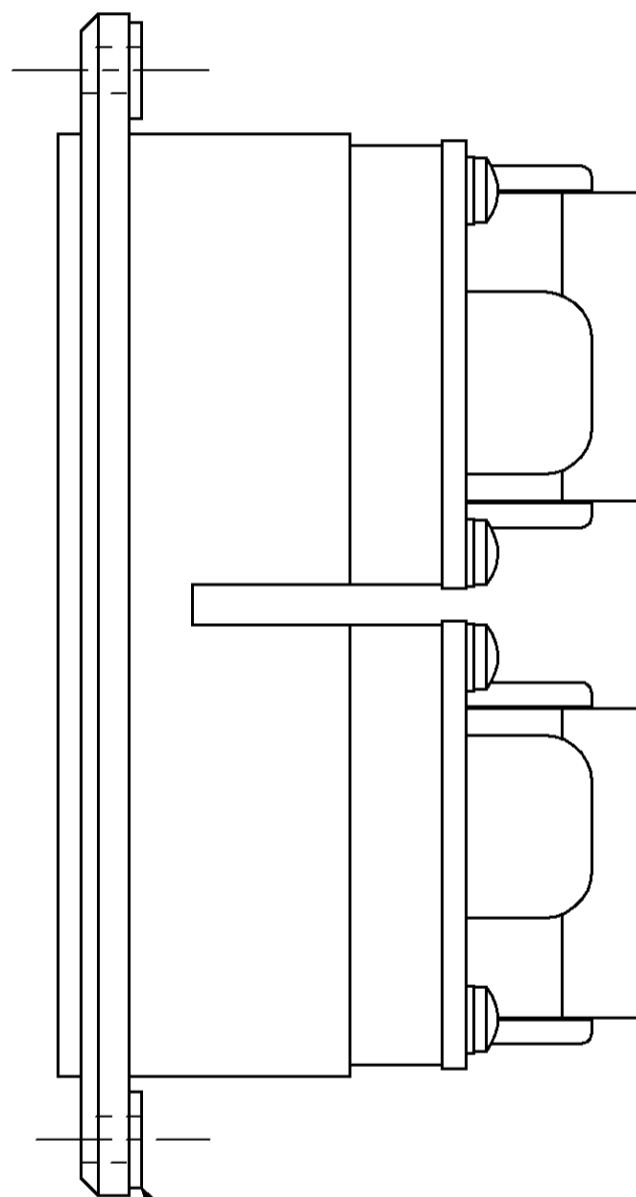

FLOAT BUSHINGS  
4 PLC

RETAINER PLATE (2 PLC)  
 MATERIAL: ALUMINUM  
 PER QQ-A-250/8  
 FINISH: BLUE ANODIZED  
 PER MIL-A-8625

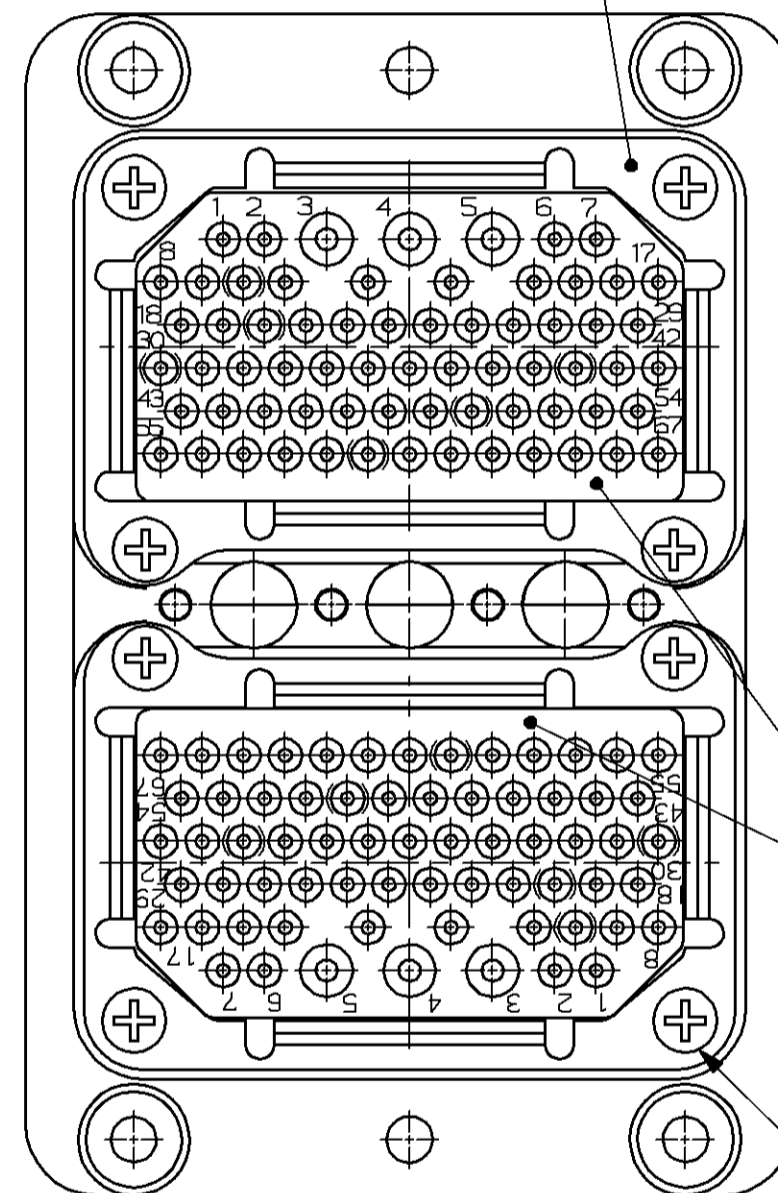

INSERT ASSY, 67P  
 MATERIAL: EPOXY  
 COLOR: BLACK

SCREW & LOCKWASHER (QTY=8)  
 MATERIAL: STAINLESS STEEL  
 PER QQ-S-766  
 FINISH: PASSIVATED  
 PER QQ-P-358

AMP MARKED  
IN THIS AREA

DATE CODE MARKED  
IN THIS AREA

- KEYING IS SET IN POSITION "01".
- CONNECTOR IS SUPPLIED WITHOUT CONTACTS.

1218343-1  
PART NO.

THIS DRAWING IS A CONTROLLED DOCUMENT.		DWN C.C.THOMAS 8-18-98	AMP Incorporated Harrisburg, PA 17105-3608															
DIMENSIONS: INCHES [mm]		CHK D.BELL 8-18-98	NAME ASSEMBLY, ARINC 404 RECEPTACLE RME2R67P67P-3301 (201)															
TOLERANCES UNLESS OTHERWISE SPECIFIED:		APVD D.BELL 8-18-98	PRODUCT SPEC -															
<table border="0"> <tr><td>0 PLC</td><td>±-</td></tr> <tr><td>1 PLC</td><td>±-</td></tr> <tr><td>2 PLC</td><td>±-</td></tr> <tr><td>3 PLC</td><td>±-</td></tr> <tr><td>4 PLC</td><td>±-</td></tr> <tr><td>ANGLES</td><td>±-</td></tr> <tr><td>FINISH</td><td>-</td></tr> </table>		0 PLC	±-	1 PLC	±-	2 PLC	±-	3 PLC	±-	4 PLC	±-	ANGLES	±-	FINISH	-	APPLICATION SPEC -	SIZE A2	CAGE CODE 00779
0 PLC	±-																	
1 PLC	±-																	
2 PLC	±-																	
3 PLC	±-																	
4 PLC	±-																	
ANGLES	±-																	
FINISH	-																	
MATERIAL -		WEIGHT -	DRAWING NO 1218343															
CUSTOMER DRAWING			RESTRICTED TO -	SCALE 2:1														
			SHEET 1 OF 1	REV 0														