

REV.	DATE	ECR NO.	DESCRIPTION
NC	08/17/02	-	INITIAL RELEASE
A	03/16/09	-	REVISE PART DESCRIPTION, ADD NOTE 1.

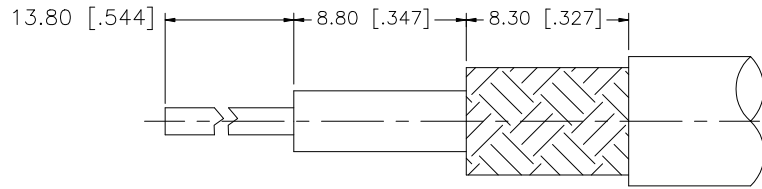

RECOMMENDED CABLE STRIPPING DIM'S

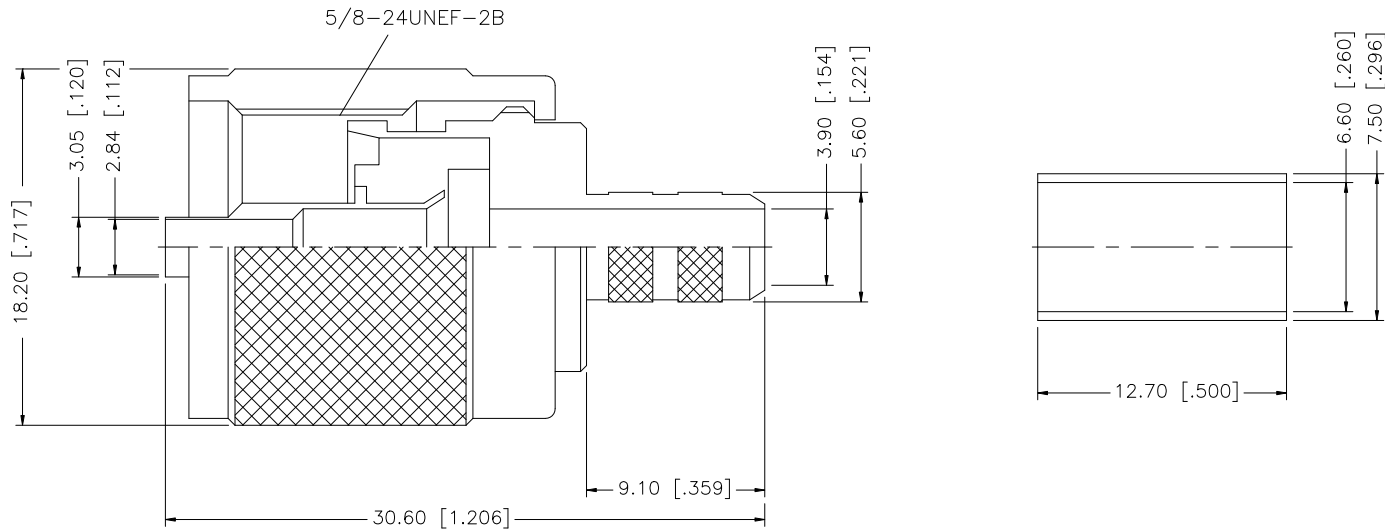

NOTES:

1. CRIMPED FERRULE HEX CRIMP SIZE .255" [6.48]

				UNLESS OTHERWISE SPECIFIED DIMENSIONS ARE IN MILLIMETERS. DIMENSIONS IN [ ] ARE IN INCHES AND FOR CUSTOMER REFERENCE ONLY.	APPROVALS	DATE	<h1 style="text-align: center;">Amphenol Connex</h1>				
8					DRAWN	GRS					03/16/09
7					CHECKED			<p style="text-align: center;">PART NO.</p> <p style="text-align: center;">182101</p>			
6					ISSUED						
5					SHEET	1 OF 1		<p style="text-align: center;">REV. A</p> <p style="text-align: center;">SIZE A</p> <p style="text-align: center;">SCALE NA</p>			
4	FERRULE	COPPER	NICKEL	1	CAD FILE		C:/182/182101.DWG				
3	CONTACT PIN	BER. COPPER	GOLD	1	DO NOT SCALE DRAWING						
2	INSULATOR	PHENOLIC	YELLOW	1							
1	BODY/SHELL	BRASS	NICKEL	1							
				UNLESS OTHERWISE SPECIFIED TOLERANCES FOR MILLIMETERS ARE: 0.5 - 8mm ± 0.20mm 8 - 30mm ± 0.40mm 30 - 120mm ± 0.50mm UNLESS OTHERWISE SPECIFIED TOLERANCES FOR INCHES ARE: .020 - .315 ± 0.007" .315 - 1.180 ± 0.015" 1.180 - 4.724 ± 0.020"							