

- 1 HOUSING: LIQUID CRYSTAL POLYMER, COLOR BLACK. CONTACTS: HIGH RELIABILITY COPPER ALLOY. GROUND BUSES: BRASS, UNS C26000
- 2 CONTACTS & GROUND BUSES: NICKEL UNDERPLATE ALL OVER, MATING SURFACE PLATED TO MEET LEVEL 1 PERFORMANCE REQUIREMENTS OF TE CONNECTIVITY PRODUCT SPECIFICATION 108-1422, SOLDER TAILS PLATED MATTE TIN.
- 3 DATE CODE MARKED IN AREA INDICATED ON OPPOSITE SIDE OF POSITION #1.
- 4 ONE GROUND BUS WITH 5 TAILS PER EACH MODULE.
- 5 TOLERANCE NON-ACCUMULATIVE.
- 6 FOR STANDARD APPLICATIONS, ORIENTATION HOLE TO BE $\phi.094\pm.002[2.39\pm0.05]$. FOR SLIP-FIT APPLICATIONS, ORIENTATION HOLE TO BE $\phi.079\pm.001[2.00\pm0.03]$.

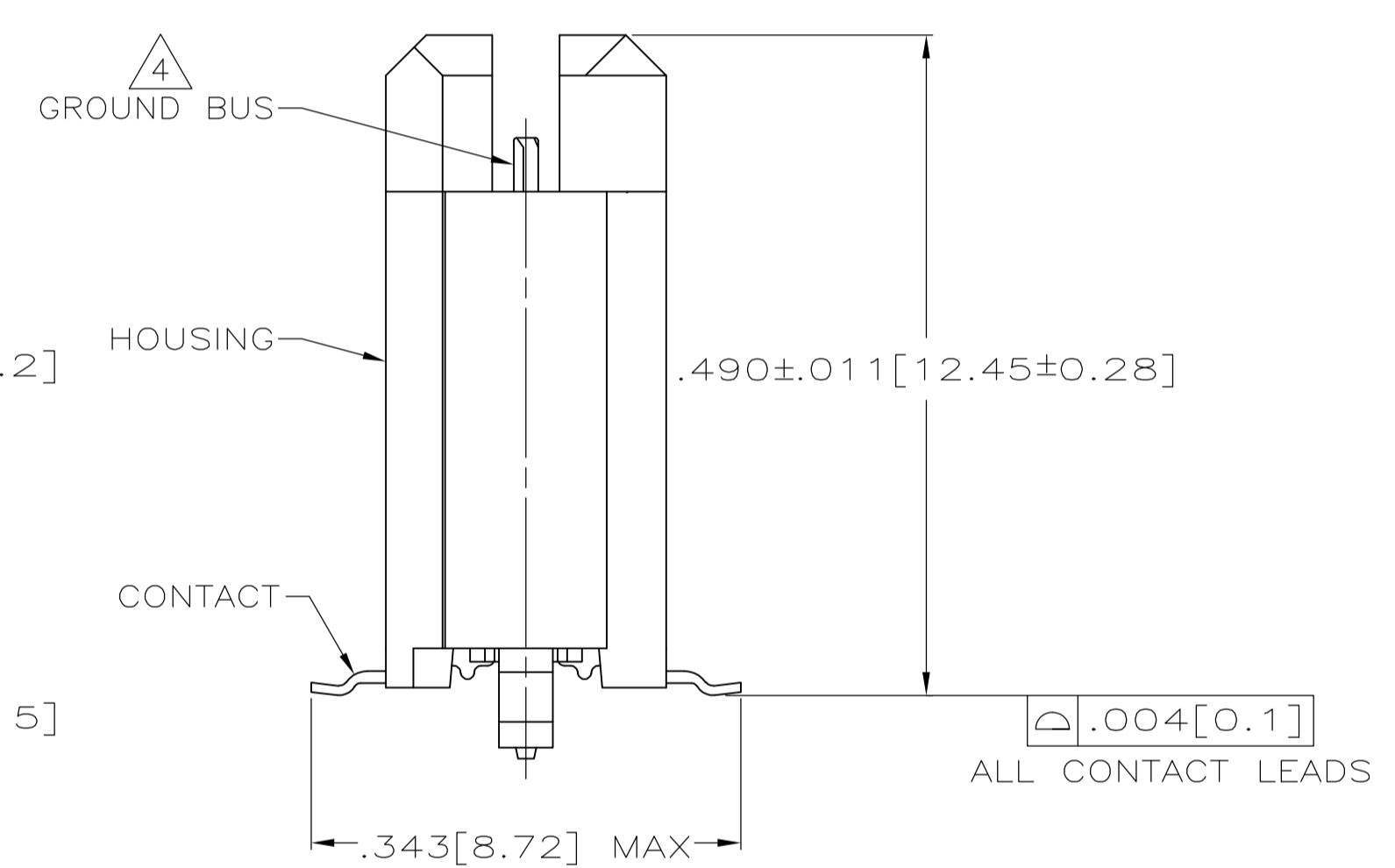

ALL GROUND BUS LEADS EXTENDED FOR 5767005-1 THRU 5767005-7
 ALL GROUND BUS LEADS STANDARD FOR 5767005-8 THRU 1-5767005-4

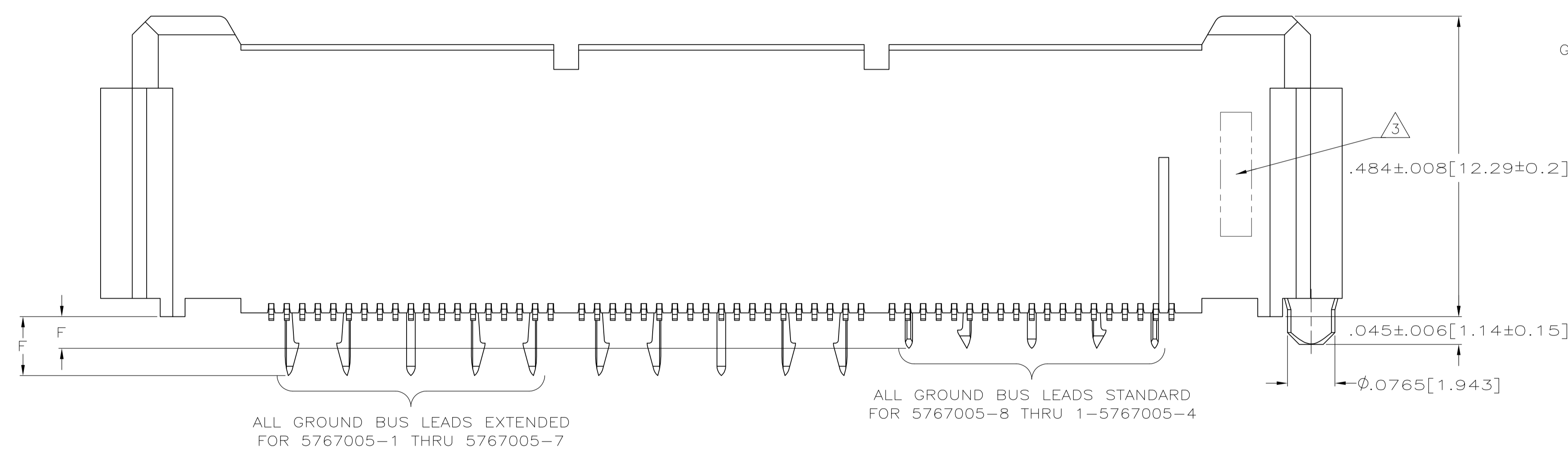
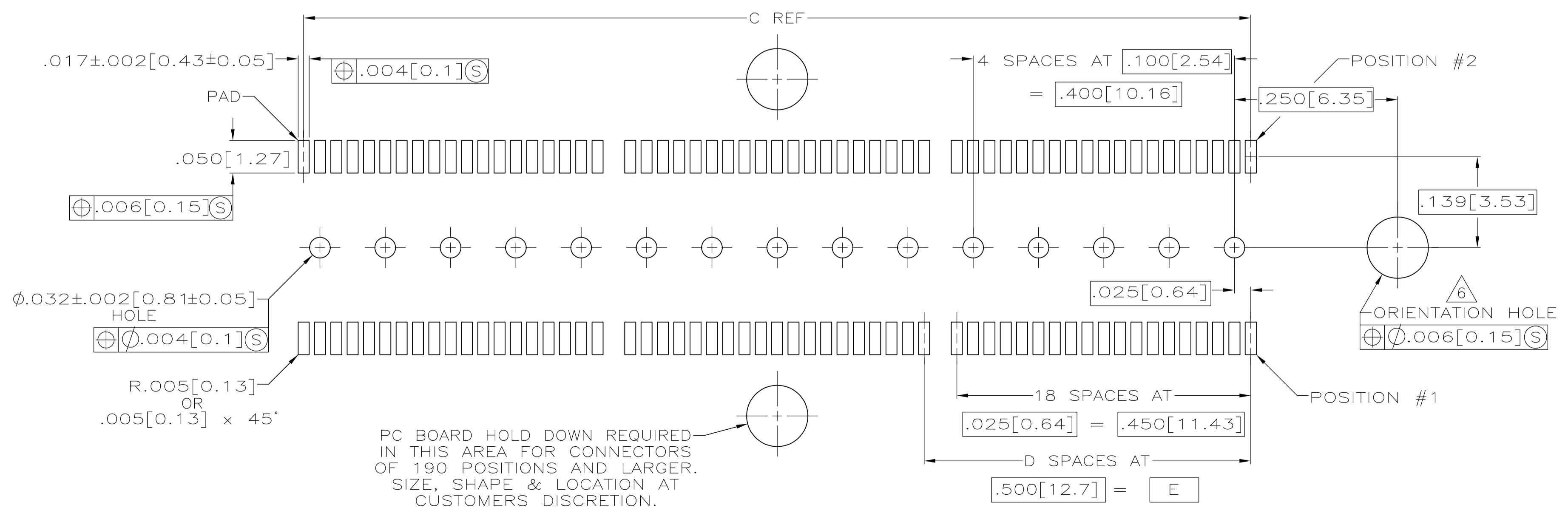

PC BOARD HOLD DOWN REQUIRED IN THIS AREA FOR CONNECTORS OF 190 POSITIONS AND LARGER. SIZE, SHAPE & LOCATION AT CUSTOMERS DISCRETION.

RECOMMENDED PC BOARD LAYOUT (VIEWED FROM CONNECTOR SIDE)

BUS LEADS TYPE	F	E	D	C	B	A	NO OF POS	PART NUMBER
STANDARD	.060[1.52]	3.000[76.2]	6	3.450[87.63]	3.898[99]	4.000[101.6]	266	1-5767005-4
STANDARD	.060[1.52]	2.500[63.5]	5	2.950[74.93]	3.398[86.31]	3.500[88.9]	228	1-5767005-3
STANDARD	.060[1.52]	2.000[50.8]	4	2.450[62.23]	2.898[73.61]	3.000[76.2]	190	1-5767005-2
STANDARD	.060[1.52]	1.500[38.1]	3	1.950[49.53]	2.398[60.91]	2.500[63.5]	152	1-5767005-1
STANDARD	.060[1.52]	1.000[25.4]	2	1.450[36.83]	1.898[48.21]	2.000[50.8]	114	1-5767005-0
STANDARD	.060[1.52]	.500[12.7]	1	.950[24.13]	1.398[35.51]	1.500[38.1]	76	5767005-9
STANDARD	.060[1.52]	.000[0]	0	.450[11.43]	.898[22.81]	1.000[25.4]	38	5767005-8
OBsolete EXTENDED	.104[2.64]	3.000[76.2]	6	3.450[87.63]	3.898[99]	4.000[101.6]	266	5767005-7
OBsolete EXTENDED	.104[2.64]	2.500[63.5]	5	2.950[74.93]	3.398[86.31]	3.500[88.9]	228	5767005-6
OBsolete EXTENDED	.104[2.64]	2.000[50.8]	4	2.450[62.23]	2.898[73.61]	3.000[76.2]	190	5767005-5
OBsolete EXTENDED	.104[2.64]	1.500[38.1]	3	1.950[49.53]	2.398[60.91]	2.500[63.5]	152	5767005-4
OBsolete EXTENDED	.104[2.64]	1.000[25.4]	2	1.450[36.83]	1.898[48.21]	2.000[50.8]	114	5767005-3
OBsolete EXTENDED	.104[2.64]	.500[12.7]	1	.950[24.13]	1.398[35.51]	1.500[38.1]	76	5767005-2
OBsolete EXTENDED	.104[2.64]	.000[0]	0	.450[11.43]	.898[22.81]	1.000[25.4]	38	5767005-1

THIS DRAWING IS A CONTROLLED DOCUMENT. DIN S. ATTADIA 25 OCT 04. CHK D. DIXON 25 OCT 04. APVD D. DIXON 25 OCT 04.

STE TE Connectivity

PLUG ASSEMBLY, .495[12.57] VERTICAL, .025[0.64]CL, GULL WING LEADS, MICTOR 108-1422

114-11004

A1 00779 C=5767005

CUSTOMER DRAWING SCALE 8:1 SHEET 1 OF 1 REV A2