

16A, 200V - 600V Ultra Fast Rectifier

FEATURES

- AEC-Q101 qualified available
- Ultra fast recovery times
- 175°C operating junction temperature
- Popular TO-220AB Package
- High temperature glass passivated junction
- High voltage capability to 600 volts
- RoHS Compliant
- Halogen-free according to IEC 61249-2-21

APPLICATIONS

- DC to DC converters
- Switching mode converters and inverters
- Freewheeling application

MECHANICAL DATA

- Case: TO-220AB
- Molding compound meets UL 94V-0 flammability rating
- Terminal: Matte tin plated leads, solderable per J-STD-002
- Mounting torque: 0.56 N·m maximum
- Meet JESD 201 class 2 whisker test
- Polarity: As marked
- Weight: 1.82g (approximately)

KEY PARAMETERS		
PARAMETER	VALUE	UNIT
I_F	16	A
V_{RRM}	200 - 600	V
I_{FSM}	100	A
$T_{J\ MAX}$	175	°C
Package	TO-220AB	
Configuration	Dual dies	

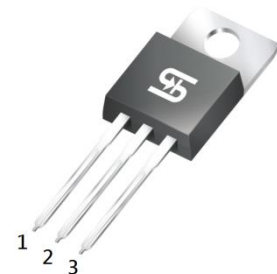
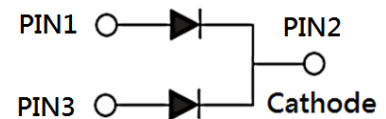
TO-220AB

ABSOLUTE MAXIMUM RATINGS ($T_A = 25^\circ\text{C}$ unless otherwise noted)					
PARAMETER	SYMBOL	MUR1620CT	MUR1640CT	MUR1660CT	UNIT
Marking code on the device		MUR1620CT	MUR1640CT	MUR1660CT	
Repetitive peak reverse voltage	V_{RRM}	200	400	600	V
Reverse voltage, total rms value	$V_{R(RMS)}$	140	280	420	V
Forward current	I_F	16			A
Surge peak forward current, 8.3ms single half sine wave superimposed on rated load	I_{FSM}	100			A
Junction temperature	T_J	-55 to +175			°C
Storage temperature	T_{STG}	-55 to +175			°C

THERMAL PERFORMANCE

PARAMETER		SYMBOL	TYP	UNIT
Junction-to-case thermal resistance	MUR1620CT	$R_{\theta JC}$	3	°C/W
Junction-to-case thermal resistance	MUR1640CT MUR1660CT	$R_{\theta JC}$	2	°C/W

ELECTRICAL SPECIFICATIONS ($T_A = 25^\circ\text{C}$ unless otherwise noted)

PARAMETER		CONDITIONS	SYMBOL	TYP	MAX	UNIT
Forward voltage per diode ⁽¹⁾	MUR1620CT	$I_F = 8\text{A}, T_J = 25^\circ\text{C}$	V_F	-	0.975	V
	MUR1640CT			-	1.300	V
	MUR1660CT			-	1.500	V
	MUR1620CT	$I_F = 8\text{A}, T_J = 150^\circ\text{C}$		-	0.895	V
	MUR1640CT			-	1.100	V
	MUR1660CT			-	1.200	V
Reverse current @ rated V_R per diode ⁽²⁾	MUR1620CT	$T_J = 25^\circ\text{C}$	I_R	-	5	μA
	MUR1640CT MUR1660CT			-	10	μA
	MUR1620CT	$T_J = 125^\circ\text{C}$		-	250	μA
	MUR1640CT MUR1660CT			-	500	μA
Reverse recovery time	MUR1620CT	$I_F = 0.5\text{A}, I_R = 1.0\text{A}, I_{rr} = 0.25\text{A}$	t_{rr}	-	25	ns
	MUR1640CT MUR1660CT			-	50	ns

Notes:

1. Pulse test with PW = 0.3ms
2. Pulse test with PW = 30ms

ORDERING INFORMATION

ORDERING CODE ⁽¹⁾⁽²⁾	PACKAGE	PACKING
MUR16xCT	TO-220AB	50 / Tube
MUR16xCTH	TO-220AB	50 / Tube

Notes:

1. "x" defines voltage from 200V(MUR1620CT) to 600V(MUR1660CT)
2. "H" means AEC-Q101 qualified

CHARACTERISTICS CURVES

($T_A = 25^\circ\text{C}$ unless otherwise noted)

Fig.1 Forward Current Derating Curve

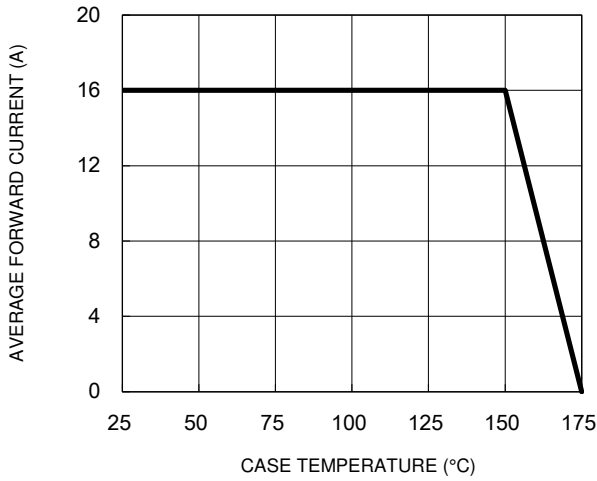

Fig.2 Typical Junction Capacitance

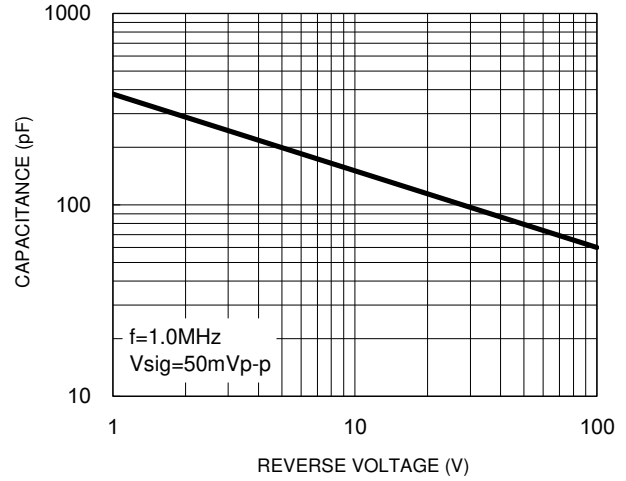

Fig.3 Typical Reverse Characteristics

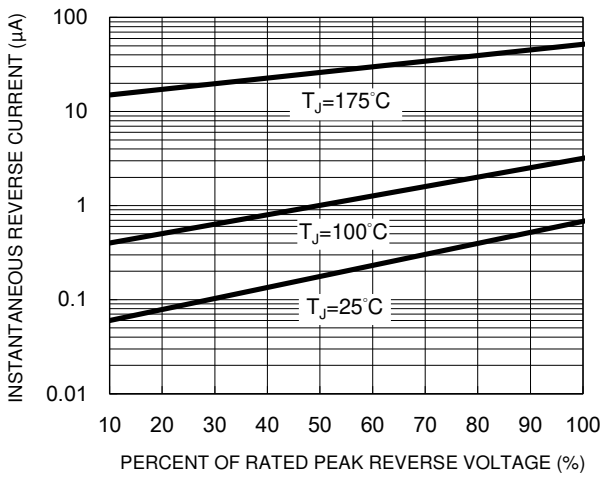

Fig.4 Typical Forward Characteristics

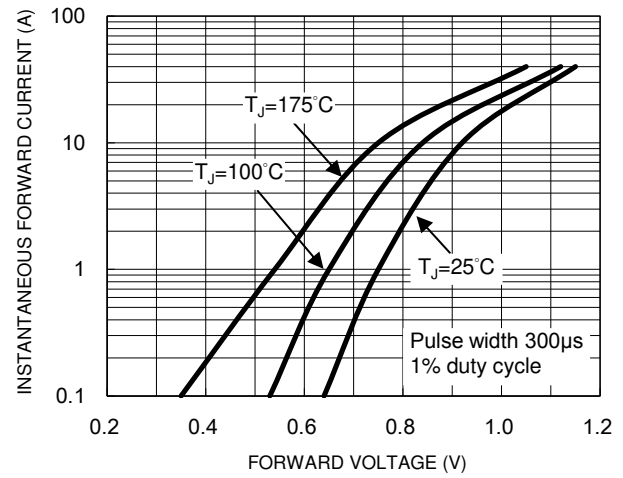
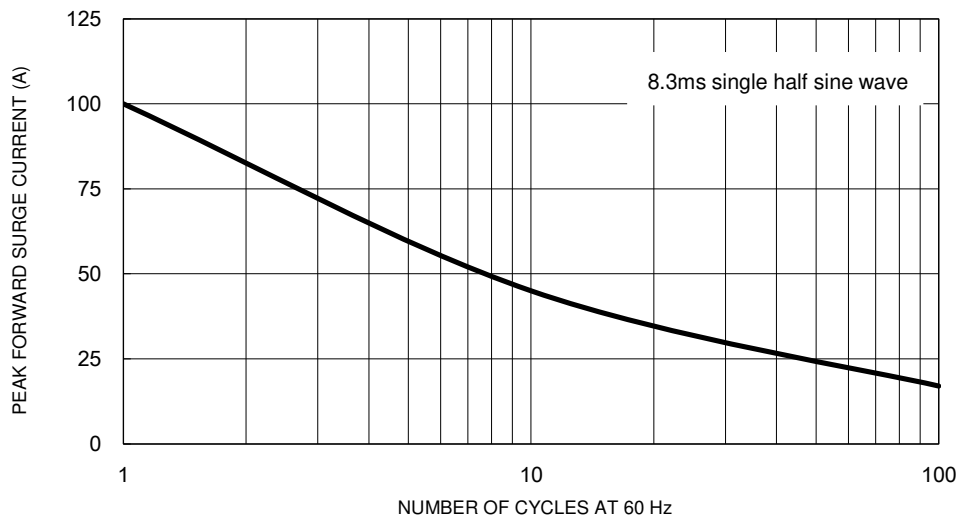

Fig.5 Maximum Non-Repetitive Forward Surge Current



CHARACTERISTICS CURVES

($T_A = 25^\circ\text{C}$ unless otherwise noted)

Fig.6 Reverse Recovery Time Characteristic and Test Circuit Diagram



PACKAGE OUTLINE DIMENSIONS

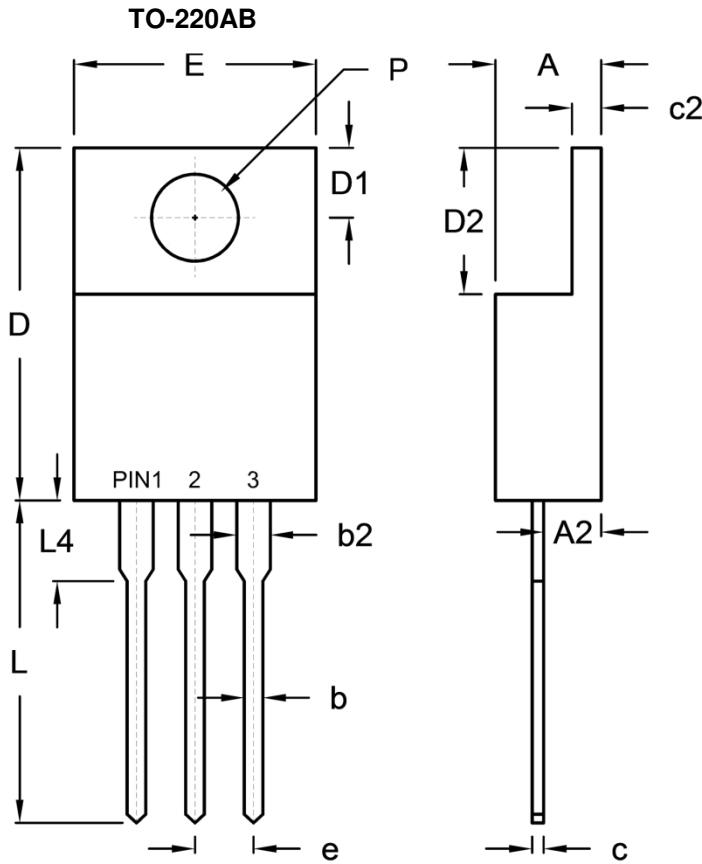

DIM.	Unit (mm)		Unit (inch)	
	Min.	Max.	Min.	Max.
A	4.42	4.76	0.174	0.187
A2	2.20	2.80	0.087	0.110
b	0.68	0.94	0.027	0.037
b2	1.14	1.77	0.045	0.070
c	0.35	0.64	0.014	0.025
c2	1.14	1.40	0.045	0.055
D	14.60	16.00	0.575	0.630
D1	2.62	3.44	0.103	0.135
D2	5.84	6.86	0.230	0.270
E	-	10.50	-	0.413
e	2.41	2.67	0.095	0.105
L	13.19	14.79	0.519	0.582
L4	2.80	4.20	0.110	0.165
P	3.54	4.00	0.139	0.157

MARKING DIAGRAM



- P/N = Marking Code
- G = Green Compound
- YWW = Date Code
- F = Factory Code

Notice

Specifications of the products displayed herein are subject to change without notice. TSC or anyone on its behalf assumes no responsibility or liability for any errors or inaccuracies.

Purchasers are solely responsible for the choice, selection, and use of TSC products and TSC assumes no liability for application assistance or the design of Purchasers' products.

Information contained herein is intended to provide a product description only. No license, express or implied, to any intellectual property rights is granted by this document. Except as provided in TSC's terms and conditions of sale for such products, TSC assumes no liability whatsoever, and disclaims any express or implied warranty, relating to sale and/or use of TSC products including liability or warranties relating to fitness for a particular purpose, merchantability, or infringement of any patent, copyright, or other intellectual property right.

The products shown herein are not designed for use in medical, life-saving, or life-sustaining applications. Customers using or selling these products for use in such applications do so at their own risk and agree to fully indemnify TSC for any damages resulting from such improper use or sale.