

HEADER WITHOUT PEGS & CAP VERSION

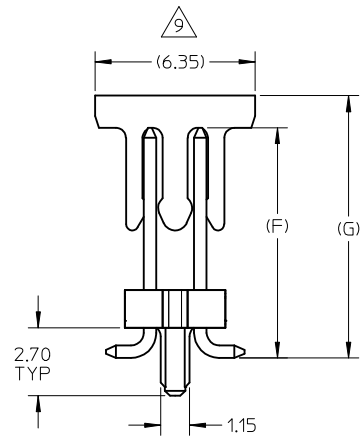

HEADER WITH CRASH PEGS & CAP VERSION

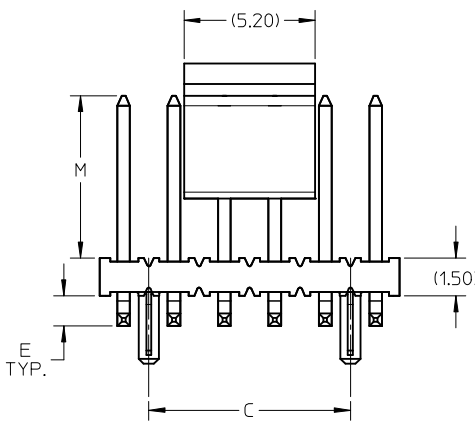
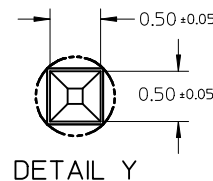
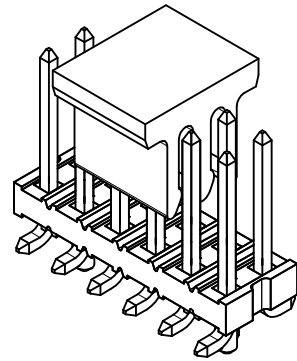

- NOTES
- MATERIAL:
 - HSG: NYLON, GLASS-FILLED, UL94V-0 COLOR: BLACK
 - CAP: NYLON, GLASS-FILLED, UL94V-0, COLOR: BLACK
 - PIN: 0.50MM SQ, COPPER ALLOY
 - PLATING TYPE:
 - GOLD FLASH OVER
1.25µm MIN. NICKEL OVERALL.
 - GOLD FLASH ON CONTACT AND
2.50µm MIN. TIN ON SOLDER TAIL OVER
1.25µm MIN. NICKEL OVERALL.
 - 0.38µm MIN. GOLD PLATE ON CONTACT AND
2.00µm MIN. TIN ON SOLDER TAIL OVER
1.25µm MIN. NICKEL OVERALL.
 - 0.75µm MIN. GOLD PLATE ON CONTACT AND
2.00µm MIN. TIN ON SOLDER TAIL OVER
1.25µm MIN. NICKEL OVERALL.
 - 2.50µm MIN. TIN OVERALL
1.25µm MIN. NICKEL OVERALL
 - 5.00µm MIN. TIN OVERALL
1.25µm MIN. NICKEL OVERALL
 - PRODUCT SPECIFICATION: PS-87761-100
 - PACKAGING TYPE: SEE TABLE
 - PACKAGING SPEC: PLS REFER TO SHEET 2 AND SEE TABLE
 - WAFER TO BE FLAT WITHIN 0.003 mm/mm
 - BEND DEPRESSION IS ACCEPTED SO LONG AS IT DOES NOT AFFECT THE OVERALL COPLANARITY OF TAIL
 - COPLANARITY IS TO BE MEASURED BY RESTING THE SOLDER TAIL ON A GAUGE SURFACE
 - CAP TO BE LOCATED AS CENTRAL OF PARTS AS POSSIBLE. TOP SURFACE OF CAP TO BE FLAT FOR THE PURPOSE OF PICK & PLACE BY VACUUM SUCTION NOZZLE
 - IRREGULAR CIRCUIT CUTOFF WITHIN BREAKAWAY SECTION IS PERMISSIBLE. CUTTING OR CHIPPING OF THE MAIN BODY IS NOT ACCEPTABLE
 - RECOMMENDED PCB THICKNESS IS 1.60mm±0.10
 - THE ABOVE CKT 12 IS FOR ILLUSTRATION PURPOSE ONLY
 - TUBE LENGTH AS PER STANDARD 560mm

ADD 20CKT 87759-2116 EC NO: S2013-0145 DRWN:SKANG 2012/09/13 CHKD:ATSEE 2012/10/19 APPR:MLONG 2012/10/19	QUALITY SYMBOLS ▽=0 ◻=0	GENERAL TOLERANCES (UNLESS SPECIFIED)		DIMENSION STYLE MM ONLY	SCALE NTS	DESIGN UNITS METRIC	THIRD ANGLE PROJECTION	
		mm	INCH	DRAWN BY	DATE	TITLE		
		4 PLACES ± ---	± ---	SKLIM01	2006/08/14	CUSTOM HEADER		
		3 PLACES ± ---	± ---	CHECKED BY	DATE	MGRID, DUAL ROW SMT HDR.		
2 PLACES ± 0.2	± ---	CWLAM	2006/08/16	WITH OR W/O LOC. PEGS, LF				
1 PLACE ± ---	± ---	APPROVED BY	DATE	MOLEX INCORPORATED				
ANGULAR ± 3 °		PATEY	2006/08/18	MATERIAL NO.	DOCUMENT NO.	SHEET NO.		
DRAFT WHERE APPLICABLE MUST REMAIN WITHIN DIMENSIONS		SEE TABLE		SD-87759-297		1 OF 3		
		SIZE	THIS DRAWING CONTAINS INFORMATION THAT IS PROPRIETARY TO MOLEX INCORPORATED AND SHOULD NOT BE USED WITHOUT WRITTEN PERMISSION					

PACKAGING SPECIFICATION OVERVIEW

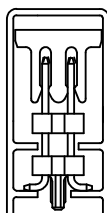
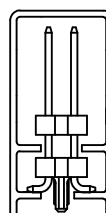
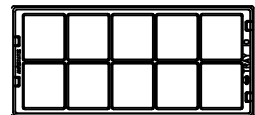
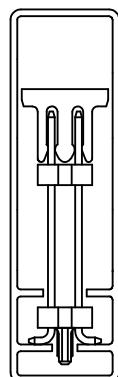
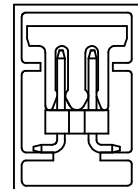
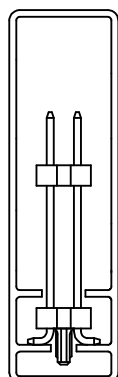
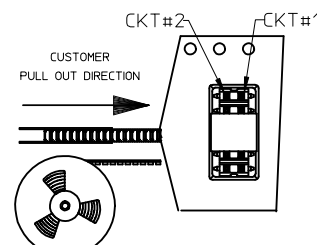
ITEM	PACKAGING TYPE	PACKAGING SPECIFICATION	PART OVERALL HEIGHT	PART PACKED IN PACKAGING ORIENTATION (FOR REF. USE ONLY)	ITEM	PACKAGING TYPE	PACKAGING SPECIFICATION	PART OVERALL HEIGHT	PART PACKED IN PACKAGING ORIENTATION (FOR REF. USE ONLY)	
01	BULK	PK-89990-490	-		04	TUBE	PK-89990-475	DIMENSION F/G= <13.3MM (WITH CAP & W/O CAP VERSION)		
02	TRAY	PK-89990-487	DIMENSION F/G= MAX. 40.0MM						HEADER WITH CAP IN TUBE	HEADER WITHOUT CAP IN TUBE
03	TUBE	PK-89990-474	DIMENSION F/G= 13.4MM ~ 23.4MM (WITH & W/O CAP VERSION)		05	TUBE	PK-89990-476	DIMENSION F/G = 8.05MM (WITH CAP VERSION ONLY)		
									HEADER WITH CAP IN TUBE	HEADER WITHOUT CAP IN TUBE
06	TAPE & REEL	PK-89990-484 (REEL Ø: 330.0 MAX.)	DIMENSION F/G= MAX. 15.0MM							

ADD 20CKT 87759-2116 EC NO: S2013-0145 DRWN:SKANG 2012/09/13 CHKD:ATSEE 2012/10/19 APPR:MLONG 2012/10/19	REV DESCRIPTION A7	QUALITY SYMBOLS ▽=0 ◻=0	GENERAL TOLERANCES (UNLESS SPECIFIED)		DIMENSION STYLE MM ONLY		SCALE NTS	DESIGN UNITS METRIC	THIRD ANGLE PROJECTION			
					mm	INCH	DRAWN BY SKLIM01	DATE 2006/08/14	CUSTOM HEADER MGRID, DUAL ROW SMT HDR. WITH OR W/O LOC. PEGS,LF MOLEX INCORPORATED SD-87759-297			
			4 PLACES	± ---	± ---	3 PLACES	± ---	± ---				
			2 PLACES	± 0.2	± ---	1 PLACE	± ---	± ---	APPROVED BY PATEY	DATE 2006/08/18	SHEET NO. 2 OF 3	
			ANGULAR ± 3 °		DRAFT WHERE APPLICABLE MUST REMAIN WITHIN DIMENSIONS		SEE TABLE		THIS DRAWING CONTAINS INFORMATION THAT IS PROPRIETARY TO MOLEX INCORPORATED AND SHOULD NOT BE USED WITHOUT WRITTEN PERMISSION			

CKT SIZE	DIMENSION		
	A	B	C
04	4.00	2.00	-
06	6.00	4.00	2.00
08	8.00	6.00	4.00
10	10.00	8.00	6.00
12	12.00	10.00	8.00
14	14.00	12.00	10.00
16	16.00	14.00	12.00
18	18.00	16.00	14.00
20	20.00	18.00	16.00
22	22.00	20.00	18.00
24	24.00	22.00	20.00
26	26.00	24.00	22.00
28	28.00	26.00	24.00
30	30.00	28.00	26.00
32	32.00	30.00	28.00
34	34.00	32.00	30.00
36	36.00	34.00	32.00
38	38.00	36.00	34.00
40	40.00	38.00	36.00
42	42.00	40.00	38.00
44	44.00	42.00	40.00
46	46.00	44.00	42.00
48	48.00	46.00	44.00
50	50.00	48.00	46.00

PART NO. W/O CAP IN BULK PACK	PART NO. WITH CAP IN TAPE & REEL	PART NO. WITH CAP IN TUBE	PART NO. W/O CAP IN TUBE	PART NO. W/O CAP IN TRAY	CKT SIZE	PEG	PLATE OPT.	PK SPEC.	VOID PIN#	DIMENSION			
										G	F	M	E
-	87759-0601	-	-	-	6	N	6	6	-	9.77	8.50	5.80	1.20
-	87759-0801	87759-0802	-	-	8	Y	3	6	-	16.97	15.70	13.00	1.20
-	87759-1001	-	-	-	10	N	4	6	9	7.17	5.90	3.20	1.20
-	87759-1011	-	-	-	10	N	4	6	10	7.17	5.90	3.20	1.20
-	87759-1601	-	-	-	16	N	3	6	-	13.47	12.20	9.50	1.20
-	87759-2115	-	87759-2114	-	20	N	3	4, 6	-	9.27	8.00	5.30	1.20
-	-	87759-2116	-	-	20	N	5	3	-	13.97	12.70	10.00	1.20
87759-5000	-	-	-	-	50	N	4	1	9,19,29,39,49	-	5.90	3.20	1.20

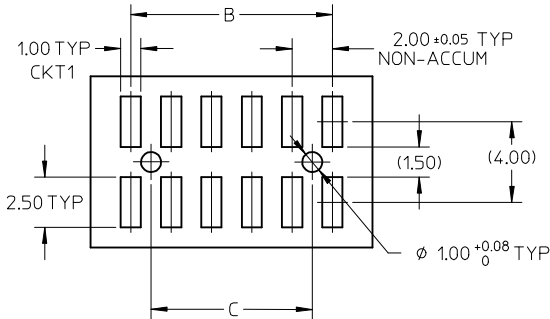

RECOMMENDED PCB LAYOUT: SOLDER SIDE

ADD 20CKT 87759-2116 EC NO: S2013-0145 DRWN:SKANG 2012/09/13 CHKD:ATSEE 2012/10/19 APPR:MLONG 2012/10/19	QUALITY SYMBOLS	GENERAL TOLERANCES (UNLESS SPECIFIED)	DIMENSION STYLE	SCALE	DESIGN UNITS	THIRD ANGLE PROJECTION																		
	$\nabla = 0$ $\square = 0$	<table border="1"> <tr><th></th><th>mm</th><th>INCH</th></tr> <tr><td>4 PLACES</td><td>± ---</td><td>± ---</td></tr> <tr><td>3 PLACES</td><td>± ---</td><td>± ---</td></tr> <tr><td>2 PLACES</td><td>± 0.2</td><td>± ---</td></tr> <tr><td>1 PLACE</td><td>± ---</td><td>± ---</td></tr> </table>		mm	INCH	4 PLACES	± ---	± ---	3 PLACES	± ---	± ---	2 PLACES	± 0.2	± ---	1 PLACE	± ---	± ---	MM ONLY	NTS	METRIC				
		mm	INCH																					
	4 PLACES	± ---	± ---																					
3 PLACES	± ---	± ---																						
2 PLACES	± 0.2	± ---																						
1 PLACE	± ---	± ---																						
DESCRIPTION	<table border="1"> <tr><th>mm</th><th>INCH</th></tr> <tr><td>ANGULAR</td><td>± 3 °</td></tr> </table>	mm	INCH	ANGULAR	± 3 °	<table border="1"> <tr><th>DRAWN BY</th><th>DATE</th><th>TITLE</th></tr> <tr><td>SKLIM01</td><td>2006/08/14</td><td rowspan="4">CUSTOM HEADER MGRID, DUAL ROW SMT HDR. WITH OR W/O LOC. PEGS,LF</td></tr> <tr><th>CHECKED BY</th><th>DATE</th></tr> <tr><td>CWLAM</td><td>2006/08/16</td></tr> <tr><th>APPROVED BY</th><th>DATE</th></tr> <tr><td>PATEY</td><td>2006/08/18</td></tr> </table>	DRAWN BY	DATE	TITLE	SKLIM01	2006/08/14	CUSTOM HEADER MGRID, DUAL ROW SMT HDR. WITH OR W/O LOC. PEGS,LF	CHECKED BY	DATE	CWLAM	2006/08/16	APPROVED BY	DATE	PATEY	2006/08/18	MOLEX INCORPORATED			
mm	INCH																							
ANGULAR	± 3 °																							
DRAWN BY	DATE	TITLE																						
SKLIM01	2006/08/14	CUSTOM HEADER MGRID, DUAL ROW SMT HDR. WITH OR W/O LOC. PEGS,LF																						
CHECKED BY	DATE																							
CWLAM	2006/08/16																							
APPROVED BY	DATE																							
PATEY	2006/08/18																							
REV	DRAFT WHERE APPLICABLE MUST REMAIN WITHIN DIMENSIONS	SEE TABLE	MATERIAL NO.	DOCUMENT NO.	SHEET NO.																			
A7			SD-87759-297		3 OF 3																			
			THIS DRAWING CONTAINS INFORMATION THAT IS PROPRIETARY TO MOLEX INCORPORATED AND SHOULD NOT BE USED WITHOUT WRITTEN PERMISSION																					