

MAT'L NO.	INTERNAL THREAD	DIM. "A"	MATERIAL / PLATING
74962-1000	4-40 UNC-2B	.338 / 8.60	STAINLESS STEEL 303
74962-2000	M3x0.5 CLASS 6H	.338 / 8.60	
74962-3000	4-40 UNC-2B	.378 / 9.60	STAINLESS STEEL 303
74962-4000	M3x0.5 CLASS 6H	.378 / 9.60	
74962-0005	4-40 UNC-2B	.421 / 10.69	STAINLESS STEEL 303
74962-0006	M3x0.5 CLASS 6H	.421 / 10.69	

NOTES:  
 1. PARTS ARE PACKAGED IN POLY BAGS CONSISTING OF 40 PIECES.  
 2. INTERNAL AND EXTERNAL THREADS TO WITHSTAND A MINIMUM APPLIED TORQUE OF 5 lbf in/5.76 kgf cm.

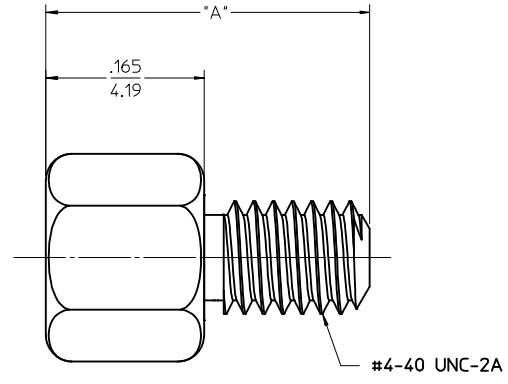
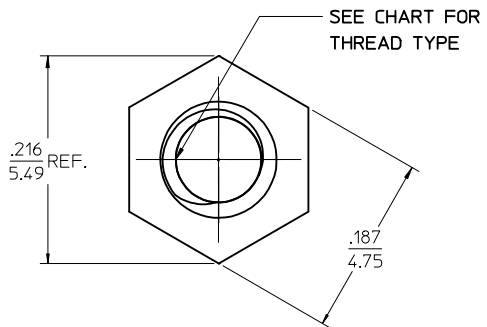
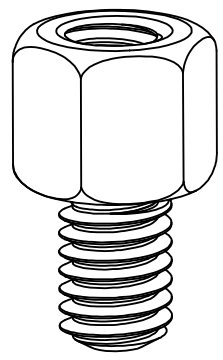

INITIAL RELEASE EC NO: UCP2015-0921 DRWN:TIBARRA 2014/08/01 CHKD:MPOFF 2014/08/29 APPR:SMILLER 2014/09/04	QUALITY SYMBOLS	GENERAL TOLERANCES (UNLESS SPECIFIED)	DIMENSION STYLE	SCALE	DESIGN UNITS	THIRD ANGLE PROJECTION
	▽=0	mm INCH	IN/MM	10:1	INCH	
	▽=0	4 PLACES ± --- ± ---	DRAWN BY DATE	TITLE		
	▽=0	3 PLACES ± --- ± .010	TIBARRA 2014/08/01	TDP 3/16" HEX JACKPOST		
	2 PLACES ± 0.25 ± ---	CHECKED BY DATE	<b>molex</b>			
	1 PLACE ± --- ± ---	MPOFF 2014/08/29				
	0 PLACE ± ±	APPROVED BY DATE	DOCUMENT NO.		SHEET NO.	
	ANGULAR ±1/2°	SMILLER 2014/09/04	SD-74962-1000		1 OF 1	
	DRAFT WHERE APPLICABLE MUST REMAIN WITHIN DIMENSIONS	MATERIAL NO.	THIS DRAWING CONTAINS INFORMATION THAT IS PROPRIETARY TO MOLEX INCORPORATED AND SHOULD NOT BE USED WITHOUT WRITTEN PERMISSION			
A	REV	SIZE				

13	12	11	10	9	8	7	6	5	4	3	2	1
MAT'L NO.	INTERNAL THREAD	EXTERNAL THREAD	DIM. "A"	MATERIAL / PLATING								
74962-1110	4-40 UNC-2B	4-40 UNC-2A	.338 / 8.60	STAINLESS STEEL 303 / NYLON TORQUE PATCH								

- NOTES:
- PARTS ARE PACKAGED IN POLY BAGS CONSISTING OF 40 PIECES.
  - INTERNAL AND EXTERNAL THREADS TO WITHSTAND A MINIMUM APPLIED TORQUE OF 5 lbf in/5.76 kgf cm.
  - NYLOK® TORQUE PATCH LOCATED TO THE LEFT OF THE FIRST OR SECOND FULL THREADS AND COVERS 3 THREADS MINIMUM.

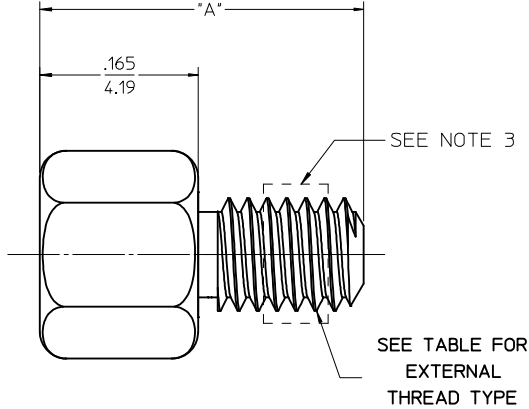
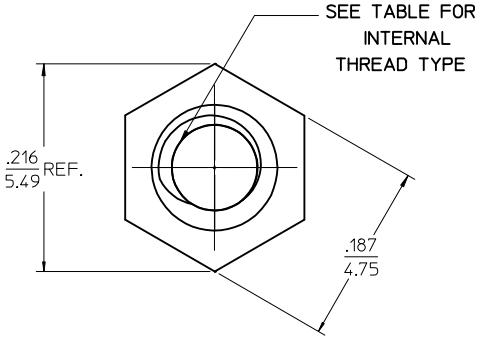
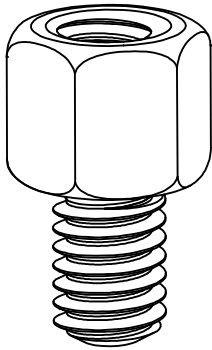

<b>MOD NOTE 3</b> EC NO: UCP2016-1139 DRWN: TIBARRA 2015/09/14 CHKD: MCAN 2015/09/14 APPR: MILLER 2015/09/17	QUALITY SYMBOLS ▽=0 ▽=0 ▽=0	GENERAL TOLERANCES (UNLESS SPECIFIED)		DIMENSION STYLE IN/MM		SCALE 10:1	DESIGN UNITS INCH	THIRD ANGLE PROJECTION		
		4 PLACES ± --- ± ---	3 PLACES ± --- ± .010	2 PLACES ± 0.25 ± ---	1 PLACE ± --- ± ---	0 PLACE ± ±	DRAWN BY TIBARRA DATE 2015/07/09		TITLE TDP 3/16" HEX JACKPOST WITH TORQUE PATCH	
		CHECKED BY DMORGAN DATE 2017/07/09		APPROVED BY SMILLER DATE 2015/08/14		MATERIAL NO.		DOCUMENT NO.		
		ANGULAR ±1/2°		DRAFT WHERE APPLICABLE MUST REMAIN WITHIN DIMENSIONS		SIZE C		SEE TABLE		SD-74962-1110