

部番 No.	部品名 PARTS NAME	材質 MATERIAL	記事 ARTICLE
①	ハウジング HOUSING	ガラス入り耐熱樹脂 G.F. HEAT RESISTANT PLASTIC	UL94V-0, 色: 黒 UL94V-0, COLOR: BLACK
②	ピン PIN	黄銅 t0.25 BRASS t0.25	接点部 : 金メッキ0.76μmMIN. CONTACT AREA : GOLD 0.76μmMIN. 半田付け部 : 錫メッキ1μmMIN. SOLDER TAIL AREA : TIN 1μmMIN. 下地メッキ : ニッケルメッキ2μmMIN. UNDER-PLATING : NICKEL 2 μmMIN.
③	シエル SHELL	りん青銅 t0.4 PHOSPHOR BRONZE t0.4	錫メッキ : 1.0μmMIN.* TIN : 1.0 μmMIN. 下地メッキ : ニッケルメッキ1.27μmMIN.* UNDER-PLATING : NICKEL 1.27 μmMIN.

※半田付け部のみ。
ONLY SOLDERING PART.

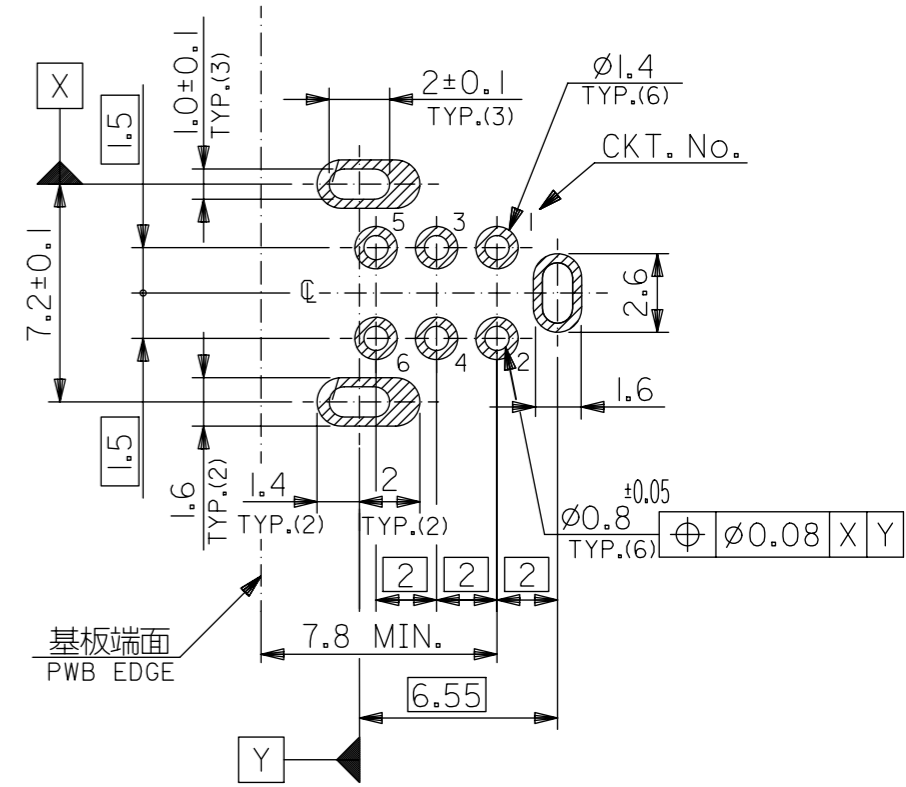
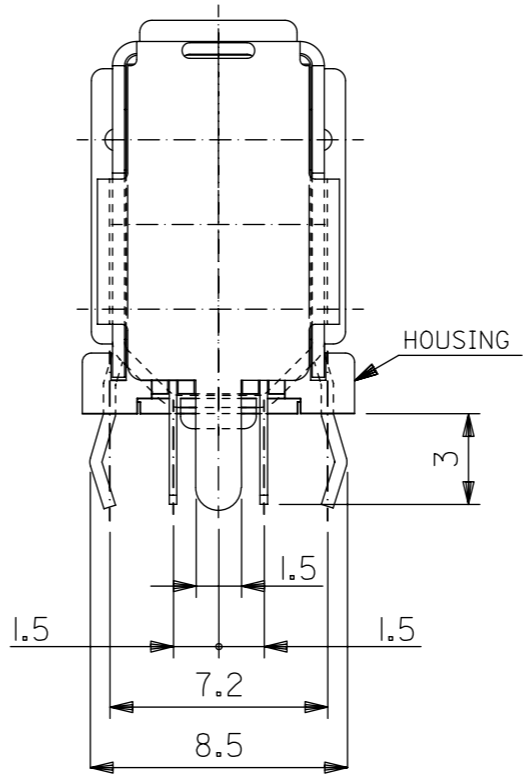

注記 :
NOTES :
1. 本製品は53460-0629の生産地変更品である。
THIS PRODUCT IS PRODUCTION TRANSFER OF 53460-0629.

6	53460-0639	53460-**39
CKT	MATERIAL NO.	MODEL NO.

THIS DRAWING CONTAINS INFORMATION THAT IS PROPRIETARY TO MOLEX ELECTRONIC TECHNOLOGIES, LLC AND SHOULD NOT BE USED WITHOUT WRITTEN PERMISSION		CURRENT REV DESC:		molex		
DIMENSION UNITS	SCALE	EC NO: 659204				
mm	4:1	DRWN: KNAGUMO 2021/03/09		PRODUCT CUSTOMER DRAWING		
GENERAL TOLERANCES (UNLESS SPECIFIED)		CHK'D: SHOSHIKAWA 2021/09/15		DOCUMENT NUMBER		
ANGULAR TOL ± 3.0°		APPR: SHOSHIKAWA 2021/09/15		534600000		DOC TYPE
4 PLACES	± 0.2	INITIAL REVISION:		PSD	001	REVISION
3 PLACES	± 0.2	DRWN: KTAKEUCHI01 2016/12/13		B		
2 PLACES	± 0.2	APPR: RTAKEUCHI 2018/03/15		SHEET NUMBER		
1 PLACE	± 0.2	DRAFT WHERE APPLICABLE MUST REMAIN WITHIN DIMENSIONS		1 OF 1		
0 PLACES	± 0.2	THIRD ANGLE PROJECTION	DRAWING	SERIES	MATERIAL NUMBER	CUSTOMER
			A3-SIZE	53460		