

DO NOT SCALE FROM THIS PRINT

TABLE 1				
"X"				
PIN STAGING	POSITION 1	POSITION 2	POSITION 3	POSITION 4
-01	1.10	1.10	1.10	1.10
-02	1.10	1.10	2.60	2.60
-03	1.10	2.60	2.60	1.10
-04	1.10	2.60	2.60	2.60
-05	2.60	2.60	2.60	1.10
-06	2.60	2.60	2.60	2.60

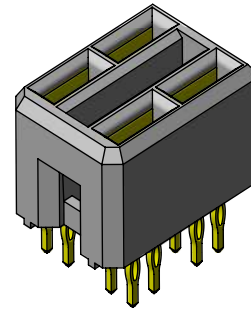

EPTS-X-X-D-VT-XX

**SERIES**  
EXAMAX™ POWER TRADITIONAL SOCKET

**PIN STAGING**  
-01 THRU -06 (SEE TABLE 1)

**POSITION**  
-2 : 4 POSITIONS

**PLATING**  
-P: PALLADIUM WITH FLASH GOLD ON CONTACTS, MATTE TIN TAILS.

**ORIENTATION**  
-VT: VERTICAL

**ROWS**  
-D: DOUBLE

SEE FCI-EPTS-X-X-D-VT-XX FOR SUB-ASSEMBLY PRINT

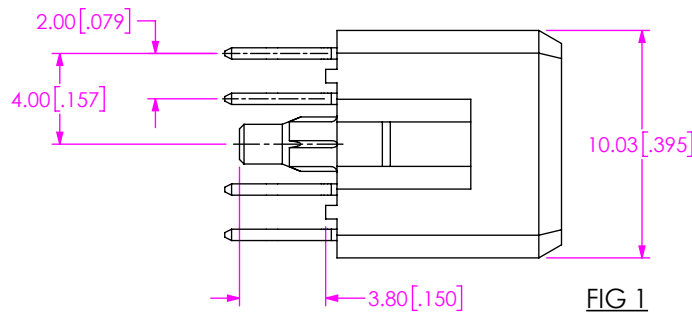
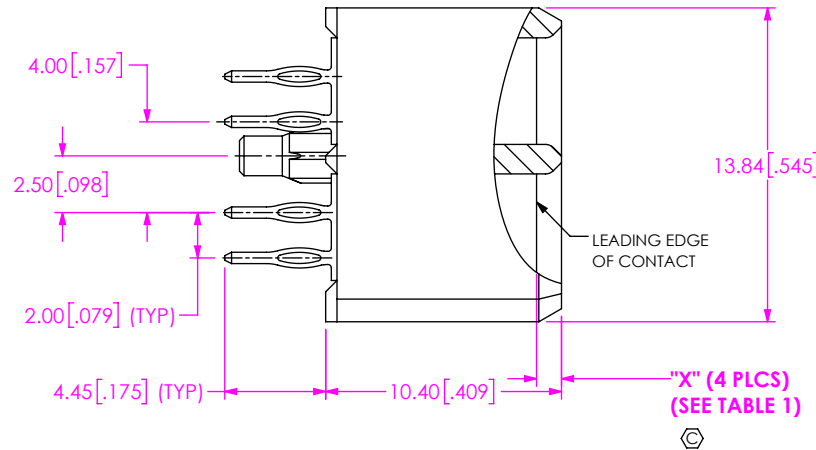
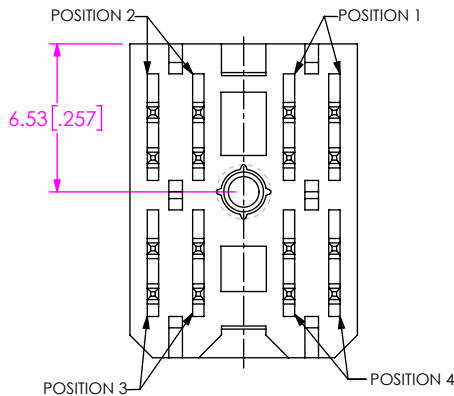
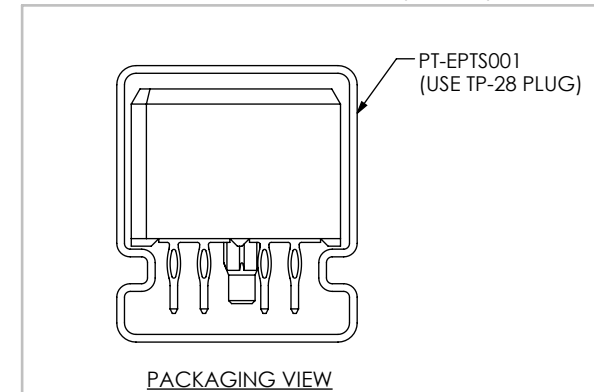
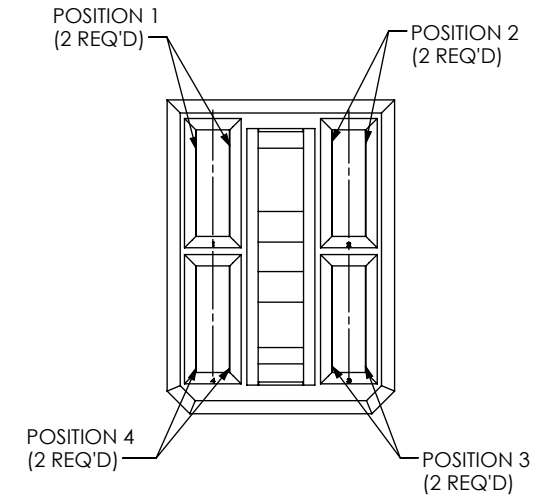

FIG 1  
EPTS-2-X-D-VT-XX SHOWN



NOTES:

- ⊗ REPRESENTS A CRITICAL DIMENSION.
- TUBES ARE STANDARD PACKAGING.
- SEE EPTS-X-X-D-VT-XX-FOOTPRINT DRAWING FOR RECOMMENDED PCB LAYOUT AND INFORMATION REGARDING PCB LAYOUT OF POWER MODULES RELATIVE TO SIGNAL MODULES.
- MINIMUM PULLOUT FORCE: 2.22N.
- NOMINAL PCB THICKNESS: 2.4MM [0.094] MINIMUM.
- ORDERS WILL BE PACKAGED ACCORDING TO THE SAMTEC PACKAGING EFFICIENCY STANDARDS (SPES) FOUND ON WWW.SAMTEC.COM

UNLESS OTHERWISE SPECIFIED, DIMENSIONS ARE IN MILLIMETERS [INCHES]. TOLERANCES ARE:  
 DECIMALS ANGLES  
 X.X: ±0.3 [01] 2°  
 X.XX: ±0.10 [004]  
 X.XXX: ±0.050 [0020]

**PROPRIETARY NOTE**  
 THIS DOCUMENT CONTAINS CONFIDENTIAL AND PROPRIETARY INFORMATION AND ALL DESIGN, MANUFACTURING, REPRODUCTION, USE, PATENT RIGHTS AND SALES RIGHTS ARE EXPRESSLY RESERVED BY SAMTEC, INC. THIS DOCUMENT SHALL NOT BE DISCLOSED, IN WHOLE OR PART, TO ANY UNAUTHORIZED PERSON OR ENTITY NOR REPRODUCED, TRANSFERRED OR INCORPORATED IN ANY OTHER PROJECT IN ANY MANNER WITHOUT THE EXPRESS WRITTEN CONSENT OF SAMTEC, INC.

MATERIAL: DO NOT SCALE DRAWING SHEET SCALE: 2:1  
 INSULATOR: NYLON  
 TERMINAL: PHOS BRONZE



520 PARK EAST BLVD, NEW ALBANY, IN 47150  
 PHONE: 812-944-6733 FAX: 812-948-5047  
 e-Mail: info@SAMTEC.com code 53322

DESCRIPTION:  
 EXAMAX® POWER-VERTICAL RECEPTACLE ASSY

DWG. NO.  
**EPTS-X-X-D-VT-XX**

BY: KNOWLDEN 9/2/2015 SHEET 1 OF 1