

PART NUMBER	REV	FIRST USED	POWER UNIT	FEED TYPE	DESCRIPTION
1855444-1	A	122500-1	LEADMAKER	AIR FEED	CUTS CARRIER
1855444-2	A	565435-5	BENCH MODEL K	AIR FEED	CUTS CARRIER
1855444-3	A	354500-1	BENCH MODEL G	AIR FEED	CUTS CARRIER
7-1855444-7	A	-	-	-	SPARE PARTS

- 1 RECOMMENDED SPARE PARTS
- 2 GREASE LIGHTLY
- 3 GUARD MUST BE IN PLACE WHEN OPERATING APPLICATOR IN A BENCH MACHINE
- 4 GRIND AT ASSEMBLY.
- 5. TERMINAL LUBRICANT IS REQUIRED.
- 6 INSTALL ITEMS 100,101 & 102 ON SIDE OF STRIPPER ON APPLICATOR HOUSING USING ITEM 21.

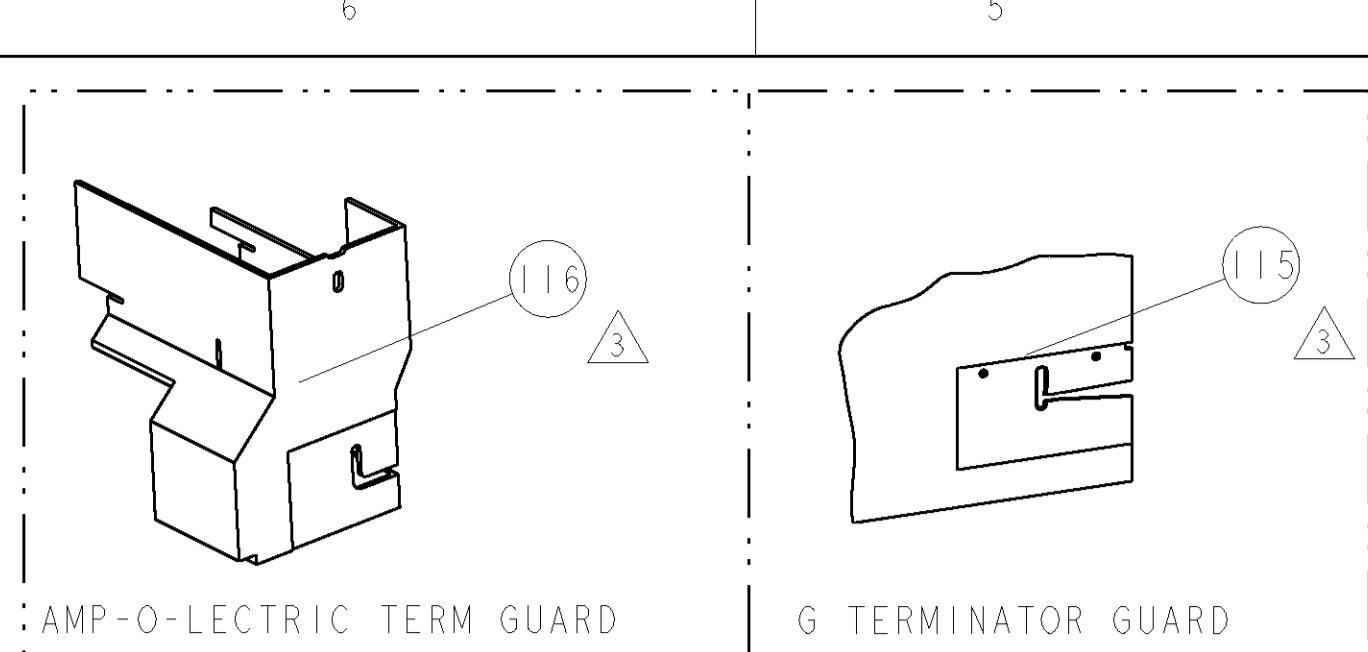

TERMINAL NAME: RING UNPLATED TERMINAL		DELPHI TERMINAL - DELPHI CRIMP SPECS		REF SETTING
TE PN	DELPHI			
1949821	12004983			
		CRIMP HEIGHT	WIRE SIZE	
-	-	3.50mm+.05/- .05 [.138+.002/- .002]	5mm2	A9
-	-	3.20mm+.05/- .05 [.126+.002/- .002]	3mm2	C9
		CRIMP	SIZE	TYPE
-	-	WIRE	5.08mm [.200]	F
-	-	INSUL	7.11mm [.280]	F
WIRE STRIP LENGTH	TERM APPL SPEC	FEED	APPLICATOR INSTRUCTIONS	SET UP GAGE
6.80-7.40	NONE	19.80	408-8040	458637-1

*** WARNING**
ON INSTALLATION, SET WIRE DISC TO LARGEST WIRE SIZE SETTING. USE OF SETTINGS BELOW MIN. REQUIRED CRIMP HEIGHT SETTING WILL CAUSE DAMAGE TO CRIMP TOOLING.

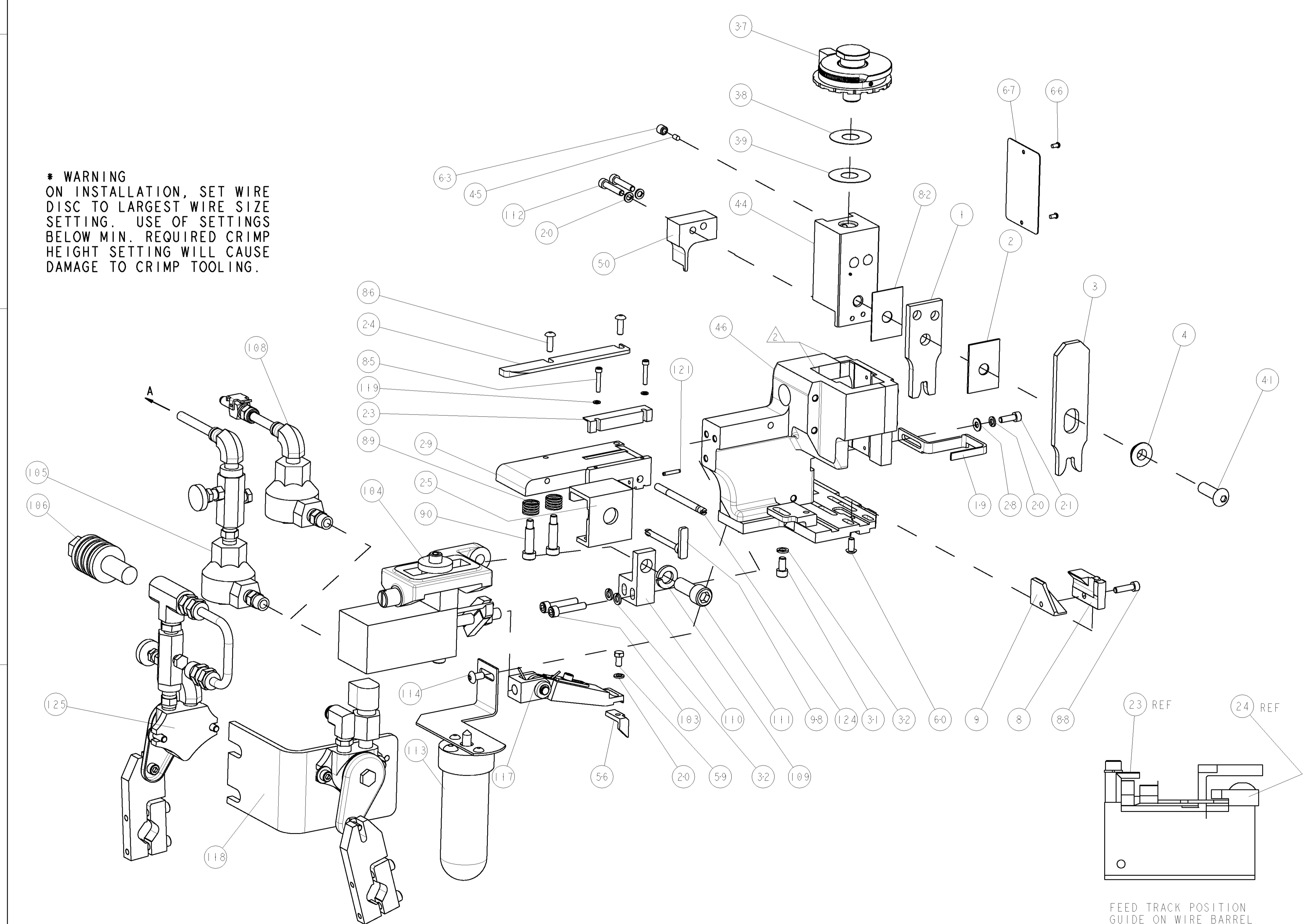

LOC	DIST	REV	DESCRIPTION	DATE	DWN	APPR
A	66		RELEASED	09FEB2009	BH	BH

-	-	1	-	455350-4	AIR BLAST ASS'Y	125
-	-	1	1	690432-6	ADJUSTMENT SCREW	124
-	-	1	1	3-21028-7	PIN, SLOTTED SPRING .094 X .562	121
-	-	2	2	21024-2	WASHER, SPRG LOCK, REG NO 4	119
-	-	-	-	692655-6	AIR FEED VALVE ASSEMBLY	118
-	-	1	1	461062-1	FEED FINGER ASSEMBLY	117
-	-	REF	-	455749-1	GUARD WINDOW	116
-	-	REF	-	679532-1	INSERT, GUARD	115
-	-	1	1	2-21002-6	SCR, BTN SKT HD CAP 10-32 X .375	114
-	-	-	-	1-465184-0	LUBRICATOR ASSY	113
-	-	2	2	3-21000-0	SCR, SKT HD CAP 8-32 X .875	112
-	-	1	1	3-21001-5	SCR, SKT HD CAP 3/8-16 X 1.000	111
-	-	1	1	459610-1	MOUNT, FEED BRACKET	110
-	-	1	1	21024-8	WASHER, SPRG LOCK, REG 3/8	109
-	-	-	-	692655-7	AIR FEED VALVE ASSEMBLY	108
-	-	-	-	24042-2	VALVE, SLEEVE, 3-WAY	106
-	-	-	-	692655-5	AIR FEED VALVE ASSEMBLY	105
-	-	1	1	461065-1	ASSEMBLY, AIR FEED	104
-	-	2	2	3-21000-9	SCR, SKT HD CAP 10-32 X 1.000	103
-	-	1	1	986220-3	CLAMP, CABLE, BLACK	102
-	-	1	1	23238-1	INSERT, COUPLING	101
-	-	18.0	24.0	18.0	TUBING 1/4" O.D.	100
-	-	1	1	690546-1	LEVER, DRAG RELEASE	98
-	-	2	2	1-27210-8	SCR, SHLD, HEX HD, 1/4 DIA	90
-	-	2	2	1-22284-0	SPRING, COMPRESSION	89
-	-	1	1	2-21000-8	SCR, SKT HD CAP 8-32 X .625	88
-	-	2	2	2-21002-2	SCR, BTN SKT HD CAP 8-32 X .500	86
-	-	2	2	1-21000-6	SCR, SKT HD CAP 4-40 X .625	85
-	-	1	1	455888-5	SPACER, CRIMPER	82
-	-	1	1	4088040	SF APPL INST 408-8040	72
-	-	1	1	217238-1	GENERAL INSTRUCTION PKG	71
-	-	1	1	461264-5	PLATE, IDENTIFICATION	67
-	-	2	2	21017-2	SCREW, DRIVE	66
-	-	1	1	21009-2	SCR, SET, SELF LOCKING 1/4-20 X .250	63
-	-	1	1	22733-8	SCR, BHSC, SELF-LOCKING, 8-32 X .375	60
-	-	1	1	2-22603-0	SCREW, MACH, HEX HD, 8-32 X .312	59
-	-	1	1	1-694433-8	FEED PAWL	56
-	-	1	1	1338284-4	SHEAR	50
-	-	1	1	1633399-1	APPL., BASIC AIR FEED SUB ASSY	46
-	-	1	1	690191-1	PLUG, NYLON	45
-	-	1	1	1-455673-4	RAM, SIDE FEED	44
-	-	1	1	7-21002-9	SCR, BTN SKT HD CAP 5/16-24 X 1.00	41
-	-	1	1	690125-1	SHIM SUB-ASSY	39
-	-	1	1	469367-1	SHIM	38
-	-	1	1	879103-2	FINE ADJUST HEAD ASSEMBLY	37
-	-	3	3	21024-5	WASHER, SPRG LOCK, REG NO 10	32
-	-	1	1	3-21000-4	SCR, SKT HD CAP 10-32 X .375	31
-	-	1	1	3-455671-2	PLATE, STRIP GUIDE	29
-	-	1	1	21055-6	WASHER, FLAT, REG NO 8	28
-	-	1	1	5-690754-9	DRAG, SPECIAL	25
-	-	1	1	8-690440-4	GUIDE, REAR STRIP	24
-	-	1	1	2-690712-9	FRONT STRIP GUIDE	23
-	-	1	1	2-21000-7	SCR, SKT HD CAP 8-32 X .500	21
-	-	4	4	21024-4	WASHER, SPRG LOCK, REG NO 8	20
-	-	1	1	456468-5	STRIPPER, SPECIAL	19
-	-	-	-	-	-	12
-	-	-	-	-	-	11
-	-	-	-	-	-	10
-	-	1	1	1633742-1	PLATE, REAR SHEAR	9
-	-	1	1	1633739-1	ANVIL	8
-	-	-	-	-	-	6
-	-	-	-	-	-	5
-	-	1	1	3-238009-8	BLOCK, FL CRIMPER SPACER	4
-	-	1	1	4-1633511-0	CRIMPER, INSULATION F	3
-	-	1	1	1-455888-0	SPACER, CRIMPER	2
-	-	1	1	5-1633588-9	CRIMPER, WIRE	1

FEED TRACK POSITION GUIDE ON WIRE BARREL

DIMENSIONS: INCHES		TOLERANCES UNLESS OTHERWISE SPECIFIED:		DWN: B. HIGMAN 09DEC2008		Tyco Electronics Tyco Electronics Harrisburg, PA 17105-3608	
0 PLC	±	1 PLC	±0.1	CHK: T. ELBIN 09DEC2008	NAME: FINE ADJUST SIDE FEED HDM APPLICATOR		
2 PLC	±0.01	3 PLC	±0.001	APPR: N. DEMING 09DEC2008	PRODUCT SPEC: -		
4 PLC	±0.0001	ANGLES	±	APPLICATION SPEC: -			
MATERIAL: -		FINISH: -		WEIGHT: -		SIZE: A 00779 C=1855444	
CUSTOMER DRAWING				SCALE: 3:5		SHEET 1 OF 1 REV A	