



### FEATURES

- Magnetic connector
- Self-mating & self-alignment
- Food grade materials
- Prevents wire & cable damage
- Easy cleaning
- 5000 mating cycles
- IP67 (mated)
- Gold plated Pogo pins (spring loaded)

### SPECIFICATIONS

#### Electrical

|          |                     |
|----------|---------------------|
| Voltage  | 48VDC max           |
| Amperage | 1.5A                |
| Pins     | 18 AWG wire maximum |

#### MECHANICAL

|                 |                           |
|-----------------|---------------------------|
| Material        | Food grade Teflon (white) |
| Shell           | 316 stainless steel       |
| Pins            | Gold plated (x6)          |
| Weight          | 70g (2.5 oz)              |
| Retention force | 10 pounds                 |
| Connector type  | Self-mating               |
| Cable size      | 2.8 - 8.0mm (1/8" - 1/4") |

#### ENVIRONMENT

|                       |                                 |
|-----------------------|---------------------------------|
| Rating                | IP67 / NEMA 6 (mated)           |
| Operating temperature | -40°C to 150°C (-40°F to 302°F) |
| Dust & waterproof     |                                 |

#### TYPICAL APPLICATIONS

Temperature probes, measuring instruments, auto manufacturing, food & pharma, manufacturing equipment, Ethernet communications, drones and more

## MAGNETIC CONNECTOR 6P MALE



MP6-M-RTD2

Male connector – 6 pins

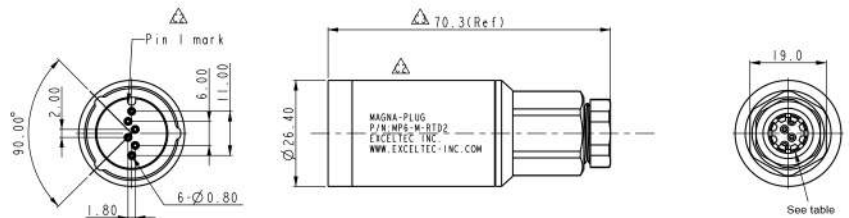

Female connector    Panel Mount    Male connector

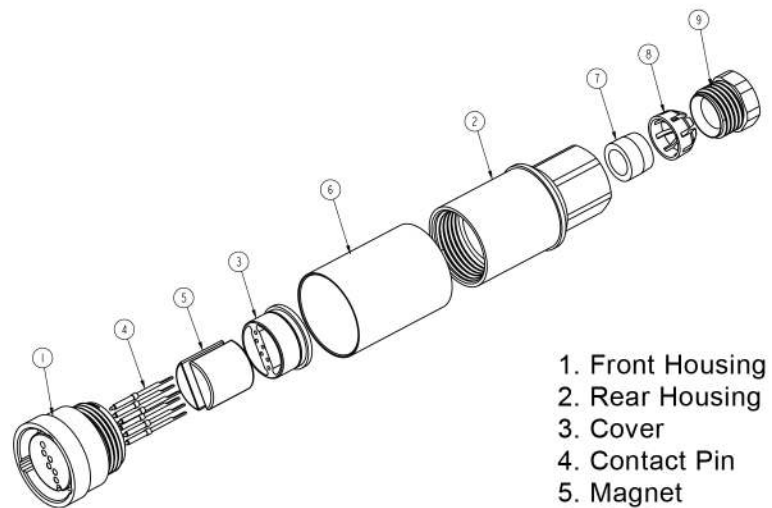

1. Front Housing
2. Rear Housing
3. Cover
4. Contact Pin
5. Magnet
6. Shell
7. Ring
8. Claw
9. Nut

## ORDERING INFORMATION

| Part number | Description             |
|-------------|-------------------------|
| MP6-M-RTD2  | Male connector – 6 pins |