

PART NUMBER	REV	TERMINATOR	FEED TYPE	DESCRIPTION
1528791-1	A	LEADMAKER	MECH POST FEED	CUTS CARRIER
1528791-2	A	BENCH	MECH PRE FEED	CUTS CARRIER
1528791-6	A	LEADMAKER	MECH POST FEED	CONTINUOUS CARRIER
7-1528791-1	A	LEADMAKER	MECH POST FEED	-1 AND SPARE PARTS
7-1528791-2	A	BENCH	MECH PRE FEED	-2 AND SPARE PARTS
7-1528791-6	A	LEADMAKER	MECH POST FEED	-6 AND SPARE PARTS
7-1528791-7	A	-	-	SPARE PARTS KIT

CRIMP DATA	TYCO TERMINAL	TYCO CRIMP SPECS
TERMINAL NAME: 5.16 TAB (.203 POSITIVE MATE)		
CRIMP	SIZE	TYPE
WIRE	2.54 [1.00 IN]	F
INSUL	3.56 [1.40 IN]	F
RANGE: 0.50-1.50mm <sup>2</sup>		
APPL INSTRUCTIONS: 408-8322 & 408-8490		
WIRE STRIP LENGTH: 4.80-5.60 [1.89-.220 IN]		
TERMINAL APPL SPEC: 114-3118 FEED: 16.87 [0.664 IN]		
TERMINALS APPLIED		
342868	-	-
-	-	-
-	-	-
-	-	-
WIRE SIZE	CRIMP HEIGHT	REF SETTING
1.50mm <sup>2</sup>	1.52 ± 0.05 [0.060 ± .002 IN]	B 4
1.00mm <sup>2</sup>	1.35 ± 0.05 [0.053 ± .002 IN]	D 0
0.75mm <sup>2</sup>	1.27 ± 0.05 [0.050 ± .002 IN]	D 5
0.50mm <sup>2</sup>	1.17 ± 0.05 [0.046 ± .002 IN]	E 4

- △ RECOMMENDED SPARE PARTS.
- 2. GREASE RAM, CAM, CAM FOLLOWER AND FEED ROD LIGHTLY.
- △ CERTAIN TERMINALS REQUIRE LUBRICATION. REFER TO THE APPLICATOR INSTRUCTION SHEET FOR MORE INFORMATION.
- 4. LUBRICATE DAILY PER THE APPLICATOR INSTRUCTION SHEET SUPPLIED WITH THE APPLICATOR.

**\* WARNING**  
ON INSTALLATION, SET WIRE DISC TO LARGEST WIRE SIZE SETTING. USE OF SETTINGS BELOW MIN. REQUIRED CRIMP HEIGHT SETTING WILL CAUSE DAMAGE TO CRIMP TOOLING.

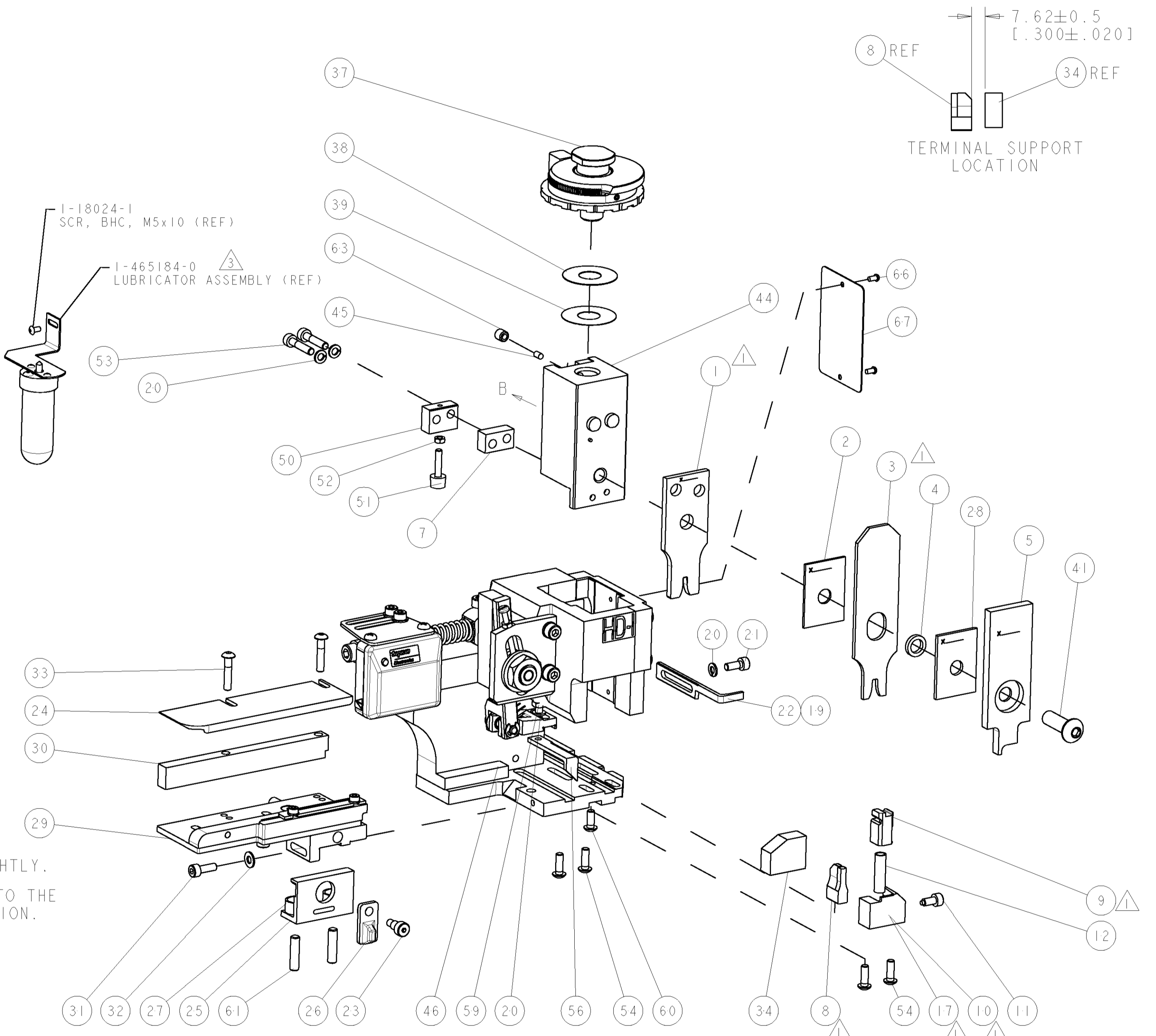
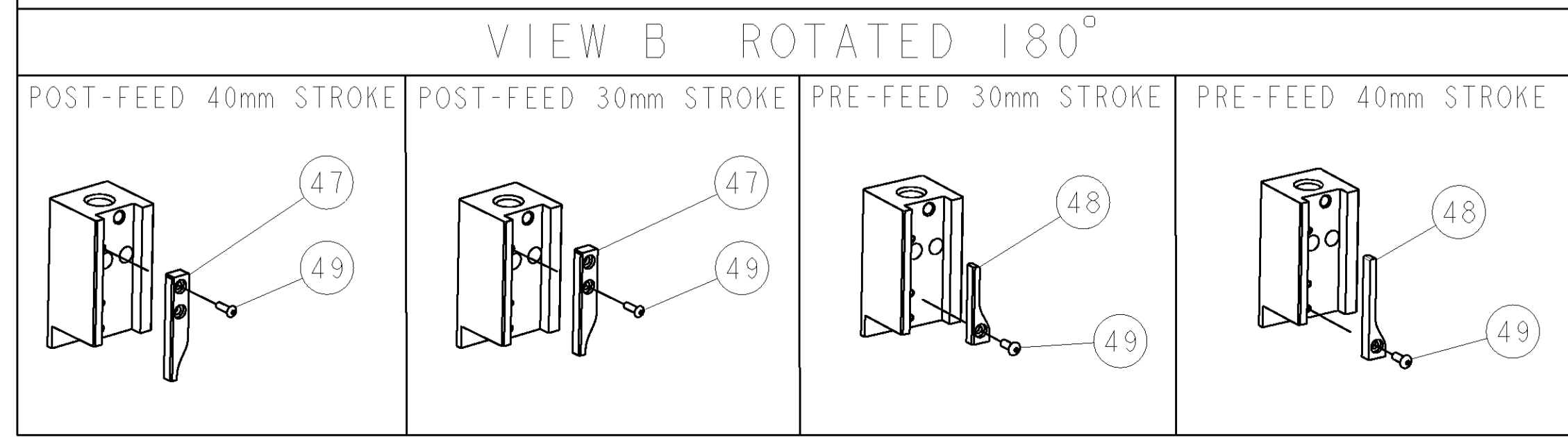

LOC	DIST	REV	DESCRIPTION	DATE	BY	APPV
A	66		SEE ECR-07-011411	15MAY2007	LJL	MC

QTY	UNIT	DESCRIPTION	ITEM NO
-	-	-	73
-	-	-	72
-	-	-	71
-	-	-	70
-	-	-	69
-	-	-	68
-	-	-	67
-	-	-	66
-	-	-	65
-	-	-	64
-	-	-	63
-	-	-	62
-	-	-	61
-	-	-	60
-	-	-	59
-	-	-	58
-	-	-	57
-	-	-	56
-	-	-	55
-	-	-	54
-	-	-	53
-	-	-	52
-	-	-	51
-	-	-	50
-	-	-	49
-	-	-	48
-	-	-	47
-	-	-	46
-	-	-	45
-	-	-	44
-	-	-	43
-	-	-	42
-	-	-	41
-	-	-	40
-	-	-	39
-	-	-	38
-	-	-	37
-	-	-	36
-	-	-	35
-	-	-	34
-	-	-	33
-	-	-	32
-	-	-	31
-	-	-	30
-	-	-	29
-	-	-	28
-	-	-	27
-	-	-	26
-	-	-	25
-	-	-	24
-	-	-	23
-	-	-	22
-	-	-	21
-	-	-	20
-	-	-	19
-	-	-	18
-	-	-	17
-	-	-	16
-	-	-	15
-	-	-	14
-	-	-	13
-	-	-	12
-	-	-	11
-	-	-	10
-	-	-	9
-	-	-	8
-	-	-	7
-	-	-	6
-	-	-	5
-	-	-	4
-	-	-	3
-	-	-	2
-	-	-	1

QTY	UNIT	DESCRIPTION	ITEM NO						
-	-	-	84						
-	-	-	83						
-	-	-	82						
-	-	-	81						
-	-	-	80						
-	-	-	79						
-	-	-	78						
-	-	-	77						
-	-	-	76						
-	-	-	75						
-	-	-	74						
QTY	UNIT	DESCRIPTION	ITEM NO						
-77	-76	-72	-71	-6	-2	-1	PART NO	DESCRIPTION	ITEM NO

DIMENSIONS: mm [IN] 	TOLERANCES UNLESS OTHERWISE SPECIFIED: 0 PLC ± 1 PLC ± 2 PLC ± 3 PLC ± 4 PLC ± ANGLES ±	DWG: 19APR2007 CHK: M. CLIFFORD APVD: M. CLIFFORD PRODUCT SPEC APPLICATION SPEC See Table WEIGHT MATERIAL FINISH	<b>tyco</b> Tyco Electronics Harrisburg, PA 17105-3608 <b>FINE ADJUST SIDE FEED HDI APPLICATOR</b> SIZE: 00779 CAGE CODE: 1528791 SCALE: 3:5 SHEET: 1 OF 1 REV: A
----------------------------	---	--	---