

THIS DRAWING AND THE SPECIFICATIONS CONTAINED HEREIN ARE CONFIDENTIAL AND PROPRIETARY. THEY ARE THE PROPERTY OF AVID THERMAL TECHNOLOGIES INC. AND SHALL NOT BE REPRODUCED OR COPIED OR USED IN WHOLE OR IN PART AS THE BASIS FOR THE MANUFACTURE OR SALE OF ITEMS WITHOUT WRITTEN PERMISSION. THIS IS AN UNPUBLISHED WORK PROTECTED UNDER THE FEDERAL COPYRIGHT LAWS. 1995

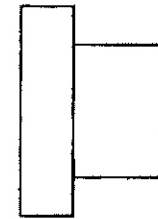
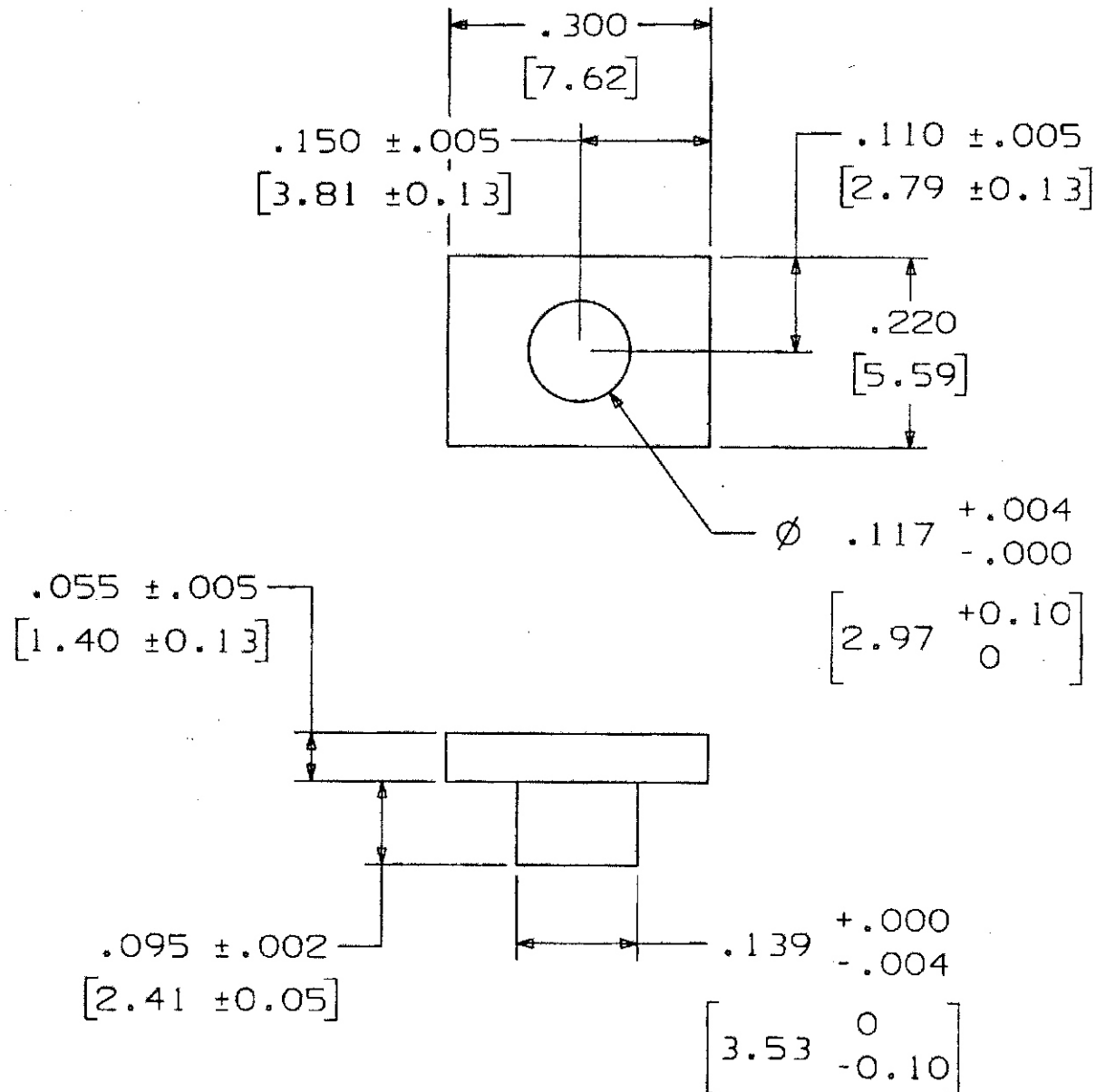
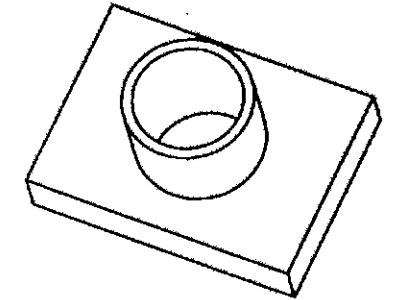

**ROHS COMPLIANT**  
PER AVID SPEC: ROHS - 9000

NOTES:

- 1) TEST PER THERMALLOY E.I.R. #83-1001 PRIOR TO RELEASE FOR SHIPMENT.
- 2) A SINGLE GATE EXTENSION, NOT TO EXCEED  $.025$  (.64) IN LENGTH, IS ALLOWABLE ON THE OUTSIDE PERIPHERY OF ALL INSULATING SHOULDER WASHERS.
- 3) AFTER MOLDING, ANNEAL THIS PART BY HEAT TREATING AT 400 DEG. F FOR NO LESS THAN 3 HOURS.
- 4) MATERIAL: POLYPHENYLENE SULFIDE PER ASTM D4067-84 PPS 000G40A43443 (COLOR BROWN).

|      |         |                             |       |
|------|---------|-----------------------------|-------|
| D    | 3/24/06 | CHANGE DESC PER ECN# 018513 | MIKEL |
| C    | 4/11/03 | REDRAW PER ECN# 015549      | MIKEL |
| REV. | DATE    | DESCRIPTION                 | CHK'D |

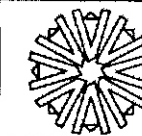

**AAVID THERMALLOY**

80 COMMERCIAL ST.  
CONCORD, N.H.  
03301

|                     |  |          |       |             |
|---------------------|--|----------|-------|-------------|
| FINISH              | N/A                                      |          |       |             |
| U/O                 | DRAWING NO. 034701                       |          |       |             |
| MAT'L               | SEE NOTE 4                               |          |       |             |
| TOLERANCE           | STANDARD DESCRIPTION THM,18698-2 REV B-G |          |       |             |
| UNLESS NOTED        |  | DATE     | DRAWN | ENGR.       |
| .XX = ±.015 [±.38]  |  | 04/11/03 | P.C.  |             |
| .XXX = ±.010 [±.25] |  |          |       |             |
| ANGULAR ± 3°        | REF: 7721-10 PPS                         |          | SHEET | SCALE 5.000 |