

6 5 4 3 2 1

APPROVED: _____
 DATE: _____ TITLE: _____

Rev	AWO #	Description	Date	Appr
-	11227	RELEASED	4/11/11	
A		REVISED SHAPE & SPEC.	4/10/12	
B		UPDATE DRAWING	11/8/17	AY/TY

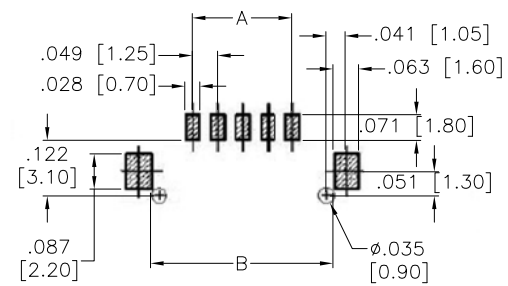
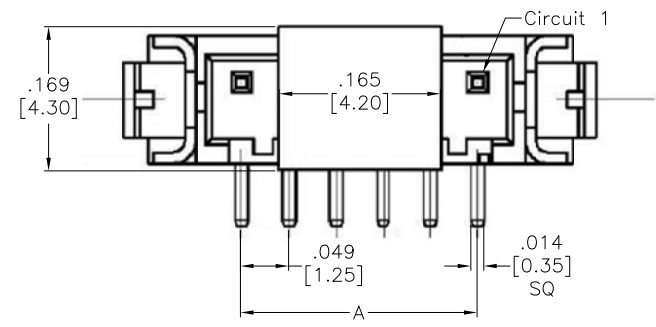

RECOMMENDED PCB LAYOUT

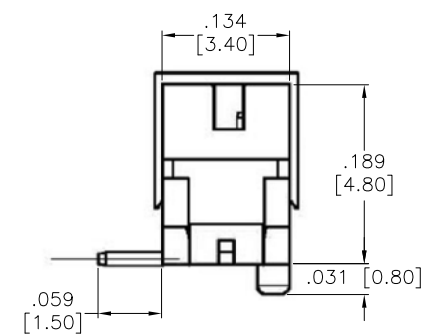
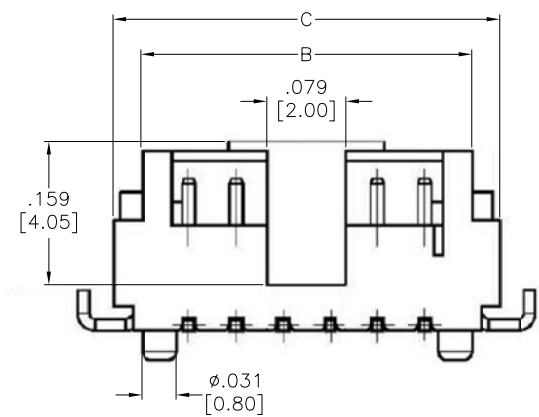

Positions: 02 thru 15
 A = .049 [1.25] X No. of Spaces
 B = .049 [1.25] X No. of Spaces + .114 [2.90]
 C = .049 [1.25] X No. of Spaces + .197 [5.00]

PACKAGED ON TAPE & REEL

SPECIFICATIONS:

Material:
 Insulator: Hi-temp thermoplastic, rated UL 94V-0
 Insulator color: Natural
 Contacts: Phosphor Bronze, Tin plated
 Solder Tabs: Brass, Tin plated

Electrical:
 Voltage rating: 100V AC,DC
 Current rating: 1A AC,DC
 Contact resistance: 20 mohms max
 Insulation resistance: 500 Mohms min
 Withstanding voltage: 500 VAC for 1 minute
Environmental:
 Lead free, RoHS compliant.



UNLESS OTHERWISE SPECIFIED ALL DIMENSIONS ARE INCHES [MM] TOLERANCES: EXCEPT AS NOTED			
.X	± .10	∅X	± .10
.XX	± .020	∅XX	± .015
.XXX	± .015	∅XXX	± .010

ADAM TECH
 909 Rahway Avenue, Union, NJ 07083
 Phone: 908-687-5000 Fax: 908-687-5710

APPROVALS		DATE
DRAWN	DY	4/11/11
CHECKED		
APPROVED		

TITLE .049 [1.25] PITCH WIRE TO BOARD HEADER STRAIGHT, SMT TYPE		
SIZE X	PART NO. 125SH-C-XX-TS-SMT-T/R	REV. B
REF: S00123T	SCALE: NTS	SHEET 1 OF 1