

NOTES:

- 1. ONLY THE ITEMS WITH QUANTITIES SPECIFIED ON PARTS LIST ARE USED ON THIS APPLICATOR.
 - △ USED IN PLACE OF ITEM 38 WHEN INSULATION CRIMP IS NOT USED.
 - △ GUARD MUST BE IN PLACE WHEN OPERATING APPLICATOR IN AMP-O-LECTRIC PRESS.
 - 4. PARTS WITH QTY. OF REF. SPECIFIED (EXCEPT ITEM 79) ARE USED ON ITEM 32.
- KEY:**
- RECOMMENDED SPARE PARTS.
 - ▲ LUBRICATE DAILY USING NO. 20 MACHINE OIL.
 - GREASE LIGHTLY.

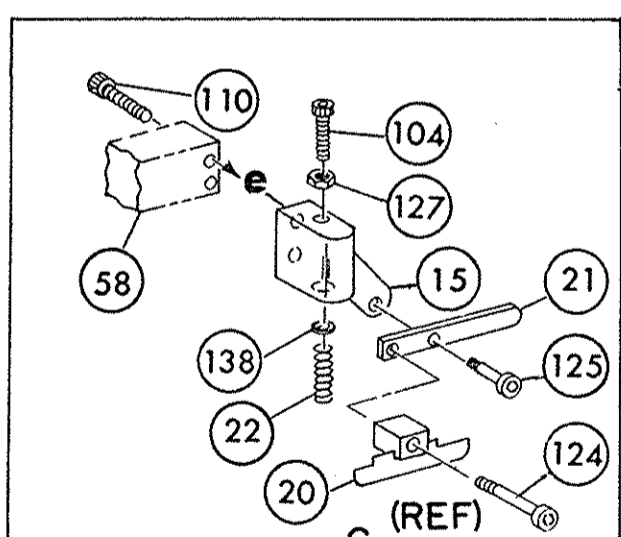

REF.	21045-3	RING, RETAINING 'C' (.187 DIA) FEED PIN	145	REF.	454220-1	CAP, RAM	59
REF.	5-21028-1	PIN, SLOT SPG (.12 DIA X .50) FD ADJ ROD	143	REF.	453736-1	HOUSING	58
REF.	1-21030-7	PIN, DOWEL (.187 DIA X 1.50) HOUSING	141	REF.	240624-1	PIN, FEED FINGER	55
REF.	1-21030-1	PIN, DOWEL (.187 DIA X .50) LEVER	140	REF.	691499-1	SPRING, FEED FINGER	54
REF.	22260-5	WASHER, FLAT (NO 6) DRAG SPRING	138	REF.	240635-1	FINGER, FEED	53
REF.	21899-4	WASHER, FLAT (5/16 DIA) SCR ADJ	137	REF.	240634-1	LEVER, TERMINAL	52
REF.	21024-5	WASHER, LOCK (NO 10) FEED ADJ PLATE	135	1	7-21002-9	BOLT, CRIMPER	49
2	21024-5	WASHER, LOCK (NO 10) SHEAR PLATES	134	1	690501-4	CAM, POST FEED 1 5/8 STROKE	48
REF.	21024-5	WASHER, LOCK (NO 10) FEED ROD GUIDE	133				47
5	21024-4	WASHER, LOCK (NO 8) STRIP GUIDE	132				46
2	21024-4	WASHER, LOCK (NO 8) SHEAR BLADE	131	1	690191-1	PLUG, NYLON	45
2	21018-4	NUT, HEX MACH (4-40) DRAG	130	1	455674-1	RAM	44
REF.	21068-5	NUT, HEX MACH (6-32) FD ADJ PLATE	128	1	690125-1	WASHER, LAMINATED	43
REF.	21018-7	NUT, HEX MACH (10-32) DRAG SPRING	127	1	690124-1	WASHER, RAM	42
2	21022-2	NUT, HEX SELF-LKG (8-32) DRAG STUD	126	2	23241-6	BALL, STEEL	40
REF.	5-21004-7	SCR, SKT HD SHLD (250 DIA X .25) DRAG ARM	125	2	690170-1	SPRING, COMPRESSION	39
REF.	21004-5	SCR, SKT HD SHLD (250 DIA X 1.00) DRAG	124	1	690142-1	DISC, INSULATION	38
2	4-21078-8	SCR, SKT SET OVAL POINT (4-40 X .75) DRAG	123	1	690141-4	DISC, WIRE	37
2	21009-2	SCR, SKT SET (1/4-20 X 25) (LOC-WEL) RAM	122	1	22480-5	WASHER, SPRING	36
2	21017-2	DRIVE SCR (#2 X .19)	121	1	690212-1	POST, RAM	35
1	1-21002-7	SCR, BTN. HD SKT CAP (6-32 X .38) CAM	120				34
1	461264-1	PLATE IDENTIFICATION	119				33
REF.	3-21064-2	SCR, RD HD MACH (6-32 X 1.50) FEED ADJ	118	1	458980-1	APPLICATOR, BASIC (SUB ASSY)	32
2	2-21002-2	SCR, BTN HD SKT CAP (8-32 X .50) STRIPPER	117				31
REF.	2-21002-9	SCR, BTN HD SKT CAP (10-32 X .75) HSG CAP	115				30
1	22733-8	SCR, BTN HD SKT CAP (8-32 X .38) (LOC-WEL) ANVIL	114	1	3-690451-2	SPACER, STRIPPER	28
4	3-21002-3	SCR, BTN HD SKT CAP (1/4-20 X .50) STR GDE PL	113	1	240639-1	STRIPPER	27
REF.	2-22733-9	SCR, BTN HD SKT CAP (1/4-20 X .75) BASE PL	112	REF.	455676-1	PLATE, BASE	26
REF.	2-21000-4	SCR, SKT HD CAP (6-32 X 1.00) DRAG ADAPTOR	111	2	22354-8	DRAG, STUD	25
2	23030-1	SCR, SKT HD CAP (6-32 X .25) (LOC-WEL) CP DISC	109	1	455678-1	PLATE, STRIP GUIDE	24
2	2-21000-6	SCR, SKT HD CAP (8-32 X .38) SHEAR BLADE	108	2	240825-2	PLATE, STRIP HOLD	23
3	2-21000-6	SCR, SKT HD CAP (8-32 X .38) STRIP GUIDE	107	REF.	4-22281-1	SPRING, DRAG	22
2	2-21000-9	SCR, SKT HD CAP (8-32 X .75) STRIP GUIDE	106	1	240636-1	LEVER, DRAG	21
REF.	3-21000-7	SCR, SKT HD CAP (10-32 X .75) FD ROD GUIDE	105	1	454177-1	DRAG, STOCK	20
REF.	3-21000-9	SCR, SKT HD CAP (10-32 X 1.00) DRAG SPRING	104	1	454204-3	GUIDE, STRIP (REAR)	19
REF.	3-21000-6	SCR, SKT HD CAP (10-32 X .62) FD ADJ PLATE	103	REF.	454178-1	GUIDE, STRIP (FRONT)	18
REF.	3-21000-4	SCR, SKT HD CAP (10-32 X .38) PIVOT BLK	102	REF.	454178-1	GUIDE, FEED ROD	17
2	3-21000-8	SCR, SKT HD CAP (10-32 X .88) SHEAR PLATE	101	REF.	4-22284-9	SPRING, FEED RETURN	16
REF.	455745-1	GUARD, WINDOW	79			ADAPTER, DRAG	15
REF.	465184-9	LUBRICATOR ASSY	78				14
REF.	455985-1	OIL, LUBRICATING	77				13
REF.	454406-1	SPACER, LUB BRACKET	76	1	23846-1	SPACER, HOLD DOWN	12
REF.	458109-1	WASHER, FLAT (SPECIAL)	74	1	240644-1	SPRING, HOLD DOWN	11
2	690603-1	SPRING, ASSIST	73	1	690495-6	PLATE, REAR SHEAR	10
REF.	690517-1	SPACER	72	1	240655-1	PLATE, FRONT SHEAR	9
REF.	22594-8	NUT, HEX	71	1	690474-4	ANVIL	8
REF.	240628-1	PLATE, ADJ	70	1	1-455892-1	BLADE, SLUG	7
REF.	240626-1	SHAFT, PIVOT	69	1	240641-7	HOLD DOWN, TERMINAL	6
REF.	240633-1	BUSHING	68	1	238009-1	SPACER, SHEAR BLADE	5
REF.	455680-1	LEVER, INTERMEDIATE	67	1	4-456134-6	SPACER, TUBULAR	4
REF.	240629-1	BLOCK, PIVOT	66	1	455888-8	CRIMPER, INSULATION	3
REF.	240632-2	SCREW, ADJ	65	1	456409-7	SPACER, INSULATION	2
REF.	240659-3	PIN, CAM ROLLER	64			CRIMPER, WIRE	1
REF.	240658-1	CAM, ROLLER	63				
REF.	454398-1	ROD, FEED	62				

CRIMPING DATA				APPLICATOR WILL APPLY	
PAD LTR	CRIMP HEIGHT	WIRE SIZE	WIRE LENGTH		
A	.075	14	.237-.267		62500
B	.071	(2)#18	.237-.267		41832
C	.066	16	.237-.267		
D	.061	18	.237-.267		

CRIMP	SIZE	TYPE	FEED	APPL INST
WIRE	.120	F	.845	A1 8039
INSUL	.180	F	.845	A1 8039

WIRE RANGE	INSULATION RANGE	PRESS NO
18-14	.120-.170	

REMARKS	DISTRIBUTION
APPL USED ON MACHINE PART NO	ORIGINAL
CUSTOMER NAME	CUSTOMER COPY
ADDRESS	FIELD ENG COPY
CITY	

REMARKS	NO	REV
APPL USED ON MACHINE PART NO	TO APPLY TERMINAL SPEC 114-2036	
CUSTOMER NAME	DISTRIBUTION	
ADDRESS	ORIGINAL	
CITY	CUSTOMER COPY	
	FIELD ENG COPY	

REV	DATE	DESCRIPTION	BY	CHKD	APPD
1	1-06	SET UP PAGE 10-1			
2	2-05	458638-1 32 B			
3	4-03	DR 6-2374 APP 6/1/78			
4	3-03	CHK 6/1 REL 6/27/78			
5	3-97	CHK 6/1 REL 6/27/78			
6	5-78	CHK 6/1 REL 6/27/78			
7	2-96	CHK 6/1 REL 6/27/78			
8	2-84	CHK 6/1 REL 6/27/78			