

THIS DRAWING IS A CONTROLLED DOCUMENT FOR THE AMP INC. IT IS SUBJECT TO CHANGE AND THE USER IS ADVISED TO CHECK THE LATEST REVISIONS OF THIS DRAWING FOR THE LATEST REVISIONS.

THIS INFORMATION IS CONFIDENTIAL AND IS TO BE KEPT AS SUCH. IT IS TO BE KEPT AS SUCH AND NOT TO BE REPRODUCED OR TRANSMITTED IN ANY FORM OR BY ANY MEANS, ELECTRONIC OR MECHANICAL, INCLUDING PHOTOCOPYING, RECORDING, OR BY ANY INFORMATION STORAGE AND RETRIEVAL SYSTEM, WITHOUT WRITTEN AUTHORIZATION FROM AMP INCORPORATED, HARRISBURG, PA.

DIST 10

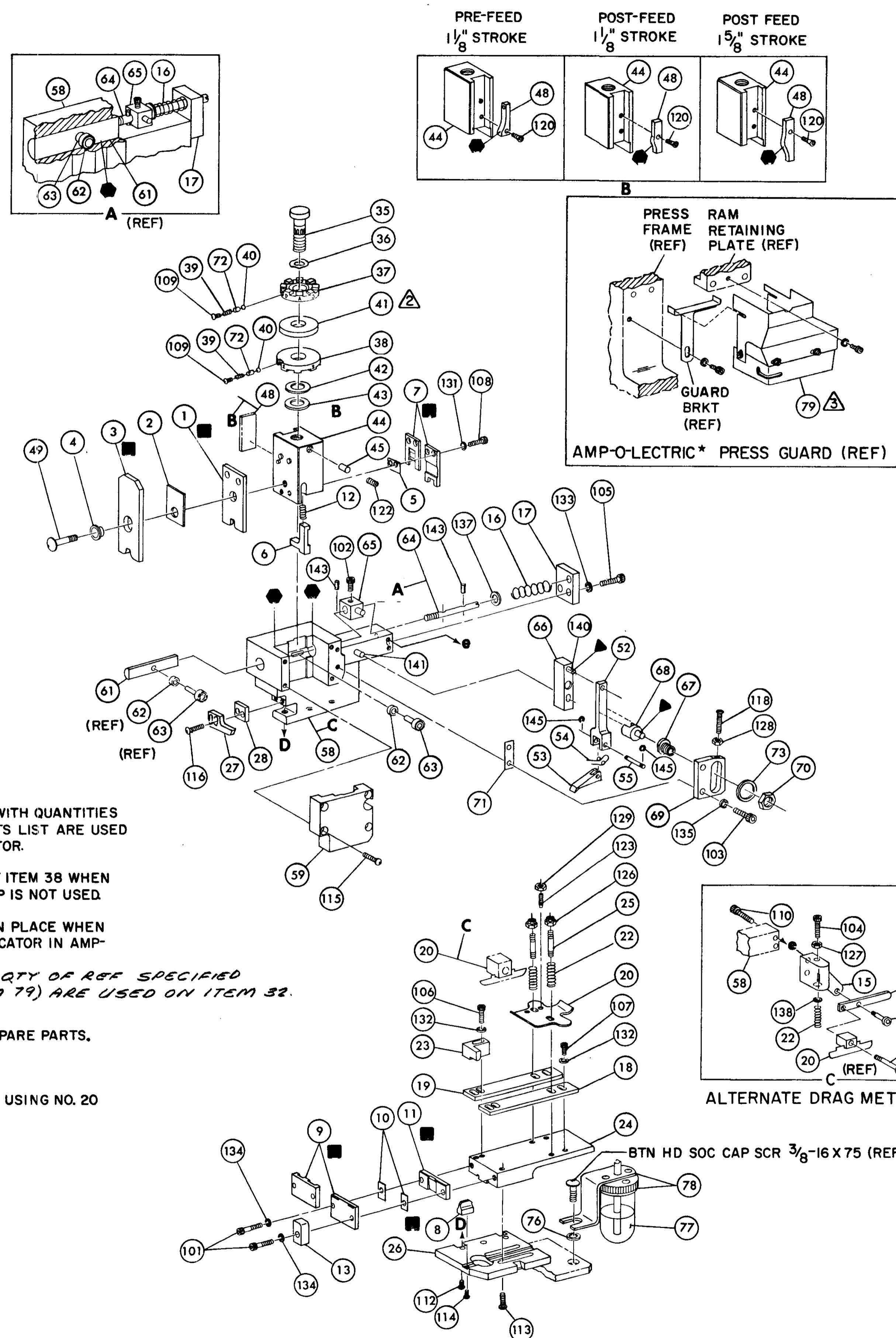

NOTES:

1. ONLY THE ITEMS WITH QUANTITIES SPECIFIED ON PARTS LIST ARE USED ON THIS APPLICATOR.

2. USED IN PLACE OF ITEM 38 WHEN INSULATION CRIMP IS NOT USED.

3. GUARD MUST BE IN PLACE WHEN OPERATING APPLICATOR IN AMP-O-LECTRIC PRESS.

4. PARTS WITH QTY OF REF SPECIFIED (EXCEPT ITEM 79) ARE USED ON ITEM 32.

KEY:

■ RECOMMENDED SPARE PARTS.

▲ LUBRICATE DAILY USING NO. 20 MACHINE OIL.

● GREASE LIGHTLY.

REF	QTY	PART NO	DESCRIPTION	ITEM NO	
REF	145	21045-3	RING, RETAINING 'C' (.187 DIA) FEED PIN	59	
REF	144	454220-1	CAP, RAM	58	
REF	143	5-21028-1	PIN, SLOT SPG (.12 DIA X .50) FD ADJ ROD	57	
REF	142	1-21030-7	PIN, DOWEL (.187 DIA X 1.50) HOUSING	56	
REF	141	240624-1	PIN, FEED FINGER	55	
REF	140	REF 091499-1	SPRING, FEED FINGER	54	
REF	139	REF 240635-1	FINGER, FEED	53	
REF	138	REF 240634-3	LEVER, TERMINAL	52	
REF	137	22260-5	WASHER, FLAT (NO 6) DRAG SPRING	51	
REF	136	21899-4	WASHER, FLAT (5/16 DIA) SCR ADJ	50	
REF	135	1	7-21002-9	BOLT, CRIMPER	49
REF	134	1	690602-5	CAM, PRE FEED 1 1/8 STROKE	48
REF	133	21024-5	WASHER, LOCK (NO 10) FEED ADJ PLATE	47	
REF	132	21024-5	WASHER, LOCK (NO 10) SHEAR PLATES	46	
REF	131	1	690191-1	PLUG, NYLON	45
REF	130	1	455674-1	RAM	44
REF	129	1	690125-1	WASHER, LAMINATED	43
REF	128	1	690124-1	WASHER, RAM	42
REF	127	21018-7	NUT, HEX MACH (10-32) DRAG SPRING	41	
REF	126	2	23241-6	SPACER, DISC	40
REF	125	2	690170-1	BALL, STEEL	39
REF	124	1	690142-1	SPRING, COMPRESSION	38
REF	123	1	3-690141-4	DISC, INSULATION	37
REF	122	1	22480-5	DISC, WIRE	36
REF	121	1	690212-1	WASHER, SPRING	35
REF	120	1	2-21003-0	POST, RAM	34
REF	119	2-21003-0	SCR, FLAT HD SKT CAP (6-32 X .50) CAM	33	
REF	118	1	458980-2	APPLICATOR, BASIC (SUB ASSY)	32
REF	117	2-21002-2	SCR, RD HD MACH (6-32 X 1.50) FEED ADJ	31	
REF	116	2-21002-2	SCR, BTN HD SKT CAP (8-32 X .50) STRIPPER	30	
REF	115	2-21002-9	SCR, BTN HD SKT CAP (10-32 X .75) HSG CAP	29	
REF	114	1	3-690451-2	SPACER, STRIPPER	28
REF	113	4	3-21002-3	SCR, BTN HD SKT CAP (1/4-20 X .50) STR GDE PL	27
REF	112	REF 1-24073-9	SCR, BTN HD SKT CAP (1/4-20 X .75) BASE PL	26	
REF	111	2	22354-8	PLATE, BASE	25
REF	110	1	455678-8	DRAG, STUD	24
REF	109	2	23030-1	PLATE, STRIP GUIDE	23
REF	108	2	2-21000-8	SCR, SKT HD CAP (8-32 X .25) (LOC-WEL) CP DISC	22
REF	107	3	2-21000-6	SCR, SKT HD CAP (8-32 X .62) SHEAR BLADE	21
REF	106	1	2-21000-6	SCR, SKT HD CAP (8-32 X .38) STRIP GUIDE	20
REF	105	1	3-21000-7	SCR, SKT HD CAP (10-32 X .75) FD ROD GUIDE	19
REF	104	1	3-21000-9	SCR, SKT HD CAP (10-32 X 1.00) DRAG SPRING	18
REF	103	REF 3-21000-6	SCR, SKT HD CAP (10-32 X .62) FD ADJ PLATE	17	
REF	102	REF 3-21000-4	SCR, SKT HD CAP (10-32 X .38) PIVOT BLK	16	
REF	101	REF 3-21000-8	SCR, SKT HD CAP (10-32 X .88) SHEAR PLATE	15	
REF	79	REF 455745-1	GUARD, WINDOW	14	
REF	78	1	465184-9	LUBRICATOR ASSY	13
REF	77	1	455985-1	OIL, LUBRICATING	12
REF	76	1	454406-1	SPACER, LUB BRACKET	11
REF	75	2	2-240645-3	SPACER, HOLD DOWN	10
REF	74	1	2-240645-7	SPACER, SHEAR PLATE	9
REF	73	1	7-240655-8	PLATE, REAR SHEAR	8
REF	72	1	3-240651-6	ANVIL	7
REF	71	1	2-455892-7	BLADE, SLUG	6
REF	70	1	2-240641-5	HOLD DOWN, TERMINAL	5
REF	69	1	238009-1	SPACER, SHEAR BLADE	4
REF	68	1	3-456135-8	SPACER, TUBULAR	3
REF	67	1	455888-4	CRIMPER, INSULATION	2
REF	66	1	1-456404-8	SPACER, INSULATION	1
REF	65	1	45680-1	CRIMPER, WIRE	
REF	64	1	240629-1	LEVER, INTERMEDIATE	
REF	63	1	240628-1	BLOCK, PIVOT	
REF	62	1	240632-2	SCREW, ADJ	
REF	61	1	240659-3	PIN, CAM ROLLER	
REF	60	1	240658-1	CAM, ROLLER	
REF	59	1	454398-1	ROD, FEED	

CRIMPING DATA				APPLICATOR WILL APPLY	
PAD LTR	CRIMP HEIGHT	WIRE SIZE	WIRE LENGTH		
A	.050	20			62074
B	.048	22			62344
C	.044	24			
D	NOT USED				

CRIMP	SIZE	TYPE	FEED	APPL INST
WIRE	.070	F		A18039
INSUL	.140	O*	.934	
WIRE RANGE	24-20			
INSULATION RANGE	.100-.103			
PRESS NO	565435-5			

REMARKS: AMP-O-LECTRIC PRE FEED
* INSUL. BBL. TO BE CRIMPED TO A .140 O.D. (INS. TO BE FREE INSIDE INSUL. BBL.)

REMARKS	NO	REV
APPL USED ON MACHINE PART NO	MACH SERIAL NO	DISTRIBUTION
CUSTOMER NAME	APPL SERIAL NO	ORIGINAL
ADDRESS	PURCHASE ORDER	CUSTOMER COPY
CITY	ENG APP	FIELD ENG COPY

P/F	LTR	REVISION RECORD	APP DATE	P/F	LTR	REVISION RECORD	APP DATE	P/F	LTR	REVISION RECORD	APP DATE



LOC A D NO 466182-2 REV F
MINIATURE QUICK CHANGE APPLICATOR.
END FEED (PIN RECPT.)