

METTRIC
 DIMENSIONS LISTED IN mm [INCHES]

AMP WIRE RANGE	IL E13288 Listed
22-16 AWG SOLID OR STRANDED	22-16 AWG SOLID OR STRANDED
LR7189 Certified	MILITARY P/N AND CLASS
22-16 AWG SOLID OR STRANDED	NOT APPLICABLE

△ STAMP AMP 22-18* APPROX AS SHOWN
 22-16 TERMINALS ARE STAMPED 22-18 IN
 ACCORDANCE WITH MILITARY SPECIFICATION
 MIL-T-7928, COMMERCIAL WIRE RANGE IS 22-16

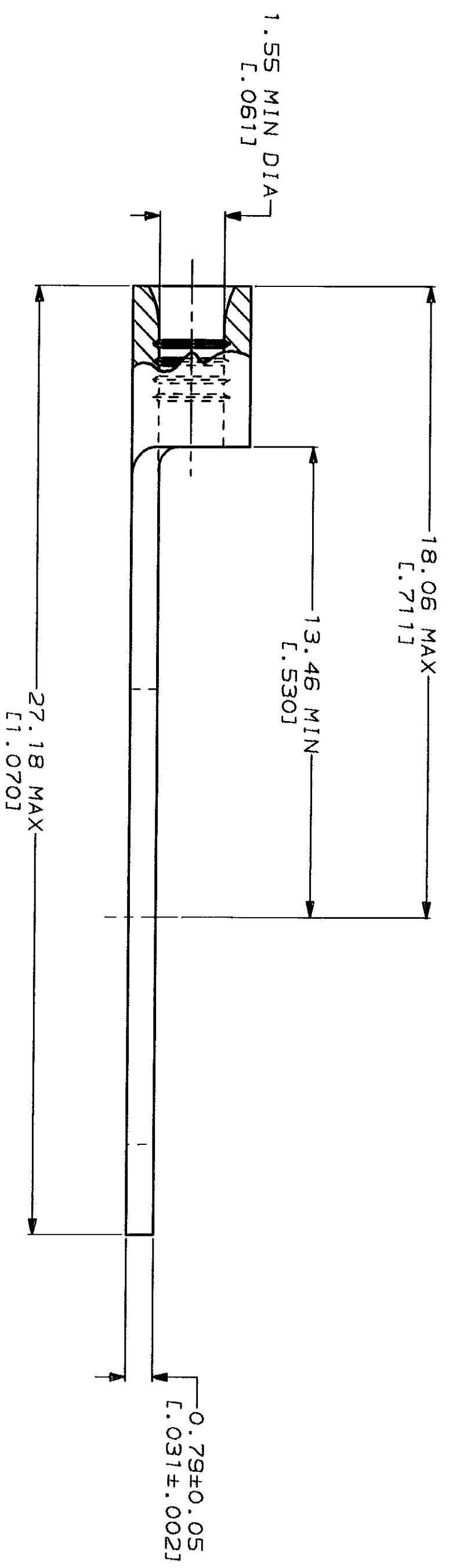

100	LOOSE PIECE, BOX	8-329966-1
---	LOOSE PIECE	329966
QUANTITY	PACKAGE TYPE	PART NO

**AMP INCORPORATED
 CUSTOMER SERVICE SYSTEMS**

FOR ADDITIONAL PRODUCT INFORMATION OR COPIES OF DRAWINGS AND TECHNICAL DOCUMENTS	PRODUCT INFORMATION CENTER 1-800-522-6752
FOR APPLICATION TOOLING INFORMATION	TOOLING ASSISTANCE CENTER 1-800-722-1111
FOR ORDER ENTRY	1-800-526-5142

MAX RECOMMENDED OPERATING TEMPERATURE:	170°C MAX
VOLTAGE RATING:	NOT APPLICABLE
WIRE CROSS SECTIONAL AREA RANGE:	0.26-1.65mm² [509-3,260] CIR MILS SOLID OR STRANDED

DO NOT SCALE PRINT. UNLESS SPECIFIED DIMENSIONS IN mm [INCHES] TOLERANCES ON: 2 PLC DEC ± - - 3 PLC DEC ± - - ANGLES ° - - MATERIAL COPPER PER ASTM B-152 ANNEALED

FINISH	TIN PLATE
THK PER MIL-T-10727	0.00254 [L.000100] MIN

DR 3-10-93	TA BRINKMAN
CHK 3-10-93	DA PATTERSON
APPD 3-10-93	DE MILLER
APPD 3-10-93	JL MECKLEY
PRODUCT SPEC	
APPLICATION SPEC	
WEIGHT	

AMP	AMP Incorporated Harrisburg, PA 17105-3608
NAME	TERMINAL, RING TONGUE, SOLISTRAND™
SIZE	CAGE CODE 00779
SCALE	8:1
DRAWING NO	329966
SHEET	1 OF 1