

# LR 4500

# instructions



**THE LABEL**  
**DISPENSER**  
BY START INTERNATIONAL

## **CONTENTS**

Read this user's manual before use to ensure proper operation. Keep the manual on hand for reference in case there is a problem.

About START International ....	2
Maintenance .....	3
Set-up .....	3
Features .....	3
Specifications .....	3
Notes .....	3
Legend .....	4
Exploded View .....	5
Repair Policy .....	6
Warranty Information .....	6

## **ABOUT START INTERNATIONAL**

START International has provided solutions for manufacturing companies worldwide since 1981. We provide the service and expertise that are required to ensure that our customers are fitted with the best equipment for the job. Our company is built on adding value to production lines and building relationships with our customers.

## MAINTENANCE

Turn machine off when not in use. Remove liner material from take-up hub at approximately 3" in diameter or if motor appears to be straining. Do not operate machine without covers in place.

Do not operate if inspection reveals a damaged power or sensor cord.

## SET-UP INSTRUCTIONS

Slide inner Guide Disc onto Take-up Hub.

Slide Core Adaptor onto Take-up Hub and secure to Hub using set screw.

Place an empty 3" label core onto the Core Adaptor. Adjust tension screw as needed to secure core onto Adaptor.

Slide outer Guide Disc onto Hub and up against the label core.

Feed the label web from the printer and tape the web to the label core.

Turn the Hub 1-2 turns to remove slack from web.

Turn power switch on to desired wind direction and set speed.

## FEATURES

- Bidirectional - Forward/Reverse
- Dual speed torque control
- Labels can be wrapped directly onto 1.5" hub
- Works with any printer
- No tools required for adjustment

## SPECIFICATIONS

<b>Model #</b>	<b>LR4500</b>
Liner Capacity Width	.25" to 4.5" (6mm to 114mm)
Roll Capacity	9" (251mm)
Feed Speed	Slow/Fast
Core	1.25" & 3" (32mm & 76mm)
Dimensions	11" (L) x 6" (W) x 9.2" (H) 27.9cm (L) x 15.2cm (W) x 23.4cm (H)
Electrical Requirements	12V DC with 90/240V adaptor

## NOTES

- Do not drop the rewinder or subject it to heavy shock.
- Turn off machine when not in use.

**LEGEND**

<b>Item #</b>	<b>Part #</b>
1	LR4500-03
1A	LR4500-03-1
2	LR4500-08
2A	LR4500-08-1
3	LR4500-06
3A	LD50017-1
4	LR4500-02
4A	LR4500-02-1
5	LR4500-07
6	LR4500-04
6A	LD50012-1
7	LR4500-05
7A	LR4500-05-2
7B	LR4500-05-1
8	LR4500-01
8A	LD50024
9	LR4500-10
10	LR4500-09
11	LD2000-19
Power Supply	LD2000-20A
Power Cord	LD50018C

# EXPLODED VIEW

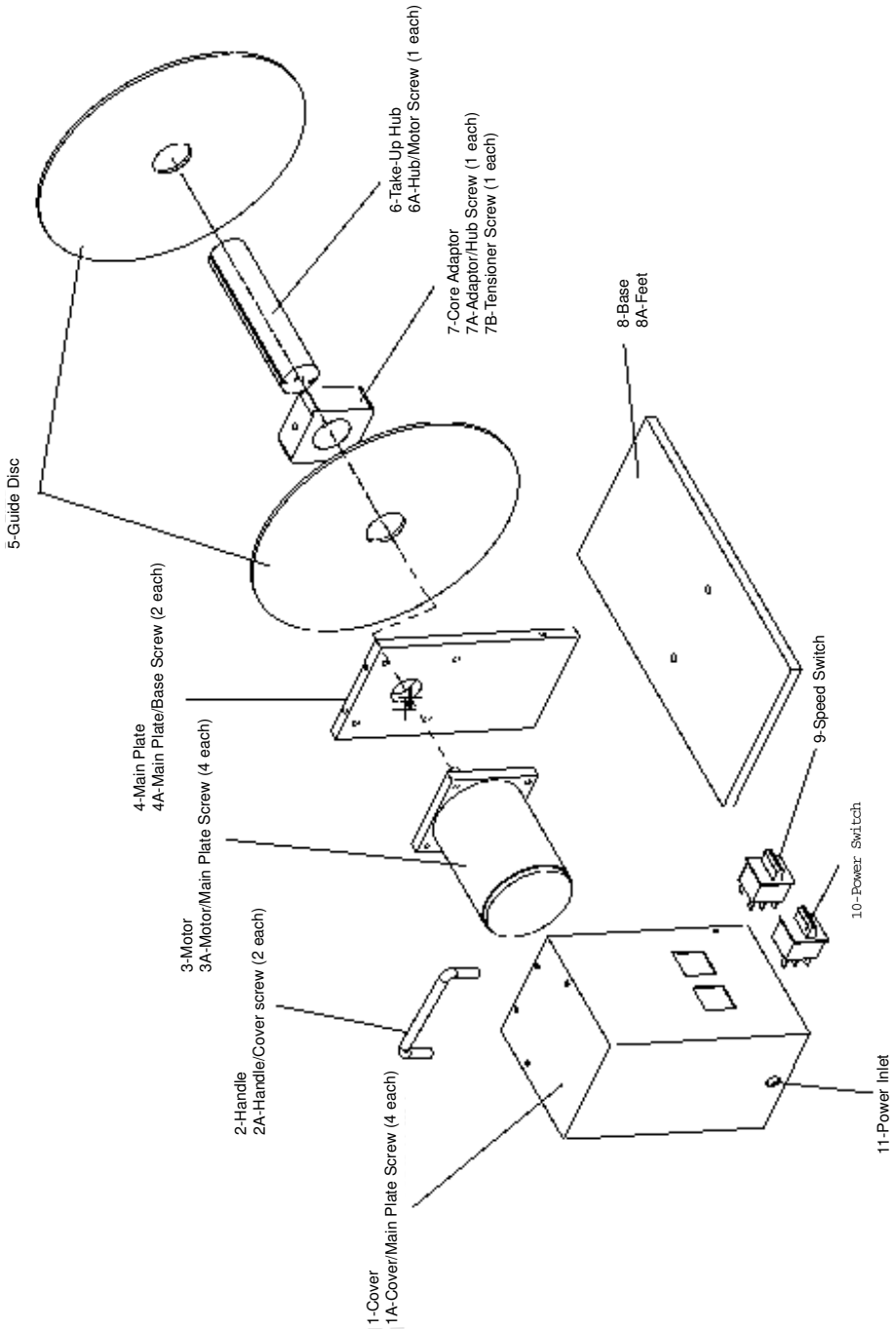

## **REPAIR POLICY**

Contact START INTERNATIONAL to determine nature of problem.

Furnish START with the following information:

1. Who the unit was purchased from.
2. Model number and serial number.
3. Date purchased (copy of invoice or packing slip required).

START will issue an RGA (Return Goods Authorization) for repair.

Return machine to START by UPS, insured and prepaid.

START will notify the customer if there is a repair charge.

## **WARRANTY POLICY FOR LR SERIES LABEL REWINDER**

START International warrants all parts on LR series label dispensers against defects in design, materials and workmanship for a period of 360 days. Labor to replace defective parts will be performed at no charge for the first 120 days after date of purchase. Warranty does not cover transportation costs.

Our sole obligation under this warranty is limited to repair, replacement or credit of the purchase price, at our option, for the machines listed above, which do not perform properly the function for which they were designed.

Warranty repair is contingent upon our examination and determination that alleged defects have not been caused by misuse, abuse, improper installation or application, repair, alteration, accident or neglect in use, storage, transportation or handling.

The above warranty and remedy constitutes Start International's sole liability hereunder and are in lieu and exclusive of all other warranties and remedies expressed, implied, or statutory, including, but not limited to, those of merchantability and fitness for a particular purpose.



4270 Airborn Drive  
Addison, TX 75001, U.S.A.

Tel 972.248.1999

Fax 972.248.1991

[info@STARTinternational.com](mailto:info@STARTinternational.com)

[www.STARTinternational.com](http://www.STARTinternational.com)