

90° PC PHONO JACK

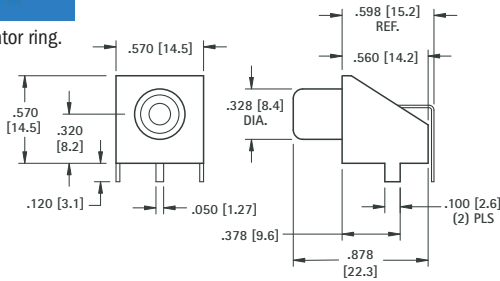

Complete one piece jack for insertion into PC board.
Time Saving. No Wiring Required.

- Black insulator ring.



MATERIAL:

Base: Steel, Tin Plate
Shell: Steel, Nickel Plate
Contact: Brass, Tin Plate

CAT. NO. 902

Mounting Detail

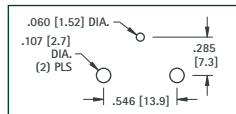

SNAP-FIT 90° PC PHONO JACKS



CHOICE OF TIN OR GOLD PLATE

Complete one piece jack for insertion into PC board.
Time Saving. No Wiring Required.
Snap-fits into PC board.

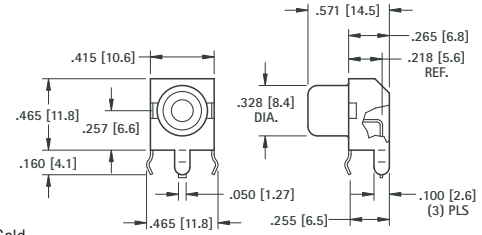

MATERIAL:

Shell: Steel
Contact: Brass
Plating: Tin or Gold

TIN PLATE CAT. NO.	INSULATOR COLOR	GOLD PLATE CAT. NO.
587	WHITE	936
588	RED	937
901	BLACK	900
589	YELLOW	938

Mounting Detail

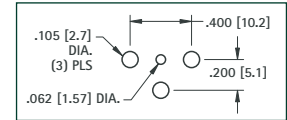

SNAP-FIT VERTICAL PC JACK

- Snaps into holes on PC board and firmly held for soldering
- No staking required



- Red insulator ring

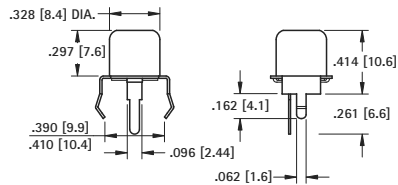

MATERIAL:

Shell: Steel, Tin Plate
Contact: Brass, Tin Plate

CAT. NO. 572

Mounting Detail

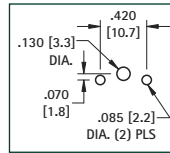

SNAP-FIT VERTICAL PC PHONO JACKS

- Extra long, one piece shell to accept plugs with longer pins for greater contact
- Snaps into holes on PC board and firmly held for soldering
- No staking required

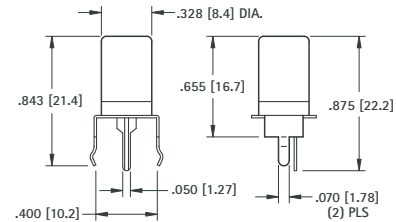

CAT. NO.	INSULATOR COLOR
584	WHITE
577	RED
585	BLACK
586	YELLOW

MATERIAL:

Shell: Steel, Nickel Plate
Contact: Brass, Tin Plate

Mounting Detail

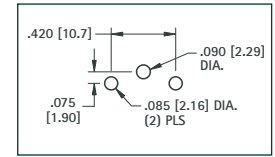

PC PHONO JACKS

VERTICAL

- For applications requiring staking to product



- White insulator ring

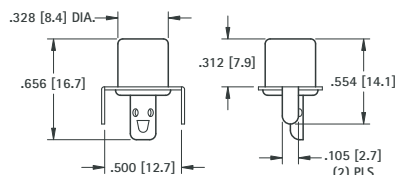

MATERIAL:

Shell: Steel, Tin Plate
Contact: Brass, Tin Plate

CAT. NO. 573

Mounting Detail

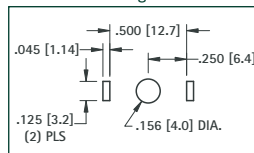

HORIZONTAL

- Mounted on bracket ready for insertion into pre-drilled holes
- Solder lug allows remote attachment of signal to PC board



- Red insulator ring

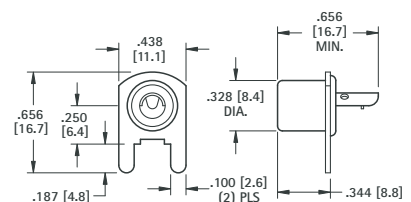

MATERIAL:

Shell: Steel, Tin Plate
Contact: Brass, Tin Plate

CAT. NO. 571

Mounting Detail

