

FRONT VIEW

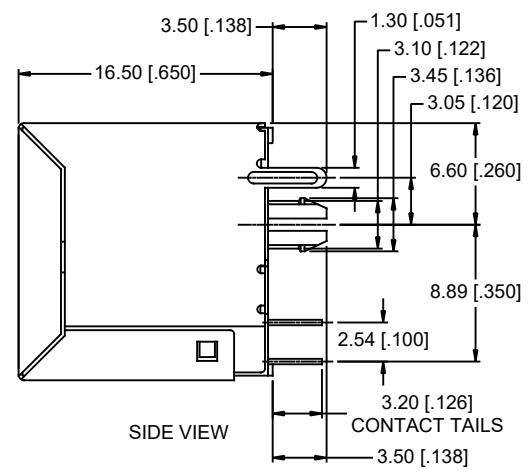

SIDE VIEW

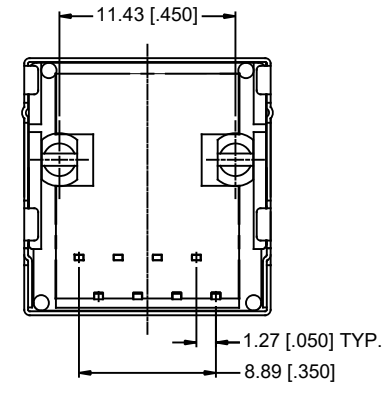

BACK VIEW

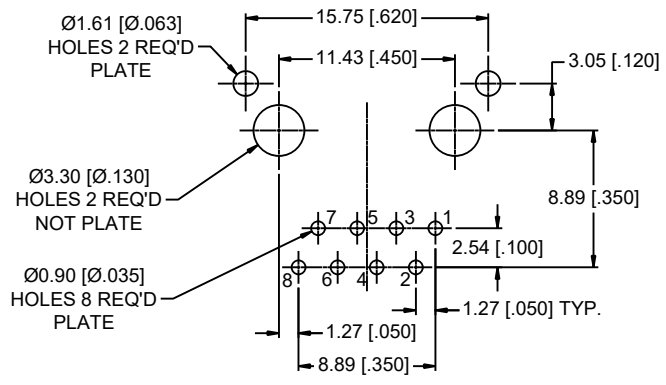

RECOMMENDED P.C.B LAYOUT
(TOLERANCE: $\pm 0.05[\pm 0.002]$)
(PCB THICKNESS: 1.60 [0.063])
(COMPONENT SIDE OF PC BOARD)

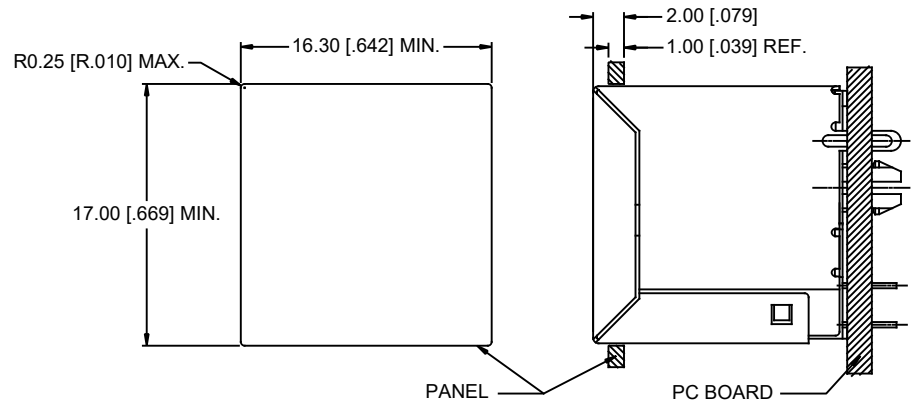

RECOMMENDED PANEL CUTOUT

NOTES:

1. MATERIALS:
CONTACTS: PHOSPHOR BRONZE, 0.35MM THICKNESS,
PLATING: GOLD FLASH PLATING ON MATING SURFACES
30 μ [0.762 MICRONS] MIN. NICKEL OVERALL.
80 μ [2.032 MICRONS] MIN. MATTE TIN ON SOLDER TAILS.
HOUSING: ENGINEERING THERMOPLASTIC, FLAMMABILITY RATING UL 94V-0
COLOR - BLACK.
SHIELD: BRASS WITH NICKEL PLATING
 2. MECHANICAL:
MATING FORCE: 5.0 LBS MAXIMUM
 3. ELECTRICAL:
CONTACT RESISTANCE: 20 MILLIOHMS MAXIMUM
INSULATION RESISTANCE: 500 MEGOHMS MINIMUM
CURRENT RATING: 1.5 AMPS
VOLTAGE RATING: 125 VOLTS AC
 4. ENVIRONMENTAL:
STORAGE TEMPERATURE: -40°C TO +85°C
 5. RECOMMENDED SOLDERING TEMPERATURE:
WAVE SOLDERING PEAKED AT 235°C FOR 5 SECONDS.
- AMPHENOL PART NUMBER: RJE74-188-6010

REVISIONS			
REV	DESCRIPTION, ECN, EAR NO.	DATE	APP'D
A	NEW PROPOSAL	JUL19/22	KELVIN

UNLESS SPECIFIED OTHERWISE	DRAWN	RONNIE.C	JUL19/22
PRIMARY UNITS MILLIMETERS	CHECKED	KELVIN.T	JUL19/22
SECONDARY INCHES	M.E. APP'D		
REFERENCE IN PARENTHESES	Q.A. APP'D		
GENERAL TOLERANCES	DWG APP'D		
1 DECIMAL PLACE ± 0.35	ENG. REL. NO.		
2 DECIMAL PLACES ± 0.25	REF.		
3 DECIMAL PLACES ± 0.15			
ANGULAR DEGREES $\pm 2.0^\circ$	THIRD ANGLE PROJECTION		

Amphenol Canada Corp. Commercial Products	
SINGLE PORT, VERTICAL MODULAR JACK, 8 POSITION, 8 CONTACTS, SHIELDED -RoHS COMPLIANT	
DWG NO.	P-RJE74-188-6010
REV	A
CODE ID NO. 03554	DWG SIZE X SCALE N/A SHEET 1 OF 1

THIS DOCUMENT CONTAINS PROPRIETARY INFORMATION AND SUCH INFORMATION MAY NOT BE DISCLOSED TO OTHERS FOR ANY PURPOSE OR USED FOR MANUFACTURING PURPOSES WITHOUT WRITTEN PERMISSION FROM AMPHENOL CANADA CORP.