



ANATECH ELECTRONICS INC
RF & Microwave Filters & Products

**380-385 MHz / 390-395 MHz
Cavity Duplexer
Part Number: AD382-392D370**



<u>Characteristics</u>	<u>Band 1</u>	<u>Band 2</u>
Passband:	380-385 MHz	390-395 MHz
Bandwidth:	5 MHz	5 MHz
Passband Return Loss:	20 dB	20 dB
Passband Insertion Loss:	1.1 dB	1.1 dB
Passband Ripple:	0.2 dB	0.2 dB
Input / Output Impedance:	50 Ohms	50 Ohms
Isolation:	70 dB	70 dB
Power Handling:	50 Watts	50 Watts

<u>Mechanical</u>	
Mounting Method:	Threaded Mounting Holes
Connector Type:	N-Type (F)
Dimensions:	6.70 x 8.33 x 4 Inches

<u>Environmental</u>	
Operating Temperature:	-40 to +70 deg.C
Storage Temperature:	-50 to +90 deg.C

Outline Drawing:

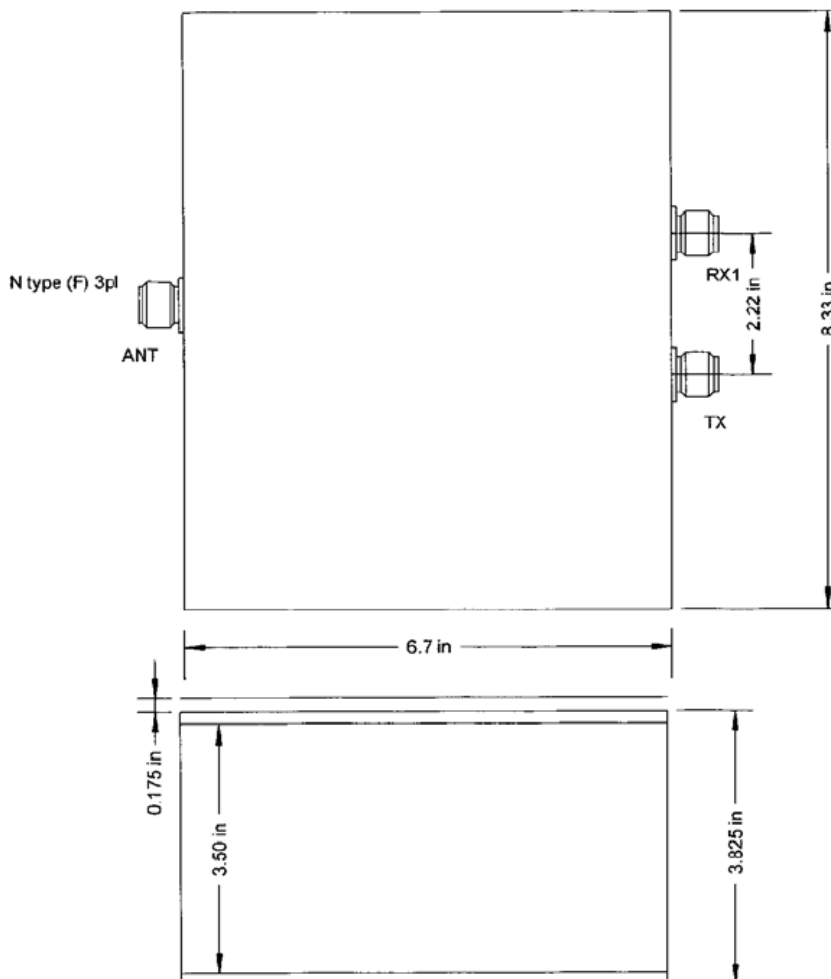



ANATECH ELECTRONICS INC
RF & Microwave Filters & Products

380-385 MHz / 390-395 MHz
Cavity Duplexer
Part Number: AD382-392D370



Response Plot:

