

THIS IS A CONTROLLED DOCUMENT.

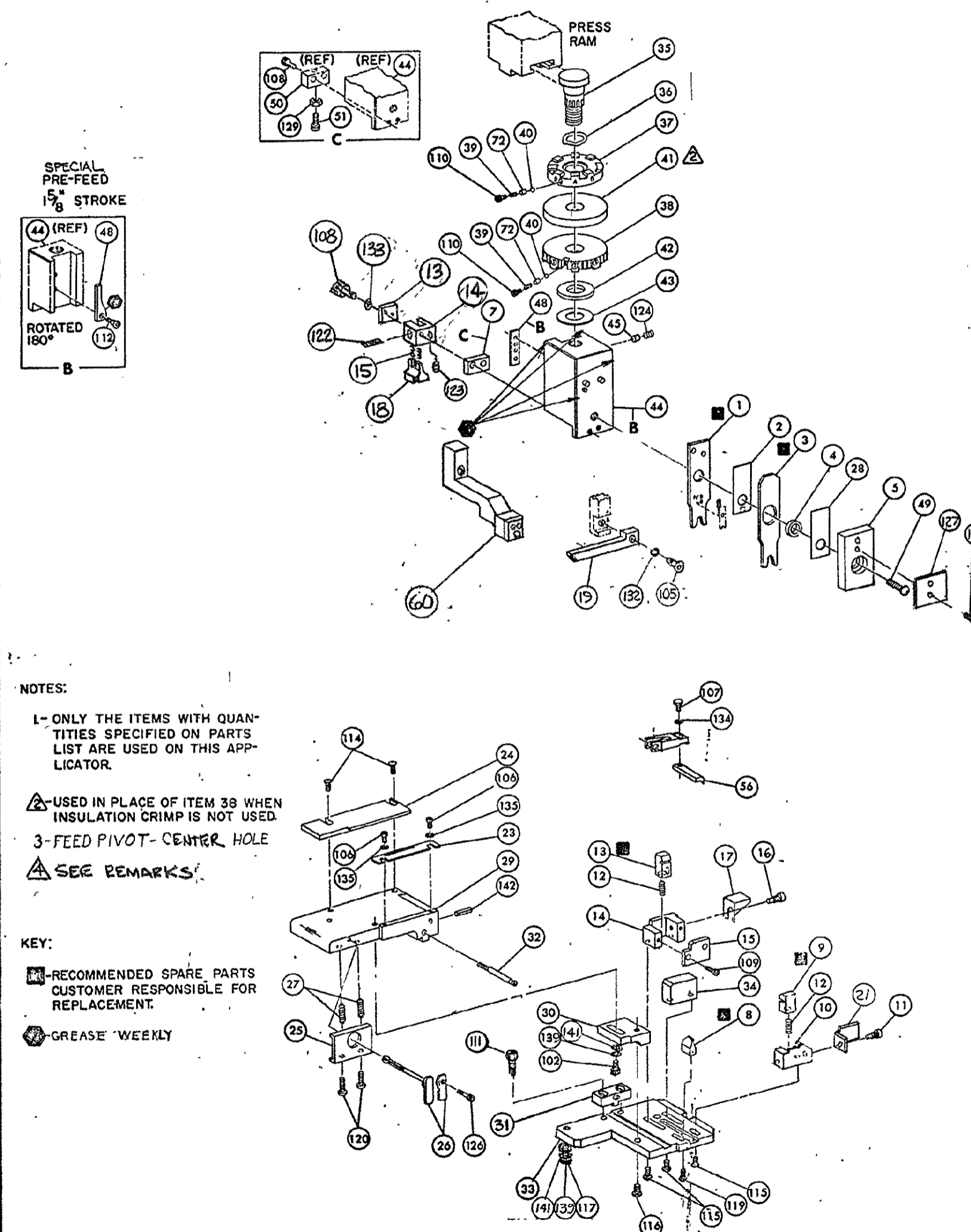

NOTES:

L- ONLY THE ITEMS WITH QUANTITIES SPECIFIED ON PARTS LIST ARE USED ON THIS APPLICATOR.

▲-USED IN PLACE OF ITEM 38 WHEN INSULATION CRIMP IS NOT USED.

3-FEED PIVOT-CENTER HOLE

▲ SEE REMARKS

KEY:

■-RECOMMENDED SPARE PARTS CUSTOMER RESPONSIBLE FOR REPLACEMENT.

●-GREASE WEEKLY

QTY	PART NO	DESCRIPTION	ITEM NO	REF	QTY	PART NO	DESCRIPTION	ITEM NO
1	4-21028-0	PIN, SLOT SPR (.093 DIA X .75) STR G PLATE	142	REF	694433-2	PAWL FEED	56	
2	21899-2	WASHER, FLAT (NO 12) MOUNTING	141				55	
1	21899-2	WASHER, FLAT (NO 10) S-G ADJ BLOCK	140				54	
2	21024-5	WASHER, LOCK (NO 10) MOUNTING	139				53	
1	21024-5	WASHER, LOCK (NO 10) STRIP GUIDE ADJ-BLOCK	138				52	
			137				51	
			136		7-21002-9	BUMPER, HOLDDOWN	50	
2	21024-2	WASHER, LOCK (NO 4) FRONT STRIP GUIDE	135	1	7-21002-9	SPACER, TONKER	49	
REF	21024-4	WASHER, LOCK (NO 8) FEED FINGER	134	1	690602-6	BOLT, CRIMPER (BUT. HD. 5/16-24 UNF X 1.00)	48	
2	21024-4	WASHER, LOCK (NO 8) DEPRESSOR	133				47	
REF	21024-4	WASHER, LOCK (NO 8) STRIPPER	132				46	
			131		690191-1	PLUG, NYLON	45	
			130		455673-1	RAM	44	
	21068-5	NUT, HEX MACH (6-32) HOLDDOWN	129		690125-1	WASHER, LAMINATED	43	
2	21017-2	SCR, DRIVE (#2 X .188 LG)	128	1	690124-1	WASHER, RAM	42	
1	219347-1	PLATE, I.D.	127				41	
	22353-8	SCR, SHLD. (187 DIA X .250 LG) DRAG LEVER	126				40	
			125		23241-6	BALL, STEEL	39	
1	21009-2	SCR, SKT SET (1/4-20 X .25) (LOC-WEL) RAM	124	1	690170-1	SPRING, COMPRESSION	38	
1	2-21008-1	SCR, SKT SET (4-40 X .25) (LOC-WEL) HOLD DOWN	123	1	690142-1	DISC, INSULATION	37	
1	4-21028-0	PIN, SLOT SPR (.094 X .75)	122	1	1-690692-2	DISC, WIRE	36	
			121		22480-5	WASHER, SPRING	35	
2	3-21002-0	SCR, BUT HD SKT CAP (10-32 X .88) DRAG	120	1	690212-1	POST, RAM	34	
1	22733-8	SCR, BUT HD SKT CAP (8-32 X .38) (LOC-WEL) ANVIL	119	1	692776-4	SUPPORT, TERMINAL	33	
			118		462544-1	PLATE, BASE SPECIAL	32	
1	3-21000-9	SCR, SOG HD SKT CAP (10-32 X 1.00) MOUNTING	117	1	690432-3	SCREW, ADJUSTMENT	31	
1	2-22733-1	SCR, BUT HD SKT CAP (10-32 X .50) SG ADJ BLOCK	116	1	462543-1	BLOCK, SCREW SPECIAL	30	
4	2-21002-2	SCR, BUT HD SKT CAP (8-32 X .50) SHEAR	115	1	455689-1	BLOCK, STRIP GUIDE ADJ	29	
2	2-21002-2	SCR, BUT HD SKT CAP (8-32 X .50) R STRIP GUIDE	114	1	455671-4	PLATE, STRIP GUIDE	28	
			113		1-455688-0	SPACER, FRONT SHEAR DEPRESSOR	27	
1	1-21002-7	SCR, BUT HD SKT CAP (6-32 X .50) CAM	112	1	1-22284-0	SPRING, DRAG	26	
2	2-21000-7	SCR, SKT HD CAP (8-32 X .50) SCR BLOCK	111	1	690546-1	LEVER, DRAG RELEASE	25	
2	23030-1	SCR, SKT HD CAP (6-32 X .25) (LOC-WEL) CP DISC	110	1	240792-5	DRAG, STOCK	24	
			109		6-690504-8	GUIDE STRIP (REAR)	23	
2	5-21006-6	SCR, SET HD CAP (8-32 X .15) DEPRESSOR (REAR)	108	1	690438-1	GUIDE, STRIP (FRONT)	22	
REF	2-21002-1	SCR, BUT HD MACH (8-32 X .38) FEED FINGER	107	1	463756-1	GUIDE, SCRAP	21	
2	1-21000-3	SCR, SKT HD CAP (4-40 X .25) F STRIP GUIDE	106				20	
REF	2-21002-1	SCR, BUT HD CAP (8-32 X .38) STRIPPER	105	REF	462615-1	STRIPPER	19	
			104	1	459551-1	HOLDER, TERMINAL	18	
			103				17	
1	3-22603-1	SCR, HEX HD CAP (10-32 X .38) SG ADJ BLOCK	102				16	
			101				15	
			79		3-22278-0	SPRING, HOLD DOWN	14	
			78		455052-1	HOLDER, DEPRESSOR	13	
2	463310-5	BLADE STRIPPING (#20)	77		455053-1	PLATE, RETAINING	12	
			76		3-22280-3	SPRING, SHEAR	11	
			75		690461-2	STOP, SHEAR (FRONT)	10	
			74		462548-1	HOLDER, SHEAR (FRONT) SPECIAL	9	
			73		462547-1	SHEAR, FLOAT (FRONT) SPECIAL	8	
2	690603-1	SPRING, ASSIST	72	1	3-690471-0	ANVIL	7	
			71		4-240641-2	SPACER, DEPRESSOR (REAR)	6	
			70			DEPRESSOR, SHEAR (REAR)	5	
			69		462838-1	DEPRESSOR, SHEAR (FRONT) SPECIAL	4	
			68		2-238011-2	SPACER, TUBULAR, INS CRIMPER	3	
			67		4-456134-8	CRIMPER, INSULATION	2	
			66		455088-5	SPACER, CRIMPER	1	
			65		3-456404-1	CRIMPER, WIRE	1	

QTY	PART NO	DESCRIPTION	ITEM NO
REF	816472-1	STOP WIRE	60

REMARKS	NO	REV
APPL USED ON MACHINE PART NO	MACH SERIAL NO	DISTRIBUTION
CUSTOMER NAME	APPL SERIAL NO	ORIGINAL
ADDRESS	PURCHASE ORDER	CUSTOMER COPY
CITY	ENG APP	FIELD ENG COPY

VISIBLE	CRIMPING DATA	APPLICATOR WILL APPLY
PAD LTR	CRIMP HEIGHT	WIRE SIZE
63		
62		
61	A .040	22
60	B .038	24
	C .048	18 A
	D .043	20

CRIMP	SIZE	TYPE	FEED	APPL INST
WIRE	070	F	330	A1
INSUL	1100	F	356	

WIRE RANGE 24-18 INSULATION RANGE .090 MAX PRESS NO 463345-1

REV 7-10

REV 10-10-63

REV 11-10-63

REV 12-10-63

REV 1-10-64

REV 2-10-64

REV 3-10-64

REV 4-10-64

REV 5-10-64

REV 6-10-64

REV 7-10-64

REV 8-10-64

REV 9-10-64

REV 10-10-64

REV 11-10-64

REV 12-10-64

REV 1-10-65

REV 2-10-65

REV 3-10-65

REV 4-10-65

REV 5-10-65

REV 6-10-65

REV 7-10-65

REV 8-10-65

REV 9-10-65

REV 10-10-65

REV 11-10-65

REV 12-10-65

REV 1-10-66

REV 2-10-66

REV 3-10-66

REV 4-10-66

REV 5-10-66

REV 6-10-66

REV 7-10-66

REV 8-10-66

REV 9-10-66

REV 10-10-66

REV 11-10-66

REV 12-10-66

REV 1-10-67

REV 2-10-67

REV 3-10-67

REV 4-10-67

REV 5-10-67

REV 6-10-67

REV 7-10-67

REV 8-10-67

REV 9-10-67

REV 10-10-67

REV 11-10-67

REV 12-10-67

REV 1-10-68

REV 2-10-68

REV 3-10-68

REV 4-10-68

REV 5-10-68

REV 6-10-68

REV 7-10-68

REV 8-10-68

REV 9-10-68

REV 10-10-68

REV 11-10-68

REV 12-10-68

REV 1-10-69

REV 2-10-69

REV 3-10-69

REV 4-10-69

REV 5-10-69

REV 6-10-69

REV 7-10-69

REV 8-10-69

REV 9-10-69

REV 10-10-69

REV 11-10-69

REV 12-10-69

REV 1-10-70

REV 2-10-70

REV 3-10-70

REV 4-10-70

REV 5-10-70

REV 6-10-70

REV 7-10-70

REV 8-10-70

REV 9-10-70

REV 10-10-70

REV 11-10-70

REV 12-10-70

466917-1