

|     |            |     |          |
|-----|------------|-----|----------|
| REV | ECN.NO:    | B Y | DATE     |
| •   | •••••••••• | ••• | •••••••• |

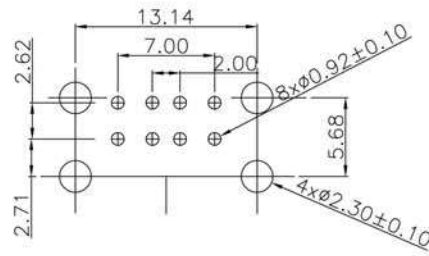
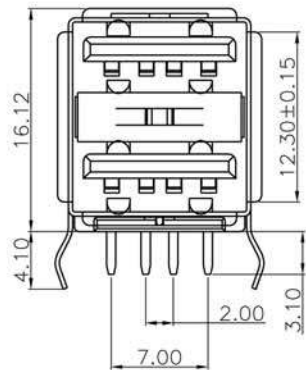
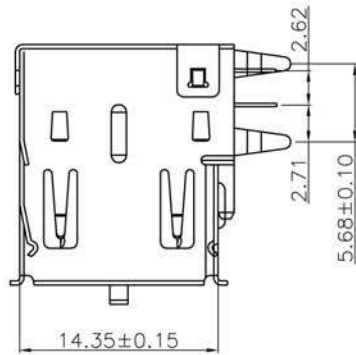
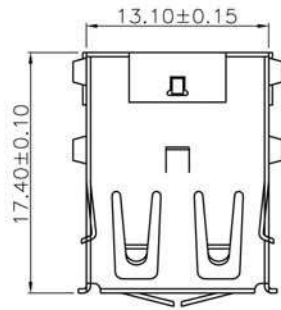

RECOMMENDED P.C.B. PATTERN LAYOUT

MATERIAL  
 INSULATOR:PBT+30%G.F  
 COLOR:BLACK/WHITE/BROWN/BEIGE-----  
 CONTACT:BRASS  
 SHELL:BRASS  
 MECHANICAL  
 MATING:35N MAX.  
 WITHDRAWAL FORCE:10N MIN.  
 DURAL LITY:1500 CYCLES MIN.  
 ELECTRICAL  
 CURENT-MAX[AMPS]:1.0A  
 VOLTAGE-MAX[VOLTS]:30V  
 WITHSTANDING VOLTAGE:100V AC.  
 CONTACT RESISTANCE [OHMS]:50mΩ MAX.  
 INSULATION RESISTANCE [OHMS]:1000MΩ MIN.  
 PLATING  
 CONTACT: GOLD PLATING CORD: 5u"  
 SHELL:Nickel(Tin) OVER ALL PLATING  
 ENVIRONMENTAL  
 TEMPERATURE RANGE:-55°C to +85°C

RoHS  
Compliant

|  |              |                                     |  |                                  |       |      |      |      |
|--|--------------|-------------------------------------|--|----------------------------------|-------|------|------|------|
| -TOLERANCES-<br>UNLESS OTHERWISE SPECIFIED |              | <b>ASSMANN</b><br>Electronics, Inc. |  |                                  |       |      |      |      |
|  |              |                                     |  | TITLE: USB, VERSION A,<br>2-PORT |       |      |      |      |
| X.X ±0.30                                  | X.X" ±3"     | APPD:                               |  | PRODUCT NO: AU-Y1008-R           |       |      |      |      |
| X.XX ±0.15                                 | X.XX" ±1"    | CHECK:                              |  | DATE                             | SCALE | UNIT | TYPE | PAGE |
| X.XXX ±0.10                                | X.XXX" ±0.5" | DRAW:                               |  |                                  | FREE  | MM   |      |      |