

Connector assembly frame - HC-SMP 125-B 6-AML - 1660957

Please be informed that the data shown in this PDF Document is generated from our Online Catalog. Please find the complete data in the user's documentation. Our General Terms of Use for Downloads are valid (<http://download.phoenixcontact.com>)



HEAVYCON connector assembly frame with panel mounting base with single locking latch, for contact inserts of type B6



Key commercial data

| | |
|--------------------------------------|--|
| Packing unit | 1 1 |
| GTIN |  4 017918 022365 |
| Weight per Piece (excluding packing) | 184.05 GRM |
| Custom tariff number | 85389099 |
| Country of origin | Germany |

Technical data

Dimensions

| | |
|---------------------------------|--------|
| Length | 125 mm |
| Height | 52 mm |
| Hole diameter | 4.5 mm |
| Drill hole distance, horizontal | 104 mm |
| Drill hole distance, vertical | 32 mm |

General

| | |
|---|---------------------------------------|
| Note | For contact inserts B6, BB10 and DD24 |
| Material | PA |
| Inflammability class according to UL 94 | HB |
| Design | B6 |

Connector assembly frame - HC-SMP 125-B 6-AML - 1660957

Classifications

eCl@ss

| | |
|------------|----------|
| eCl@ss 4.0 | 27140816 |
| eCl@ss 4.1 | 27140816 |
| eCl@ss 5.0 | 27143424 |
| eCl@ss 5.1 | 27143424 |
| eCl@ss 6.0 | 27143424 |
| eCl@ss 7.0 | 27440209 |
| eCl@ss 8.0 | 27440209 |

ETIM

| | |
|----------|----------|
| ETIM 3.0 | EC002310 |
| ETIM 4.0 | EC002310 |
| ETIM 5.0 | EC002310 |

UNSPSC

| | |
|---------------|----------|
| UNSPSC 6.01 | 43172601 |
| UNSPSC 7.0901 | 39121416 |
| UNSPSC 11 | 43172601 |
| UNSPSC 12.01 | 39121408 |
| UNSPSC 13.2 | 39121408 |

Approvals

Approvals

Approvals

GOST

Ex Approvals

Approvals submitted

Approval details

| |
|--|
| GOST  |
|--|

Connector assembly frame - HC-SMP 125-B 6-AML - 1660957

Drawings

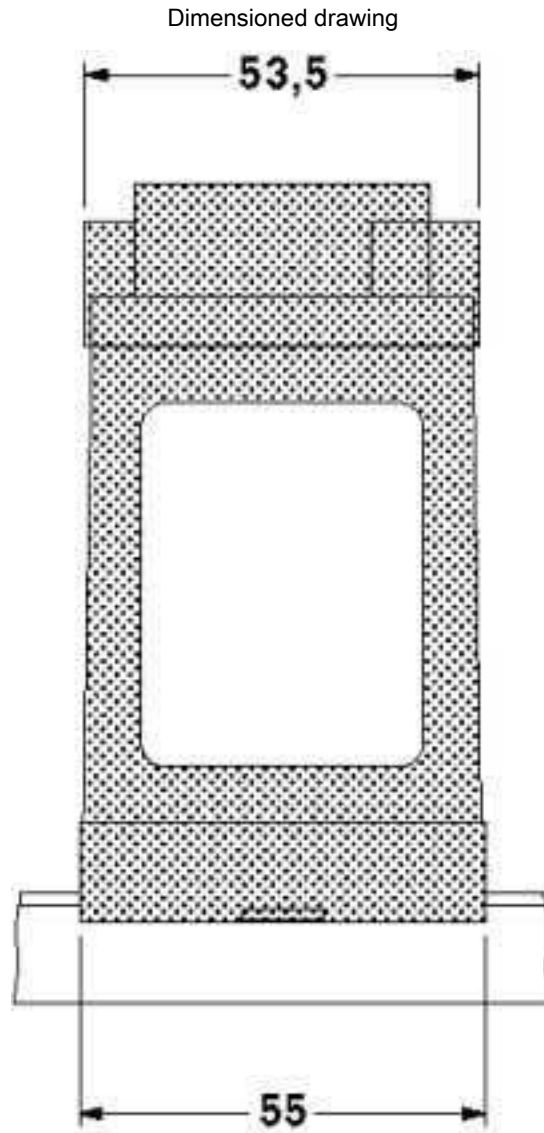

Connector assembly frame - HC-SMP 125-B 6-AML - 1660957

Dimensioned drawing

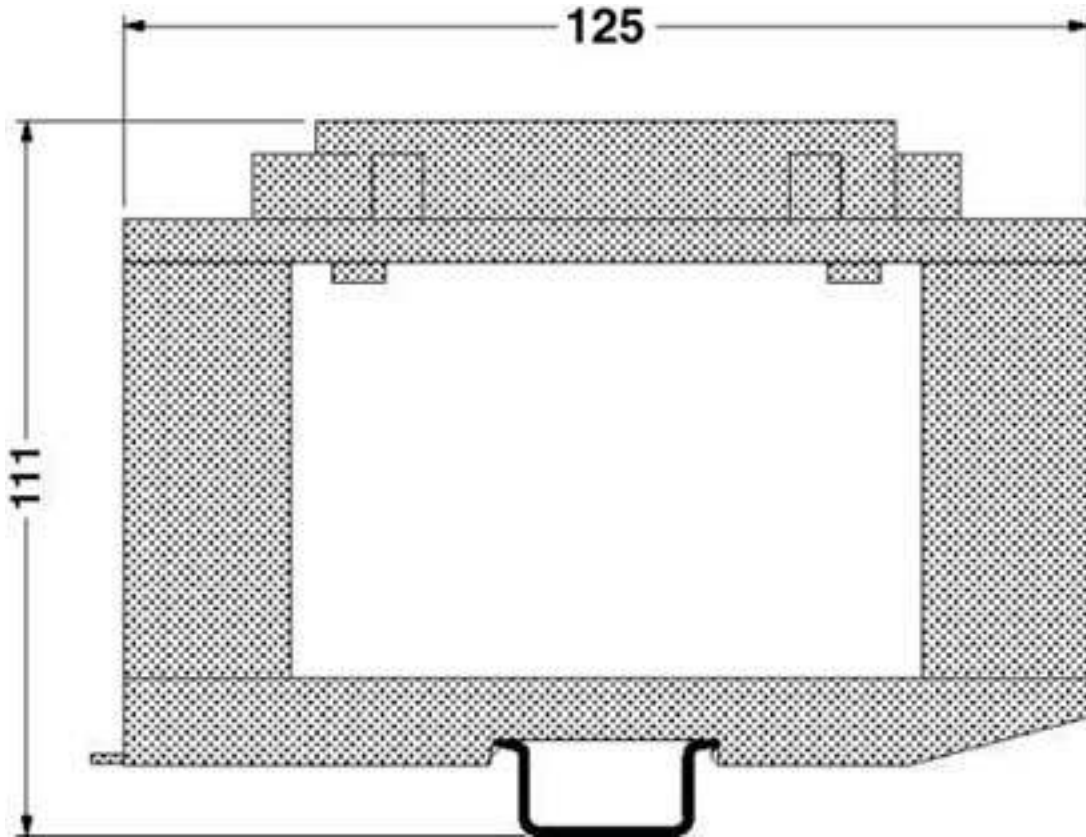

Connector assembly frame - HC-SMP 125-B 6-AML - 1660957

Dimensioned drawing

