

Product number
SEE TABLE, SHT 4

A
B
C
D
E
F

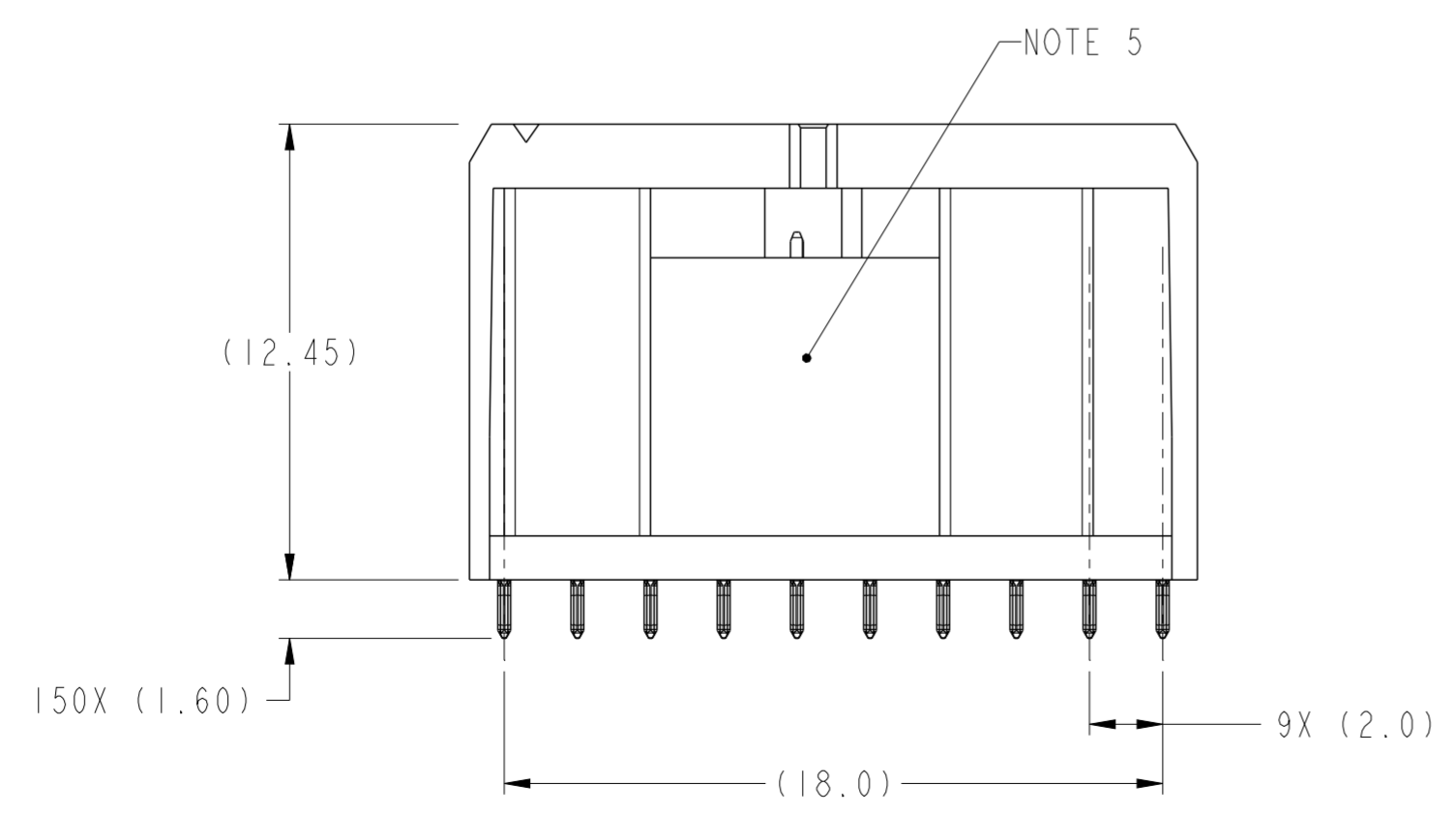
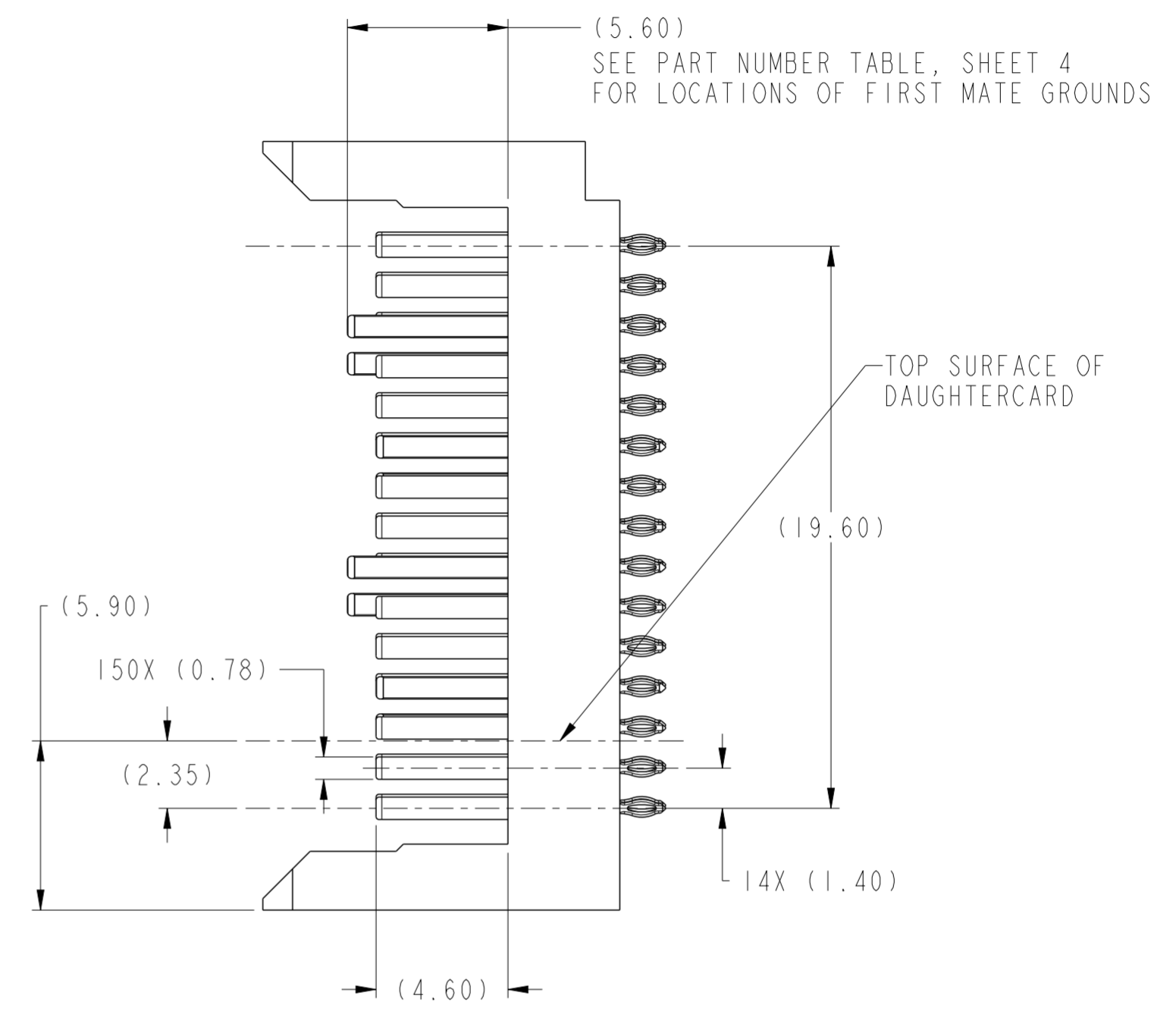
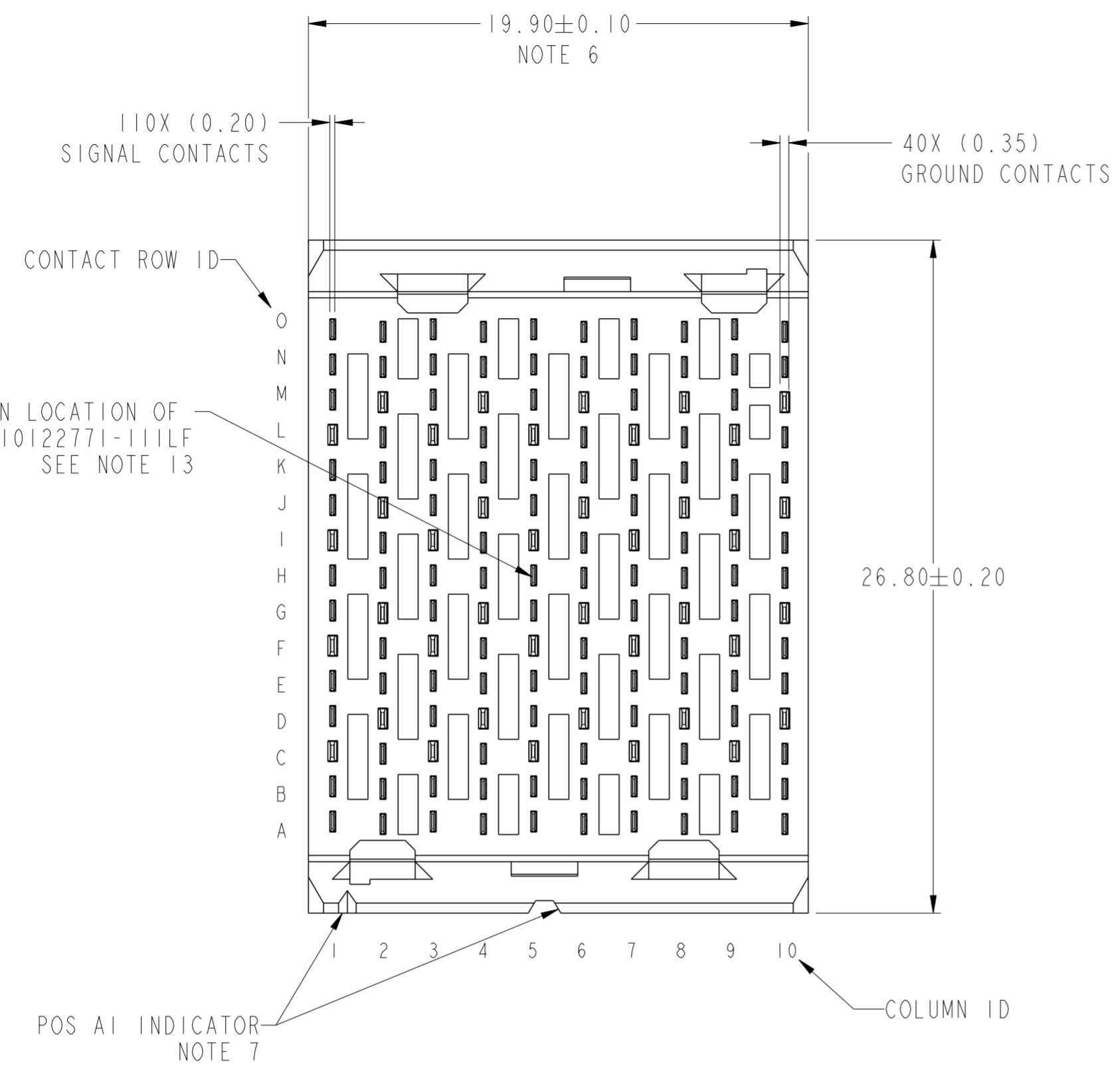

spec ref	-	dr	Sandar Soe	2012/09/13	projection	MM	size	A2	scale	5:1
tolerance std	ASME Y14.5	eng	Terry Luo	2020/09/07	chr	-	ecn no	ELX-DG-38252-1	rel level	Released
surface	-	appr	Heaven Cen	2020/09/17	product family	AIRMAX VS	cat. no.	10122771	rev	E
ASME Y14.5	TOLERANCES UNLESS OTHERWISE SPECIFIED	Amphenol FCI	AIRMAX VS2 VERTICAL HEADER		5 PAIR 150 POS 2MM 10 COL,GXT+		Product - Customer Drw		sheet 1 of 4	

PDS: Rev :E

STATUS:Released

Printed: Sep 18, 2020

Amphenol FCI

© 2016 APCI

(26.60)
PROTECTIVE CAP WIDTH

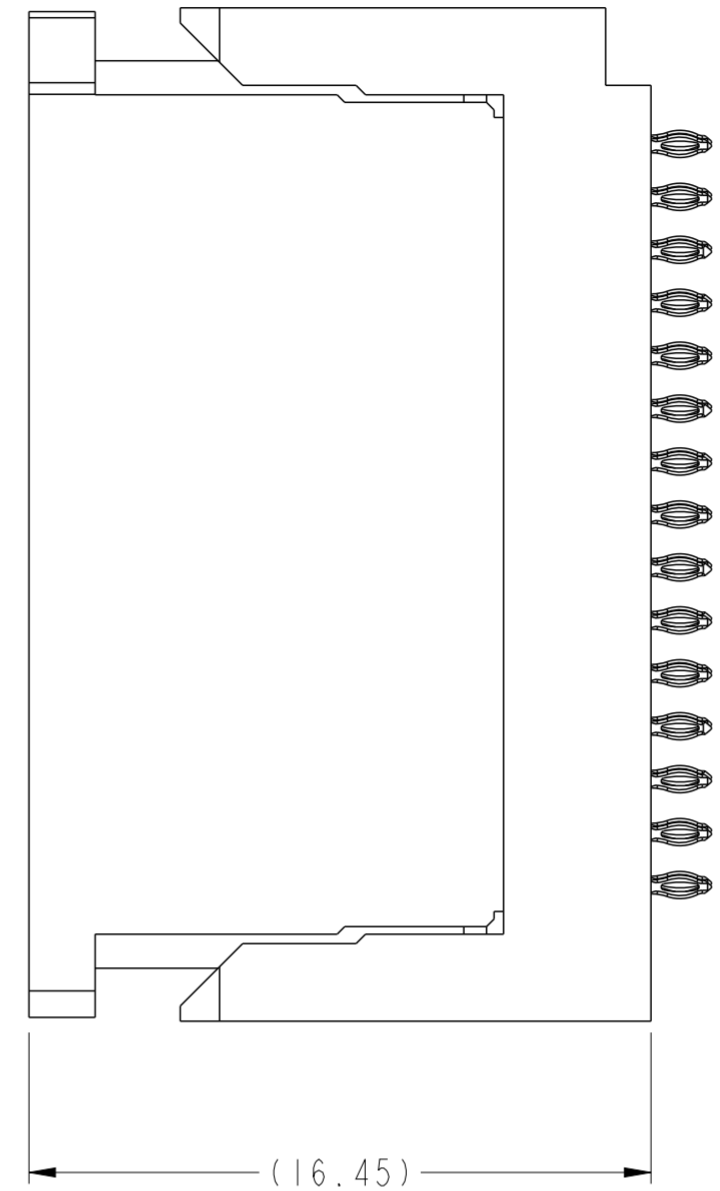
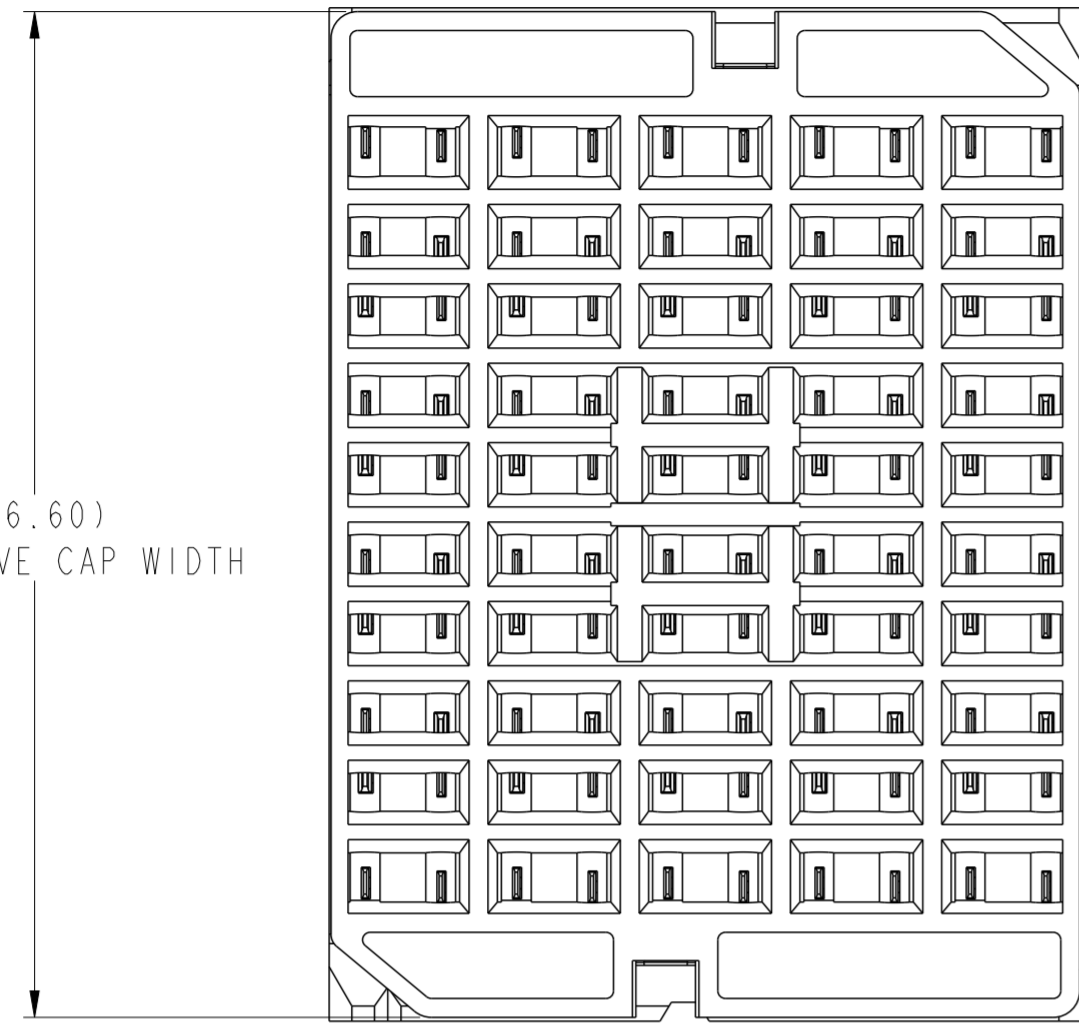

VIEWS SHOWN WITH
PROTECTIVE COVER INSTALLED
10122771-101LF

NOTE 11

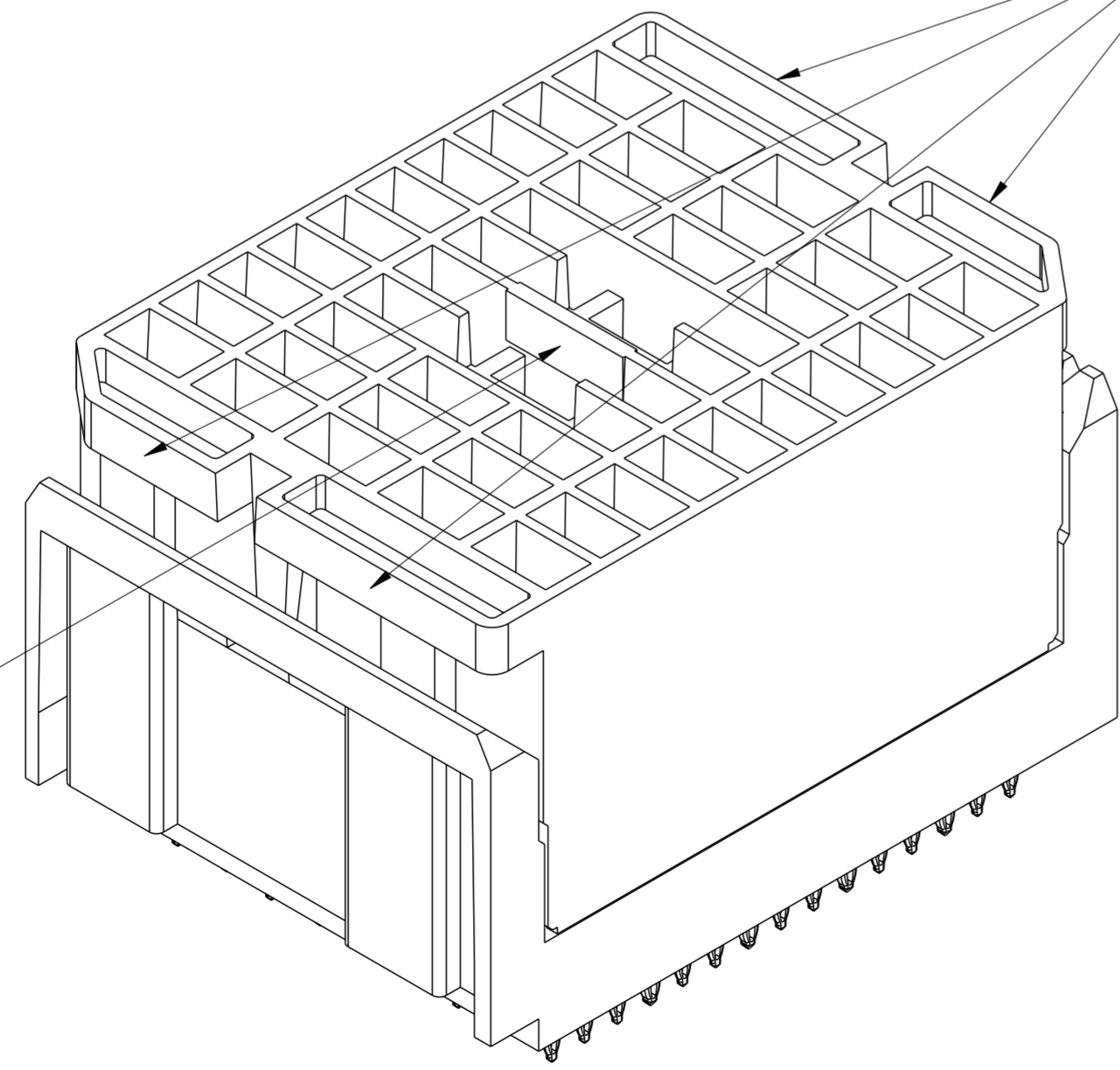

NOTE 12

spec ref	-	dr	Sandar Soe	2012/09/13	projection	MM	size	A2	scale	5:1		
tolerance std	ASME Y14.5	eng	Terry Luo	2020/09/07			ecn no	ELX-DG-38252-1				
TOLERANCES UNLESS OTHERWISE SPECIFIED		chr	-	appr			Heaven Cen	2020/09/17	product family	AIRMAX VS	rel level	Released
surface	-	linear	0.X	±0.3			Amphenol FCI		title	AIRMAX VS2 VERTICAL HEADER		rev
			0.XX	±0.10			5 PAIR 150 POS 2MM 10 COL,GXT+	cat. no.	-	Product - Customer Drw	sheet 2 of 4	
		angular	0°	±2°								

PDS: Rev :E

STATUS:Released

Printed: Sep 18, 2020

Amphenol FCI

© 2016 AFCI

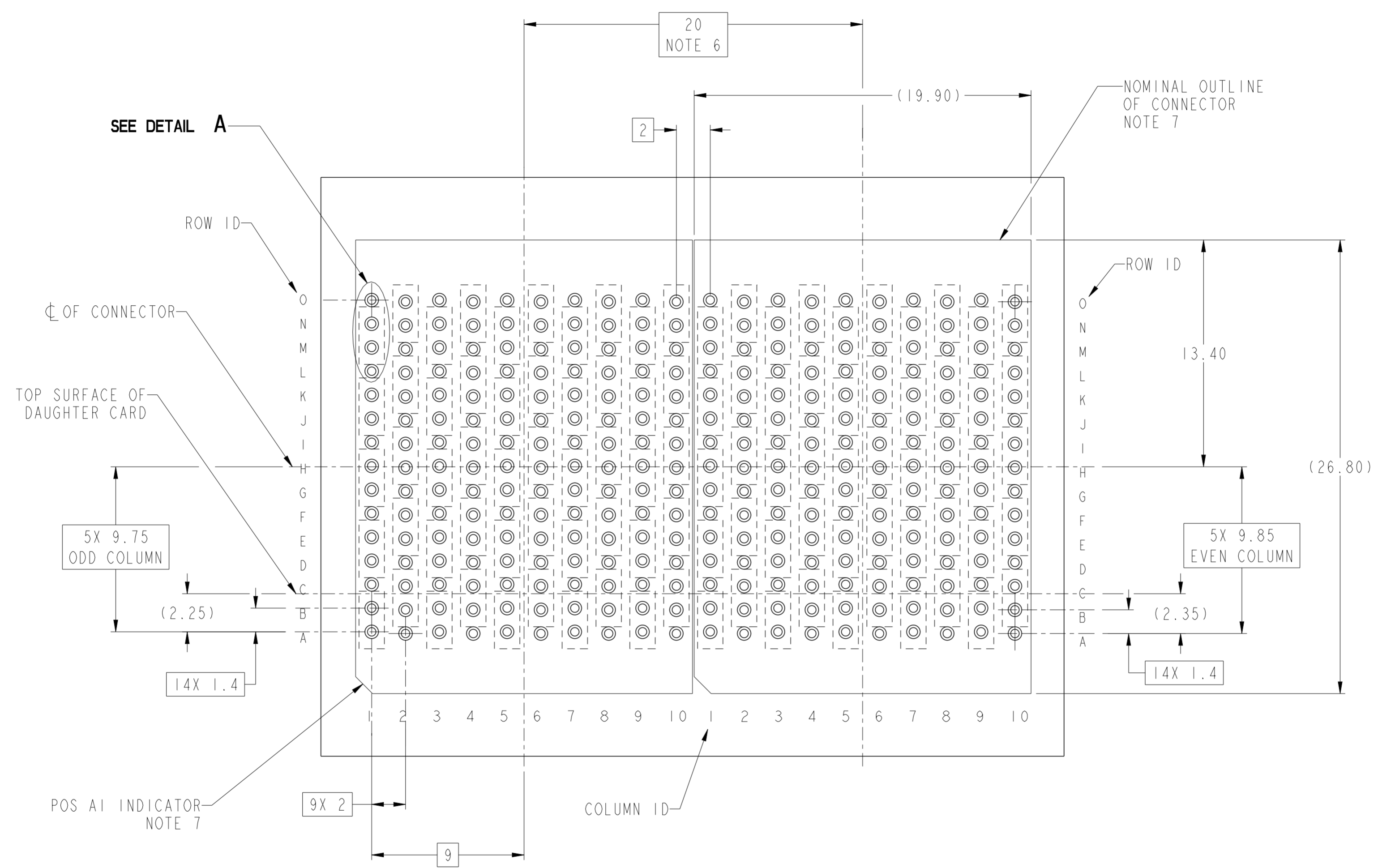

RECOMMENDED PCB LAYOUT
FOR DIFFERENTIAL APPLICATIONS,
COMPONENT SIDE
(TWO ADJACENT FOOTPRINTS SHOWN)
NOTES 6, AND 8

Amphenol
FCi

© 2016 AFci

spec ref	-	dr	Sandar Soe	2012/09/13	projection	MM	size	A2	scale	3:1
tolerance std	ASME Y14.5	eng	Terry Luo	2020/09/07			ecn no	ELX-DG-38252-1	rel level	Released
TOLERANCES UNLESS OTHERWISE SPECIFIED		chr	-	product family			AIRMAX VS			
surface	-	appr	Heaven Cen	2020/09/17			rel level	Released		
linear	0.X ±0.3 0.XX ±0.10 0.XXX ±0.050	Amphenol FCi		title		AIRMAX VS2 VERTICAL HEADER	cat. no.	-	Product - Customer Drw	sheet 3 of 4
angular	0° ±2°	5 PAIR 150 POS 2MM 10 COL,GXT+		div no		10122771	rev		E	

PART NUMBER	PRESS-FIT TAIL PLATING TYPE	PROTECTIVE COVER	FIRST MATE PIN LOCATIONS (5.6mm)	SHORT DETECT PIN LOCATION	REMARKS
10122771-101LF	TIN OVER NICKEL (LEAD FREE)	YES	F1, F3, F5, F7, F9, G2, G4, G6, G8, G10, L1, L3, L5, L7, L9, M2, M4, M6, M8, M10	NA	2-SIDED PLATING
10122771-111LF	TIN OVER NICKEL (LEAD FREE)	YES	F1, F3, F5, F7, F9, G2, G4, G6, G8, G10, L1, L3, L5, L7, L9, M2, M4, M6, M8, M10	H5 (SEE NOTE 13)	2-SIDED PLATING

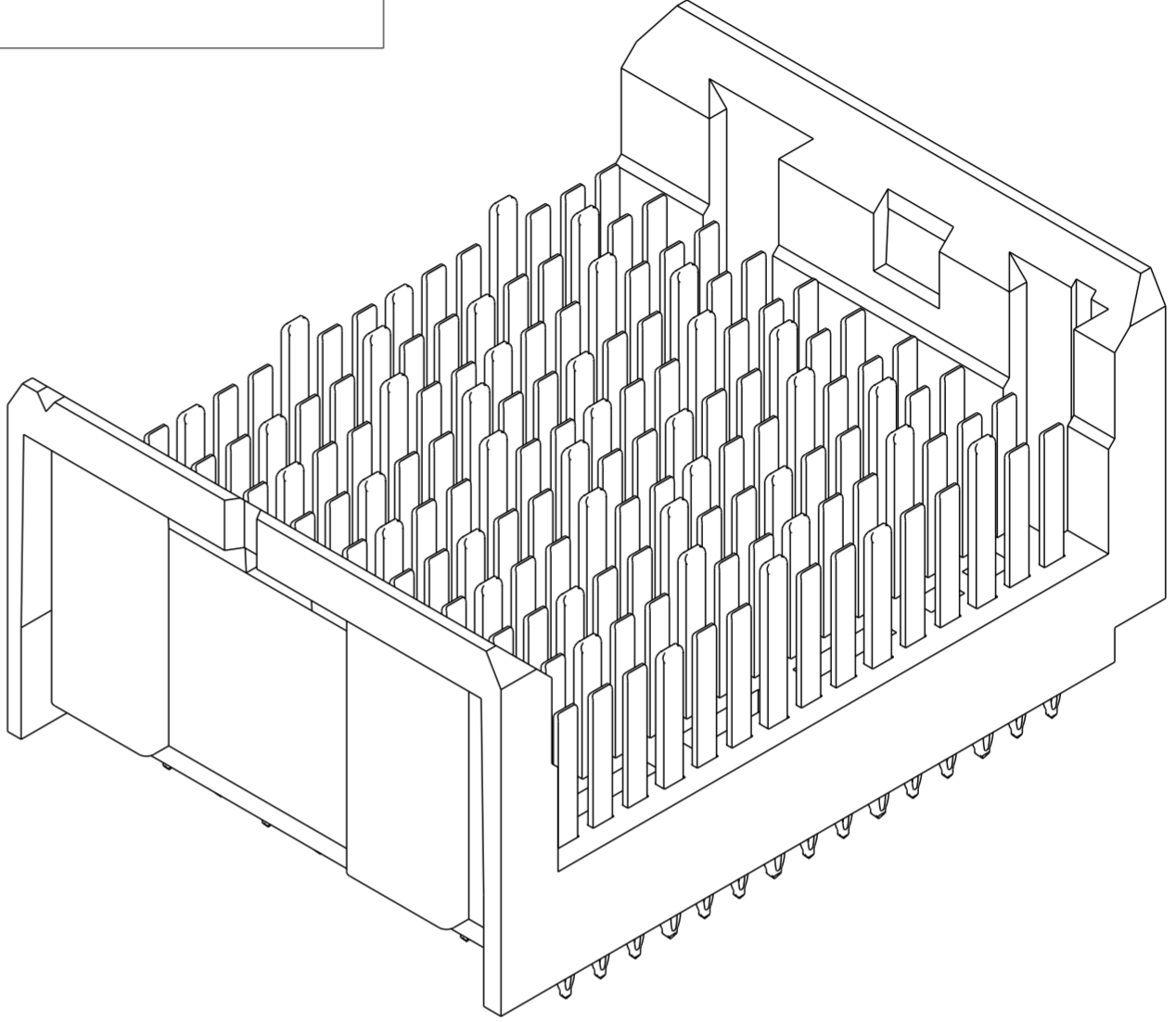

10122771-101LF
(WITHOUT PROTECTIVE COVER)

- NOTES:
- CONNECTOR MATERIALS:
HOUSING: HIGH TEMP THERMOPLASTIC, BLACK, UL94V-0
CONTACT: COPPER ALLOY
 - CONTACT PLATING:
SEPARABLE INTERFACE: PERFORMANCE-BASED PLATING, QUALIFIED TO MEET THE REQUIREMENTS OF FCI PRODUCT SPECIFICATION GS-12-239 INCLUDING TELCORDIA GR-1217-CORE (NOVEMBER 1995) CENTRAL OFFICE TEST SEQUENCE
PRESS-FIT TAILS: SEE TABLE
 - PRODUCT SPECIFICATION: GS-12-239.
 - APPLICATION SPECIFICATION: GS-20-035.
 - PRODUCT MARKING, (PROTOTYPE, PART NUMBER & LOT CODE), ON THIS SURFACE.
 - THE MINIMUM CENTERLINE SPACING BETWEEN ADJACENT MODULES IS 20.0 mm.
 - CONNECTOR OUTLINE WITH HOUSING POS AI INDICATOR MAY BE SCREEN PRINTED ONTO CUSTOMER PCB TO BE USED AS A GUIDE FOR MANUAL CONNECTOR PLACEMENT.
 - REFER TO CUSTOMER DRAWING 10045979 FOR INFORMATION ON PCB HOLE DIAMETERS AND PLATING OPTIONS.
 - THIS PRODUCT MEETS EUROPEAN UNION DIRECTIVES AND OTHER COUNTRY REGULATIONS AS DESCRIBED IN GS-22-008.
 - PACKAGING MEETS GS-14-920 LEAD FREE LABELING SPECIFICATION.
 - FOR REMOVAL OF THE PROTECTIVE CAP BY HAND GRIP USING THESE SURFACES.
 - FOR REMOVAL OF THE PROTECTIVE CAP WITH PLIERS GRIP USING THIS FEATURE.
 - SHORT DETECT PIN IS 0.50mm LESS WIPE NOMINAL THAN THE SHORTEST PIN.

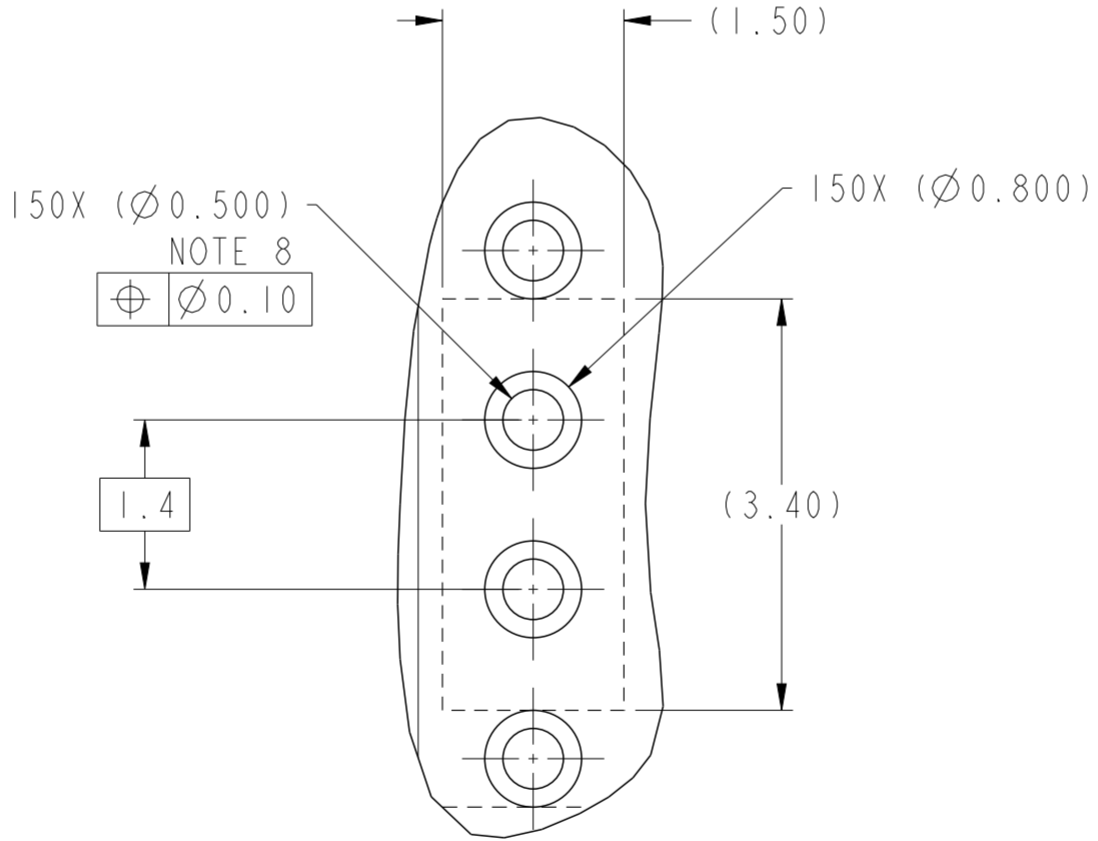

DETAIL A
SCALE 16:1

spec ref	-	dr	Sandar Soe	2012/09/13	projection	MM	size	A2	scale	5:1	
tolerance std	ASME Y14.5	eng	Terry Luo	2020/09/07			ecn no	ELX-DG-38252-1			
TOLERANCES UNLESS OTHERWISE SPECIFIED		chr	-	appr			Heaven Cen	2020/09/17	product family	AIRMAX VS	rel level
surface	-	linear	0.X	±0.3			title	AIRMAX VS2 VERTICAL HEADER		rev	E
			0.XX	±0.10			5 PAIR 150 POS 2MM 10 COL,GXT+	dwg no	10122771		
			0.XXX	±0.050			cat. no.	-	Product - Customer Drw	sheet 4 of 4	
		angular	0°	±2°							