

4

3

2

1

THIS DRAWING IS UNPUBLISHED. RELEASED FOR PUBLICATION - , - .
 © COPYRIGHT - By - ALL RIGHTS RESERVED.

LOC	DIST	REVISIONS					
G	14	P	LTR	DESCRIPTION	DATE	DWN	APVD
		F1		REVISED PER ECO-15-015482	29OCT2015	NK	DR

AMP
WIRE RANGE

6 AWG
STRANDED

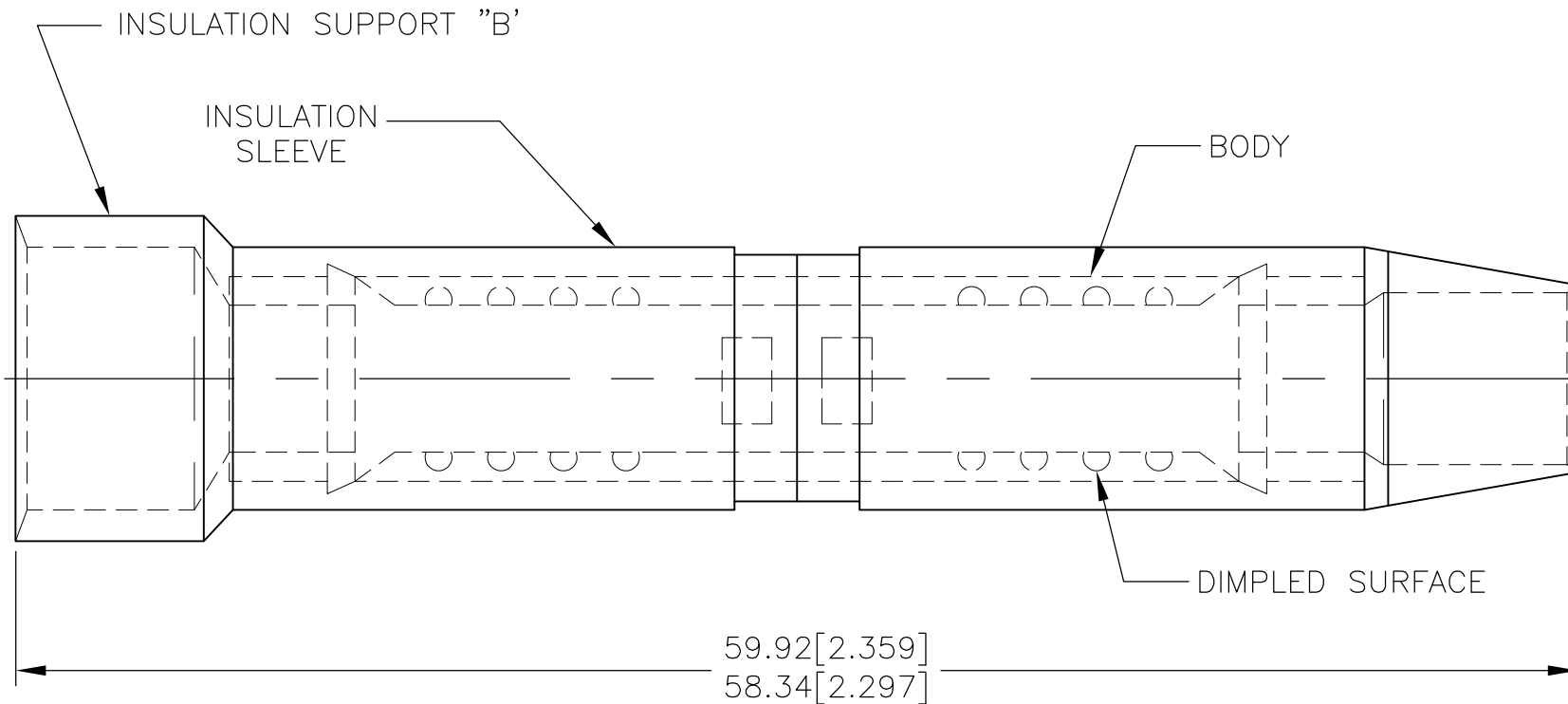

- 1 WIRE INSULATION DIA
INSULATION SUPPORT "A" 7.87[.310] MAX.
- 2 WIRE INSULATION DIA
INSULATION SUPPORT "B" 10.54[.415] MAX.

100	LOOSE PC	324621
QTY	PACKAGE TYPE	PART NO

AMP INCORPORATED CUSTOMER SERVICE SYSTEMS		MAX RECOMMENDED OPERATING TEMPERATURE: 105° C
FOR ADDITIONAL PRODUCT INFORMATION OR COPIES OF DRAWINGS AND TECHNICAL DOCUMENTS	PRODUCT INFORMATION CENTER 1-800-522-6752	VOLTAGE RATING: 600 V MAX
FOR APPLICATION TOOLING INFORMATION	TOOLING ASSISTANCE CENTER 1-800-722-1111	CIRCULAR MIL AREA: 10.54-16.77mm ² [20,800-33,100] STRANDED
FOR ORDER ENTRY	1-800-526-5142	

THIS DRAWING IS A CONTROLLED DOCUMENT.		DWN S.S. GOULDEN 8-30-93	STE TE Connectivity	
DIMENSIONS: mm[INCHES]		CHK R. HERSEY 8-30-93		
		APVD B. BARE 8-30-93	NAME SPLICE, BUTT, SINGLE TO MULTIPLE, TERMINYL, WIRE SIZE: 6 AWG	
		TOLERANCES UNLESS OTHERWISE SPECIFIED: 0 PLC ± - 1 PLC ± - 2 PLC ± 0.20[.008] 3 PLC ± - 4 PLC ± - ANGLES ± -	PRODUCT SPEC -	SIZE A3
MATERIAL COPPER PER ASTM B-152 NYLON, COLOR:BLUE	FINISH TIN PLATE PER ASTM B-545	WEIGHT -	RESTRICTED TO -	
CUSTOMER DRAWING			SCALE NTS	SHEET 1 of 1
			REV F1	