

THIS DRAWING IS UNPUBLISHED. RELEASED FOR PUBLICATION
 © COPYRIGHT - By - ALL RIGHTS RESERVED.

LOC	DIST	REVISIONS			
P	LTR	DESCRIPTION	DATE	DWN	APVD
AF	50	N1	ECR-15-005665	10AUG2015	BDA PKS

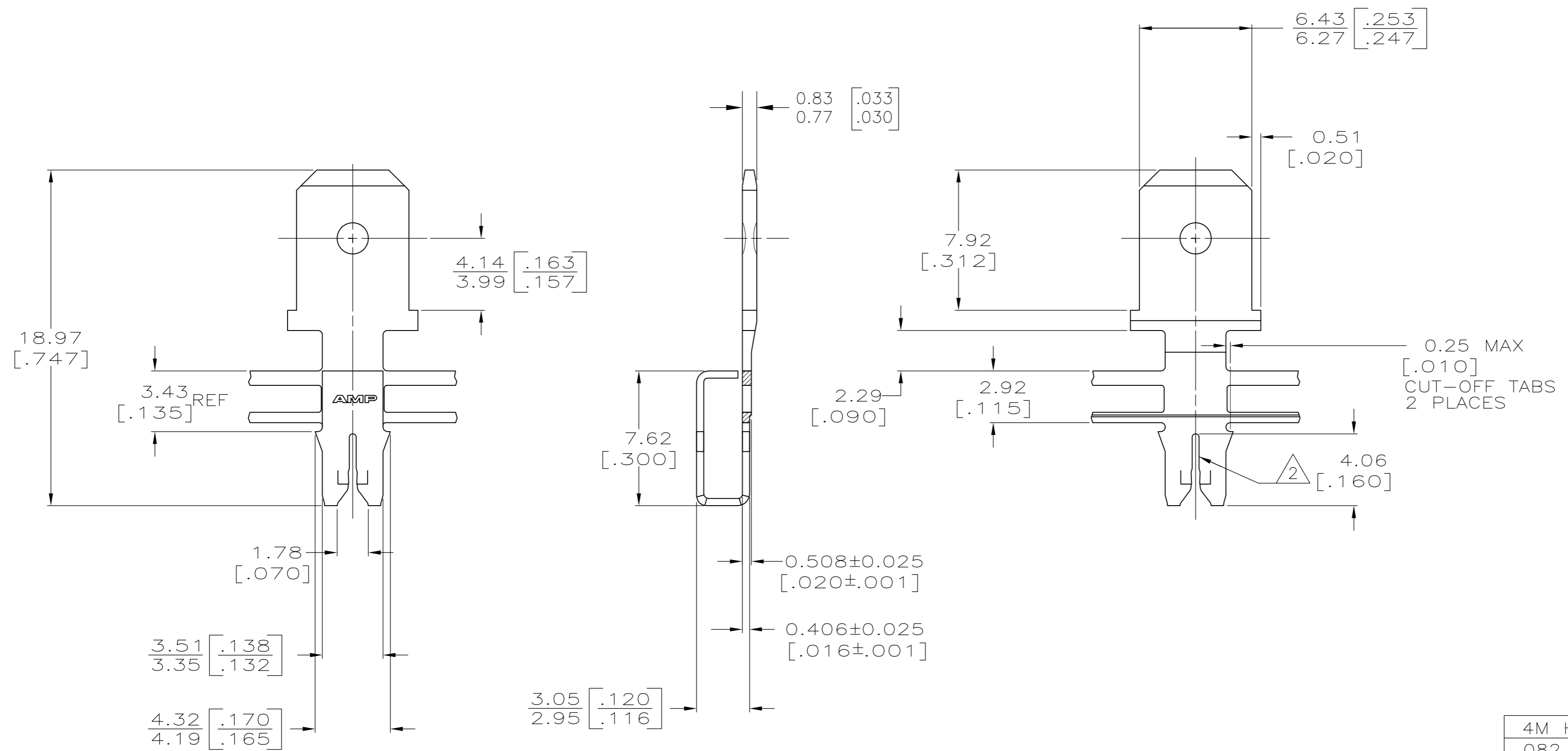

- CONTINUOUS STRIP ON REELS WITH TERMINALS LOCATED ON 8.38 [.330] CENTERS.
- SLOT TERMINATES A SINGLE MAGNET WIRE, COPPER RANGE IS 0.64-0.81mm [#22-#20] AWG. ALUMINUM RANGE IS 0.72-0.91mm [#21-#19] AWG. ALUMINUM WIRE RANGE APPLIES FOR POST-TIN PLATED VERSIONS ONLY.
- AFTER INSERTION INTO PLASTIC HOLDER TAB PORTION MUST BE BENT OVER 45° TO 90° OR POTTED-IN TO PREVENT PULL-OUT WHEN MATING RECEPTACLE IS DISCONNECTED.



MATERIAL	PART NO
4M HARD PRE-MILLED BRASS	62653-3
082 HARD PRE-MILLED BRASS	62653-2
4M HARD PRE-MILLED BRASS	62653-1

THIS DRAWING IS A CONTROLLED DOCUMENT.		DWN	MICHAEL S. FEHER	1/3/92	 TE Connectivity TAB, 6.35 [.250] FASTON™ MAG-MATE™
DIMENSIONS: INCHES		CHK	PHILLIP FORTNEY	1/6/92	
TOLERANCES UNLESS OTHERWISE SPECIFIED:		APVD	NELSON E. NEFF	1/6/92	
0 PLC ± - 1 PLC ± - 2 PLC ± 0.25 [.010] 3 PLC ± - 4 PLC ± - ANGLES ± -		PRODUCT SPEC	108-2012	NAME	
MATERIAL	SEE TABLE	FINISH	0.002037 [.000080]	APPLICATION SPEC	114-2046
		WEIGHT	-	SIZE	A2
		CUSTOMER DRAWING		CAGE CODE	00779
				DRAWING NO	C=62653
				RESTRICTED TO	-
				SCALE	5:1
				SHEET	1 of 1
				REV	N1