

6

5

4

3

2

1

APPROVED: \_\_\_\_\_

DATE: \_\_\_\_\_ TITLE: \_\_\_\_\_

| Rev | AWO # | Description | Date     | Appr |
|-----|-------|-------------|----------|------|
| -   |       | RELEASED    | 11/16/18 |      |

CUSTOM CABLE ASSEMBLIES ARE NON-CANCELLABLE / NON-RETURNABLE

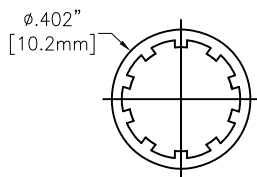
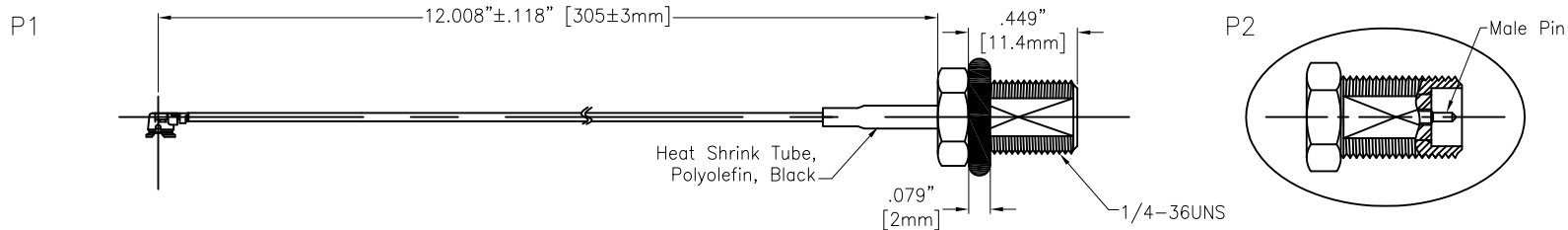

Washer:  
Brass, Gold

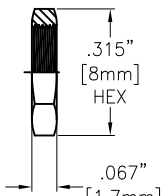

Nut:  
Brass, Gold

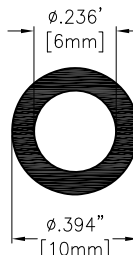

O-Ring  
ø6/2T, Black



**SPECIFICATIONS:**

**Connector:**

P1= I-PEX Connector, Gold plated

P2= SMA Jack (RP), Straight, Male pin, Gold plated

**Cable:**

ø1.37mm Coaxial Cable, Color: Black

**Electrical:**

Impedance: 50 ohms

Frequency range: DC-6 GHz

**Electrical Test:**

All Assemblies must be 100% Tested for Shorts, Open, Continuity, and Physical Appearance.

**Environmental:**

Lead free, RoHS compliant



UNLESS OTHERWISE SPECIFIED  
ALL DIMENSIONS ARE INCHES [MM]  
TOLERANCES: EXCEPT AS NOTED

| INCHES |        | HOLES |        |
|--------|--------|-------|--------|
| .X     | ± .10  | Ø.X   | ± .10  |
| .XX    | ± .020 | Ø.XX  | ± .015 |
| .XXX   | ± .015 | Ø.XXX | ± .010 |

**ADAM TECH**  
INTERCONNECTS

909 Rahway Avenue,  
Union, NJ 07083  
Phone: 908-687-5000  
Fax: 908-687-5710

| APPROVALS |    | DATE     |
|-----------|----|----------|
| DRAWN     | AY | 11/16/18 |
| CHECKED   | AC | 11/16/18 |
| APPROVED  |    |          |

|  |                                   |              |
|--|-----------------------------------|--------------|
| TITLE<br>CUSTOM CABLE ASSEMBLY, IPEX PLUG<br>TO SMA S/T JACK (RP) WITH OD 1.37MM CABLE |                                   |              |
| SIZE<br>X  | PART NO.<br>CA#DKCA0-305L1-AL10-O | REV.<br>-    |
| REF: S00291T   | SCALE: NTS                        | SHEET 1 OF 1 |

6

5

4

3

2

1