

1

2

DATE	REV	EON	APPD. BY
1/5/15	A3	10167	TRM
3-14-16	A4	10806	TRM

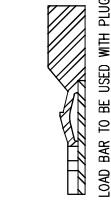

LOAD BAR TO BE USED WITH PLUG

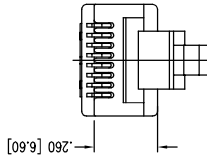
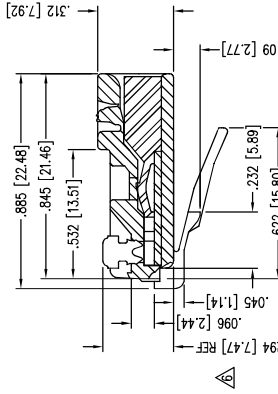
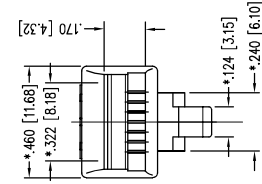
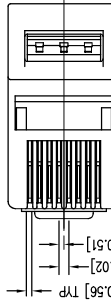

- NOTES:
- 1- PLUG KIT CONSISTS OF :
PRE-INSERTED PLUG HOUSING
LOAD BAR
 - 2- MATERIALS :
FRONT HOUSING PLASTIC : CLEAR POLYCARBONATE, UL 94-V0
LOAD BAR : CLEAR POLYCARBONATE, UL 94-V0
CONTACTS : PHOSPHOR BRONZE, SELECTIVE GOLD PLATING
 - 3- CONTACTS TERMINATE STRANDED CONDUCTORS UP TO .037 [0.94] OUTSIDE DIAMETER OF INSULATION.
 - 4- FOR PRODUCT SPECIFICATION SEE PRO26-01.
 - 5- DIMENSIONS AND TOLERANCES COMPLY WITH TIA-1096 STANDARD.
- △ TERMINATED PLUG HEIGHT: .237 [6.02] ±.005 [0.13]

BULK	50 MICRO-INCHES [1.27um]	940-SP-3088-2PC
PACKAGE	CONTACT PLATING IN MATING AREA	PART NUMBER

THIRD ANGLE PROJECTION

DO NOT SCALE DRAWING
DRAWING IS SUBJECT TO CHANGE WITHOUT NOTICE

DIMENSIONS: INCHES (METRIC)
UNLESS OTHERWISE SPECIFIED
TOLERANCES ARE ±.005 [0.13]
ANGLES ARE ± 1°

SHEET No. 1 OF 1



11118 Susquehanna Trl, South
Glen Rock, PA 17327-9139
(717) 235-7512
<http://www.stewartconnector.com>

TITLE: EIGHT CONTACT/EIGHT POSITION MODULAR; CLEAR;	
URN BY: KRL	DATE: 1/31/06
APPD BY: JM	DATE: 2-1-06
DWG NO. CT1300125	REV. A4



AutoCAD

1

2