

SIGN	DATE	DESCRIPTION	APPROVER
△	2010.02.06	Add cULus standard	Jacke
△	2010.02.06	The Wire strip length is changed	Jacke
△	2010.03.23	Add the 2p mark	Jacke

THIS IS CAD DRAWING, DO NOT REVISE MANUALLY!!!

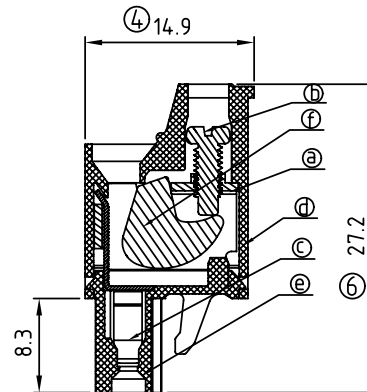
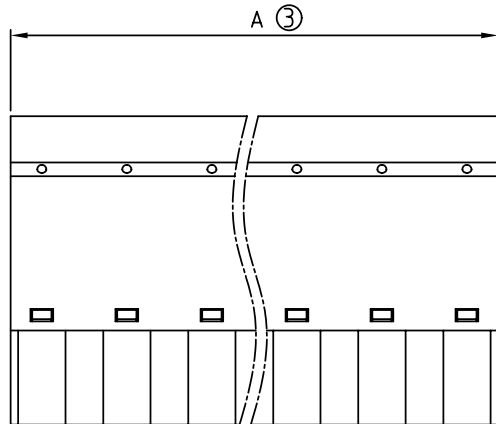
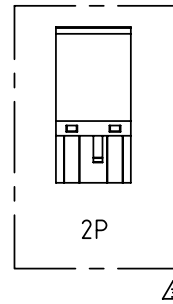
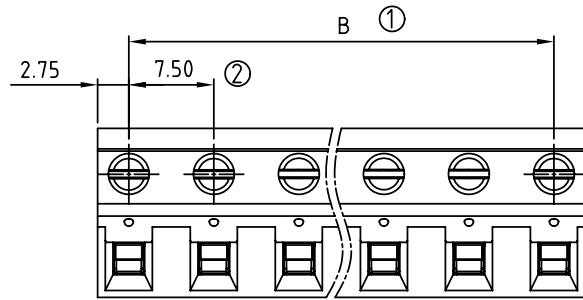

Material

- Item a Clamp: Steel zinc plated.
- Item b Terminal screw: Brass Zinc plating "--" slot type
- Item c Female contact: PhBz Tin plated
- Item d Terminal (Up body): Thermoplastic (UL94V-0)
- Item e Terminal (Down body): Thermoplastic (UL94V-0)
- Item f Clampage: Steel Zinc plated

Electrical cULus

- Voltage rating: 300VAC
- Current rating: 20A
- Wire range: 0.34-2.5mm²
- Solid wire(AWG): 12-22
- Stranded wire(AWG): 12-22
- Torque: 3.5Lb-In
- Screw: M2.5
- △ ● Wire strip length: 6-7mm
- Withstanding Voltage: 1.6KV
- Operating temperature: -40°C to +115°C
- △ ● Safety approval: cULus

VM xx A 5 x 1 xxxx G

- | | | |
|-------------|---------------------|--|
| POLES | Color | G: Pb<40000ppm |
| 02: 02 pole | 0 Black (RAL9005) | 0000: "@" Logo (Standard) |
| "" "" | 2 Red (RAL3001/D) | (Steel screw plating Cr ³) |
| 16: 16 pole | 3 Orange(RAL2011/P) | 000A: "ANYTEK" Mark |
| | 4 Yellow(RAL1018/A) | Any special item by |
| | 5 Green(RAL6018/T) | customer request. |
| | 6 Blue (RAL5015/A) | please contact sales |
| | 8 Grey(RAL7035/D) | department. |

POLE	2	3	4	5	6	7	8	
A	13.00	20.50	28.00	35.50	43.00	50.50	58.00	
B	7.50	15.00	22.50	30.00	37.50	45.00	52.50	
Tol.	±0.10			±0.20				
POLE	9	10	11	12	13	14	15	16
A	65.50	73.00	80.50	88.00	95.50	103.00	110.50	118.00
B	60.00	67.50	75.00	82.50	90.00	97.50	105.00	112.50
Tol.	±0.30			±0.40				

ANYTEK				CUSTOMER COPY			
ALL RIGHTS RESERVED. REPRODUCTION OR ISSUE TO THIRD PARTIES IN ANY FORM WHATSOEVER IS NOT PERMITTED WITHOUT WRITTEN AUTHORITY FROM THE PROPRIETOR. PROPERTY OF ANYTEK TECHNOLOGY CO., LTD							
TITLE	VM 7.5 mm W/O Flange Series						
PART NO.	VMxxA5x1xxxxG			DWG NO.	8VM0402		
APPROVED	CHECKED	DESIGNED	DRAWN	CUST NO.	Tolerance		
		Jacke	Jacke		UNIT: mm	X.	±0.50
		2010.03.23	2009.10.10		SCALE: NONE	X.X	±0.30
				SHEET: 01/01	REV.: D	X.XX	±0.10
						X°	±1°