

6

5

4

3

2

1

APPROVED: _____
 DATE: _____ TITLE: _____

Rev	AWO #	Description	Date	Appr
-		RELEASED	4/12/05	
A		CORRECTION ON FRONT VIEW	01/25/07	
B		REDRAWN	8/21/09	
C		UPDATE SPEC.	10/25/19	AY/KC

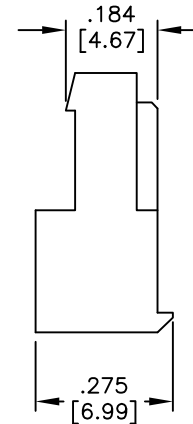
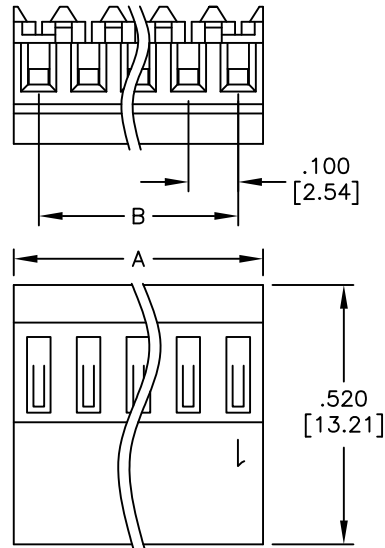

PART NUMBER	Wire Size	Insulator Color	Contact resistance
MTD-A-XX-C-2	22 AWG	RED	10mΩ Max
MTD-A-XX-D-2	24 AWG	WHITE	15mΩ Max
MTD-A-XX-E-2	26 AWG	BLUE	20mΩ Max
MTD-A-XX-F-2	28 AWG	GREEN	30mΩ Max

SPECIFICATIONS:

Material:
 Insulator: Nylon 66, rated UL 94V-2
 Insulator color: See chart
 Contacts: Phosphor Bronze
 Plating:
 Tin over Copper underplate overall
 Electrical:
 Voltage rating: 250 VAC/DC max.
 Current rating: 3A AC/DC.
 Contact resistance: See chart.
 Insulation resistance: 1000 Mohms min.
 Dielectric withstanding voltage: 1500 VAC for 1 minute
 Temperature Rating:
 Operating temperature: -40°C to +105°C
 Environmental:
 Lead free, RoHS compliant



Positions: 2 thru 24
 A = .100 [2.54] x No. of Positions
 B = .100 [2.54] x No. of Spaces

UNLESS OTHERWISE SPECIFIED ALL DIMENSIONS ARE INCHES [MM] TOLERANCES: EXCEPT AS NOTED INCHES HOLES .X ± .10 Ø.X ± .10 .XX ± .020 Ø.XX ± .015 .XXX ± .015 Ø.XXX ± .010		ADAM TECH INTERCONNECTS		909 Rahway Avenue, Union, NJ 07083 Phone: 908-687-5000 Fax: 908-687-5710	
APPROVALS DRAWN SS CHECKED APPROVED		DATE 4/12/05		TITLE IDC MASS TERMINATION HOUSING .100 [2.54] SPACING, CLOSED END	
SIZE X		PART NO. MTD-A-XX-X-2		REV. C	
REF: S00004T		SCALE: NTS		SHEET 1 OF 1	

6

5

4

3

2

1